

VERGE WALL TUNABLE WHITE

24VDC, PLASTER-IN LED SYSTEM

BY GREGORY KAY, ORIGINAL DESIGNER OF 5/8" DRYWALL PRODUCTS | ASSEMBLED IN AMERICA

REV 07.07.25

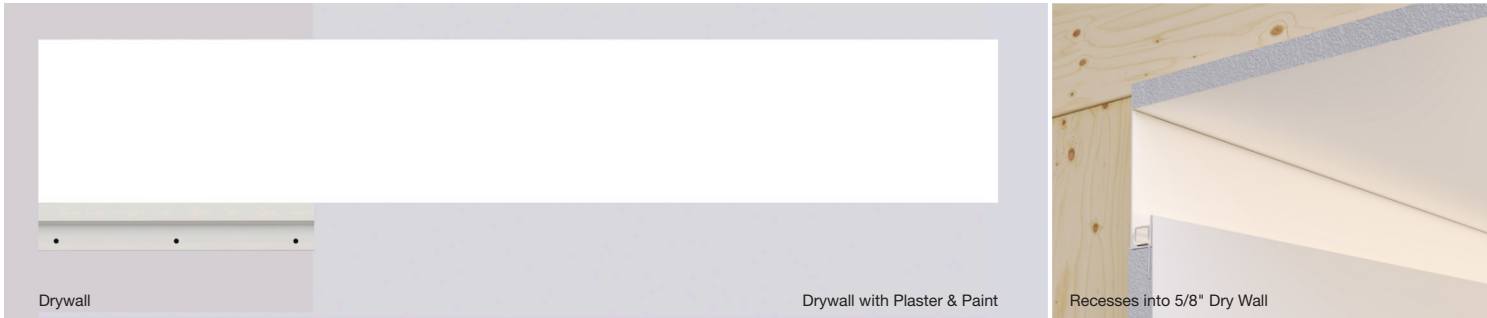

DESCRIPTION

Verge Wall, a slim, plaster-in aluminum channel with a 4" paintable aluminum backer plate, highlights the transition where two drywall surfaces join together, while emitting ambient illumination. The 24VDC linear LED system mounts directly to studs without joist modification and plasters into 5/8" or thicker drywall. Verge is sold in 1' increments up to 40' and field cuttable to any length. Our Designer-grade High CRI Tunable White technology in 2000K-6500K (**2K6K**) or 2700K-6500K (**27K6**) grants independent control and adjustment of color temperature and intensity from 2000K (Sunset) through 6500K (Day Light White). Tunable white lighting visually, biologically and emotionally contributes to human interaction with the physical world. Human centric lighting (HCL) builds on this technology bringing the dynamics of natural daylight indoors, and delivering a positive effect on human health, wellbeing and performance. Coordinate installation with electrical and drywall contractors. Includes a 5-year pro-rated warranty. For custom quotes and layout assistance, send drawings to design@PureEdgeLighting.com.

DESIGN NOTE

Verge Wall may be installed on a single surface for Toe-Kick and Cove lighting applications. Ambient and harmonious, the plaster-in LED system blends into 5/8" thick drywall to enhance the contemporary aesthetic of interior spaces. Verge offers unsurpassed flexibility that transforms interiors into thoughtful, unique works of art.

MAXIMUM LENGTHS BEFORE RE-FEEDING

- 2WDC, 2.5 watts per foot - 40'
- 5WDC, 4.4 watts per foot - 20'
- 7WDC, 7.5 watts per foot - 12'

LAMP

- Tunable White: 2000K-6500K (**2K6K**) and 2700K-6500K (**27K6**) grants independent control for adjusting color temperature and intensity
- Lumen Performance: 228lm/ft at 3000K 7W per foot
- CRI 95+
- Average life: 50,000 hours
- For additional color temperatures refer to other specifications

REMOTE POWER SUPPLIES*, DIMMERS & CONTROLS (SOLD SEPARATELY)

24VDC, Class 2 wiring

- Pure Smart™ WiZ Pro [Power Supplies](#) & [Smart Controls](#)
- [0-10V](#) Requires two dimmers, one for intensity and one for color temperature
- [DMX & Controls](#)

*In-Wall Mounting and drop ceiling Kits available for select power supplies

INCLUDED COMPONENTS

Junction Box, Adjustable Mounting Bars, Backer Plate, Verge Wall Channel(s), Drywall Screws, LED Strip, and Lens(es)

APPLICATIONS

Indoor damp or dry locations only. Wall Mount for use as Cove lighting or use at the Floor for Floating Wall effects. Ideal applications include Residential, Commercial, Retail, and Hospitality environments.

COMPLIANCE

ETL, Class 2, Damp Location, Assembled in the USA.

For quick & easy reference, plus the most up-to-date pricing, use our Configurator. [Verge Wall](#)

PureEdge is the Original Designer of 5/8" Drywall Products, Backed by Over 30 Years of Precision Manufacturing and Design.

System	Watts Per Foot	Length in Feet	
VG	2WDC	1-40FT	ST27K6
VG Verge Wall	2WDC 2.5 Watts (40ft Max) 5WDC 5 Watts (20ft Max) 7WDC 7.5 Watts (12ft Max)	1-40FT 1-20FT 1-12FT	ST2K6K Tunable White 2000K-6500K ST27K6 Tunable White 2700K-6500K

PROJECT		FIXTURE TYPE		DATE	
---------	--	--------------	--	------	--

VERGE WALL TUNABLE WHITE

24VDC, PLASTER-IN LED SYSTEM

NOMINAL LAMP DATA

WATTS PER FOOT	2K6K																							
	2K6K 2W (2.5 watts)												2K6K 5W (4.4 watts)											
COLOR TEMPERATURE	20K	22K	24K	27K	30K	35K	40K	57K	65K	20K	22K	24K	27K	30K	35K	40K	57K	65K	20K	22K	24K	27K	30K	35K
LUMENS PER FOOT (lm/ft)	57	58	58	59	60	62	67	73	78	138	143	149	155	160	171	184	186	187	192	201	210	219	228	246
LUMENS PER WATT (lm/w)	31	29	29	30	30	31	90	36	43	30	30	31	32	33	36	38	39	41	30	28	29	30	32	34
CRI	91+	91+	91+	91+	91+	94+	94+	94+	91+	91+	91+	91+	91+	91+	94+	94+	94+	91+	91+	91+	91+	91+	94+	94+

	27K6																																			
WATTS PER FOOT	27K6 2W (2.5 watts)												27K6 5W (4.4 watts)												27K6 7W (7.5 watts)											
COLOR TEMPERATURE	27K	30K	35K	40K	45K	57K	65K	27K	30K	35K	40K	45K	57K	65K	27K	30K	35K	40K	45K	57K	65K	27K	30K	35K	40K	45K	57K	65K								
LUMENS PER FOOT (lm/ft)	62	73	75	77	84	91	86	154	157	163	169	167	166	165	208	212	220	228	226	224	223	208	212	220	228	226	224	223								
LUMENS PER WATT (lm/w)	34	37	38	39	42	45	48	38	34	35	37	36	36	41	32	30	31	32	31	31	35	32	30	31	32	31	31	35								
CRI	91+	91+	91+	94+	94+	94+	91+	91+	91+	91+	94+	94+	94+	91+	92+	92+	92+	95+	93+	93+	93+	92+	92+	92+	95+	93+	93+	93+								

2.5 WATTS PER FOOT

LENGTH IN FEET	WATTS	LENGTH IN FEET	WATTS	LENGTH IN FEET	WATTS	LENGTH IN FEET	WATTS
1	3	11	27	21	51	31	75
2	5	12	29	22	54	32	78
3	8	13	32	23	56	33	80
4	10	14	34	24	58	34	82
5	13	15	37	25	61	35	85
6	15	16	39	26	63	36	87
7	17	17	41	27	66	37	90
8	20	18	44	28	68	38	92
9	22	19	46	29	70	39	94
10	24	20	48	30	72	40	96

5 WATTS PER FOOT

LENGTH IN FEET	WATTS	LENGTH IN FEET	WATTS	LENGTH IN FEET	WATTS	LENGTH IN FEET	WATTS
1	5	6	30	11	54	16	78
2	10	7	34	12	58	17	82
3	16	8	40	13	64	18	88
4	20	9	44	14	68	19	92
5	24	10	48	15	72	20	96

7 WATTS PER FOOT

LENGTH IN FEET	WATTS	LENGTH IN FEET	WATTS	LENGTH IN FEET	WATTS	LENGTH IN FEET	WATTS
1	7.5	4	30	7	52.5	10	75
2	15	5	37.5	8	60	11	82.5
3	22.5	6	45	9	67.5	12	90

COVE INSTALLATION

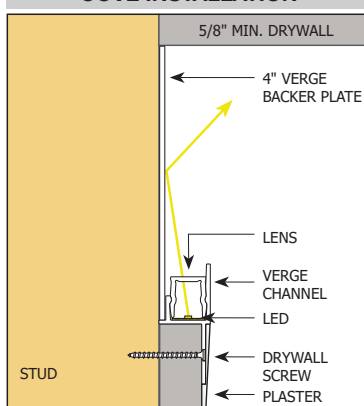

Direction of Light

TOE-KICK INSTALLATION

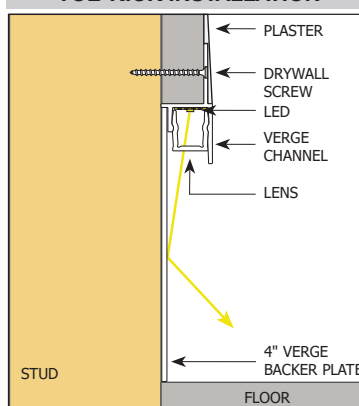

Direction of Light

PROJECT		FIXTURE TYPE		DATE	
---------	--	--------------	--	------	--

VERGE WALL TUNABLE WHITE

24VDC, PLASTER-IN LED SYSTEM

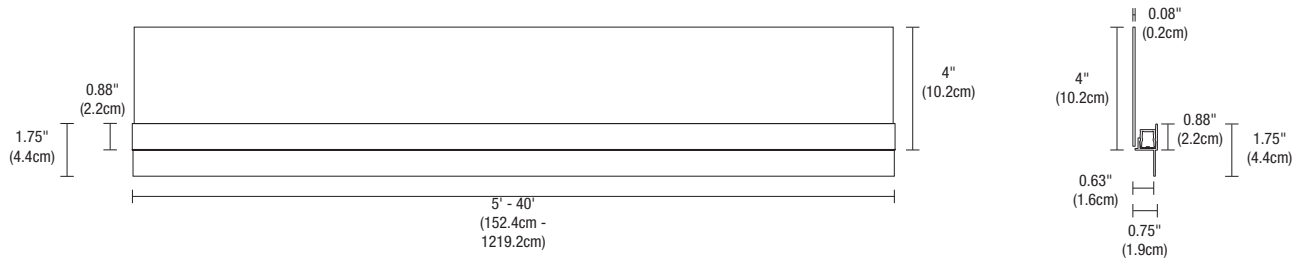

INCLUDED COMPONENTS

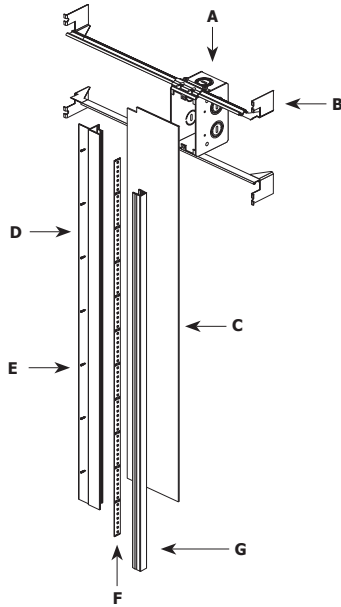

A. JUNCTION BOX

Mounts behind drywall with Adjustable Mounting Bars. Low Voltage 24VDC wires from Remote Power Supply connect to the wires inside box. Junction Box opening is covered by the Backer Plate and required at the beginning of each run.

B. ADJUSTABLE MOUNTING BARS

Provide flexibility for mounting in a variety of spaces.

C. BACKER PLATE

4" paintable aluminum plate that conceals Junction Box and reflects light.

D. VERGE CHANNEL

5/8" deep extrusion houses a single row of LED Strip

E. DRYWALL SCREWS

Secures channel to drywall and stud.

F. LED STRIP

Commercial-grade White or Dynamic Color Changing LED Strip. See lamp data on for additional details.

G. LENS

0.6" wide diffused lens projects a clean line of light without LED pixelation.

JUNCTION BOX ROUGH-IN COMPONENT

One Junction Box is included with Verge Wall. Order additional Junction Box(es) separately to rough-in electrical wiring before drywall installation. Quick shipment available.

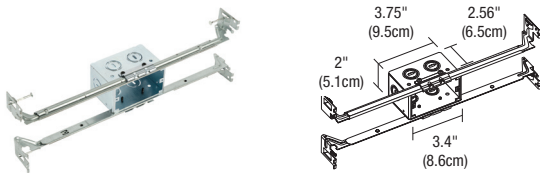

System	Size	Component
VG	1RE	JBOX
VG Verge Wall	1RE 1" Rectangle	JBOX Junction Box

VERGE WALL TUNABLE WHITE 24VDC, PLASTER-IN LED SYSTEM

INSTALLATION

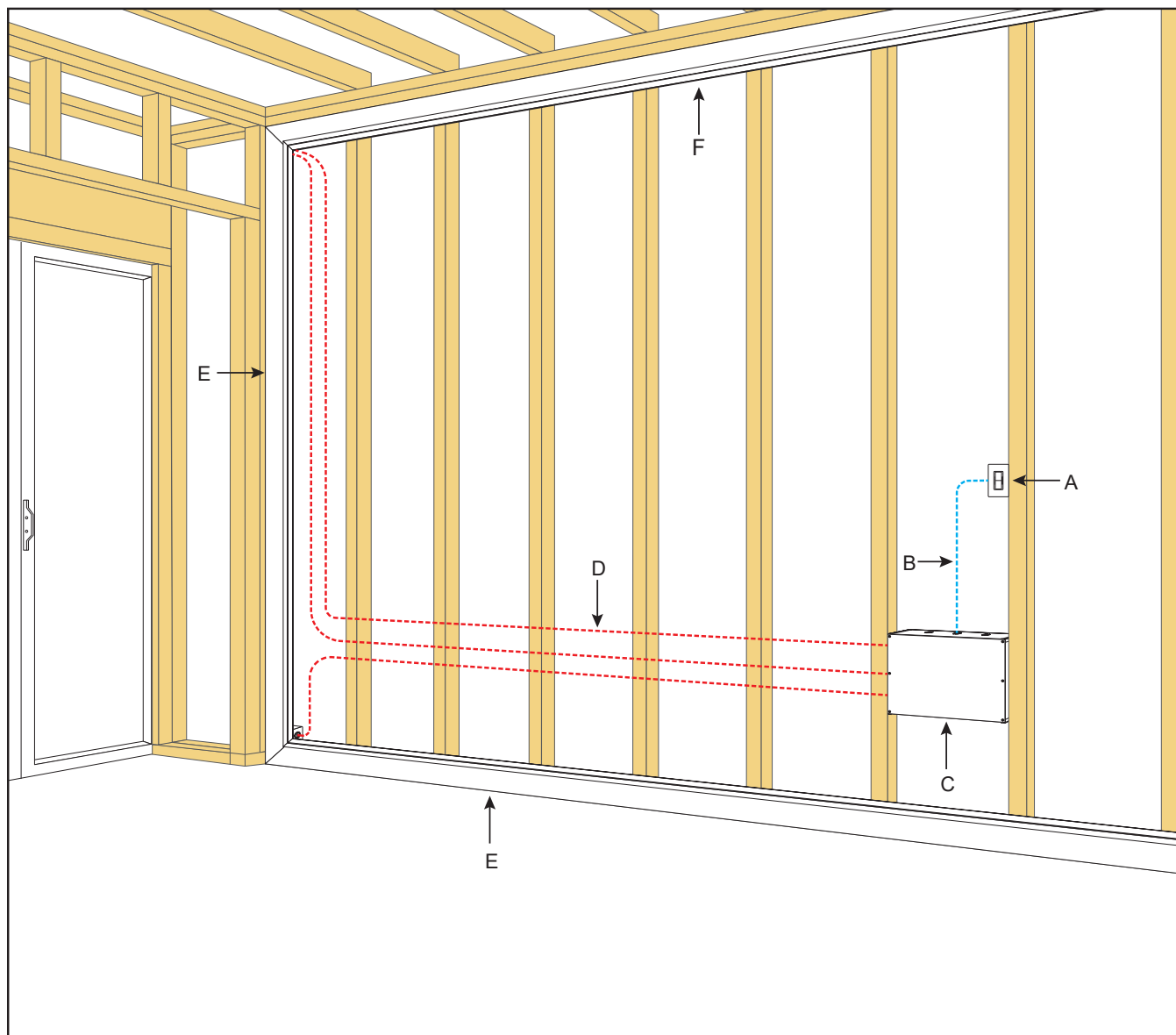

- A. DIMMER OR SWITCH**
- B. 120VAC WIRING**
- C. 120V/24VDC REMOTE POWER SUPPLY FOR IN-WALL MOUNTING KIT**
- D. 24VDC, CLASS 2 WIRING**
- E. VERGE WALL CHANNEL**
- F. LED STRIP**

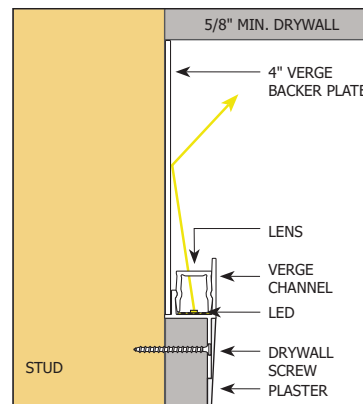

 Direction of Light Cove Installation

PROJECT	FIXTURE TYPE	DATE
---------	--------------	------

TM30 DATA

24VDC, PLASTER-IN LED SYSTEM

TM-30-15 DATA: The data below is for Tunable White bare LED Strip. Consistent color temperatures throughout a single strip and among multiple strips is possible through a 3 phase binning process in which each order is inspected with a color meter to ensure uniformity.

2000K ONLY (2K6K/27K6) | Rf: 90.6 | Rg: 98.5

Color Vector Graphic

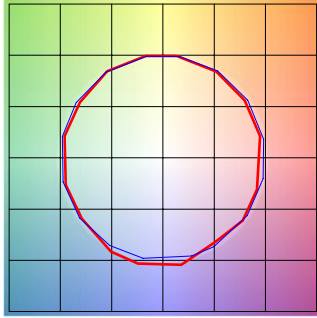

■ Test ■ Reference

		GRAPHIC SHIFTS %	
HUE BIN	Rf	CHROMA	HUE
1	87.7	-5.5%	1.2%
2	88.7	-3.9%	4.2%
3	90.5	-1.5%	4.3%
4	95.0	-1.7%	0.8%
5	95.2	-0.2%	2.1%
6	94.2	1.6%	1.9%
7	95.9	-0.8%	-2.2%
8	95.5	-1.7%	1.3%
9	93.8	-1.4	2.6%
10	91.9	-0.7%	4.2%
11	91.3	3.6%	3.7%
12	91.2	4.2%	-1.0%
13	86.6	3.8%	-12.7%
14	67.2	-3.0%	-16.3%
15	84.9	-3.3%	-9.4%
16	84.2	-5.7%	-7.5%

3000K (2K6K/27K6) | Rf: 90.5 | Rg: 100.7

Color Vector Graphic

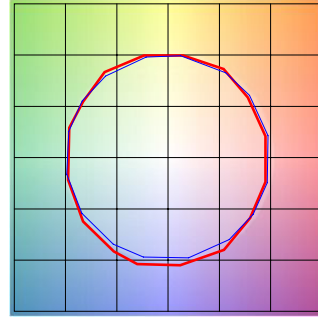

■ Test ■ Reference

		GRAPHIC SHIFTS %	
HUE BIN	Rf	CHROMA	HUE
1	91.5	-3.5%	1.2%
2	92.4	-1.8%	2.7%
3	89.8	0.3%	4.5%
4	92.4	-1.7%	0.4%
5	93.3	-0.1%	1.4%
6	94.5	2.1%	-0.6%
7	91.0	-2.5%	0.3%
8	96.9	-0.8%	-0.2%
9	91.6	-0.9%	4.6%
10	86.7	0.7%	7.8%
11	86.3	3.8%	8.5%
12	88.3	6.1%	0.6%
13	90.9	3.1%	-5.2%
14	87.3	4.7%	-7.9%
15	92.1	-1.9%	-2.5%
16	84.5	-0.9%	-10.9%

4000K ONLY (2K6K/27K6) | Rf: 86.4 | Rg: 96.1

Color Vector Graphic

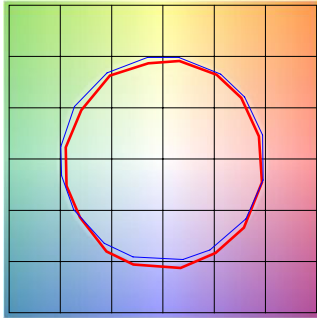

■ Test ■ Reference

		GRAPHIC SHIFTS %	
HUE BIN	Rf	CHROMA	HUE
1	86.5	-5.5%	1.3%
2	90.4	-3.0%	2.3%
3	89.8	-2.1%	3.6%
4	89.1	-3.4%	0.4%
5	88.5	-5.9%	0.1%
6	93.6	-3.0%	-0.4%
7	88.9	-6.2%	1.7%
8	87.3	-5.0%	4.9%
9	82.4	-3.6%	11.3%
10	77.4	-1.8%	12.7%
11	79.8	4.9%	11.4%
12	88.7	4.4%	2.7%
13	88.7	4.0%	-5.1%
14	91.2	2.2%	-3.8%
15	82.7	-0.1%	-9.2%
16	82.8	-2.2%	-7.6%