

VERGE WALL WARM DIM

24VDC, PLASTER-IN LED SYSTEM

BY GREGORY KAY, ORIGINAL DESIGNER OF 5/8" DRYWALL PRODUCTS | ASSEMBLED IN AMERICA

REV 07.24.25

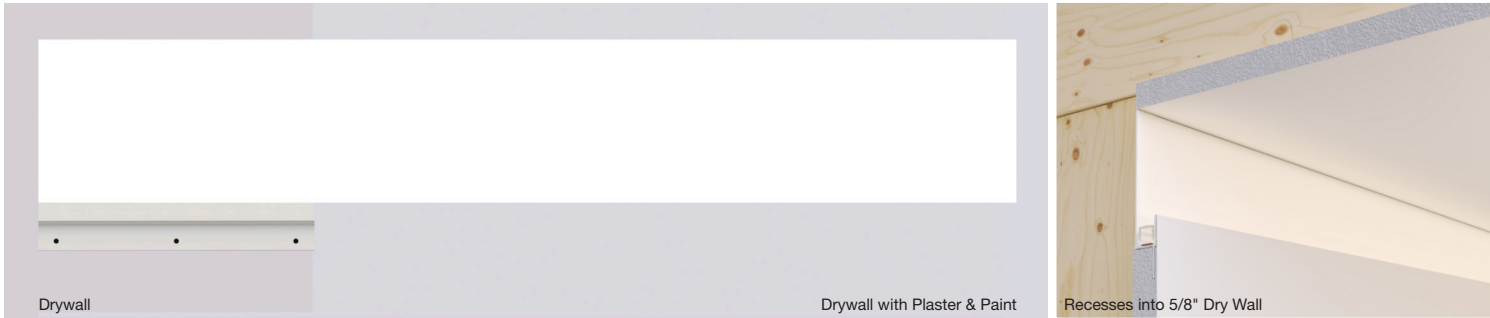

DESCRIPTION

Verge Wall Warm Dim is another innovative design that comes from the family of plaster-in 24VDC systems pioneered by PureEdge that recesses within 5/8" drywall without joist modification. Verge Wall creates and highlights the transition space where two drywall surfaces join together while emitting ambient illumination, redefining the relationship between lighting and architecture. Order in 1' field-cutable increments up to 20', the slim plaster-in aluminum extrusion has a 4" paintable backer plate. Warm Dim technology (**27D** & **30D**) mimics an incandescent atmosphere by decreasing the color temperature as you dim. Our Warm Dim strips can be dimmed all the way down to a soothing amber hue at 1800K, reminiscent of candlelight along the halogen curve. [Click here for all Other Color Temperatures](#). Verge brings together a Modern and Dynamic appearance to Residential and Commercial environments, offering unlimited creativity and empowering you to design One-of-a-kind spaces every time. Remote Power supplies are required and sold separately. Coordinate installation with electrical and drywall contractors. Includes a 5-year pro-rated warranty. For custom quotes and layout assistance, send drawings to design@PureEdgeLighting.com.

DESIGN NOTE

Verge Wall may be installed on a single surface for cove and toe-kick applications. Ambient and harmonious, the plaster-in LED system blends into 5/8" thick drywall to enhance the contemporary aesthetic of interior spaces. Verge offers unsurpassed flexibility that transforms interiors into thoughtful, unique works of art.

MAXIMUM LENGTHS BEFORE RE-FEEDING

- 5WDC, 4.4 watts per foot - 20'

INCLUDED COMPONENTS

Junction Box, Adjustable Mounting Bars, Backer Plate, Verge Wall Channel(s), Drywall Screws, LED Strip, and Lens(es)

LAMP

- Warm Dim: **27D** and **30D** dim down to 1800K, resembling halogen
- light sources
- Lumen Performance: 203lm/ft at 3000K 5 watts per foot
- Designer Grade High CRI 95+ LEDs
- Average life: 50,000 hours
- For additional color temperatures refer to other specifications

REMOTE POWER SUPPLIES*, DIMMERS & CONTROLS (SOLD SEPARATELY)

24VDC, Class 2 wiring

- [UNI Driver: Universal Dimming \(TRIAC, ELV, 0-10V\)](#)
ELV & TRIAC [Smart Dimmer & Switch](#)
- [0-10V](#)
- [Lutron](#) Hi-Lume/Ecosystem

*In-Wall Mounting and drop ceiling Kits available for select power supplies

MAKE IT SMART

- [Pure Smart™ WiZ Pro Controls](#)

APPLICATIONS

Indoor damp or dry locations only. Wall Mount for use as Cove lighting or use at the Floor for Floating Wall effects. Ideal applications include Residential, Commercial, Retail, and Hospitality environments.

COMPLIANCE

ETL, Class 2, Damp Location, Assembled in the USA.

For quick & easy reference, plus the most up-to-date pricing, use our [Verge Wall Configurator](#).

PureEdge is the Original Designer of 5/8" Drywall Products, Backed by Over 30 Years of Precision Manufacturing and Design.

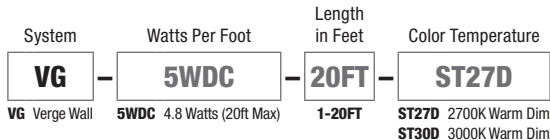

PROJECT		FIXTURE TYPE		DATE	
---------	--	--------------	--	------	--

VERGE WALL WARM DIM

24VDC, PLASTER-IN LED SYSTEM

NOMINAL LAMP DATA

WATTS PER FOOT	5W (4.8 watts)	
COLOR TEMPERATURE	27D*	30D*
LUMENS PER FOOT (lm/ft)	199	203
LUMENS PER WATT (lm/w)	41	42
CRI	94+	94+

LENGTH LOAD CHARTS: To determine the necessary wire gauge use our [Voltage Drop Calculator](#).

5 WATTS PER FOOT	
LENGTH IN FEET	WATTS
1	5
2	10
3	16
4	20
5	24
6	30
7	34
8	40
9	44
10	48
11	54
12	58
13	64
14	68
15	72
16	78
17	82
18	88
19	92
20	96

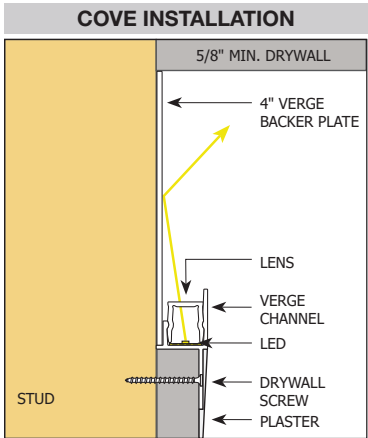

■ Direction of Light

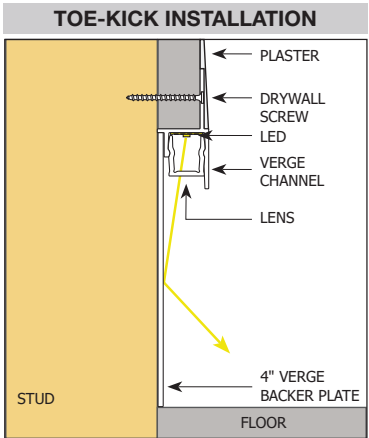

■ Direction of Light

VERGE WALL WARM DIM

24VDC, PLASTER-IN LED SYSTEM

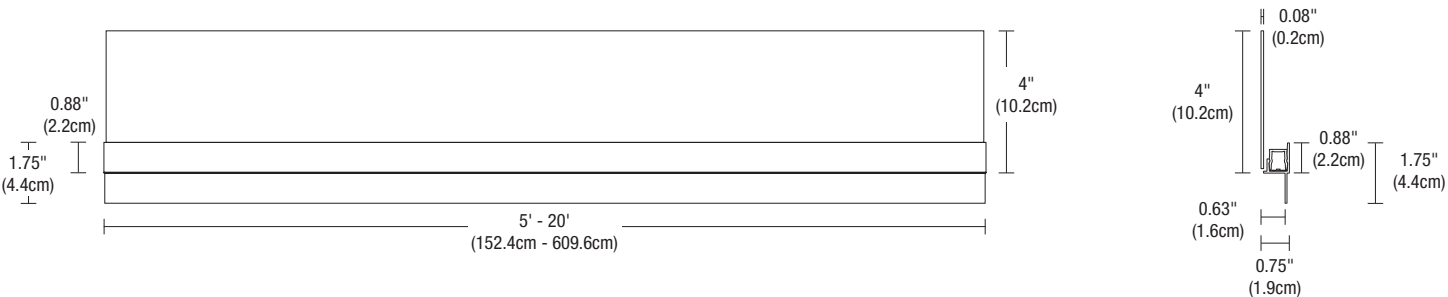

INCLUDED COMPONENTS

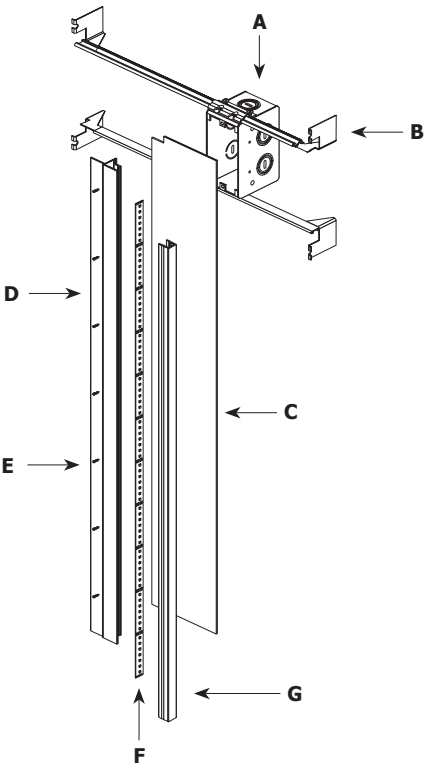

- A. JUNCTION BOX**
Mounts behind drywall with Adjustable Mounting Bars. Low Voltage 24VDC wires from Remote Power Supply connect to the wires inside box. Junction Box opening is covered by the Backer Plate and required at the beginning of each run.
- B. ADJUSTABLE MOUNTING BARS**
Provide flexibility for mounting in a variety of spaces.
- C. BACKER PLATE**
4" paintable aluminum plate that conceals Junction Box and reflects light.
- D. VERGE CHANNEL**
5/8" deep extrusion houses a single row of LED Strip
- E. DRYWALL SCREWS**
Secures channel to drywall and stud.
- F. LED STRIP**
Commercial-grade White or Dynamic Color Changing LED Strip. See lamp data on for additional details.
- G. LENS**
0.6" wide diffused lens projects a clean line of light without LED pixelation.

JUNCTION BOX ROUGH-IN COMPONENT

One Junction Box is included with Verge Wall. Order additional Junction Box(es) separately to rough-in electrical wiring before drywall installation. Quick shipment available.

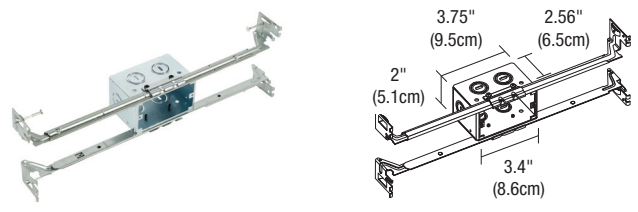

System	Size	Component
VG	1RE	JBOX
VG Verge Wall	1RE 1" Rectangle	JBOX Junction Box

VERGE WALL WARM DIM 24VDC, PLASTER-IN LED SYSTEM

INSTALLATION

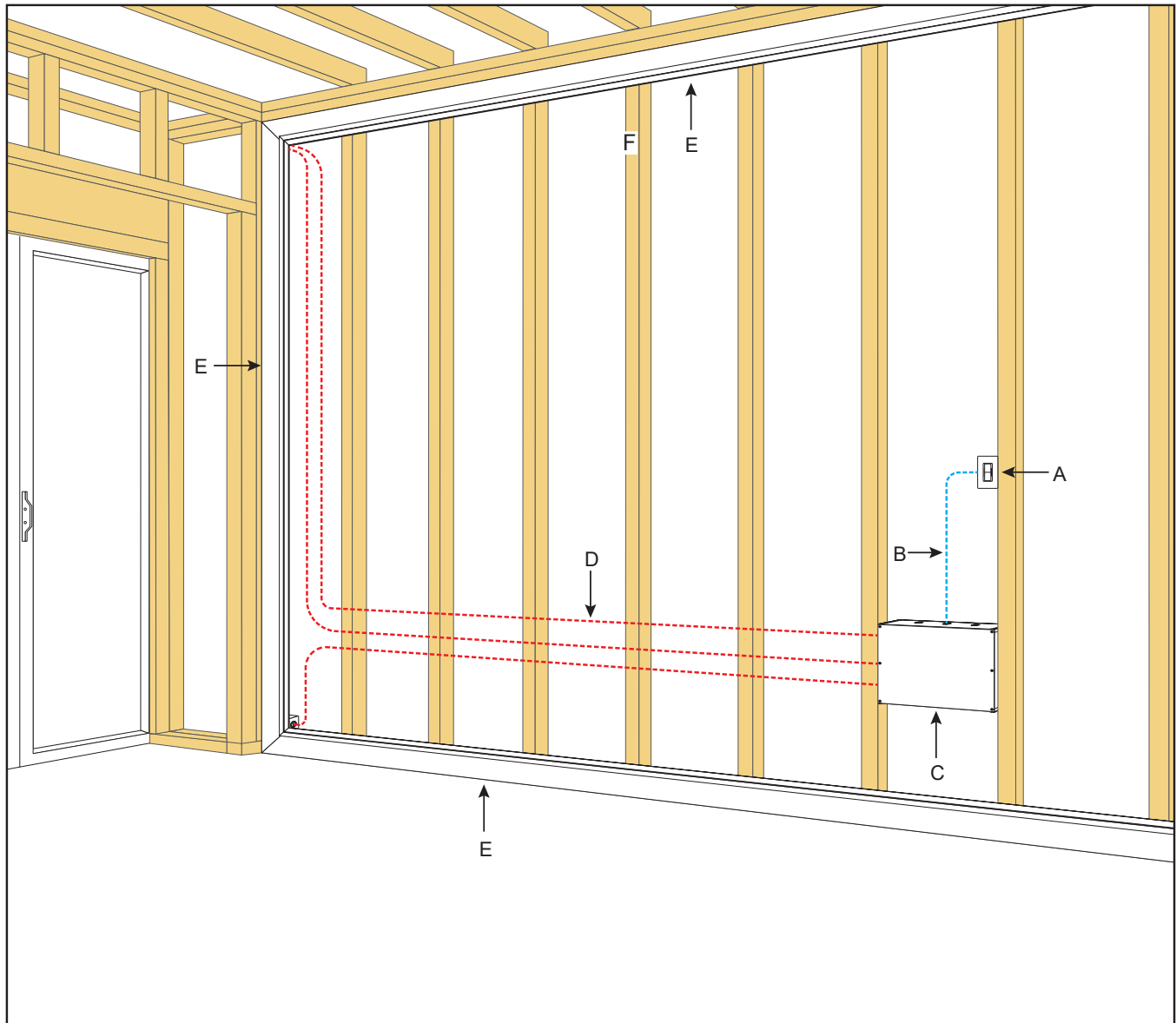

- A. DIMMER OR SWITCH**
- B. 120VAC WIRING**
- C. 120V/24VDC REMOTE POWER SUPPLY FOR IN-WALL MOUNTING KIT**
- D. 24VDC, CLASS 2 WIRING**
- E. VERGE WALL CHANNEL**
- F. LED STRIP**

PROJECT		FIXTURE TYPE		DATE	
---------	--	--------------	--	------	--

PURE SMART™ Wi-Fi DIMMER

FOR TRADITIONAL NON-SMART BULBS & FIXTURES CONNECTED BY WIZ PRO



DESCRIPTION

The Pure Smart™ Wi-Fi dimmer works with non-smart bulbs and fixtures compatible with forward phase or Triac dimming(not compatible with 0-10V Dimming). Smart Wi-Fi Dimmer also allows for scheduling, grouping, voice control and control from anywhere via the WiZ app on your mobile device or the WiZ Pro Dashboard on your desktop.

OPERATION*

Features an ON/OFF switch and dimming functionality activated with a long press of the On (Brightness Up) or Off (Brightness Down) button. 400W Maximum Incandescent load, 150W CFL and/or retrofit LED bulb. Minimum trim and fade in/out settings are adjusted in the WiZ App. Communicates over 2.4 GHz Wi-Fi only. If remote power is being used, this dimmer is only compatible with PureEdge Universal Power Supplies. No Hub Required.

*When dimming traditional CFL/LEDs, ensure they are marked as dimmable.

BODY

Durable polycarbonate body. Compatible with decorator style wall plate (Not Included)

EASY INSTALLATION

The Pure Smart™ Wi-Fi Dimmer installs just like a regular in-wall switch. Works with any non-smart Static CCT or Warm Dim bulb/ fixture compatible with forward phase or Triac dimming. Can be used in 3-way applications with [Pure Smart Room Controllers](#) as companions only (Reference Manual for Wiring Diagram). Compatible with standard gangable boxes. Requires neutral wire. No Hub Required.

WIZ APP

The Pure Smart™ Dimmer can be controlled via the WiZ app (works with iOS and Android) from anywhere. Voice control enabled when used in conjunction with Google Assistant, Siri, Alexa, IFTTT, and SmartThings. Grouping, zoning, and scheduling can all be programmed with the WiZ app or WiZ Pro Dashboard.

SECURITY

3rd party log-in and cloud security provide a safe and protected connection. WiZ does not store nor share any personal information.

SPECIFICATIONS

Approved Location	Dry / Indoor
Input Voltage	120Vac - 60 Hz
Certification	cULus, FCC
Compatible Load(s)	Any non-smart bulb or fixture *Triac, ELV (Reverse Phase/ Trailing Edge dimming) and MLV (Forward Phase/Leading Edge Dimming) only
Maximum Power	Incandescent: 400W Compact Fluorescent (CFL): 150W LED: 150W
Dimming	Dims to 1% with app trim setting at 30%
Operating Temperature	23°F~113°F (-5°C~45°C)
Wireless Frequency	2.4GHz
Radio Frequency	Certified IEEE 802.11, Wi-Fi 2.4Ghz radio
Wireless Standard	IEEE 802.11
Warranty	3-Year

Product	Type	Finish
SWW	DIM	WH
SWW Pure Smart Wall WIZ Pro Connected	DIM Dimmer	WH White

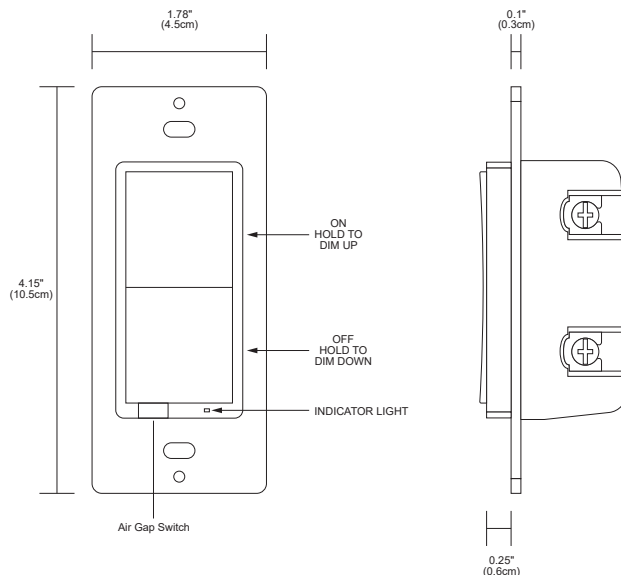

PROJECT		FIXTURE TYPE		DATE	
---------	--	--------------	--	------	--

TM30 DATA
24VDC, PLASTER-IN LED SYSTEM

TM-30-15 DATA: The data below is for bare LED Warm Dim Strip. Consistent color temperatures throughout a single strip and among multiple strips is possible through a 3 phase binning process in which each order is inspected with a color meter to ensure uniformity.

2700D | Rf: 90.7 | Rg: 101.1
Color Vector Graphic

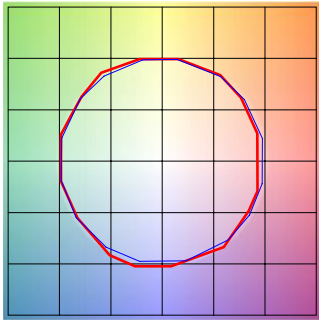

Test Reference

Table with 4 columns: HUE BIN, Rf, CHROMA, HUE. Rows 1-16 showing color shift data for 2700D.

3000D | Rf: 90.6 | Rg: 101.1
Color Vector Graphic

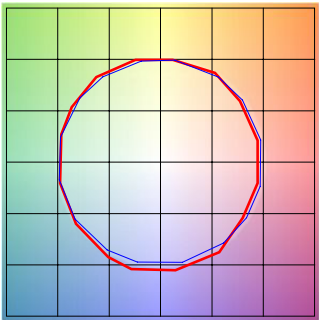

Test Reference

Table with 4 columns: HUE BIN, Rf, CHROMA, HUE. Rows 1-16 showing color shift data for 3000D.