

DESCRIPTION

TruTrack® is a patented, recessed 24VDC two circuit track (one circuit - track, second circuit - LED strip) with a linear plaster-in LED system that is only as thick as the 5/8" drywall, eliminating the concern of running into studs or joists, and allowing complete flexibility to make turns along ceilings and walls. For custom quotes and layout assistance, send your drawings and ideas to our design team: design@PureEdgeLighting.com.

FEATURES

- Designed for combining recessed Track Spots and LED Strip for a clean modern look. System may be switched and dimmed as a Single Circuit or separately as a 2-Circuit System. Remote power supply can be located up to 40ft away from the power feed.
- Linear Plaster-in LED and Track System can be installed on a single surface (Wall or Ceiling), or on multiple surfaces going from the Wall to the Ceiling.
- Pre-Formed components will help you to create desired configurations including Picture Frame and Room Wrapping Installations
- LED Soft Strip is sold in 1' increments 40' maximum length, up to 96 watts supply before re-feeding.
- Track Head Lumen Output up to 1256 Lumens with multiple fixed and adjustable beam spread options.
- Track Power Feeds may be ordered in End, Center, L, T and X configurations running up to 96 watts before re-feeding.
- Recessed TruTrack® Channel is available in 2', 4', 6' and 8' field-cutttable lengths.
- Two White Plastic Opaque Slot Covers are included to protect and seal the inside of the track from dust and paint during the installation process. One Transparent Lens Slot cover is used to diffuse the output of the integrated LED strip and eliminate pixelation.
- #10 Gauge Busbar to help eliminate voltage drop.

FINISH & MATERIAL

- White Powder Coat Paint
- Extruded Aluminum Channel, conductors are a pair of #10 AWG Copper Busbar

TRACK FIXTURES AND INTEGRAL LED STRIP

- **Track Heads:** Static White - 24K, 27K, 30K, & 35K
Warm Dim - 30D (3000K-1800K)
- **Integral LED Strip:** Static White 24K - 40K
Warm Dim - 27D (2700K-1800K) & 30D (3000K-1800K)

REMOTE POWER SUPPLY AND DIMMING (SOLD SEPARATELY)

See [Page 7](#) For LED Strip Specific Power Supplies
24VDC, Class 2 wiring

Track Heads

- [Uni Trim Power Supply](#) Universal Dimming (TRIAC, ELV, 0-10V)
ELV & TRIAC [Smart Dimmer & Switch](#)

APPLICATIONS

Indoor use only. Ideal applications in residential, commercial, retail and hospitality environments.

WARRANTY / LABELS

5 year pro-rated warranty. Assembled in America
ETL (Conforms to UL 1598 and 2108 and CSA 22.2 #250.0), Class 2

PureEdge is the Original Designer of 5/8" Drywall Products, Backed by Over 30 Years of Precision Manufacturing and Design.

| | | | | | |
|---------|--|--------------|--|------|--|
| PROJECT | | FIXTURE TYPE | | DATE | |
|---------|--|--------------|--|------|--|



DUAL SOURCE RECESSED 24VDC TRACK

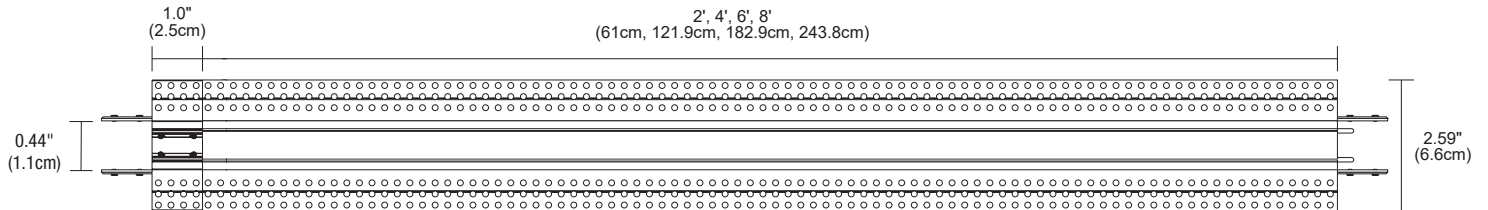

DUAL SOURCE

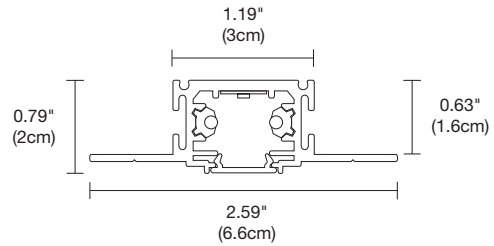
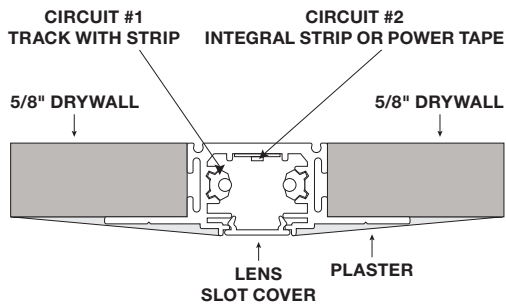

DUAL SOURCE TRACK

Made of extruded Aluminum Channel with #10 AWG Bus Bar for Track circuit #1 and with 4oz Copper Power tape to connect Soft Strip Circuit #2. Includes TR24-SC2 connector. LED Soft Strip must be ordered separately. Designed for use with two separate 24VDC Remote Power Supplies (Sold Separately). Includes one Mudding Cover and one Paintable Cover, one Opaque Slot Cover for Track Slot and one Diffused Slot for LED Soft Strip and track joiner.

| System | Circuit | Length in Feet | Color |
|-------------------------|---|--------------------------|-----------------------|
| TR24 | DS | 8FT | WH |
| TR24 TruTrack® Recessed | DS Dual Source for Track with LED strip | 2FT 4FT 6FT 8FT | WH White Powder Paint |

| | | |
|---------|--------------|------|
| PROJECT | FIXTURE TYPE | DATE |
|---------|--------------|------|

COMPONENTS

END POWER FEED WITH JUNCTION BOX FOR 5/8" DRYWALL

2" starter section included. Feed 24VDC Track up to 96 watts and 96 watts for LED Strip. May be used on cement ceiling with only 5/8" dry wall. (J-Box not used).

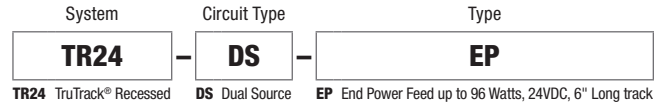
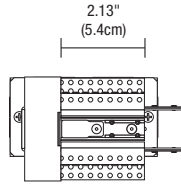

CENTER POWER FEED WITH JUNCTION BOX FOR 5/8" DRYWALL

3" starter section included, feed 5 track up to 2x 96 watts 24VDC and LED strip 2x96 watts.

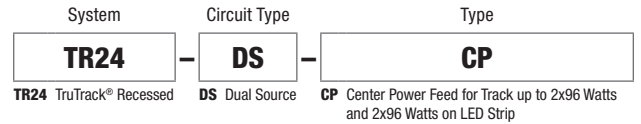
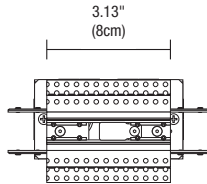

L-SHAPED POWER CONNECTOR FOR 5/8" DRYWALL WITH JUNCTION BOX

Feeds track up to 2x96 watts 24VDC and LED strip up to 2x96 watts.

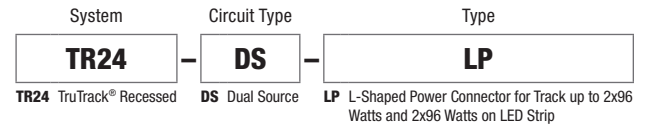
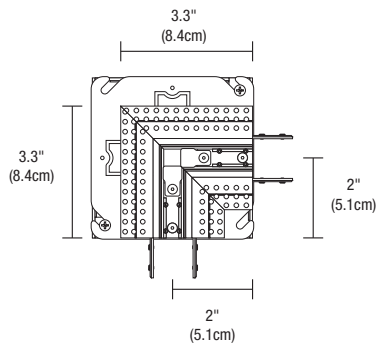

L-CONNECTOR

Conductive or Non-Conductive L-Connector joins two straight TruTrack® Channels together to make a 90° angle. Order Non-Conductive when adding two Power Supplies in a square configuration. Track head can be placed on this portion of track.

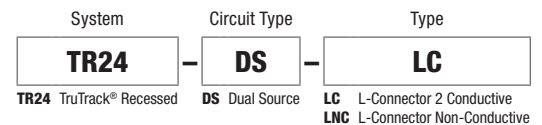
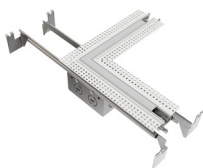
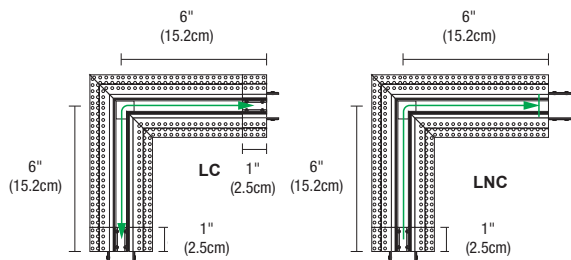

| | | | | | |
|---------|--|--------------|--|------|--|
| PROJECT | | FIXTURE TYPE | | DATE | |
|---------|--|--------------|--|------|--|

COMPONENTS (Cont'd)

T-SHAPE POWER FEED WITH JUNCTION BOX FOR 5/8" DRYWALL

Feeds track up to 3x96 watts 24VDC and LED strip up to 3x96 watts.

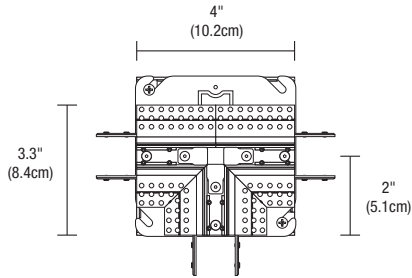

| System | Circuit Type | Type |
|-------------------------|----------------|--|
| TR24 | DS | TP |
| TR24 TruTrack® Recessed | DS Dual Source | TP T-Shaped Power Triple Feed for Track up to 3x96 Watts and 3x96 Watts on LED Strip |

X-SHAPE POWER FEED WITH JUNCTION BOX FOR 5/8" DRYWALL

Feeds track up to 4x96 watts 24VDC and LED strip up to 4x96 watts.

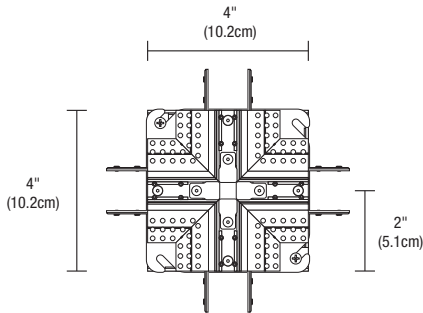

| System | Circuit Type | Type |
|-------------------------|----------------|--|
| TR24 | DS | XP |
| TR24 TruTrack® Recessed | DS Dual Source | XP X-Shaped Power Quad Feed for Track up to 4x96 Watts and 4x96 Watts on LED Strip |

TRANSPARENT LENS SLOT COVER FOR LED SOFT STRIP (INCLUDED)

One included with each TruTrack® Recessed track order. Use Slot Cover for LED Soft Strip to give you a clean Line of Light any where along the Track. No LED dots. Field Cuttable.



| System | Type | Length in Feet | Color |
|--------------------------|-----------------------------|----------------|-------------------------------|
| T24 | SCT | 8FT | DW |
| T24 Track Recessed 24VDC | SCT Slot Cover, Transparent | 8FT 8' | DW Diffused Translucent White |

OPAQUE SLOT COVER, PAINTABLE (INCLUDED)

One paintable Plastic Slot Cover Included with each TruTrack® Recessed Track. Field Cuttable.

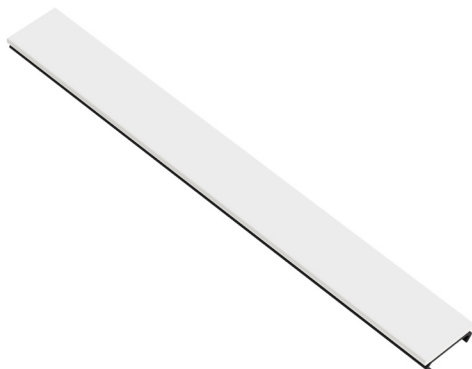

| System | Type | Length in Feet | Color |
|--------------------------|------------------------|----------------|-----------------|
| T24 | SCO | 8FT | WH |
| T24 Track Recessed 24VDC | SCO Slot Cover, Opaque | 8FT 8' | WH Opaque White |

| | | | | | |
|---------|--|--------------|--|------|--|
| PROJECT | | FIXTURE TYPE | | DATE | |
|---------|--|--------------|--|------|--|

COMPONENTS (Cont'd)



MUDDING COVER, OPAQUE SLOT COVER (INCLUDED)

Mud cover used in installation to keep plaster out of track. Included with track.

| System | Type | Length in Feet | Color |
|--------------------------|------------------------|----------------|-----------------|
| T24 | COV | 8FT | WH |
| T24 Track Recessed 24VDC | COV Mudding Slot Cover | 8FT 8' | WH Opaque White |

END CAP

To be ordered with each dead end of TR24 Track System, can be used as a take up receptacle for extra soft strip.

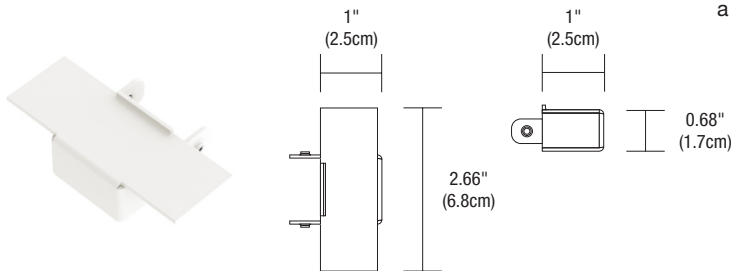

| System | Type | Color |
|-------------------------|------------|----------------|
| TR24 | CA | WH |
| TR24 TruTrack® Recessed | CA End Cap | WH White Cover |

24V TRACK INLINE STRAIGHT SEAMLESS CONNECTOR, CONDUCTIVE

Order when cutting and joining a Track. Includes 2" Opaque and Transparent Slot Cover.

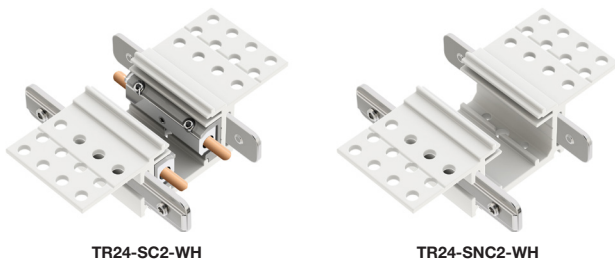

| System | Connector Type | Color |
|---------------------------|---|-----------|
| TR24 | SC2 | WH |
| TR24 Track Recessed 24VDC | SC2 Seamless Connector, Conductive SNC2 Straight Connector, Non-Conductive | WH White |

L-CONNECTOR (ORDER SEPARATELY)

The Soft Strip L-Connector physically and electrically join two Soft Strip sections and 90° on a horizontal plane (includes one male joiner). Order Separately.

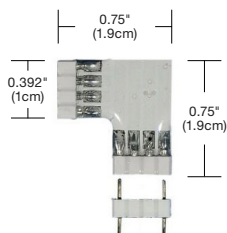

| Product | Type |
|---------------|-----------------------------------|
| SS | CL10M |
| SS Soft Strip | CL10M L-Connector 10MM Soft Strip |

| | | |
|---------|--------------|------|
| PROJECT | FIXTURE TYPE | DATE |
|---------|--------------|------|

COMPONENTS (Cont'd)



1FT, 2FT, 4FT

POWER TAPE CONNECTOR (ORDER SEPARATELY)

The Power Tape Connector has no LEDs and will Link two sections of soft strip together. Use OPAQUE Paintable SLOT COVER, (INCLUDED) to hide tape. Features a 3M adhesive back and links two sections of Soft Strip. No LEDs on this strip. Fold strip for exact length.

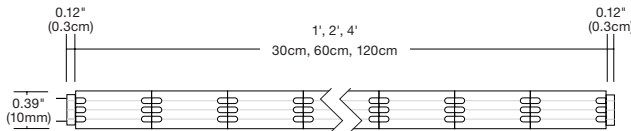

| Product | Type | Size |
|---------------|--|--|
| SS | CPT10MM | 1FT |
| SS Soft Strip | CPT10MM Power Tape Connector 10MM Wide | 1FT 1 Foot 2FT 2 Foot 3FT 3 Foot |

3 POSITION POWER FEED CONNECTOR (INCLUDED WITH POWER FEED CONNECTORS)

SS-10MM-PFE-8IN

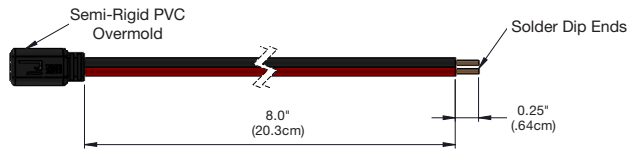

**(SS-10MM-PFE-8IN)
POWER FEED**

| System | Type | Connector | Length |
|---------------|-------------|----------------|------------|
| SS | 10MM | PFE | 8IN |
| SS Soft Strip | 10MM 10 mm | PFE Power Feed | 8IN 8" |

| | | | | | |
|---------|--|--------------|--|------|--|
| PROJECT | | FIXTURE TYPE | | DATE | |
|---------|--|--------------|--|------|--|

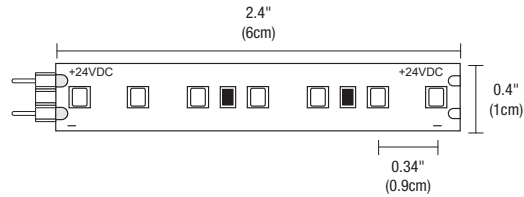

CAN'T STOMP ME OUT

Our Low Voltage 24VDC LED Stomp Strip is highly durable, designed to withstand the harsh elements of a job site, and precision engineered to provide superior color rendering with up to 94+ CRI. STR_A 2 Pin Stomp Strip is Only compatible TruTrack® and Pipeline® Track with UpLight. For custom quotes and layout assistance, send your drawings and ideas to our design team: design@PureEdgeLighting.com.

FEATURES & BENEFITS

- Pin Connectors reduce time and labor during installation
- Developed to meet popular demand for resilient performance without sacrificing output, color rendering and efficacy
- Tolerance: Created to resist damage in rigorous environments such as busy commercial jobsites
- Compact LED spacing: Produce uniform light distribution without visible diodes or hot spots when used within a diffused lens
- 4oz Layer of Copper Busbar: Provides superior heat dissipation and less voltage drop equivalent to 14AWG wire
- Premium Coating: Optically Clear Silicone prevents fading over time
- Mounting: Industrial 3M tape lined strip for strong, self-adhesion to most smooth, finished surfaces
- Suitable for indoor damp locations
- Warranty: Includes a 5-year pro-rated warranty

SPECIFICATIONS

- 24VDC, 120-277VAC Input
- 2.5, 4.4 or 7.3 watts per foot
- Sold in 1' increments
- Field-cutttable in 2.4" increments
- Operating temperature: -22°F to 140°F (-30°C to 60°C)

LAMP

- Offered in multiple Static White Color Temperatures: 2400K, 2700K, 3000K, 3500K & 4000K
- Average life: 50,000 hours

REMOTE POWER SUPPLIES*, DIMMING & CONTROLS (SOLD SEPARATELY)

24VDC, Class 2 wiring

- [Home Integration Solutions](#)
- [WiZ Pro Connected, Pure Smart™ Power Supplies & Controls](#)
- [UNI Driver: Universal Dimming \(TRIAC, ELV, 0-10V\)](#) ELV & TRIAC [Smart Dimmer & Switch](#)

*In-Wall Mounting Kits available for select power supplies

MAXIMUM LENGTHS BEFORE RE-FEEDING

- 2WDC, 2.5 watts per foot - 40'
- 5WDC, 4.4 watts per foot - 20'
- 7WDC, 7.3 watts per foot - 12'

COMPATIBLE FIXTURES & SYSTEMS

- TruTrack®
- Pipeline® Track with up light

APPROVALS

Class 2 Wiring up to 100 watts, Damp Location Suitable, ETL listed

| WATTS PER FOOT | STR2A | | | | | | STR5A | | | | | | STR7A | | | | | |
|-------------------------|-------|-----|-----|-----|-----|-----|-------|-----|-----|-----|-----|-----|-------|-----|-----|-----|-----|------|
| | 2.5W | | | | | | 4.4W | | | | | | 7.3W | | | | | |
| COLOR TEMPERATURE | 22K | 24K | 27K | 30K | 35K | 40K | 22K | 24K | 27K | 30K | 35K | 40K | 22K | 24K | 27K | 30K | 35K | 40K |
| LUMENS PER FOOT (lm/ft) | 284 | 284 | 287 | 299 | 343 | 362 | 525 | 525 | 531 | 553 | 634 | 669 | 811 | 811 | 820 | 854 | 980 | 1033 |
| LUMENS PER WATT (lm/w) | 114 | 114 | 115 | 120 | 137 | 145 | 119 | 119 | 121 | 126 | 144 | 152 | 111 | 111 | 112 | 117 | 134 | 142 |
| CRI | 92+ | 92+ | 92+ | 92+ | 92+ | 92+ | 92+ | 92+ | 92+ | 92+ | 92+ | 92+ | 92+ | 92+ | 92+ | 92+ | 92+ | 92+ |

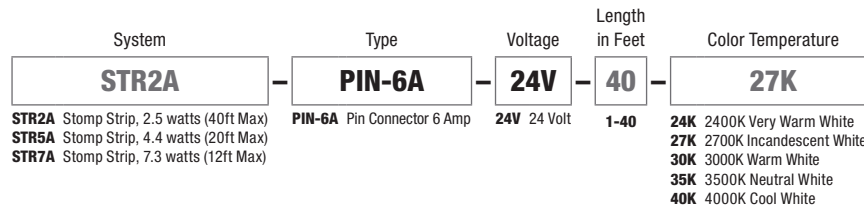

| | | |
|---------|--------------|------|
| PROJECT | FIXTURE TYPE | DATE |
|---------|--------------|------|

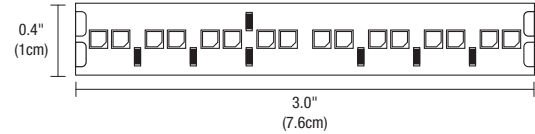
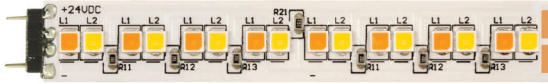

CAN'T STOMP ME OUT

Our Low Voltage Stomp Strip is highly durable, designed to withstand the harsh elements of a job site, and precision engineered to provide superior color rendering up to 94+ CRI. Warm Dim technology (**27D** & **30D**) mimics an incandescent atmosphere by decreasing the color temperature as you dim. Our Warm Dim strips can be dimmed all the way down to a soothing amber hue at 1800K, reminiscent of candlelight along the halogen curve. STR5A Stomp Strip is Only compatible TruTrack® and Pipeline® Track with UpLight. For custom quotes and layout assistance, send your drawings and ideas to our design team: design@PureEdgeLighting.com.

FEATURES & BENEFITS

- Offered with Pin Connectors reducing time and labor during installation
- Developed to meet popular demand for resilient performance without sacrificing output, color rendering and efficacy
- Tolerance: Created to resist damage in rigorous environments such as busy commercial jobsites
- Compact LED spacing: Produce uniform light distribution without visible diodes or hot spots when used within a diffused lens
- 4oz Layer of Copper Busbar: Provides superior heat dissipation and less voltage drop equivalent to 14AWG wire
- Premium Coating: Optically Clear Silicone prevents fading over time
- Mounting: Industrial 3M tape lined strip for strong, self-adhesion to most smooth, finished surfaces
- Suitable for indoor damp locations
- Warranty: Includes a 5-year pro-rated warranty

SPECIFICATIONS

- 24VDC
- 4.8 watts per foot
- Sold in 1' increments
- Field-cutttable in 3" increments
- Operating temperature: -22°F to 140°F (-30°C to 60°C)
- Maximum length before re-feeding - 20'

LAMP

- **27D** dims from 2700K down to 1800K, and **30D** dims from 3000K down to 2000K, resembling incandescent light sources.
- Average life: 50,000 hours

COMPATIBLE FIXTURES & SYSTEMS

- TruTrack®
- Pipeline® Track with up light

REMOTE POWER SUPPLIES*, DIMMING & CONTROLS (SOLD SEPARATELY)

24VDC, Class 2 wiring

- [Home Integration Solutions](#)
- [UNI Driver: Universal Dimming \(TRIAC, ELV, 0-10V\)](#)
ELV & TRIAC [Smart Dimmer & Switch](#)

*In-Wall Mounting and drop ceiling kits available for select power supplies

APPROVALS

Class 2 Wiring up to 100 watts, Damp Location Suitable, ETL listed.

| | ST5A | |
|-------------------------|------|-----|
| WATTS PER FOOT | 4.8W | |
| COLOR TEMPERATURE | 27D | 30D |
| LUMENS PER FOOT (lm/ft) | 606 | 631 |
| LUMENS PER WATT (lm/w) | 126 | 131 |
| CRI | 94+ | 94+ |

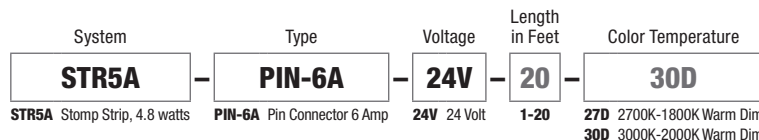

| | | |
|---------|--------------|------|
| PROJECT | FIXTURE TYPE | DATE |
|---------|--------------|------|

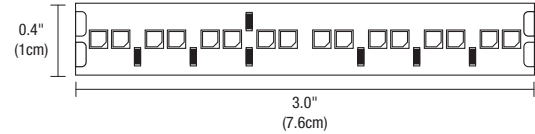
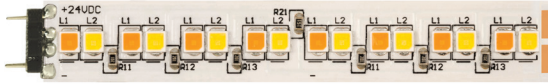

CAN'T STOMP ME OUT

Our Low Voltage Stomp Strip is highly durable, designed to withstand the harsh elements of a job site, and precision engineered to provide superior color rendering up to 94+ CRI. Warm Dim technology (**27D** & **30D**) mimics an incandescent atmosphere by decreasing the color temperature as you dim. Our Warm Dim strips can be dimmed all the way down to a soothing amber hue at 1800K, reminiscent of candlelight along the halogen curve. STR5A Stomp Strip is Only compatible TruTrack® and Pipeline® Track with UpLight. For custom quotes and layout assistance, send your drawings and ideas to our design team: design@PureEdgeLighting.com.

FEATURES & BENEFITS

- Offered with Pin Connectors reducing time and labor during installation
- Developed to meet popular demand for resilient performance without sacrificing output, color rendering and efficacy
- Tolerance: Created to resist damage in rigorous environments such as busy commercial jobsites
- Compact LED spacing: Produce uniform light distribution without visible diodes or hot spots when used within a diffused lens
- 4oz Layer of Copper Busbar: Provides superior heat dissipation and less voltage drop equivalent to 14AWG wire
- Premium Coating: Optically Clear Silicone prevents fading over time
- Mounting: Industrial 3M tape lined strip for strong, self-adhesion to most smooth, finished surfaces
- Suitable for indoor damp locations
- Warranty: Includes a 5-year pro-rated warranty

SPECIFICATIONS

- 24VDC
- 4.8 watts per foot
- Sold in 1' increments
- Field-cutttable in 3" increments
- Operating temperature: -22°F to 140°F (-30°C to 60°C)
- Maximum length before re-feeding - 20'

LAMP

- **27D** dims from 2700K down to 1800K, and **30D** dims from 3000K down to 2000K, resembling incandescent light sources.
- Average life: 50,000 hours

COMPATIBLE FIXTURES & SYSTEMS

- TruTrack®
- Pipeline® Track with up light

REMOTE POWER SUPPLIES*, DIMMING & CONTROLS (SOLD SEPARATELY)

24VDC, Class 2 wiring

- [Home Integration Solutions](#)
- [UNI Driver: Universal Dimming \(TRIAC, ELV, 0-10V\)](#)
ELV & TRIAC [Smart Dimmer & Switch](#)

*In-Wall Mounting and drop ceiling kits available for select power supplies

APPROVALS

Class 2 Wiring up to 100 watts, Damp Location Suitable, ETL listed.

| | ST5A | |
|-------------------------|------|-----|
| WATTS PER FOOT | 4.8W | |
| COLOR TEMPERATURE | 27D | 30D |
| LUMENS PER FOOT (lm/ft) | 606 | 631 |
| LUMENS PER WATT (lm/w) | 126 | 131 |
| CRI | 94+ | 94+ |

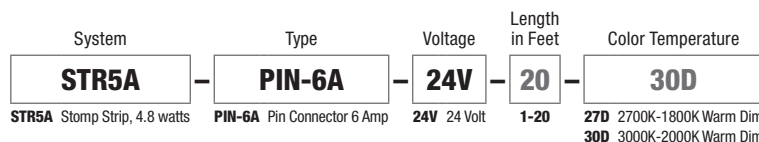

| | | |
|---------|--------------|------|
| PROJECT | FIXTURE TYPE | DATE |
|---------|--------------|------|

TRUTRACK® DUAL SOURCE WITH INTEGRAL LED STRIP

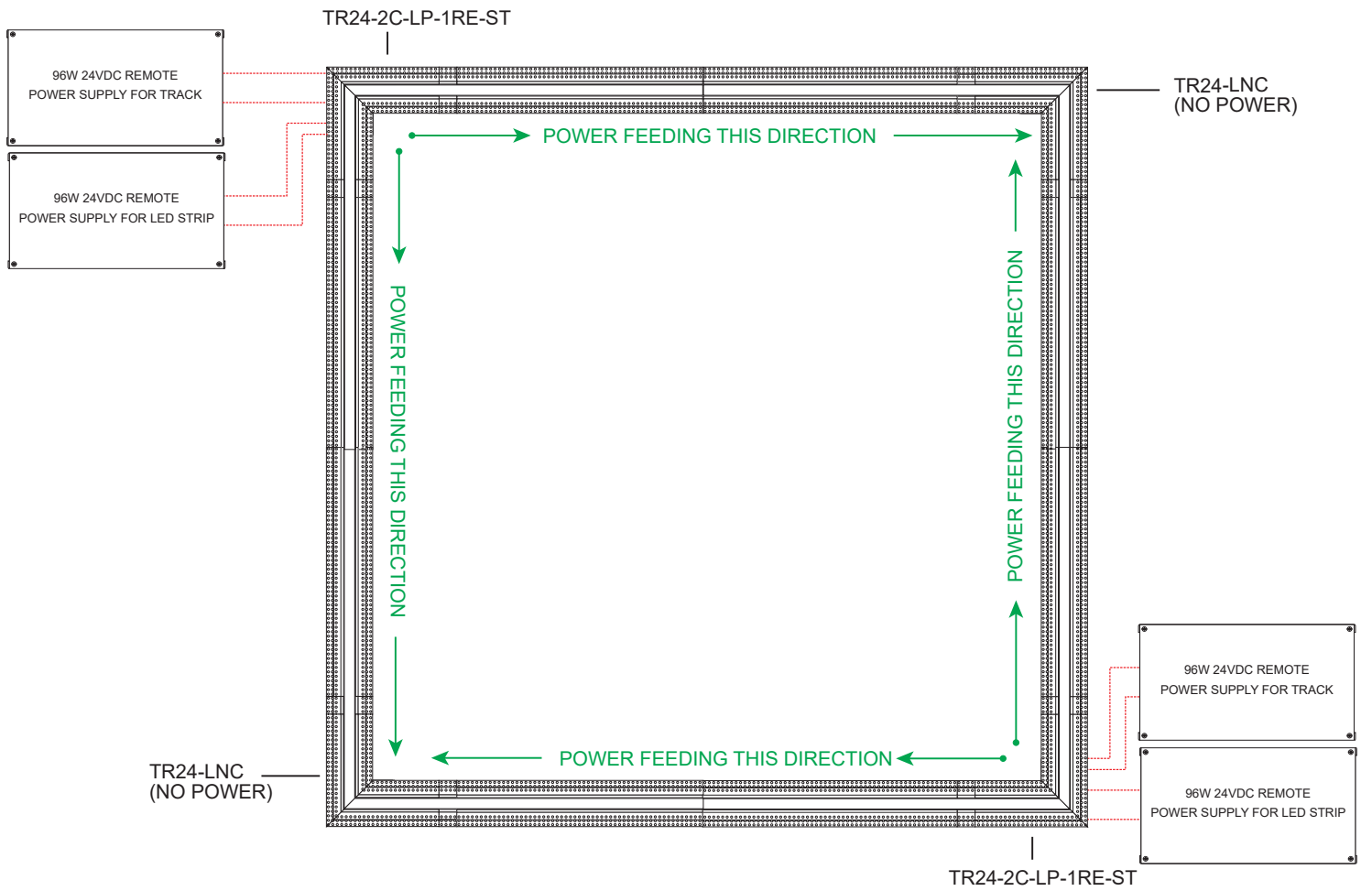
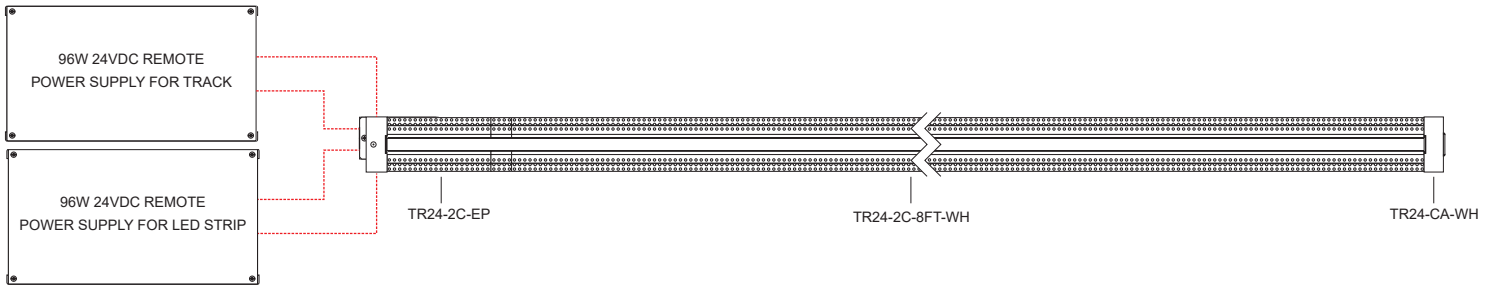

| | | | | | |
|---------|--|--------------|--|------|--|
| PROJECT | | FIXTURE TYPE | | DATE | |
|---------|--|--------------|--|------|--|

T24 TRACK HEADS

24VDC WITH INTEGRATED LED, STATIC WHITE & WARM DIM TECHNOLOGY

PureEdge T24 Track Heads are Compatible with TruTrack® (TR24).

All uniform beam spread options are field changeable. See accessories page for more information.

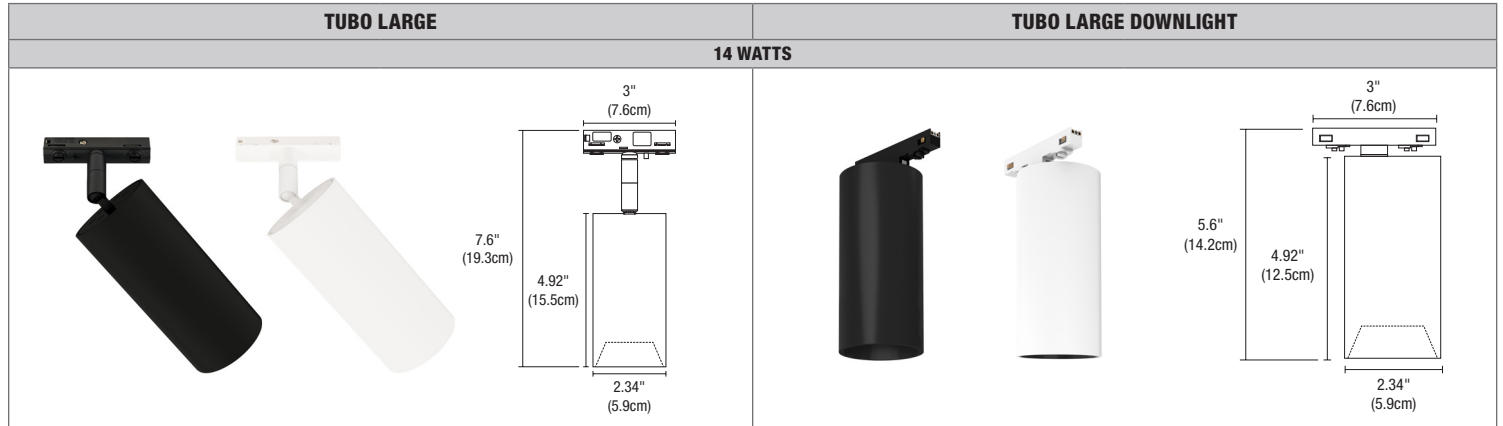

| | | | | |
|----------------------|---|---|--|--|
| System | Fixture | Beam Spread | Color Temperature | Finish |
| T24 | TUBL | FL | 30K | WH |
| T24 24V Track System | TUBL Tubo Large TUBLD Tubo Large Downlight | NS Narrow Spot 10° SP Spot 20° NF Narrow Flood 35° FL Flood 45° WF Wide Flood 60° For 7° use STB16 snoot with NS | 24K 2400K Very Warm White 27K 2700K Incandescent White 30D 3000D Warm Dim 30K 3000K Warm White 35K 3500K Neutral White 30D NS: 7.5W, 400 lumens | BK Black Powder Coat WH Warm White Powder Coat RAL 9010 PW Pure White Powder Coat RAL 9016 |

| BEAM ANGLE REFERENCE 45° | | | | | |
|--------------------------|----------------------|-----------------------|----------------------|-----------------------|-----------------------|
| COLOR TEMPERATURE | 24K | 27K | 30K | 30D | 35K |
| TOTAL LUMENS | 1238 | 1035 | 1069 | 683 | 1268 |
| WATTS | 14 | 14 | 14 | 14 | 14 |
| LUMENS PER WATT (lm/w) | 88 | 74 | 76 | 49 | 91 |
| CRI | 97 | 92 | 91 | 97 | 98 |
| TM-30 DATA | R9: 60 Rf: 93 Rg: 98 | R9: 97 Rf: 92 Rg: 100 | R9: 64 Rf: 91 Rg: 98 | R9: 90 Rf: 95 Rg: 102 | R9: 92 Rf: 94 Rg: 101 |

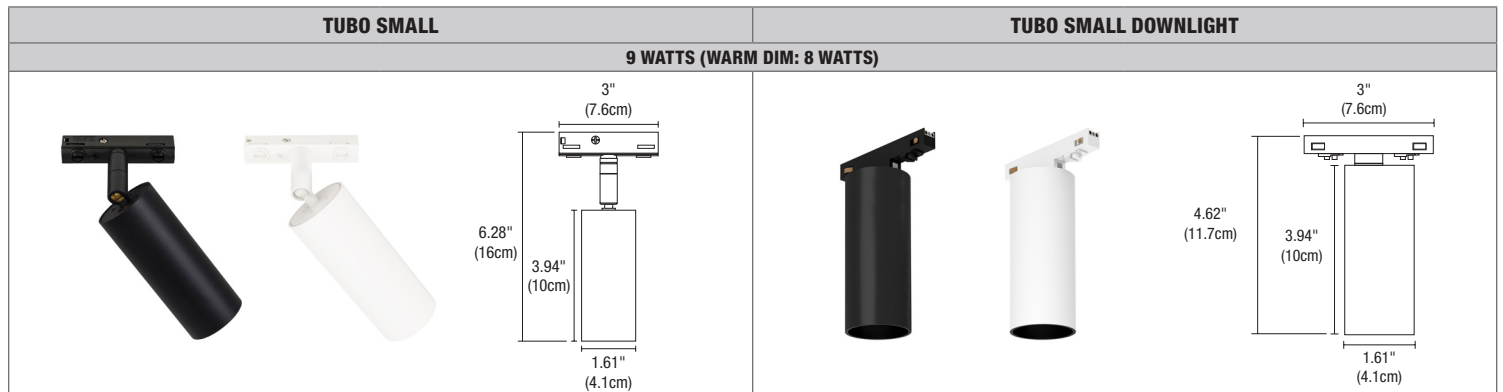

| | | | | |
|----------------------|---|---|--|--|
| System | Fixture | Beam Spread | Color Temperature | Finish |
| T24 | TUBS | FL | 30K | WH |
| T24 24V Track System | TUBS Tubo Small TUBSD Tubo Small Downlight | NS Narrow Spot 15° SP Spot 25° NF Narrow Flood 35° FL Flood 45° WF Wide Flood 60° For 7° use TUBS-ST snoot with NS | 24K 2400K Very Warm White 27K 2700K Incandescent White 30D 3000D Warm Dim 30K 3000K Warm White 35K 3500K Neutral White | BK Black Powder Coat WH White Powder Coat |

| BEAM ANGLE REFERENCE 45° | | | | | |
|--------------------------|----------------------|-----------------------|----------------------|-----------------------|-----------------------|
| COLOR TEMPERATURE | 24K | 27K | 30K | 30D | 35K |
| TOTAL LUMENS | 503 | 420 | 434 | 287 | 515 |
| WATTS | 9 | 9 | 9 | 8 | 9 |
| LUMENS PER WATT (lm/w) | 59 | 49 | 51 | 39 | 61 |
| CRI | 97 | 92 | 93 | 94 | 98 |
| TM-30 DATA | R9: 60 Rf: 93 Rg: 98 | R9: 97 Rf: 92 Rg: 100 | R9: 64 Rf: 91 Rg: 98 | R9: 90 Rf: 95 Rg: 102 | R9: 92 Rf: 94 Rg: 101 |

All track heads with the exception of Tubo Wall Wash and Zoom are JAB listed with universal power supplies in 27K> CCT. Click the link to access our full Title 24 compliance listings: pureedgelighting.com/resources

| | | | | | |
|---------|--|--------------|--|------|--|
| PROJECT | | FIXTURE TYPE | | DATE | |
|---------|--|--------------|--|------|--|

T24 TRACK HEADS

24VDC WITH INTEGRATED LED, STATIC WHITE & WARM DIM TECHNOLOGY

TUBO LARGE WALL WASH

15 WATTS

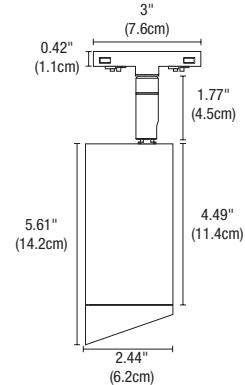

System: **T24** — Fixture: **TUBL** — Beam Spread: **WW** — Color Temperature: **30K** — Finish: **BK**

- T24** Track Head 24V
- TUBL** Tubo Large
- WW** Wall Wash
- 24K** 2400K Very Warm White
- 27K** 2700K Incandescent White
- 30K** 3000K Warm White
- 30D** 3000K Warm Dim to 1800K
- 35K** 3500K Neutral White
- BK** Black Powder Coat
- WH** Warm White Powder Coat RAL 9010
- PW** Pure White Powder Coat RAL 9016

| TUBO WALL WASH | |
|------------------------|-----------------------|
| COLOR TEMPERATURE | 30K |
| TOTAL LUMENS | 884 |
| WATTS | 15 |
| LUMENS PER WATT (lm/w) | 59 |
| CRI | 92 |
| TM-30 DATA | R9: 61 Rf: 92 Rg: 100 |

ZOOM

16 WATTS

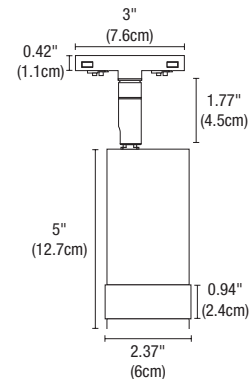
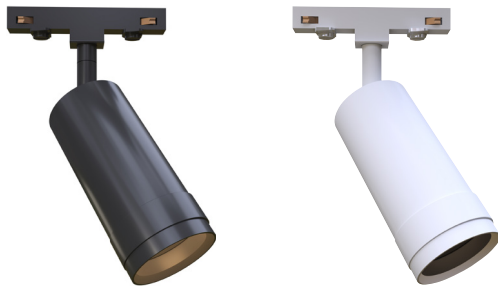

System: **T24** — Fixture: **ZOOM** — Beam Spread: **Z2** — Color Temperature: **30K** — Finish: **BK**

- T24** Track Head 24V Connector
 - ZOOM** Zoom
 - Z1** Zoom Adjust 15° to 55°
 - Z2** Zoom Adjust 20° to 50°
 - 24K** 2400K Very Warm White
 - 27K** 2700K Incandescent White
 - 30K** 3000K Warm White
 - 30D** 3000K Warm Dim to 1800K*
 - 35K** 3500K Neutral White
 - BK** Black Powder Coat
 - WH** Warm White Powder Coat RAL 9010
- *Only available for Z2

| | Z1 | | Z2 | | Z2 | |
|------------------------|-----------------------|-----------------------|-----------------------|-----------------------|-----------------------|-----------------------|
| BEAM ANGLE | 15° | 55° | 20° | 50° | 20° | 50° |
| COLOR TEMPERATURE | 30K | 30K | 30K | 30K | 30D | 30D |
| TOTAL LUMENS | 686 | 873 | 795 | 1188 | 727 | 879 |
| WATTS | 16 | 16 | 16 | 16 | 15 | 15 |
| LUMENS PER WATT (lm/w) | 46 | 61 | 69 | 89 | 50 | 61 |
| CRI | 93 | 93 | 94 | 94 | 97 | 97 |
| TM-30 DATA | R9: 66 Rf: 92 Rg: 101 | R9: 66 Rf: 92 Rg: 101 | R9: 74 Rf: 92 Rg: 102 | R9: 74 Rf: 92 Rg: 102 | R9: 66 Rf: 94 Rg: 101 | R9: 66 Rf: 94 Rg: 101 |

| | | | | | |
|---------|--|--------------|--|------|--|
| PROJECT | | FIXTURE TYPE | | DATE | |
|---------|--|--------------|--|------|--|

T24 TRACK HEADS

24VDC WITH INTEGRATED LED, STATIC WHITE & WARM DIM TECHNOLOGY

REV 01.16.25

All uniform beam spread options are field changeable, see accessories page.

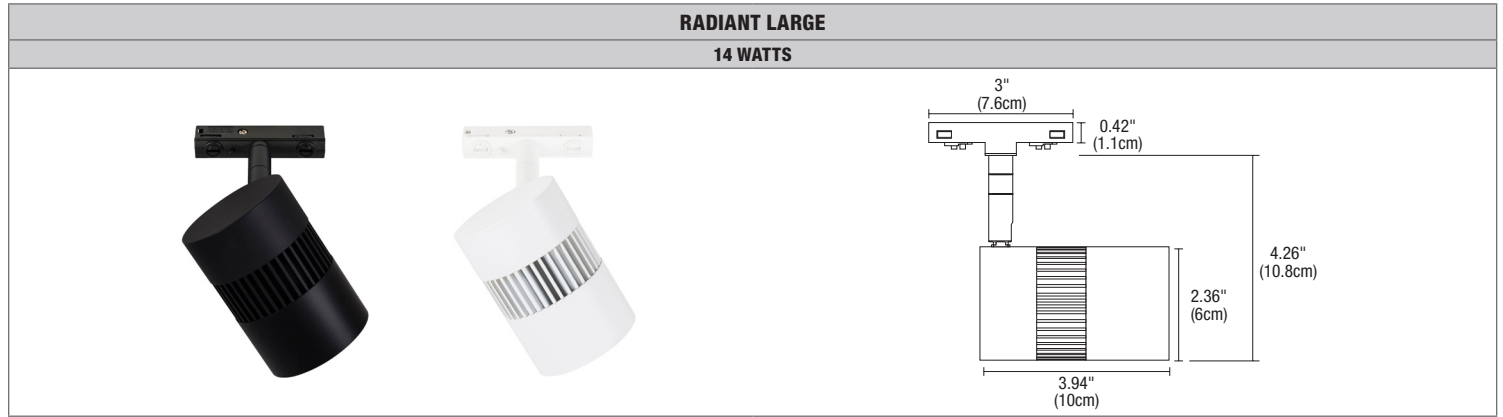

| | | | | |
|----------------------|--------------------|---|--|--|
| System | Fixture | Beam Spread | Color Temperature | Finish |
| T24 | RADL | FL | 30K | WH |
| T24 24V Track System | RADL Radiant Large | NS Narrow Spot 10° SP Spot 20° NF Narrow Flood 35° FL Flood 45° WF Wide Flood 60° Warm Dim: NS (15°), SP (25°) | 24K 2400K Very Warm White 27K 2700K Incandescent White 30K 3000K Warm White 30D 3000D Warm Dim* 35K 3500K Neutral White *Not available in NF | BK Black Powder Coat WH White Powder Coat |

| BEAM ANGLE REFERENCE 45° | | | | | |
|--------------------------|----------------------|-----------------------|----------------------|-----------------------|-----------------------|
| COLOR TEMPERATURE | 24K | 27K | 30K | 30D | 35K |
| TOTAL LUMENS | 1389 | 1161 | 1199 | 838 | 1422 |
| WATTS | 14 | 14 | 14 | 14 | 14 |
| LUMENS PER WATT (lm/w) | 99 | 83 | 86 | 58 | 102 |
| CRI | 97 | 92 | 93 | 97 | 98 |
| TM-30 DATA | R9: 60 Rf: 93 Rg: 98 | R9: 97 Rf: 92 Rg: 100 | R9: 64 Rf: 91 Rg: 98 | R9: 90 Rf: 95 Rg: 102 | R9: 92 Rf: 94 Rg: 101 |

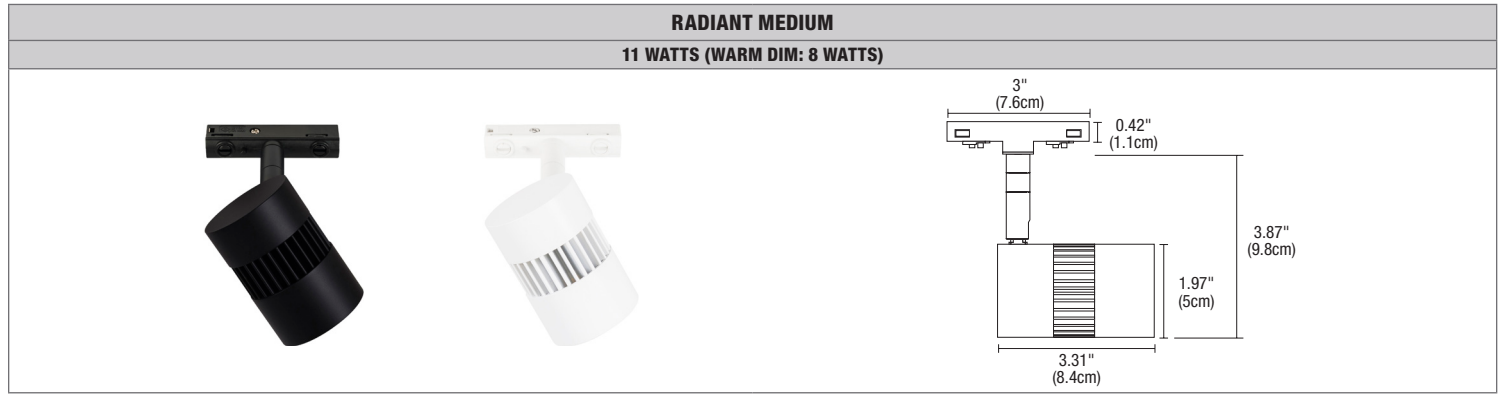

| | | | | |
|----------------------|---------------------|---|---|--|
| System | Fixture | Beam Spread | Color Temperature | Finish |
| T24 | RADM | FL | 30K | WH |
| T24 24V Track System | RADM Radiant Medium | SP Spot 20° NF Narrow Flood 35° FL Flood 45° WF Wide Flood 60° | 24K 2400K Very Warm White 27K 2700K Incandescent White 30K 3000K Warm White 30D 3000D Warm Dim 35K 3500K Neutral White | BK Black Powder Coat WH White Powder Coat |





| BEAM ANGLE REFERENCE 45° | | | | | |
|--------------------------|-----------------------|----------------------|-----------------------|-----------------------|-----------------------|
| COLOR TEMPERATURE | 24K | 27K | 30K | 30D | 35K |
| TOTAL LUMENS | 765 | 639 | 660 | 360 | 783 |
| WATTS | 11 | 11 | 11 | 7.7 | 11 |
| LUMENS PER WATT (lm/w) | 70 | 58 | 64 | 47 | 76 |
| CRI | 97 | 92 | 93 | 93 | 98 |
| TM-30 DATA | R9: 97 Rf: 92 Rg: 100 | R9: 64 Rf: 91 Rg: 98 | R9: 90 Rf: 95 Rg: 102 | R9: 92 Rf: 94 Rg: 101 | R9: 92 Rf: 94 Rg: 101 |





| | | | | | | | |
|----------------------|-------------------|---------------------|---------|------------------------------|--|-------------------------|-------------------------|
| MATERIAL | Extruded Aluminum | FREQUENCY | 50/60HZ | APPLICATION | Suitable for damp or dry locations. Indoor use only. | COMPLIANCE LABEL | ETL to UL 2108 Standard |
| INPUT VOLTAGE | 24VDC | POWER FACTOR | > 0.90 | DIMMING & FLICKER | 0-10V dimming Flicker less than 2% | LED LAMP LIFE | 60,000 Hours |

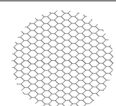



All track heads with the exception of Tubo Wall Wash and Zoom are JAB listed with universal power supplies in 27K> CCT. Click the link to access our full Title 24 compliance listings: pureedgelighting.com/resources

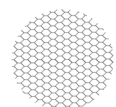

| | | | | | |
|---------|--|--------------|--|------|--|
| PROJECT | | FIXTURE TYPE | | DATE | |
|---------|--|--------------|--|------|--|

Additional Lenses and Accessories

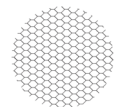
| TUBO LARGE LENS | | SNOOT | | LOUVER | FOCUS LENS | LINEAR SPREAD FILM | |
|---|---|---|--|--|---|---|---|
|  | |  | |  |  |  | |
| ORDERING CODE | STATIC WHITE LEN-TUBL-NS-SW LEN-TUBL-SP-SW LEN-TUBL-NF-SW LEN-TUBL-FL-SW LEN-TUBL-WF-SW | WARM DIM LEN-TUBL-SP-WD LEN-TUBL-NF-WD LEN-TUBL-FL-WD LEN-TUBL-WF-WD | STB16-BK STB16-WH (WHITE SHELL) | ST16-BK ST16-WH | L016-H | LF-TUBL-SF (SOFT FOCUS), MF (MEDIUM FOCUS), WF (WIDE FOCUS) | LF-TUBL-LS |
| LENS SIZE | 2" (50mm) Diameter | | | | | | |
| BEAM SPREADS | NS (10°), SP (20°), NF (35°) FL (45°), WF (60°) | | Conical snoot creates a 7° Beam spread and is designed to reduce spill and control glare. Spun aluminum. | Snoot is designed to reduce spill and control glare. Spun aluminum. | Hexcell louver eliminates glare. 0.125" Thickness. | Soft focus lens is included with every track head. Diffuses the beam, providing uniform illumination. | Linear spread film: directs the light into an elongated beam. Typical applications using 10°, 15°, 25° include illuminating landscape oriented art. 35°, 40°, 60° create an elongated oval typically used for wall washing. |

| TUBO SMALL LENS | | SNOOT | | LOUVER | FOCUS LENS | LINEAR SPREAD FILM |
|---|---|---|--|--|---|---|
|  | |  | |  |  |  |
| ORDERING CODE | STATIC WHITE LEN-TUBS-NS-SW LEN-TUBS-SP-SW LEN-TUBS-NF-SW LEN-TUBS-FL-SW LEN-TUBS-WF-SW | WARM DIM LEN-TUBS-NS-WD LEN-TUBS-SP-WD LEN-TUBS-NF-WD LEN-TUBS-FL-WD LEN-TUBS-WF-WD | TUBS-ST-BK TUBS-ST-WH (WHITE SHELL) | L011-H | LF-TUBS-SF (SOFT FOCUS), MF (MEDIUM FOCUS), WF (WHITE FOCUS) | LF-TUBS-LS |
| LENS SIZE | 1.37" (35mm) Diameter | | | | | |
| BEAM SPREADS | NS (15°), SP (25°), NF (35°), FL (45°), VW (75°) | | Conical snoot creates a 7° Beam spread and is designed to reduce spill and control glare. Spun aluminum. | Hexcell louver eliminates glare. 0.125" Thickness. | Soft focus lens is included with every track head. Diffuses the beam, providing uniform illumination. | Linear spread film: directs the light into an elongated beam. Typical applications using 10°, 15°, 25° include illuminating landscape oriented art. 35°, 40°, 60° create an elongated oval typically used for wall washing. |

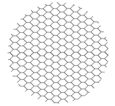
| RADIANT LARGE LENS | | SNOOT | | LOUVER | FOCUS LENS | LINEAR SPREAD FILM |
|---|---|---|--|--|---|---|
|  | |  | |  |  |  |
| ORDERING CODE | STATIC WHITE LEN-RADL-NS-SW LEN-RADL-SP-SW LEN-RADL-NF-SW LEN-RADL-FL-SW LEN-RADL-WF-SW | WARM DIM LEN-RADL-NS-WD LEN-RADL-SP-WD LEN-RADL-FL-WD LEN-RADL-WF-WD | STB16-BK STB16-WH (WHITE SHELL) | L016-H | LF-RADL-SF (SOFT FOCUS), MF (MEDIUM FOCUS), WF (WIDE FOCUS) | LF-RADL-LS |
| LENS SIZE | 2" (50mm) Diameter | | | | | |
| BEAM SPREADS | NS (10°), SP (20°), NF (35°), FL (45°), WF (60°) | NS (15°), SP (25°), FL (45°), WF (60°) | Conical snoot creates a 7° Beam spread and is designed to reduce spill and control glare. Spun aluminum. | Hexcell louver eliminates glare. 0.125" Thickness. | Soft focus lens is included with every track head. Diffuses the beam, providing uniform illumination. | Linear spread film: directs the light into an elongated beam. Typical applications using 10°, 15°, 25° include illuminating landscape oriented art. 35°, 40°, 60° create an elongated oval typically used for wall washing. |

| RADIANT MEDIUM LENS | | LOUVER | FOCUS LENS | LINEAR SPREAD FILM | |
|---|---|---|--|---|---|
|  | |  |  |  | |
| ORDERING CODE | STATIC WHITE LEN-RADM-SP-SW LEN-RADM-NF-SW LEN-RADM-FL-SW LEN-RADM-WF-SW | WARM DIM LEN-RADM-SP-WD LEN-RADM-NF-WD LEN-RADM-FL-WD LEN-RADM-WF-WD | L011-H | LF-RADM-SF (SOFT FOCUS) MF (MEDIUM FOCUS), WF (WIDE FOCUS) | LF-RADM-LS |
| LENS SIZE | 1.37" (35mm) Diameter | | | | |
| BEAM SPREADS | SP (20°), NF (35°), FL (45°), WF (60°) | | Hexcell louver eliminates glare. 0.125" Thickness. | Soft focus lens is included with every track head. Diffuses the beam, providing uniform illumination. | Linear spread film: directs the light into an elongated beam. Typical applications using 10°, 15°, 25° include illuminating landscape oriented art. 35°, 40°, 60° create an elongated oval typically used for wall washing. |

| | | | | | |
|---------|--|--------------|--|------|--|
| PROJECT | | FIXTURE TYPE | | DATE | |
|---------|--|--------------|--|------|--|

TUBO LARGE Photometric Data at 3000K

D - Distance from fixture
FC - Initial foot candles at the center of beam
DIA - Diameter

NARROW SPOT BEAM ANGLE 10°

| D' | FC | DIA. |
|----|-------|-------|
| 1' | 17300 | 2.2" |
| 2' | 4330 | 4.3" |
| 3' | 1930 | 6.5" |
| 4' | 1080 | 8.6" |
| 5' | 694 | 10.8" |
| 6' | 482 | 12" |
| 7' | 354 | 15" |
| 8' | 271 | 18" |

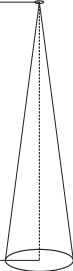

DIA.

SPOT BEAM ANGLE 20°

| D' | FC | DIA. |
|----|------|-------|
| 1' | 2582 | 4.3" |
| 2' | 1860 | 8.6" |
| 3' | 828 | 13" |
| 4' | 466 | 17.3" |
| 5' | 298 | 21.6" |
| 6' | 207 | 25.9" |
| 7' | 152 | 30.2" |
| 8' | 117 | 34.6" |

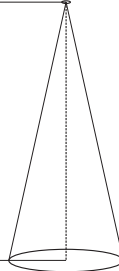

DIA.

NARROW FLOOD BEAM ANGLE 35°

| D' | FC | DIA. |
|----|------|-------|
| 1' | 2780 | 7.6" |
| 2' | 695 | 15.1" |
| 3' | 309 | 22.7" |
| 4' | 174 | 30" |
| 5' | 111 | 37.2" |
| 6' | 77.2 | 45.4" |
| 7' | 56.7 | 53" |
| 8' | 43.4 | 62.5" |

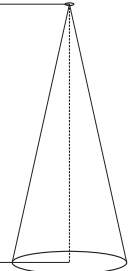

DIA.

FLOOD BEAM ANGLE 45°

| D' | FC | DIA. |
|----|------|-------|
| 1' | 1610 | 9.8" |
| 2' | 403 | 18" |
| 3' | 179 | 29.2" |
| 4' | 101 | 40" |
| 5' | 64.5 | 48" |
| 6' | 44.8 | 58.3" |
| 7' | 32.9 | 68" |
| 8' | 25.2 | 80" |

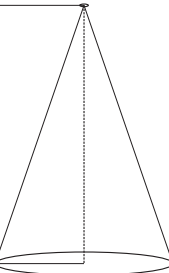
WIDE FLOOD BEAM ANGLE 60°

| D' | FC | DIA. |
|----|------|--------|
| 1' | 561 | 16.2" |
| 2' | 140 | 32.4" |
| 3' | 62.3 | 48" |
| 4' | 35 | 64.8" |
| 5' | 22.4 | 81" |
| 6' | 15.6 | 97.2" |
| 7' | 11.4 | 113.4" |
| 8' | 8.8 | 129.6" |

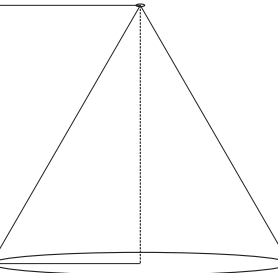

TUBO SMALL Photometric Data at 3000K

D - Distance from fixture
FC - Initial foot candles at the center of beam
DIA - Diameter

NARROW SPOT BEAM ANGLE 15°

| D' | FC | DIA. |
|----|------|-------|
| 1' | 3890 | 3.2" |
| 2' | 972 | 6.4" |
| 3' | 432 | 9.7" |
| 4' | 243 | 12.9" |
| 5' | 156 | 16.2" |
| 6' | 108 | 19.4" |
| 7' | 79 | 22.6" |
| 8' | 61 | 25.9" |



DIA.

SPOT BEAM ANGLE 25°

| D' | FC | DIA. |
|----|------|-------|
| 1' | 2080 | 5.4" |
| 2' | 520 | 10.8" |
| 3' | 231 | 16.2" |
| 4' | 130 | 21.6" |
| 5' | 83 | 27" |
| 6' | 57.8 | 32.4" |
| 7' | 42.4 | 37.8" |
| 8' | 32.5 | 43.2" |

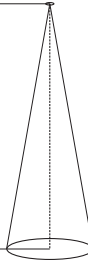

DIA.

NARROW FLOOD BEAM ANGLE 35°

| D' | FC | DIA. |
|----|------|-------|
| 1' | 1540 | 7.5" |
| 2' | 385 | 15.1" |
| 3' | 171 | 22.6" |
| 4' | 96.3 | 30" |
| 5' | 61.6 | 37.2" |
| 6' | 42.8 | 45.3" |
| 7' | 31.4 | 53" |
| 8' | 24.1 | 62.5" |



DIA.

FLOOD BEAM ANGLE 45°

| D' | FC | DIA. |
|----|------|-------|
| 1' | 496 | 9.7" |
| 2' | 124 | 19.4" |
| 3' | 55.1 | 29.1" |
| 4' | 31 | 38.8" |
| 5' | 19.8 | 48.6" |
| 6' | 13.8 | 58.3" |
| 7' | 10.1 | 68.0" |
| 8' | 7.75 | 77.7" |

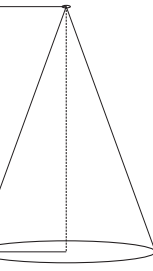

DIA.

WIDE FLOOD BEAM ANGLE 60°

| D' | FC | DIA. |
|----|------|--------|
| 1' | 265 | 16.2" |
| 2' | 66.3 | 32.4" |
| 3' | 29.4 | 48" |
| 4' | 16.6 | 64.8" |
| 5' | 10.6 | 81" |
| 6' | 7.3 | 97.2" |
| 7' | 5.4 | 113.4" |
| 8' | 4.1 | 129.6" |

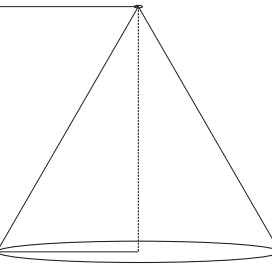

DIA.

| | | | | | |
|---------|--|--------------|--|------|--|
| PROJECT | | FIXTURE TYPE | | DATE | |
|---------|--|--------------|--|------|--|

ZOOM Z1 Photometric Data at 3000K

D - Distance from fixture
FC - Initial foot candles at the center of beam
DIA - Diameter

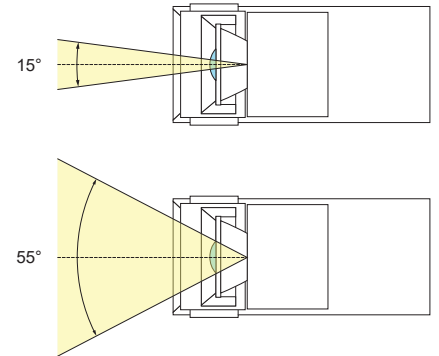
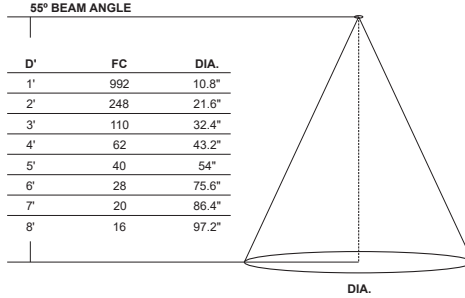
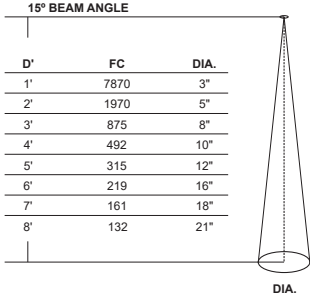

Z1: Adjustable between 15° and 55°

ZOOM Z2 Photometric Data at 3000K

D - Distance from fixture
FC - Initial foot candles at the center of beam
DIA - Diameter

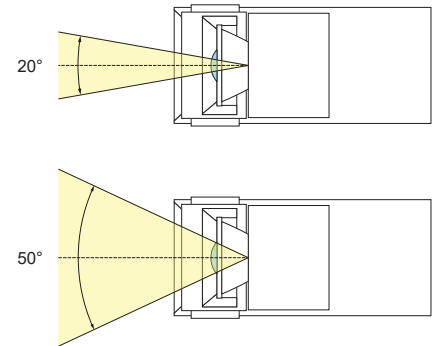
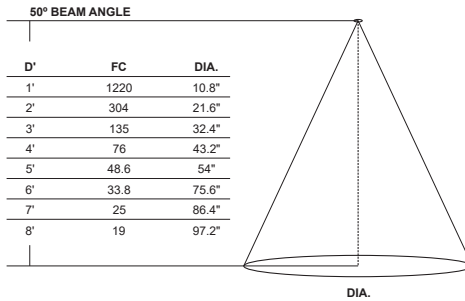
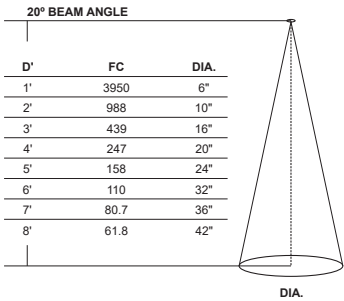

Z2: Adjustable between 20° and 50°

TUBO WALL WASH Photometric Data at 3000K

D - Distance from fixture
FC - Initial foot candles at the center of beam
DIA - Diameter

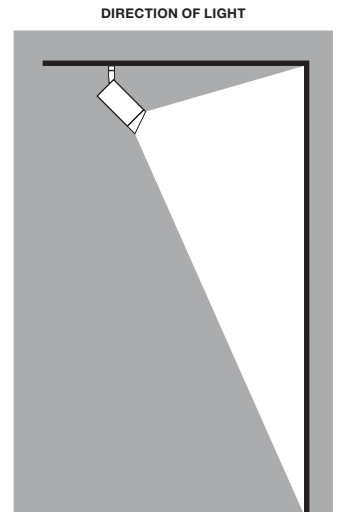
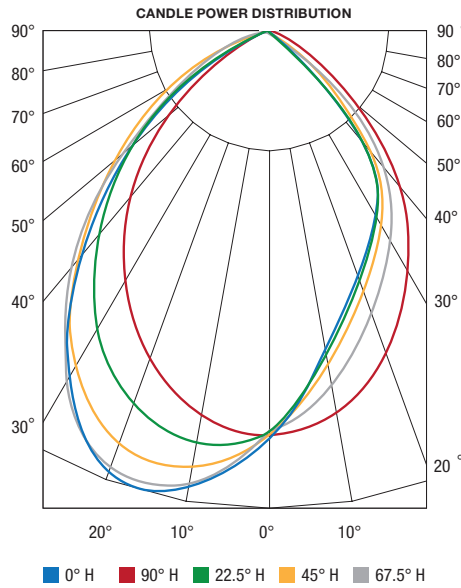
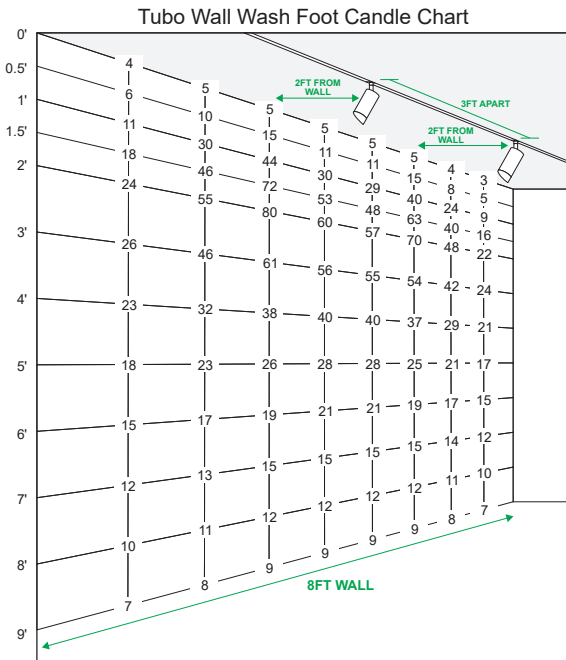

| | | |
|---------|--------------|------|
| PROJECT | FIXTURE TYPE | DATE |
|---------|--------------|------|

RADIANT LARGE Photometric Data at 3000K

D - Distance from fixture
FC - Initial foot candles at the center of beam
DIA - Diameter

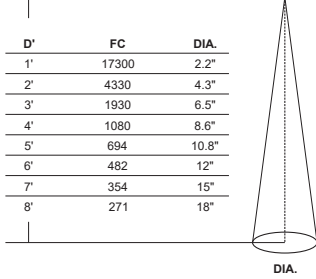
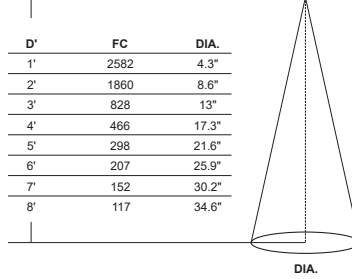
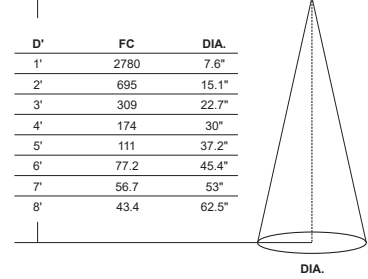
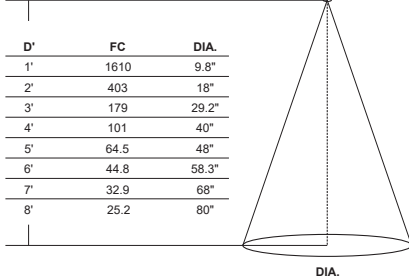
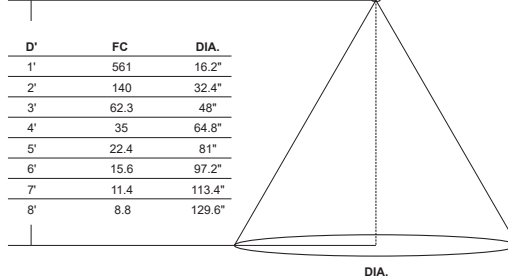
NARROW SPOT BEAM ANGLE 10°

SPOT BEAM ANGLE 20°

NARROW FLOOD BEAM ANGLE 35°

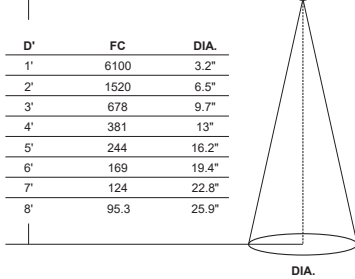
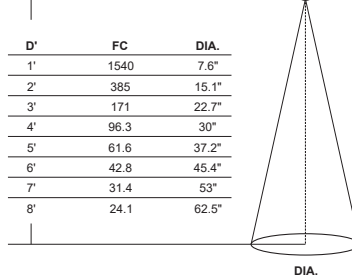
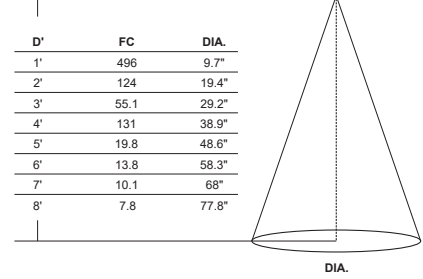
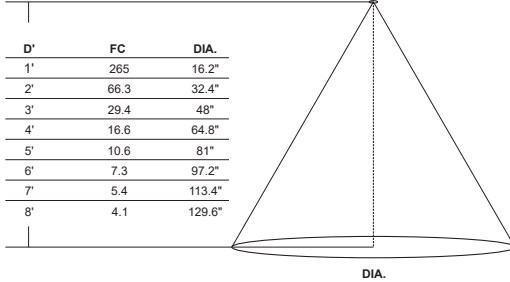
FLOOD BEAM ANGLE 45°

WIDE FLOOD BEAM ANGLE 60°

RADIANT MEDIUM Photometric Data at 3000K

D - Distance from fixture
FC - Initial foot candles at the center of beam
DIA - Diameter

SPOT BEAM ANGLE 20°

NARROW FLOOD BEAM ANGLE 35°

FLOOD BEAM ANGLE 45°

WIDE FLOOD BEAM ANGLE 60°

| | | |
|---------|--------------|------|
| PROJECT | FIXTURE TYPE | DATE |
|---------|--------------|------|

UNIVERSAL POWER SUPPLIES WITH TRIM

24VDC, UNIVERSAL DIMMING (ELV, TRIAC, 0-10V) STATIC WHITE & WARM DIM FOR TRACK HEADS



DESCRIPTION

The Uni TRIM Power Supply is designed for 24 Volt Track Heads, accepts input voltage in a range of 120 - 277VAC and outputs 24VDC power up to 96 watts. Can be used as a dimmable or non-dim Power Supply. Dims down 7% with an ELV dimmer or a 0-10 volt dimmer when two additional wires are connected to the dimmer. The enclosure provides a space inside for electrical connections. Power Supply features short circuit and overload and over temperature protection. Indoor applications only. For custom quotes and layout assistance, send your drawings and ideas to our design team: design@PureEdgeLighting.com.

MOUNTING

Surface mounted with conduit access

COMPATIBILITY

Compatible with PureEdge 24VDC Track heads (T24, T24M), Vanishing Point and Mono-point/Multi-point heads (FJ24, VR, V2MR, MR2R, M44R, 2RRE, 3R8R).

POWER INPUT

120-277 volts AC, 50/60Hz

POWER OUTPUT

Class 2; 24 volts DC 4A, 96 watts maximum

EFFICIENCY

85%

AMBIENT OPERATING TEMPERATURE

-25C to 40C

ELV DIMMER TYPE

Legrand: Adorne ADTP703TU
Lutron: Diva DVELV-300P, Skylark SELV-300P, Maestro MAELV-600 and Radio RA 2

MAKE IT SMART

ELV & TRIAC [Smart Dimmer & Switch](#)

0-10 DIMMER TYPE

Lutron: Radio RA2 (with GRX-TVI), Grafik Eye Qs (with GRX-TVI), Diva (with PP20); Nova T
Philips: Sunrise SR1200ZTUNV
Leviton: IP710-DL

DIMMING CURVE

Linear, Logarithmic 100% - 7% (HydraDrive)

APPLICATIONS: Indoor

To avoid overheating the power supply, install it in a ventilated remote location where air flows. Maintain proper spacing among power supplies when multiple power supplies are installed in the same remote location.



| Product | Wattage | Dimming | Voltage | Type | Options |
|--|--|-----------------------------------|-------------------------|---------------|---|
| PSB | 96W | UNI | 24VDC | T | STANDARD (Leave Blank) |
| PSB Power Supply with Enclosure Box | 40W 40 Watt 60W 60 Watt 96W 96 Watt 2X40W 2x40 Watt 2X60W 2x60 Watt 2X96W 2x96 Watt | UNI Universal Power Supply | 24VDC 24 Volt DC | T Trim | TB T-Bar CP Chicago Plenum |

| | | | | | |
|---------|--|--------------|--|------|--|
| PROJECT | | FIXTURE TYPE | | DATE | |
|---------|--|--------------|--|------|--|



UNIVERSAL POWER SUPPLIES WITH TRIM

24VDC, UNIVERSAL DIMMING (ELV, TRIAC, 0-10V) STATIC WHITE & WARM DIM FOR TRACK HEADS

UNIVERSAL POWER SUPPLIES & RECOMMENDED DIMMERS

| | PSB-40W-UNI-24VDC-T | PSB-60W-UNI-24VDC-T | PSB-96W-UNI-24VDC-T |
|-----------------------|---|--|---|
| ORDERING CODE |  |  |  |
| SPECIFICATIONS | | | |
| MAXIMUM LOAD | 40W | 60W | 96W |
| INPUT VOLTAGE | 120-277VAC | 120-277VAC | 120-277VAC |
| OUTPUT VOLTAGE | 24VDC | 24VDC | 24VDC |
| DIMENSIONS | 15.65" X 6.37" X 3.43" | 15.65" X 6.37" X 3.43" | 15.65" X 6.37" X 3.43" |
| CLASSIFICATION | CLASS 2 | CLASS 2 | CLASS 2 |
| T-BAR MOUNTING | PSB-40W-UNI-24VDC-T-TB | PSB-60W-UNI-24VDC-T-TB | PSB-96W-UNI-24VDC-T-TB |
| T-BAR CHICAGO PLENUM | PSB-40W-UNI-24VDC-T-CP | PSB-60W-UNI-24VDC-T-CP | PSB-96W-UNI-24VDC-T-CP |

UNIVERSAL POWER SUPPLIES & RECOMMENDED DIMMERS

| | PSB-2X40W-UNI-24VDC-T | PSB-2X60W-UNI-24VDC-T | PSB-2X96W-UNI-24VDC-T |
|-----------------------|---|--|---|
| ORDERING CODE |  |  |  |
| SPECIFICATIONS | | | |
| MAXIMUM LOAD | 2X40W | 2X60W | 2X96W |
| INPUT VOLTAGE | 120-277VAC | 120-277VAC | 120-277VAC |
| OUTPUT VOLTAGE | 24VDC | 24VDC | 24VDC |
| DIMENSIONS | 15.4" X 9.73" X 3.43" | 15.4" X 9.73" X 3.43" | 15.4" X 9.73" X 3.43" |
| CLASSIFICATION | CLASS 2 | CLASS 2 | CLASS 2 |
| T-BAR MOUNTING | PSB-2X40W-UNI-24VDC-T-TB | PSB-2X60W-UNI-24VDC-T-TB | PSB-2X96W-UNI-24VDC-T-TB |
| T-BAR CHICAGO PLENUM | PSB-2X40W-UNI-24VDC-T-CP | PSB-2X60W-UNI-24VDC-T-CP | PSB-2X96W-UNI-24VDC-T-CP |

ELV DIMMING & CONTROLS

| | | | |
|-------------------------------|---|---|---|
| LUTRON DIVA: DVELV-300P | • | • | • |
| LUTRON SKYLARK: SELV-300P | • | • | • |
| LUTRON RADIO RA3: RR-PROC3-XX | • | • | • |
| LUTRON MAESTRO: MAELV-600 | • | • | • |
| LEGRAND ADORNE: ADTP-703TUM4 | • | • | • |

0-10 DIMMING & CONTROLS

| | | | |
|--------------------------------|---|---|---|
| PHILIPS SUNRISE: SR1200ZTUNV | • | • | • |
| LUTRON DIVA: DVTV-WH, DVSTV-WH | • | • | • |
| LUTRON NOVA T: NTSTV-DV-XX | • | • | • |
| LUTRON GRAFIX EYE QS: QSGRJ-XP | • | • | • |
| LUTRON RADIO RA3: RR-PROC3-XX | • | • | • |
| LEVITON: LEV40050 | • | • | • |
| LEVITON IP710-LFZ | • | • | • |
| LEGRAND: ADPD4FBL3P2W4 | • | • | • |
| LEGRAND RADIANT: RH703PTUW | • | • | • |

TRIAC DIMMING & CONTROLS

| | | | |
|------------------------------|---|---|---|
| LUTRON SKYLARK: S2-L-WH | • | • | • |
| LUTRON DIVA DVLV-600P-WH | • | • | • |
| LUTRON DIVA DVLV-603P-WH | • | • | • |
| LUTRON MAESTRO MALV-600-WH | • | • | • |
| LUTRON MAESTRO MALV-1000-WH | • | • | • |
| LUTRON MAESTRO MA-R-XX | • | • | • |
| PURE SMART DIMMER AND SWITCH | • | • | • |

- Flicker free dimming
- Aluminum casing for optimal heat dissipation
- Isolated output power per e and UL safety requirements
- UL & ETL recognized/ listed, meets UL 8750, 1310 requirements
- Auto-reset; short circuit, overload and thermal protection
- Class 2 power supply
- Efficient, High power factor > 0.90

- The Solid State Constant Voltage Uni-Power Supply is compatible with most commercially available Dimmers:
 - Triac Dimmer: (Forward Phase) Typically used for the dimming of Incandescent and Low Voltage Magnetic Transformers
 - ELV Dimmer: (Reverse Phase) Dimming of Electronic Low Voltage Transformers and Power Supplies used for LED lighting
 - 0-10 Dimmer : Dims the Low Voltage side of a 0-10 volt power supply commonly used in large scale lighting or commercial applications.
- The Uni-Power Supply is recommended with any Siemens/Murray brand of arc fault breaker to overcome the issues with tripping the breakers with ELV Low Voltage Drivers.

*Title 24 with JA8 listed PureEdge products and systems

| | | | | | |
|---------|--|--------------|--|------|--|
| PROJECT | | FIXTURE TYPE | | DATE | |
|---------|--|--------------|--|------|--|

UNIVERSAL POWER SUPPLIES WITH TRIM

24VDC, UNIVERSAL DIMMING (ELV, TRIAC, 0-10V) STATIC WHITE & WARM DIM FOR TRACK HEADS

REV 01.16.25

POWER SUPPLY DIMENSIONS & DIAGRAMS

40W, 60W, 96W

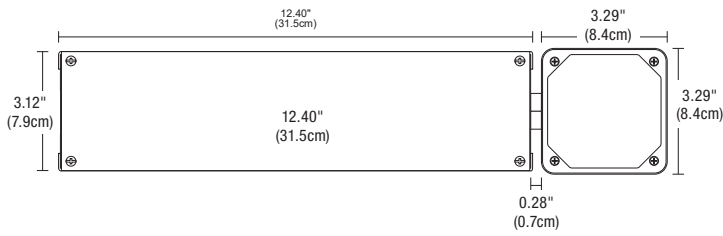

2X40W, 2X60W, 2X96W

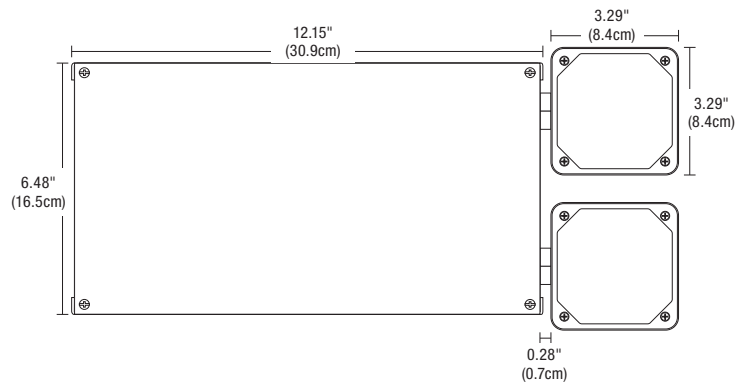

T-BAR GRID CEILING

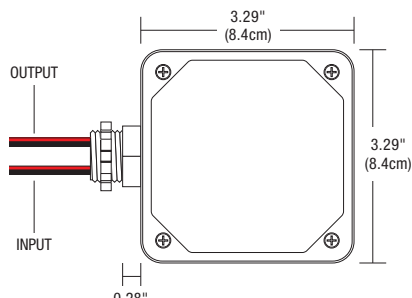
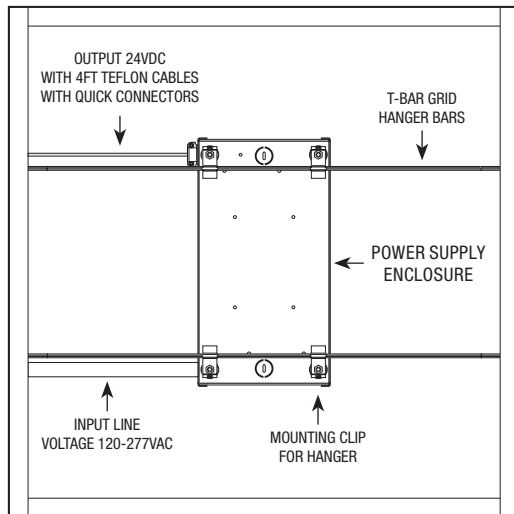

VOLTAGE TRIM BOX

Voltage Trim Box is included with power supply. Mounts in 1/2" knock-outs. The part number below is to be used for replacement only.

| Product | Voltage | Type |
|-------------------------------------|------------------|-----------------------|
| PSB | 24VDC | TRIM |
| PSB Power Supply with Enclosure Box | 24VDC 24 Volt DC | TRIM Voltage Trim Box |

| | | | | | |
|---------|--|--------------|--|------|--|
| PROJECT | | FIXTURE TYPE | | DATE | |
|---------|--|--------------|--|------|--|

UNIVERSAL POWER SUPPLIES WITH TRIM

24VDC, UNIVERSAL DIMMING (ELV, TRIAC, 0-10V) STATIC WHITE & WARM DIM FOR TRACK HEADS

REV 01.16.25

ELV WIRING DIAGRAM

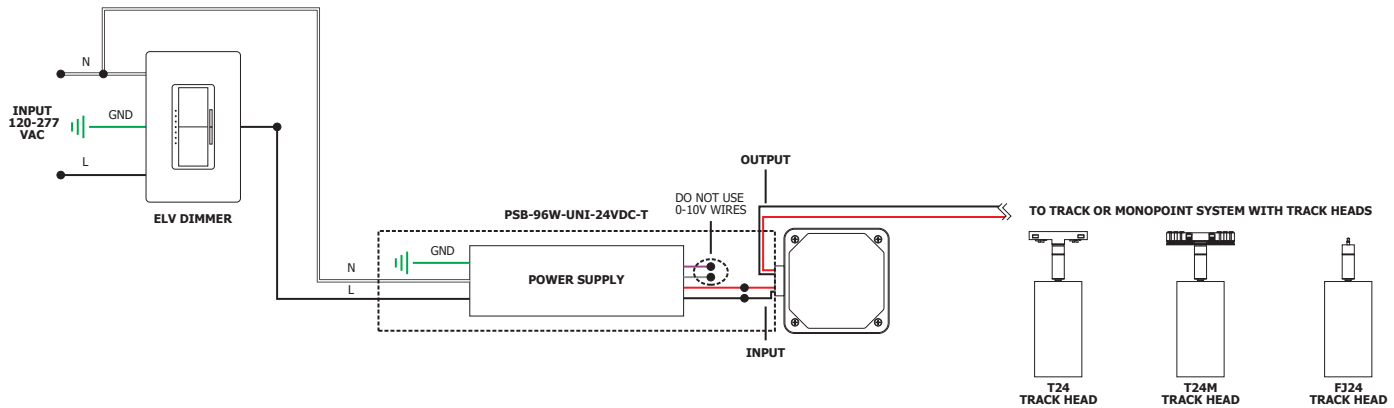

0-10V WIRING DIAGRAM

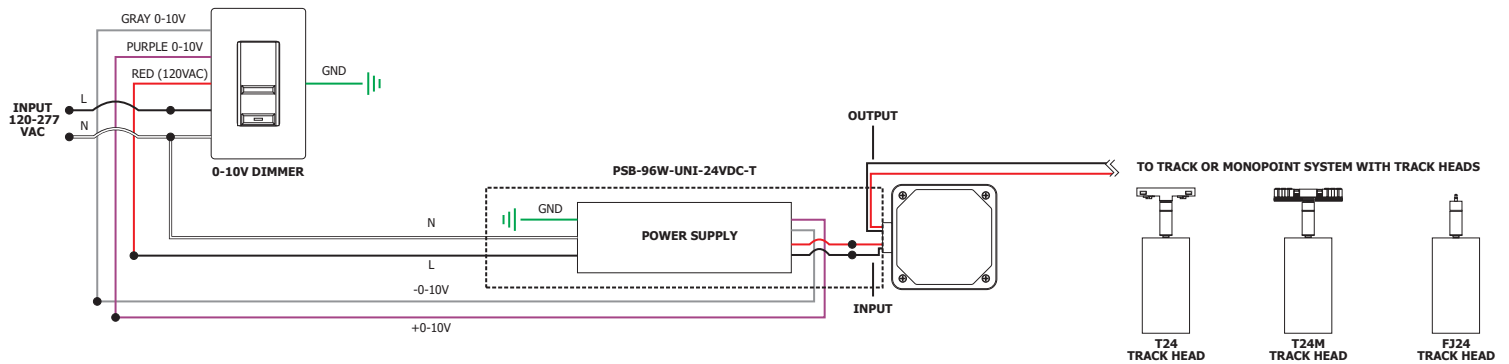

SMART WIRING DIAGRAM & NETWORK TOPOGRAPHY

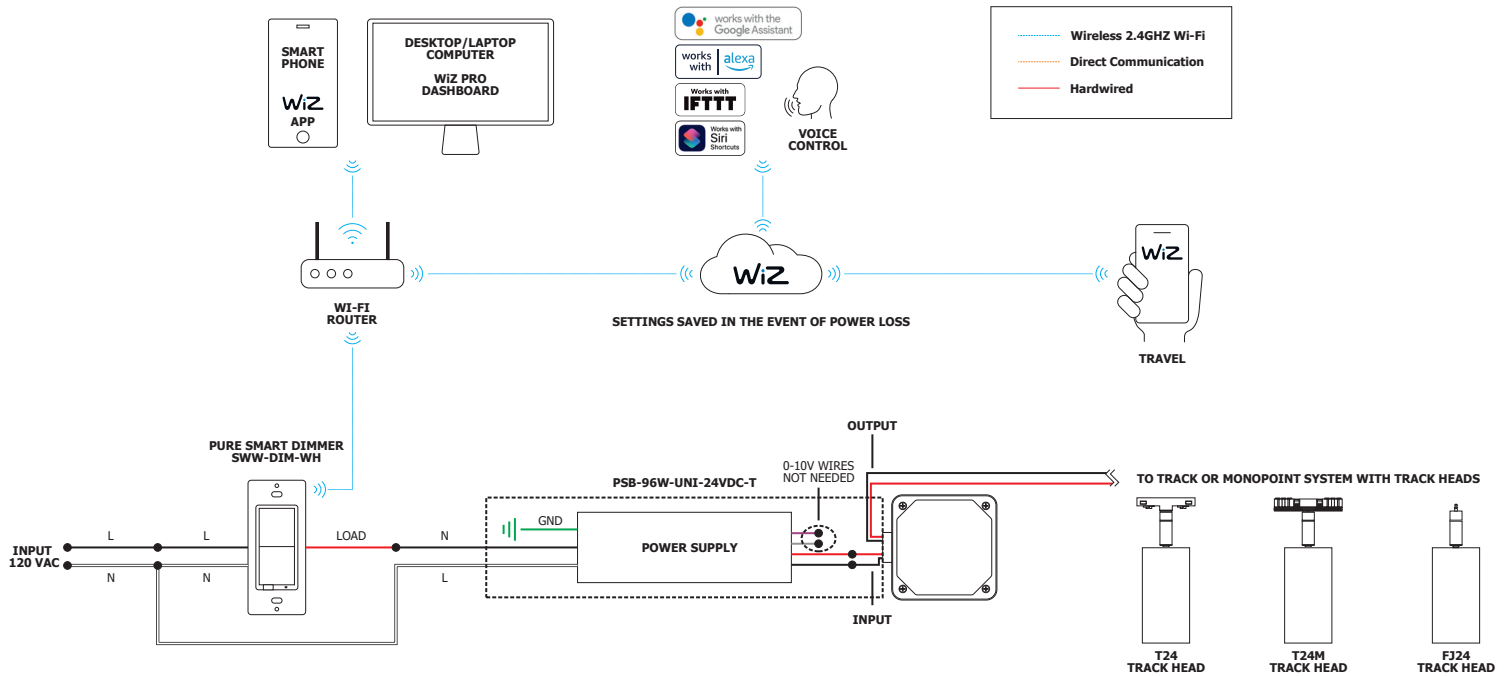

| | | | | | |
|---------|--|--------------|--|------|--|
| PROJECT | | FIXTURE TYPE | | DATE | |
|---------|--|--------------|--|------|--|

TM30-15 DATA

T24 TRACK HEADS

RADIANT LARGE FLOOD 3000K | Rf: 95 | Rg: 101.6

Color Vector Graphic

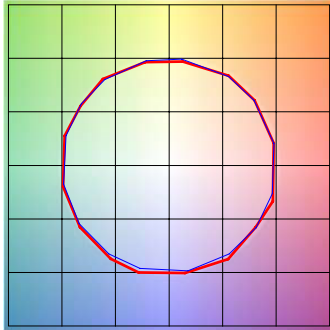

■ Test ■ Reference

| | | GRAPHIC SHIFTS % | |
|---------|------|------------------|-------|
| HUE BIN | Rf | CHROMA | HUE |
| 1 | 96.8 | -0.3% | 0.3% |
| 2 | 97.8 | 0.3% | -0.3% |
| 3 | 96.5 | 0.4% | 0.3% |
| 4 | 95.3 | -2.1% | -1.4% |
| 5 | 95.9 | -1.1% | 1.1% |
| 6 | 96.4 | 1.4% | 1.3% |
| 7 | 93.9 | -0.5% | 1.9% |
| 8 | 97.3 | 1.3% | 0.3% |
| 9 | 95.9 | 1% | 2.1% |
| 10 | 94.0 | 1.3% | 3.3% |
| 11 | 92.7 | 2.9% | 4.1% |
| 12 | 92.4 | 3.8% | -0.4% |
| 13 | 94.6 | 1.5% | -3.2% |
| 14 | 93.0 | 3.3% | -3.6% |
| 15 | 94.6 | -0.6% | -0.1% |
| 16 | 90.1 | 1.9% | -6.9% |

RADIANT MEDIUM FLOOD 3000K | Rf: 89.5 | Rg: 100.8

Color Vector Graphic

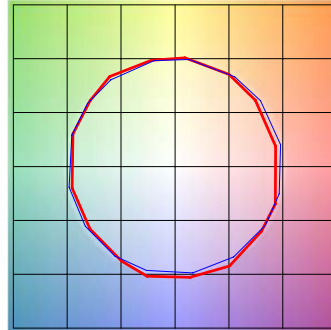

■ Test ■ Reference

| | | GRAPHIC SHIFTS % | |
|---------|------|------------------|--------|
| HUE BIN | Rf | CHROMA | HUE |
| 1 | 90.0 | -4.9% | -0.7% |
| 2 | 90.7 | -3.6% | 3.1% |
| 3 | 87.2 | -1.1% | 5.9% |
| 4 | 92.7 | 1.0% | 3.8% |
| 5 | 93.8 | 0.9% | 2.7% |
| 6 | 94.2 | 3.0% | -0.7% |
| 7 | 92.7 | -0.5% | -3.6% |
| 8 | 96.6 | -0.8% | -1.5% |
| 9 | 94.4 | -2.5% | 1.4% |
| 10 | 89.7 | -2.3% | 4.6% |
| 11 | 87.3 | 0.5% | 7.6% |
| 12 | 89.9 | 5.2% | 1.5% |
| 13 | 92.0 | 3.6% | -3.4% |
| 14 | 87.6 | 4.7% | -7.7% |
| 15 | 88.2 | -0.0% | -6.9% |
| 16 | 85.8 | -1.8% | -10.0% |

TUBO LARGE FLOOD 3000K | Rf: 91.0 | Rg: 98.0

Color Vector Graphic

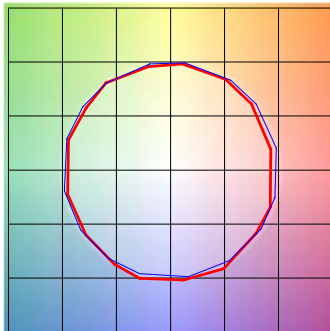

■ Test ■ Reference

| | | GRAPHIC SHIFTS % | |
|---------|------|------------------|-------|
| HUE BIN | Rf | CHROMA | HUE |
| 1 | 89.2 | -5.2% | 0.1% |
| 2 | 91.3 | -3.6% | 2.4% |
| 3 | 90.2 | -1.8% | 4.1% |
| 4 | 94.7 | -1.3% | 1.8% |
| 5 | 93.8 | -2.3% | 1.8% |
| 6 | 96.8 | 0.4% | 0.0% |
| 7 | 93.1 | -3.2% | -1.0% |
| 8 | 96.6 | -1.5% | 0.7% |
| 9 | 92.7 | -2.4% | 3.7% |
| 10 | 87.4 | -1.5% | 6.3% |
| 11 | 87.8 | 1.5% | 8.1% |
| 12 | 89.9 | 4.4% | 1.0% |
| 13 | 91.7 | 2.3% | -4.8% |
| 14 | 87.4 | 3.3% | -8.5% |
| 15 | 88.1 | -1.5% | -6.3% |
| 16 | 85.4 | -2.6% | -9.8% |

TUBO SMALL FLOOD 3000K | Rf: 95.0 | Rg: 102.2

Color Vector Graphic

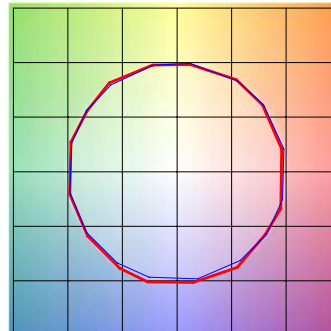

■ Test ■ Reference

| | | GRAPHIC SHIFTS % | |
|---------|------|------------------|-------|
| HUE BIN | Rf | CHROMA | HUE |
| 1 | 96.6 | -1.1% | -0.7% |
| 2 | 97.9 | -0.6% | 0.4% |
| 3 | 95.3 | 0.1% | 2.0% |
| 4 | 96.5 | 0.3% | 1.4% |
| 5 | 94.8 | 0.0% | 2.0% |
| 6 | 94.6 | 3.0% | 0.9% |
| 7 | 96.3 | 1.1% | -0.9% |
| 8 | 96.6 | 1.5% | -1.3% |
| 9 | 97.3 | 0.1% | 0.4% |
| 10 | 95.8 | -0.5% | 1.8% |
| 11 | 92.5 | 1.0% | 4.4% |
| 12 | 92.5 | 4.1% | 0.5% |
| 13 | 94.9 | 2.5% | -2.0% |
| 14 | 92.5 | 4.0% | -3.5% |
| 15 | 94.0 | 1.2% | -3.0% |
| 16 | 90.1 | 1.7% | -7.1% |

| | | | | | |
|---------|--|--------------|--|------|--|
| PROJECT | | FIXTURE TYPE | | DATE | |
|---------|--|--------------|--|------|--|

WARM DIM LED STRIP

TM-30-15 DATA: The data below is for bare LED Warm Dim Strip. Consistent color temperatures throughout a single strip and among multiple strips is possible through a 3 phase binning process in which each order is inspected with a color meter to ensure uniformity.

2700D | Rf: 90.7 | Rg: 101.1

Color Vector Graphic

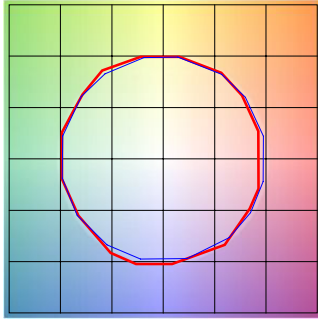

■ Test ■ Reference

| HUE BIN | Rf | GRAPHIC SHIFTS % | |
|---------|------|------------------|--------|
| | | CHROMA | HUE |
| 1 | 90.9 | -4.1% | 1.1% |
| 2 | 91.8 | -2.2% | 3.2% |
| 3 | 89.0 | 0.2% | 5.0% |
| 4 | 92.9 | -1.1% | 0.8% |
| 5 | 93.9 | 1.1% | 1.7% |
| 6 | 93.3 | 3.3% | 0.0% |
| 7 | 93.1 | -0.5% | -1.9% |
| 8 | 97.2 | -0.3% | -0.9% |
| 9 | 93.4 | -1.0% | 3.2% |
| 10 | 89.9 | -0.1% | 5.6% |
| 11 | 87.0 | 4.7% | 7.2% |
| 12 | 89.2 | 5.8% | -0.2% |
| 13 | 89.1 | 3.5% | -6.7% |
| 14 | 86.3 | 4.1% | -9.2% |
| 15 | 91.4 | -2.0% | -3.6% |
| 16 | 84.7 | -2.1% | -10.3% |

3000D | Rf: 90.6 | Rg: 101.1

Color Vector Graphic

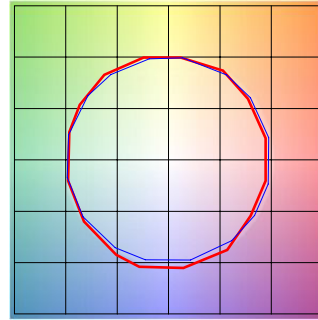

■ Test ■ Reference

| HUE BIN | Rf | GRAPHIC SHIFTS % | |
|---------|------|------------------|--------|
| | | CHROMA | HUE |
| 1 | 91.5 | -3.5% | 1.3% |
| 2 | 92.2 | -1.8% | 3.0% |
| 3 | 89.3 | 0.5% | 4.8% |
| 4 | 92.7 | -1.1% | 0.6% |
| 5 | 93.3 | 0.5% | 1.4% |
| 6 | 93.8 | 2.7% | -0.8% |
| 7 | 91.2 | -2.1% | -0.2% |
| 8 | 97.0 | -0.5% | -0.7% |
| 9 | 92.5 | -0.7% | 3.8% |
| 10 | 88.3 | 0.9% | 7.1% |
| 11 | 87.5 | 3.9% | 7.6% |
| 12 | 88.2 | 6.2% | -0.2% |
| 13 | 89.9 | 3.4% | -6.0% |
| 14 | 86.9 | 4.4% | -8.5% |
| 15 | 91.9 | -1.9% | -2.9% |
| 16 | 84.7 | -1.3% | -10.6% |

| | | | | | |
|---------|--|--------------|--|------|--|
| PROJECT | | FIXTURE TYPE | | DATE | |
|---------|--|--------------|--|------|--|