



1718 W. Fullerton Chicago, IL 60614  
 Ph: 773.770.1195 • Fax: 773.935.5613  
 www.PureEdgeLighting.com • info@PureEdgeLighting.com  
 © 2016 PureEdge Lighting. All Rights Reserved.

# Installation Instructions for TruLine 1.6A TruQuad



TL1.6A-\_\_

## IMPORTANT INFORMATION

- This instruction shows a typical installation.
- This product is wall or ceiling mount.
- This product is ETL listed for indoor use.

**SAVE THESE INSTRUCTIONS!**

## INSTALLATION VIDEO



Scan with your mobile device to watch a typical installation video or visit [https://www.pureedgelighting.com/pure/pure-videos/truquad\\_1\\_6a\\_install/index.php](https://www.pureedgelighting.com/pure/pure-videos/truquad_1_6a_install/index.php)

## Pre-installation Guide

<p><b>A</b></p> <p><b>LAYOUT 1</b></p> <p>1 Junction Box          2 Remote Power Supplies          2 Strips wrap around</p>	<p><b>LAYOUT 2</b></p> <p>1 Junction Box          4 Remote Power Supplies          4 Strips going opposite direction</p>
<p><b>LAYOUT 3</b></p> <p>2 Junction Boxes          8 Remote Power Supplies          8 Strips going all four directions</p>	<p><b>LAYOUT 4</b></p> <p>4 Junction Boxes          16 Remote Power Supplies          16 Strips going all four directions</p>

1: Depending on the size of the TruQuad, identify the design layout based on the 4 possibilities above.

**NOTE:** Parts are numbered in order of assembly (see Layout 1 for possible numbering).

## Included Components

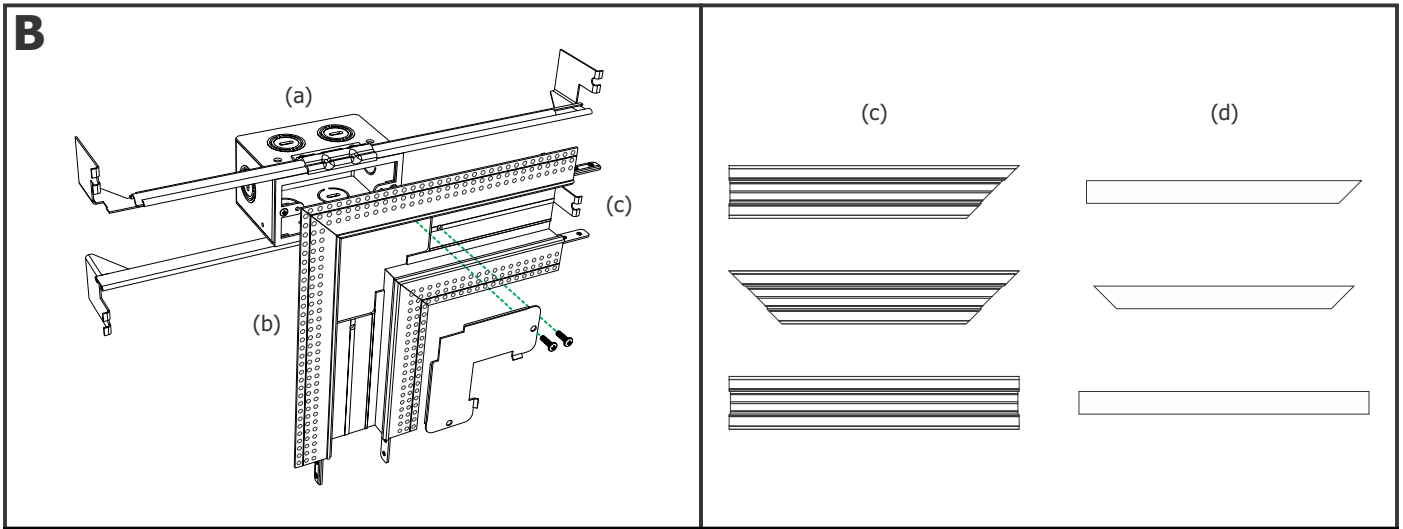

- a)** Junction Box
- b)** L-Picture Frame Power Channel Connector
- c)** Channels and Joining Brackets
- d)** Diffusers
- e)** Mounting Bar, Mounting Brackets and Mounting Screws (not shown)

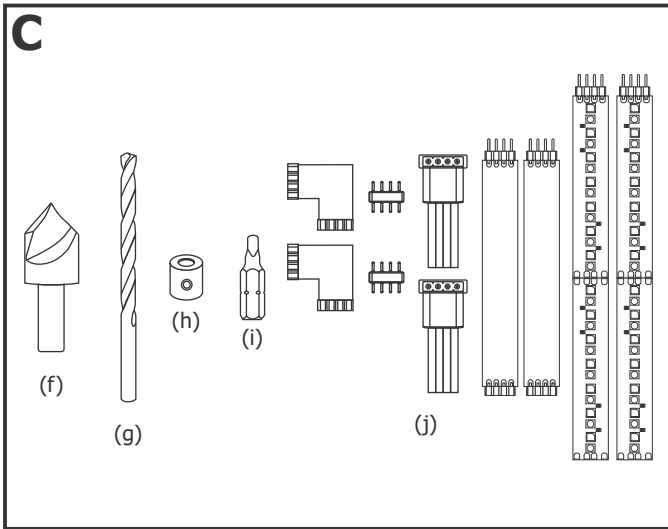

- f)** Countersink
- g)** Drill Bit
- h)** Drill Bit Stop Collars
- i)** Square-Recess Insert Bit
- j)** (2x) LED Soft Strips and Power Connectors

## Section One: Prepare and Install Junction Box and Power Connections

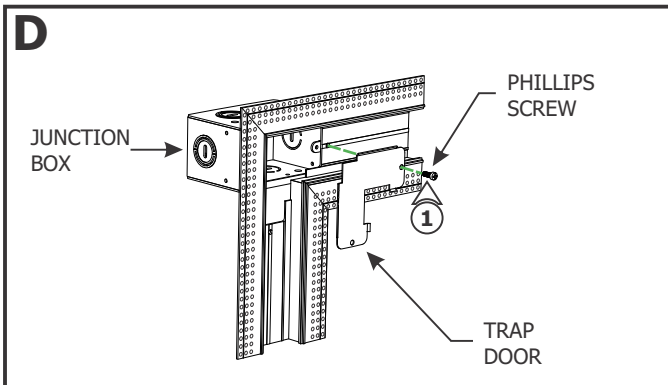

- 1:** Remove the Phillips screw from the junction box to remove the trap door from the assembly.

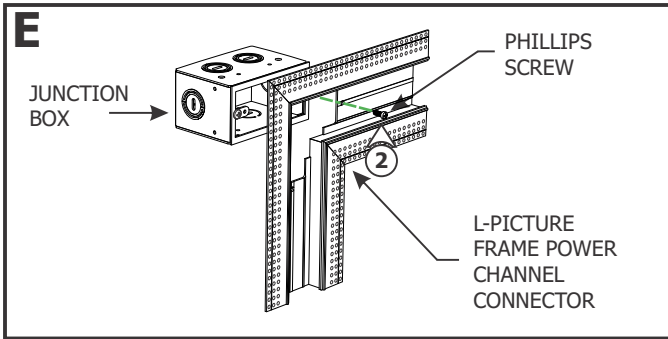

**2:** Remove the Phillips screw from the junction box to remove the L-Picture Frame Power Channel Connector.

**3:** Mount each adjustable mounting bar to one side of the junction box and secure them with the mounting brackets and two Phillips screws provided.

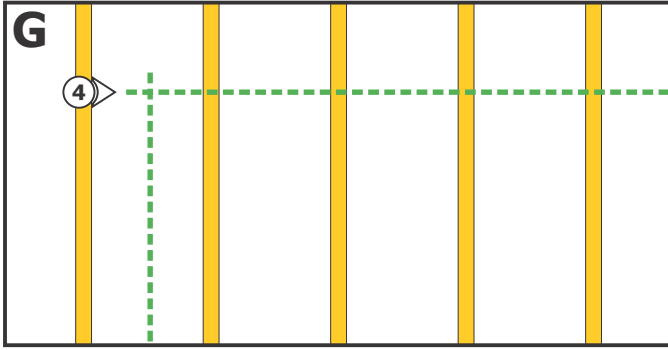
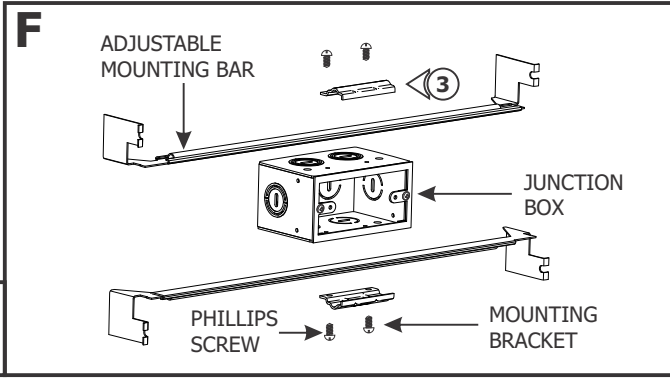

**4:** Measure and locate desired junction box mounting location. Determine the corner that the junction box will be installed to. Longer installation lengths may require two (opposing corners) or four (all corners) junction boxes.

**NOTE:** The adjustable mounting bars mount to studs that are spaced 13" to 24" apart.

- 5:** Place the lips on the adjustable mounting bars against the studs. Secure the adjustable bars to the studs with the #8 screws.
- 6:** Install power supply (reference installation instructions included with power supply) and conduit (if required by local electrical code) and run low-voltage power wires to the junction box.

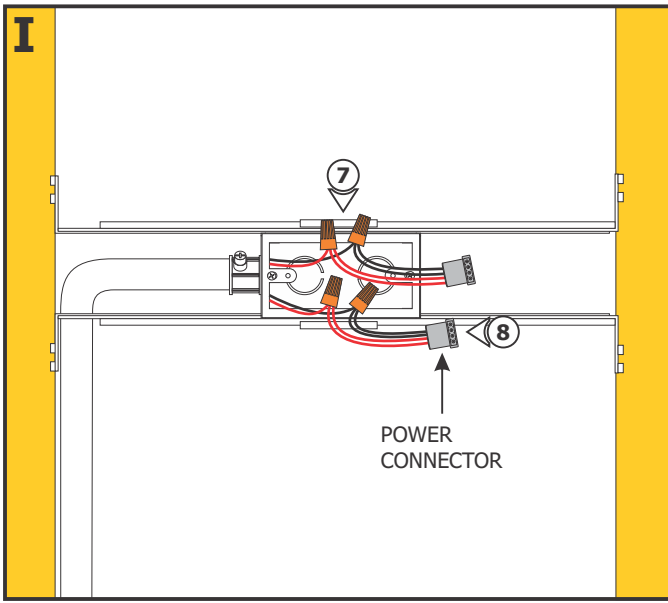
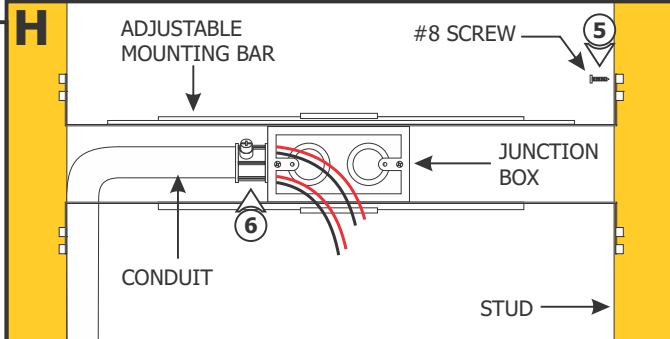

**NOTE:** If installation requires RGB, RGBW, or Tunable White, refer to wiring diagram on pages 11-13.

**NOTE:** Remote power supply wires must be present in junction box. Refer to instructions provided with power supply.

- 7:** Connect the red low voltage wires to the red power connector wires with a wire nut. Connect the black low voltage wires to the black power connector wires with a wire nut.
- 8:** Repeat step 7 for the other power connector and power supply
- 9:** Place all wire nut connections inside the junction box.

**CAUTION:** Unroll the entire LED strip from the reel and use the power connector to power the strip making sure there is no outage before continuing with the installation. Afterwards, carefully roll the LED strip loosely back into the reel.

## Section Two: Prepare Drywall and Install Channel

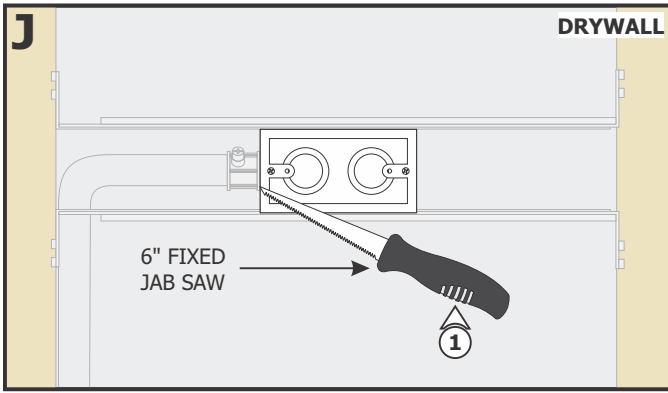

**1:** Cut a section of drywall using a 6" fixed jab saw or other appropriate tool to expose the mounting plate area. Install the drywall.

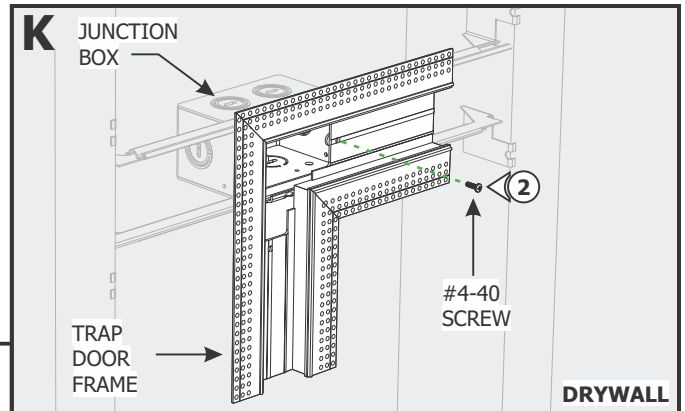

**2:** Attach the assembled trap door frame to the junction box using a #4-40 screw.

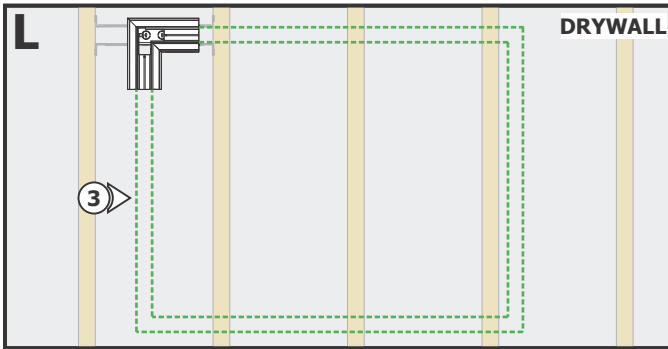

**3:** Mark the installation location on the drywall using a pencil or chalk line before cutting (minimum 2.25" wide).

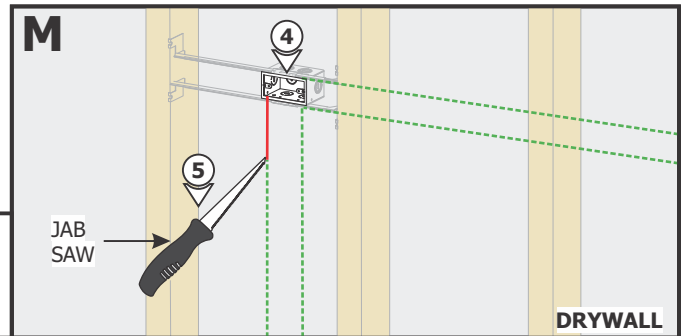

**4:** Remove the trap door frame before cutting.

**5:** Cut the drywall along the marked installation path using a jab saw or other appropriate tool.

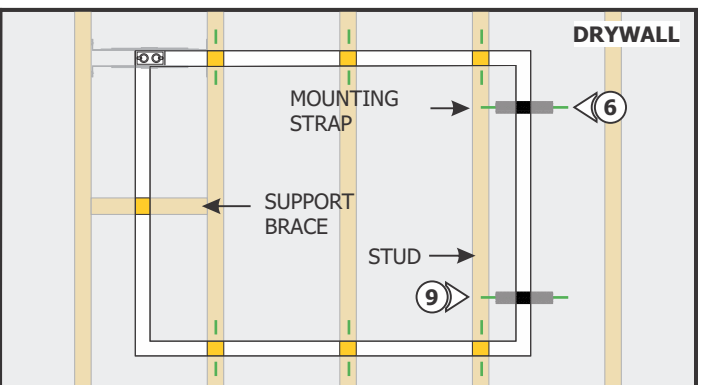
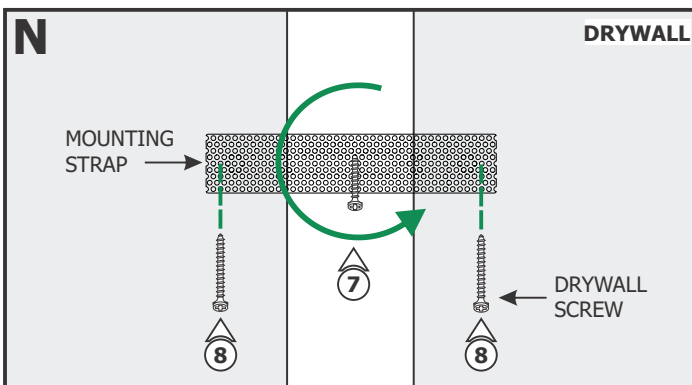

**6:** Install mounting straps behind the drywall where studs are not available (suggested spacing is every 32") by threading a drywall screw into the perforated material.

**7:** Place the mounting strap behind the cut drywall and rotate into place using the drywall screw as a handle.

**8:** Secure the mounting strap to the drywall using two drywall screws.

**9:** Mark the location of the studs and mounting straps on the drywall.

**NOTE:** For areas with lots of vibrations, it is suggested to install 2X4 support braces (suggested spacing is every 32") before installing and finishing drywall to avoid cracking of plaster.

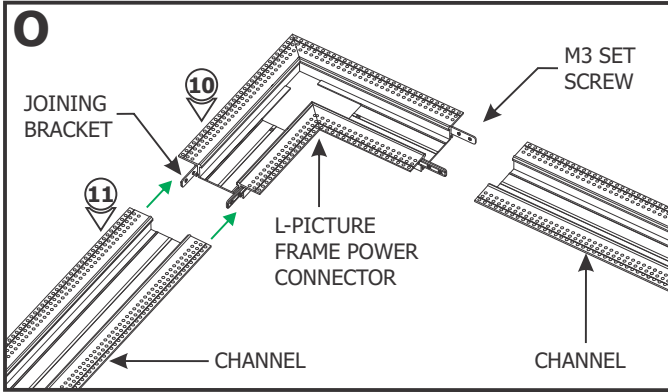

**10:** Insert joiner bars halfway into the Trap Door Frame. Tighten the M3 set screws on each joining bracket with a 1.5mm Allen wrench.

**11:** Slide the other section of channel onto the joining bracket and tighten the remaining M3 set screws with a 1.5mm Allen wrench.

**12:** Insert a 90° joiner bracket halfway into one mitered channel corner. Tighten the two M4 set screws on each joining bracket with a 2mm Allen wrench.

**13:** Slide the other section of mitered channel onto the 90° joining brackets and tighten the remaining M4 set screws with a 2mm Allen wrench.

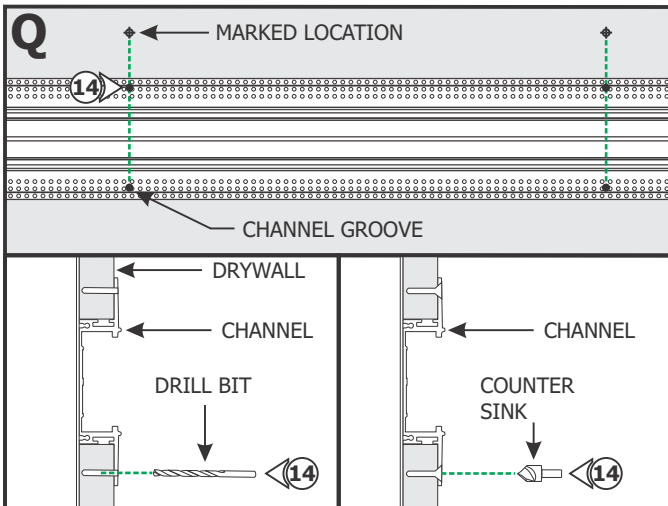
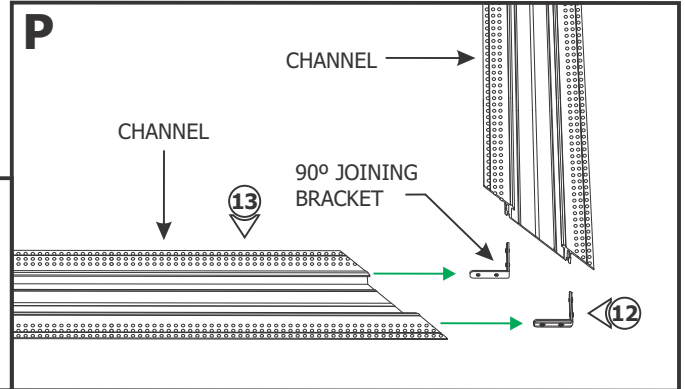

**14:** Place the assembled channel to the drywall cutout. Using the marked locations on the drywall, drill and countersink the channel using the provided square drill with counter sink bit.

**15:** Secure the channel to the studs/mounting straps through the drywall with the #6 screws using the provided square recess bit.

**16:** Secure the trap door frame to the junction box with the supplied screw.

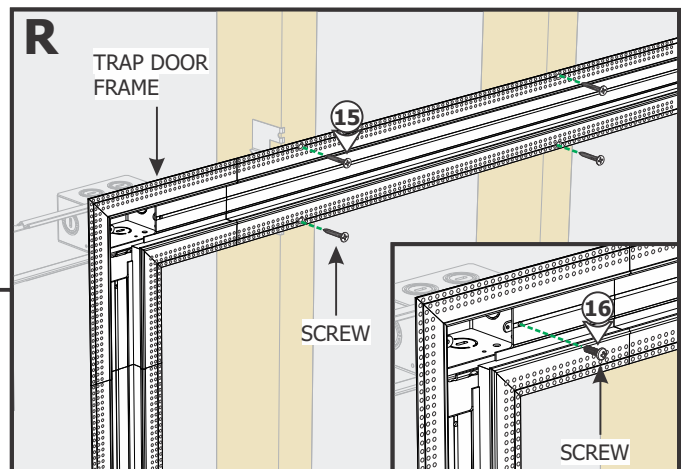

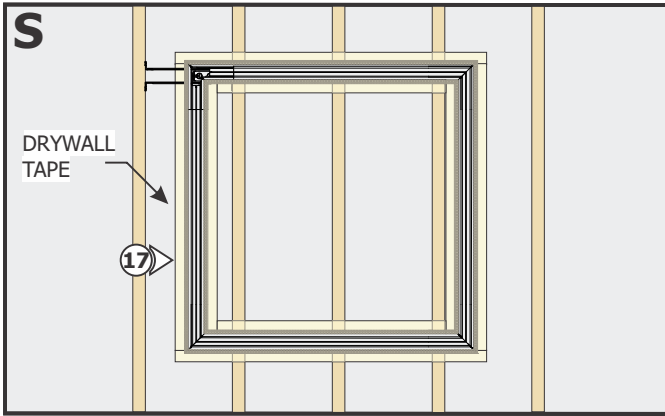

**NOTE:** For areas with lots of vibration, it is suggested to use Durabond to avoid cracking of plaster.

**NOTE:** **Do Not** use premixed joint compound "Soft Mud." No use compuesto para juntas premezclado "Soft Mud."

**NOTE:** Recommended plaster method: 1st Coat - Durabond 45 with 8" Blade, 2nd Coat - Easy Sand 45 with 10" Blade, 3rd Coat - with 12" Blade

**17:** Must apply drywall tape (Ultra-Thin drywall tape suggested) along edges of channel up to the groove to prevent cracking of plaster after installation. **DO NOT** overlap strips of drywall tape.

- 18:** Mask the interior surfaces of the channel using blue contractor's tape before plastering and painting.
- 19:** Use a compound knife for a smooth compound spread. Sand, paint, and finish the plaster and drywall before removing the blue contractor's tape.
- 20:** Carefully use a flathead screwdriver to remove excess drywall from the internal bevel/edge.

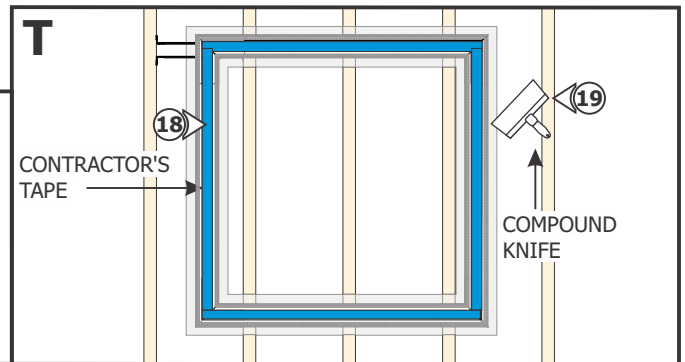

### Section Three: Installing LED Soft Strip

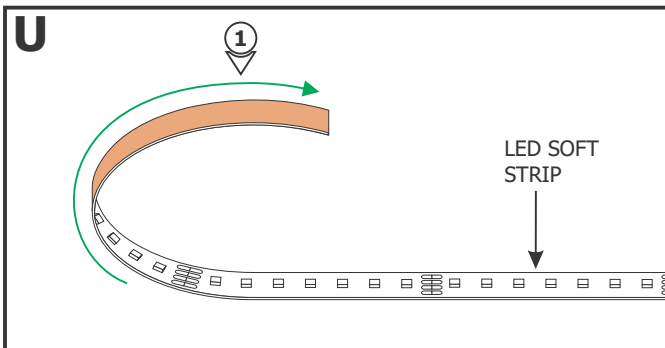

**1:** Gently uncoil the LED Soft Strip before applying to the channel otherwise the strip may lift off of the surface.

- NOTE:** Omit step 2 for RGBW Configurations. Blank Soft Strip Power Tape is not used.
- 2:** Connect the Blank Soft Strip Power Tape to the power connector.
  - 3:** Insert the Power Adapter and then connect the L-Shaped Flexible Power Connector to the Power Adapter.
  - 4:** Place the power connector and Power Tape inside the junction box.

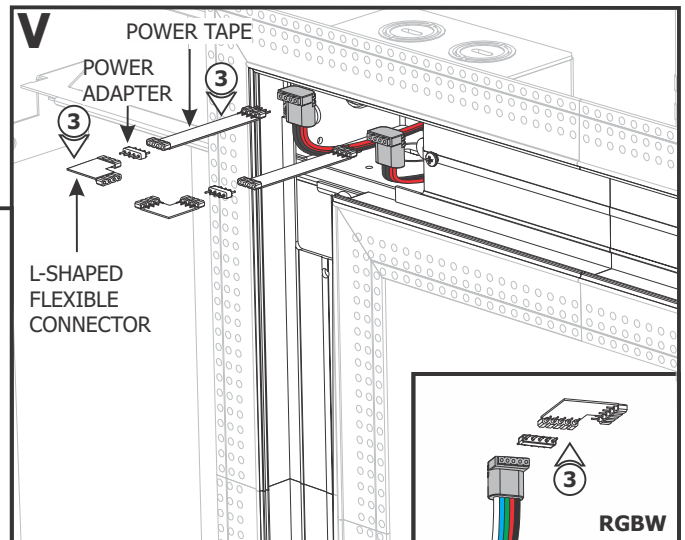

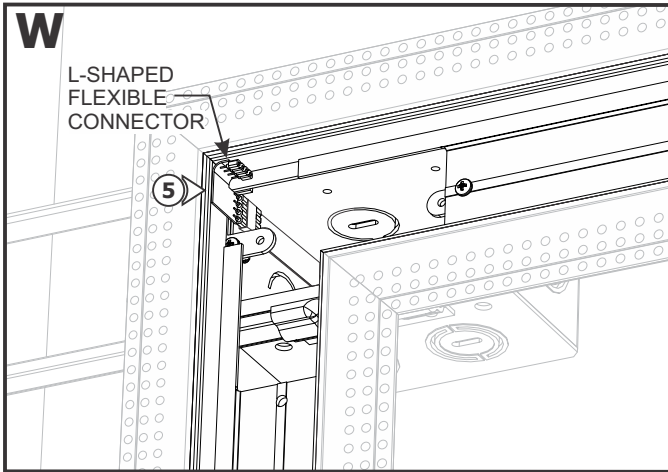

**5:** Place the assembled outer corner power connection into the channel where the LED Soft Strip will be installed.

- 6:** Place the assembled inner corner power connection into the channel where the LED Soft Strip will be installed.
- 7:** Replace the trap door and secure using the #4-40 screw.
- 8:** If necessary (depending on design), repeat step 1 through 7 for the other corners.

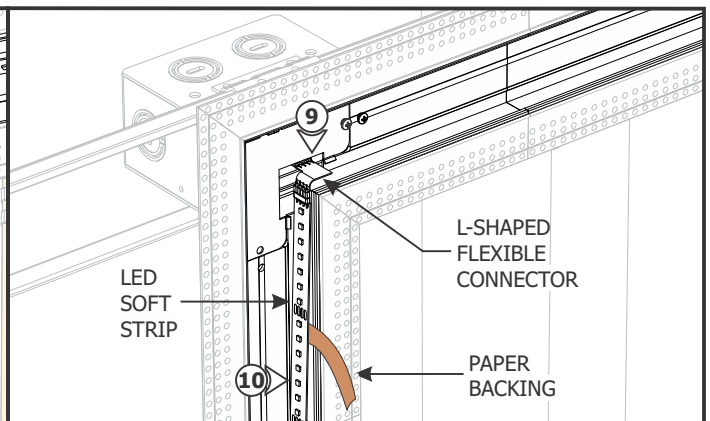
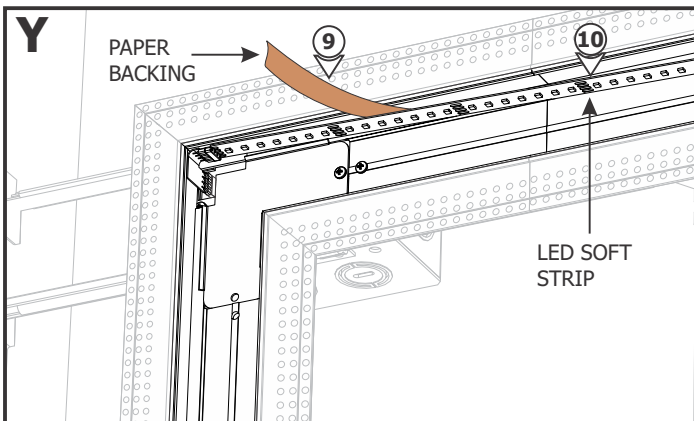
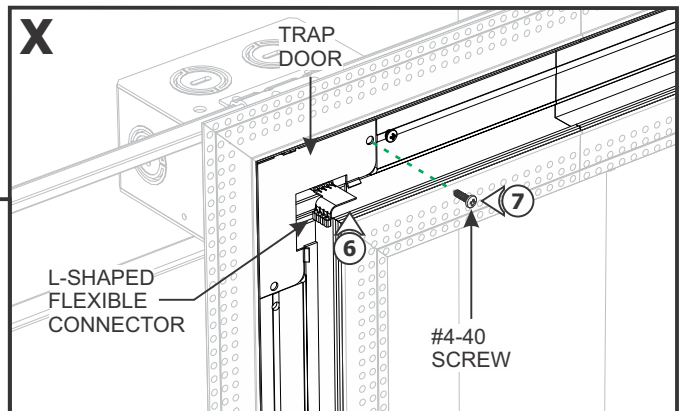

**NOTE:** If installation requires RGB, RGB+W, or Tunable White, refer to wiring diagrams on pages 11-13.

- 9:** Carefully remove the backing from the LED Soft Strips, making sure not to remove the tape. Line up the red wire side of the power connector with the "+24VDC" marking on each LED Soft Strip. Push the male connector of the LED Soft Strips into the L-Shaped Flexible Power Connectors.
- 10:** Firmly press down the adhesive portion of the LED Soft Strips onto the channel surface while removing the rest of the backing, making sure there are no air bubbles that can cause surface irregularities.

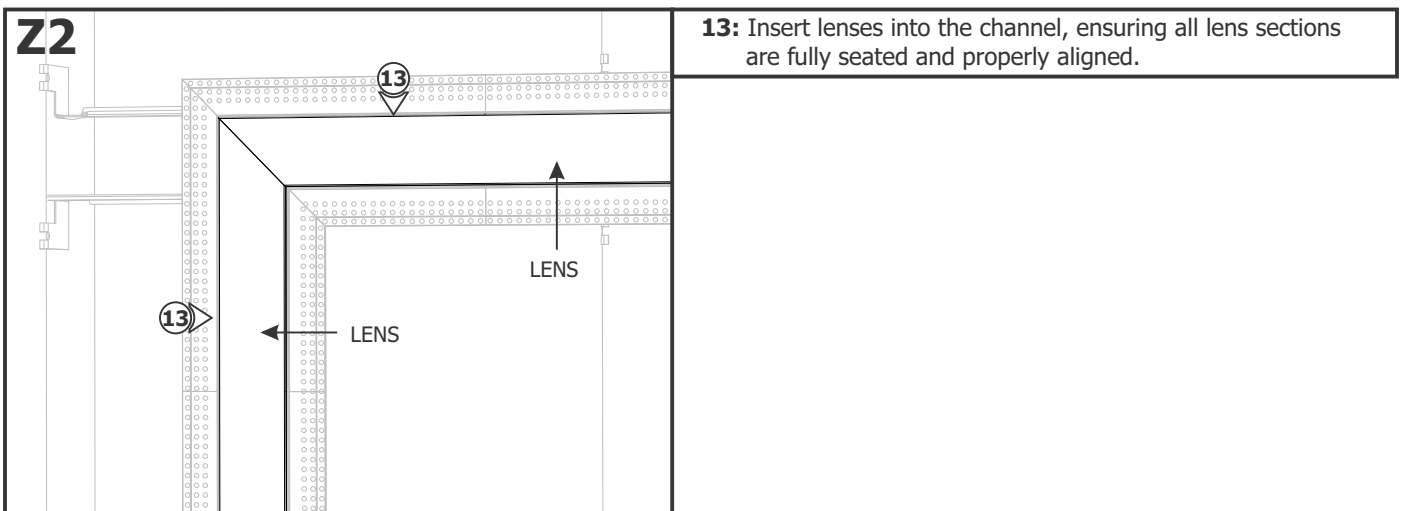
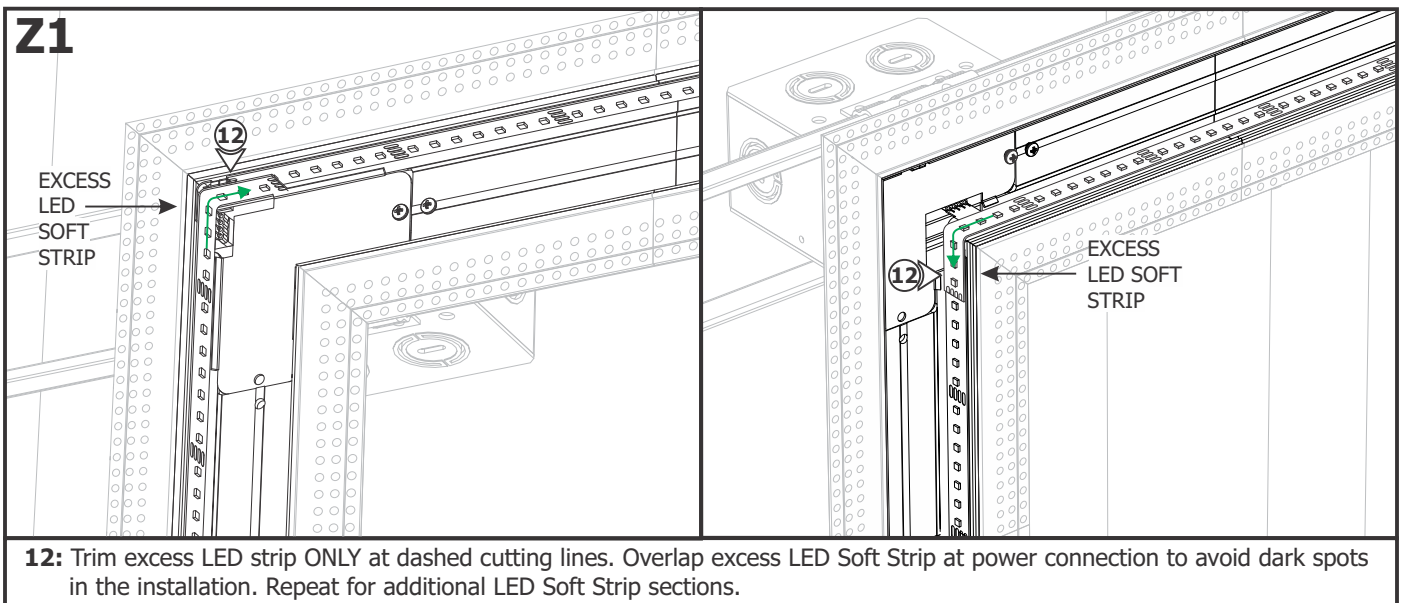
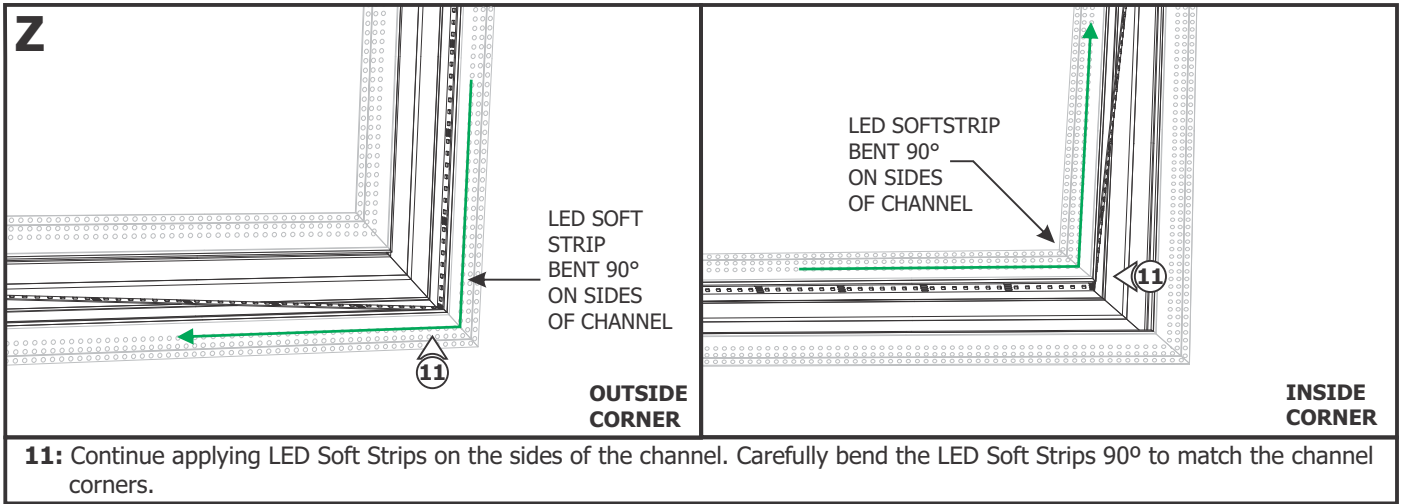



## Section Four: Installing the LED Soft Strip with Multiple Feeds

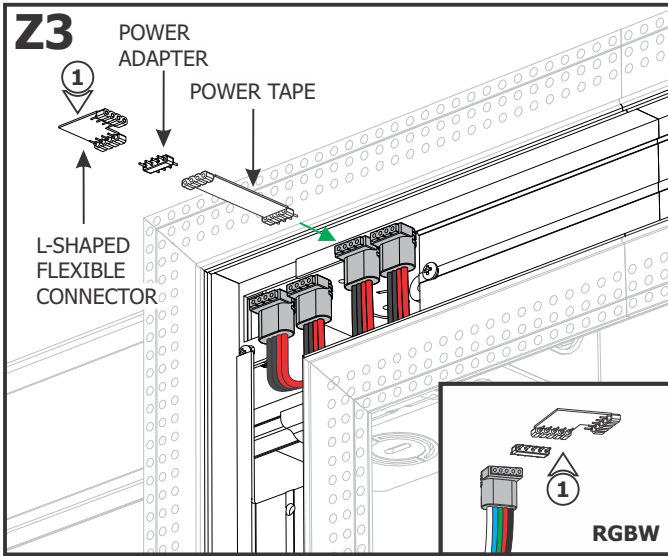

**1:** Refer to steps 1 through 4 in Section Three to uncoil the LED Soft Strip and connect each power connector to the Blank Power Tape (not used with RGBW), Power Adapter and L-Shaped Flexible Connector.

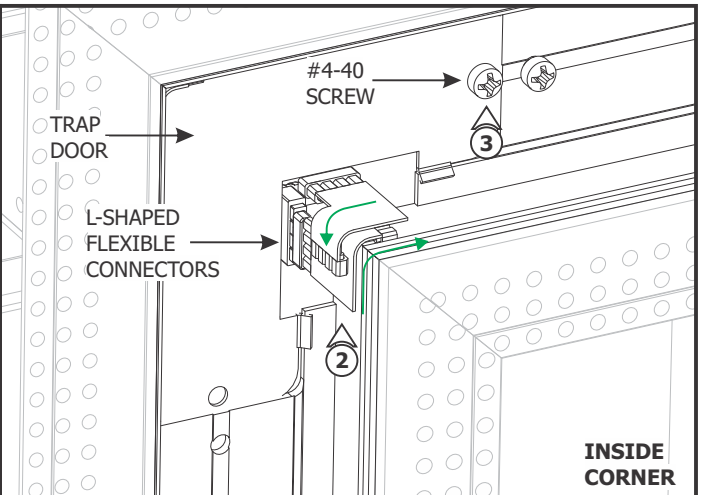
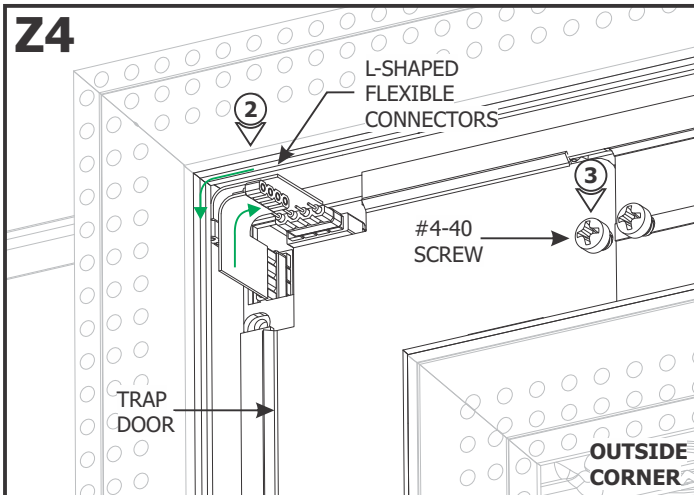

**2:** Place the assembled power connectors into the channel where the LED Soft Strips will be installed. L-Shaped Flexible Connectors should be overlapped as shown.

**3:** Replace the trap door and secure using the #4-40 screw.

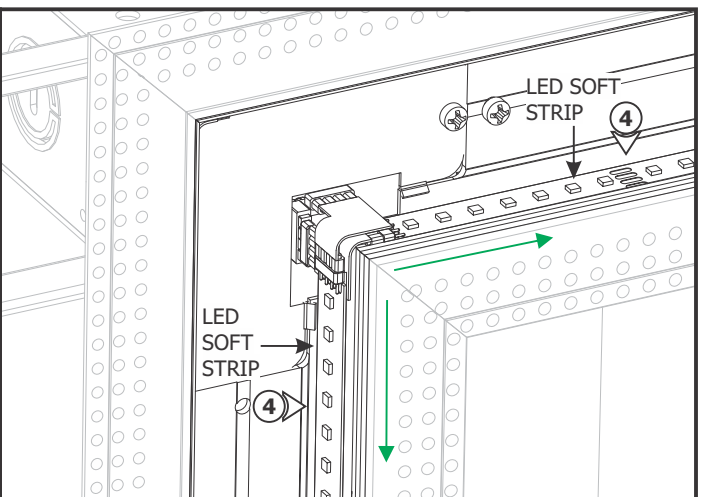
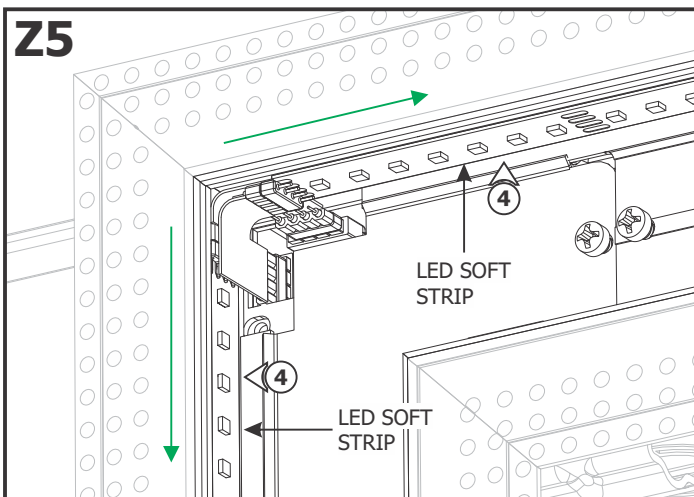

**4:** Repeat steps 9 through 12 in Section Three to install the LED Soft Strips.

**5:** Insert the lenses into the channel, ensuring all lenses are fully seated and properly aligned.

## IMPORTANT INFORMATION REGARDING INSTALLATION AND REWORK OF SOFT STRIP LED

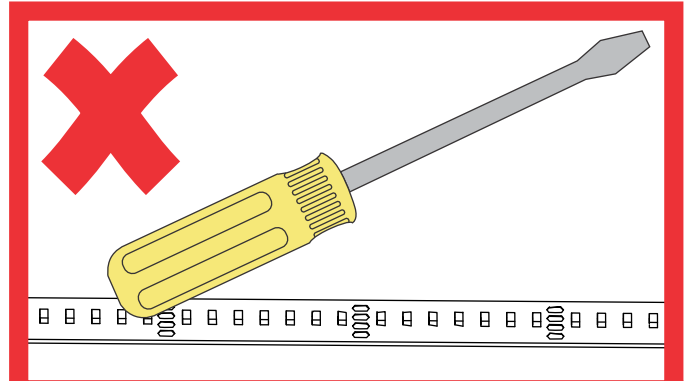
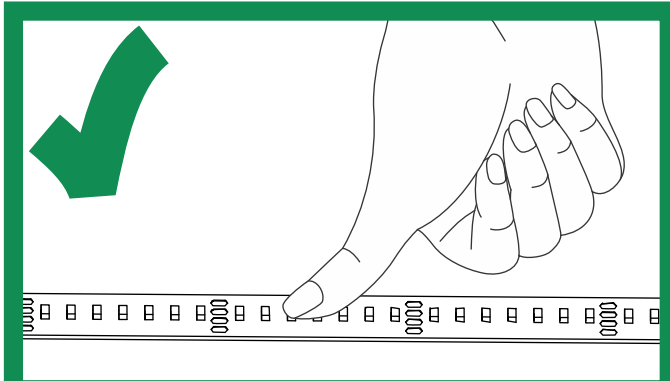
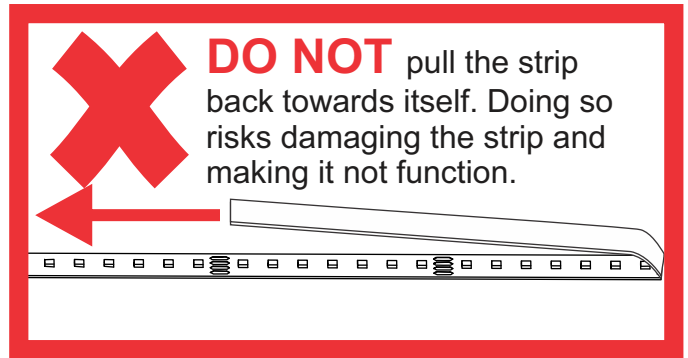
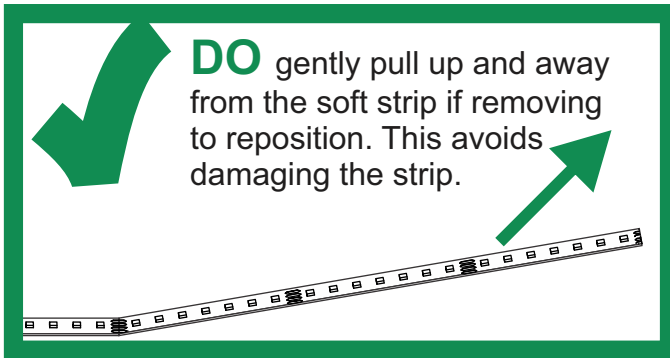

**DO** only ever use fingers to gently install soft strip to a surface AFTER cleaning the surface with alcohol.

**DO NOT** use any tool to install soft strip to a surface. This will damage the soft strip component.

### Relocating Soft Strip (Optional)

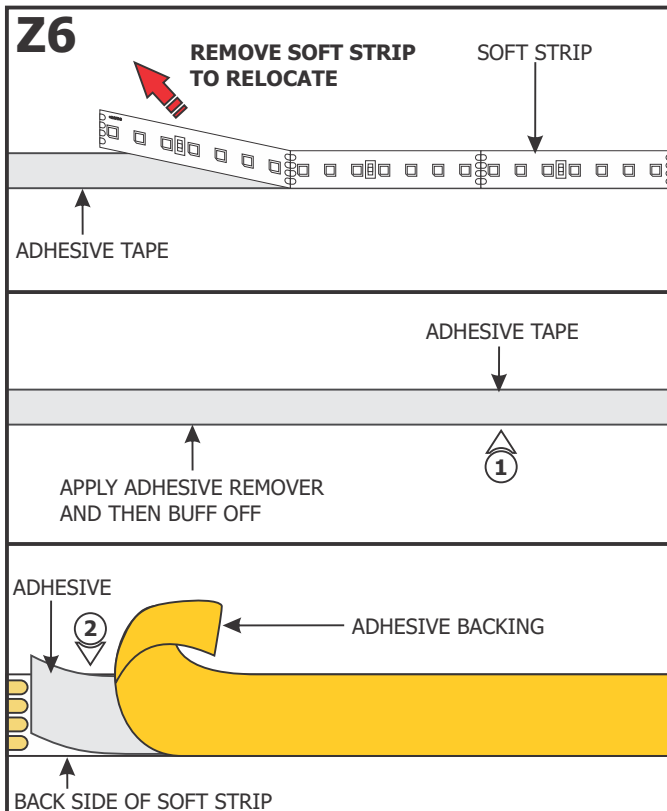

**NOTE:** If relocating the installed soft strip, make sure that the adhesive tape on back of the soft strip covers the entire strip. The adhesive tape isolates the strip from the installation surface. Damaged or inconsistent adhesive tape may cause the contacts on the back of the strip to come in contact with the conductive heat sink which will cause the strip to short and burn. Call Edge Lighting to get replacement adhesive tape and/or optional aluminum heat sink tape (SS-HR-F)

- 1:** To remove tape residue from back of the strip, apply WD-40, Goo Gone, or a mixture of warm water and lemon oil to the corner of a clean, dry towel. Gently buff the area containing the adhesive residue until it is completely removed.
- 2:** Gently remove a few inches from one side of the tape backing. Attach the adhesive tape to the back of the soft strip and apply moderate pressure to affix the tape. Continue this step a few inches at the time until the entire adhesive tape is attached to back of the soft strip.
- 3:** Refer to the steps in Section 3 or Section 4 to reinstall the soft strip.

# Wiring Diagrams

## General 24VDC Configuration

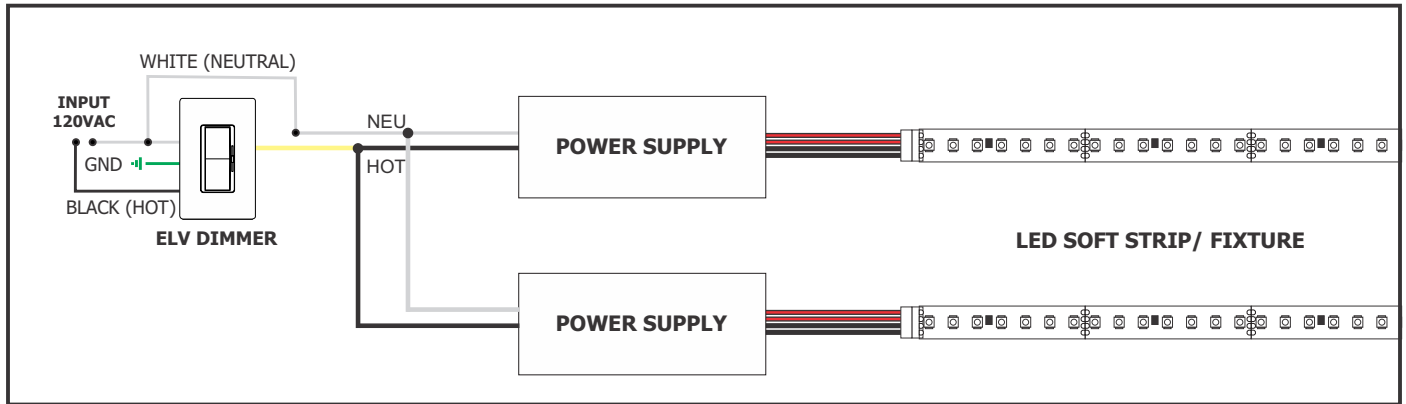

## Standard RGB Configuration

**Using LED Power Supply with RGB Soft Strip & CDP, CTP, or CDMX Control**

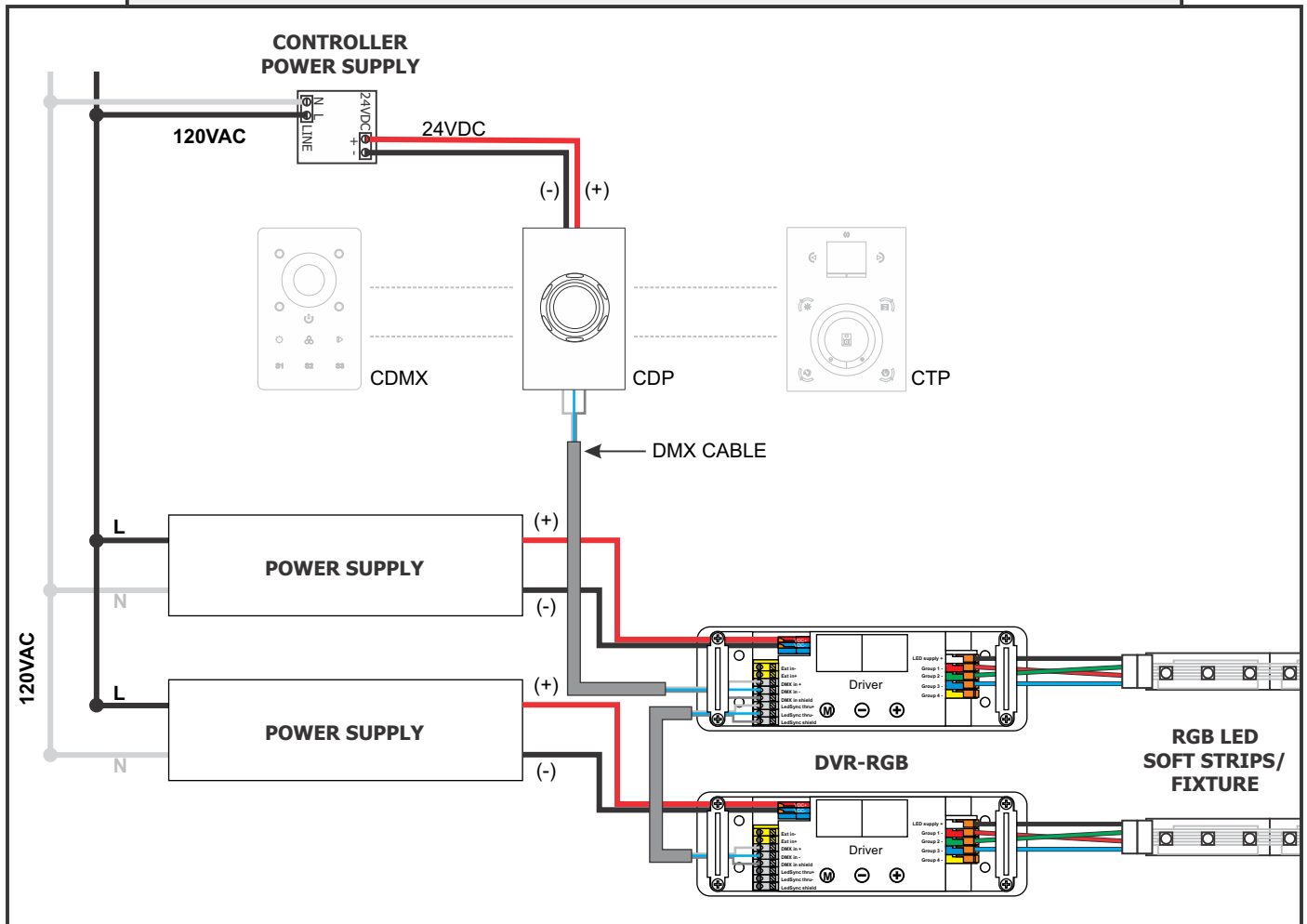

# RGB+W Configuration

Using LED Power Supply with RGB+W Soft Strip & CDP, CTP, or CDMX Control

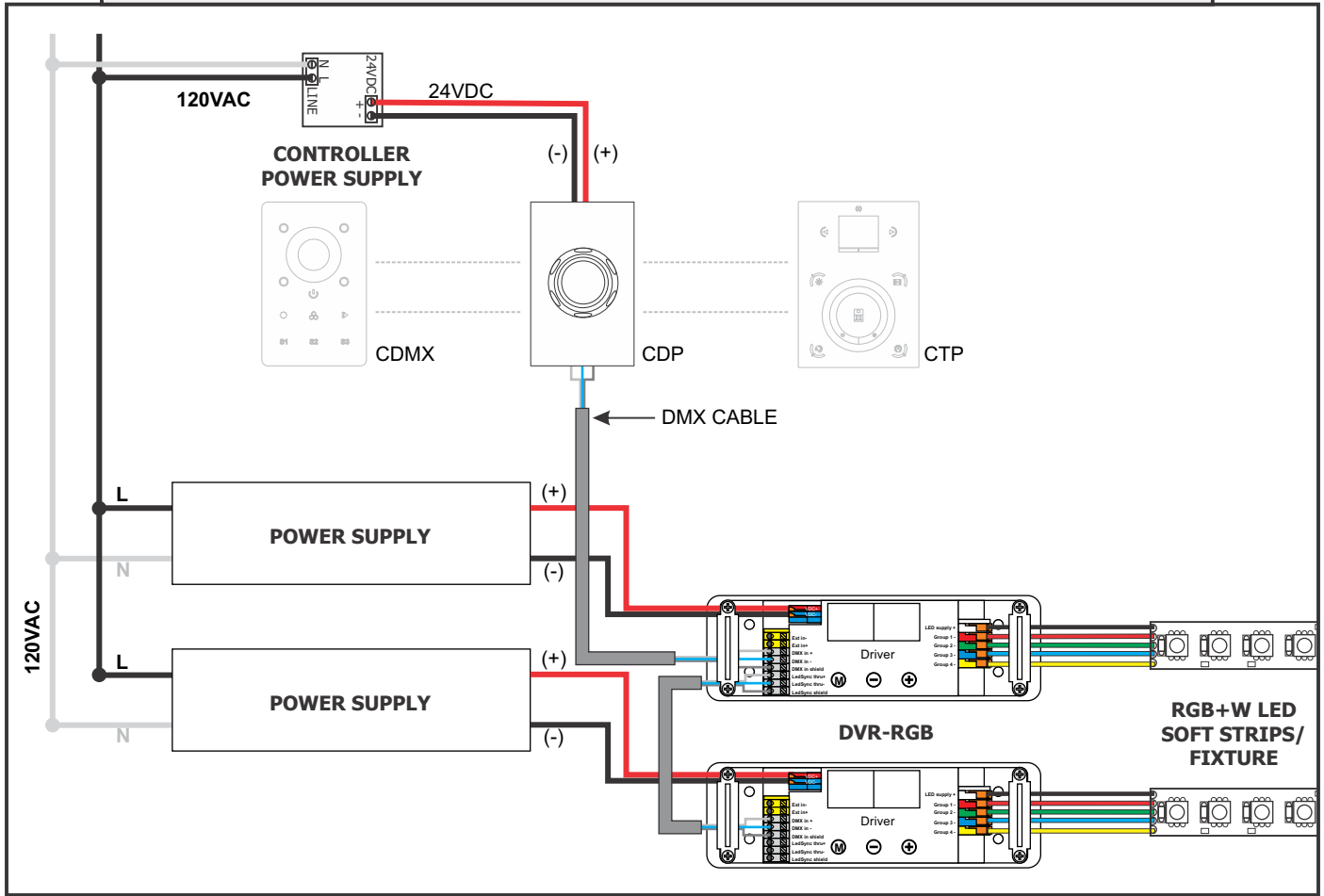

# Tunable White Configuration

Dual Power Supplies Controlled Via Individual ELV Dimmers

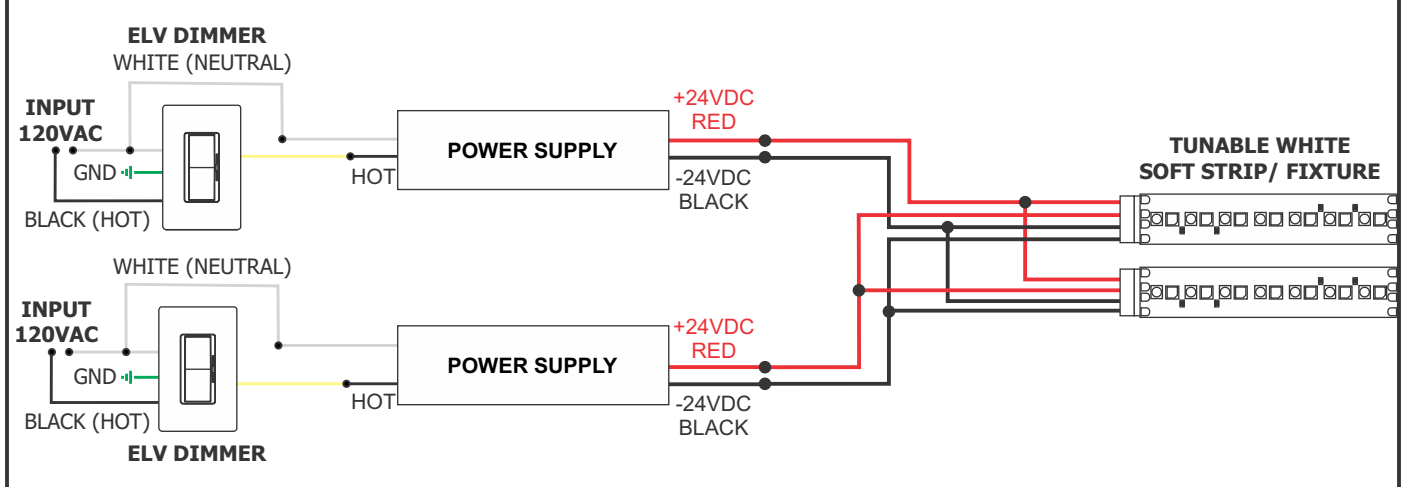

# Tunable White Configuration

## Power Supply with DMX Driver

If using a CDP Color Dial, configure your CDP to Warm White mode using DIP switches and follow CDP operating instructions:

