



1718 W. Fullerton Chicago, IL 60614
 Ph: 773.770.1195 • Fax: 773.935.5613
 www.PureEdgeLighting.com • info@PureEdgeLighting.com
 © 2016 PureEdge Lighting. All Rights Reserved.

Installation Instructions for TruLine 1.6A L-Picture Frame Power Channel Connector

TL1.6A-LP_ _

IMPORTANT INFORMATION

- This instruction must be used concurrently with other TruLine 1.6A DIY installation instructions.
- This product is wall or ceiling mount.
- This instruction shows a typical installation.
- This product must be installed by a qualified electrician and in accordance with local electrical codes.

SAVE THESE INSTRUCTIONS!

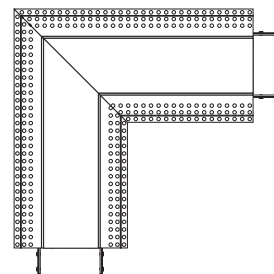

Section One: Install the Junction Box

A

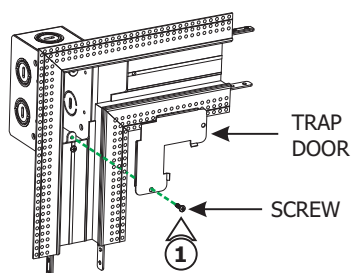

1: Remove the screw from the junction box to remove the trap door from the assembly.

B

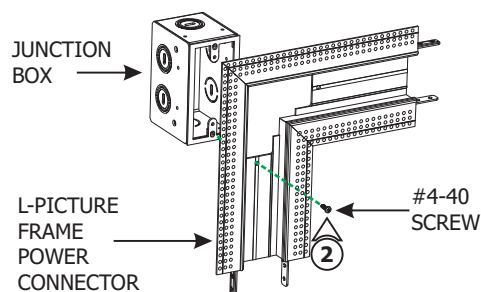

2: Remove the #4-40 screw from the junction box to remove the L-Picture Frame Power Connector Assembly.

C

HORIZONTAL ORIENTATION

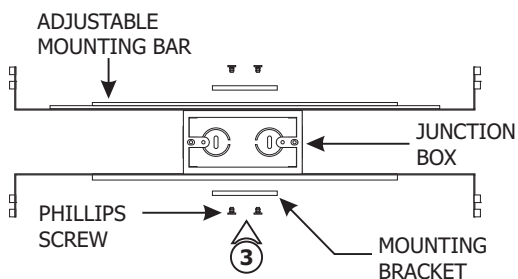

VERTICAL ORIENTATION

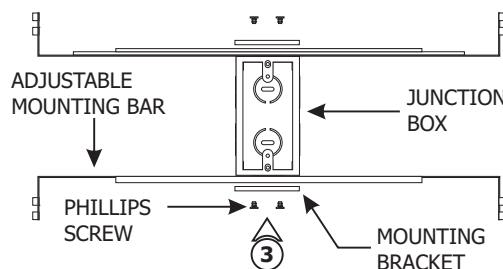

3: Mount each adjustable mounting bar to one side of the junction box and secure them with the mounting brackets and two Phillips screws provided.

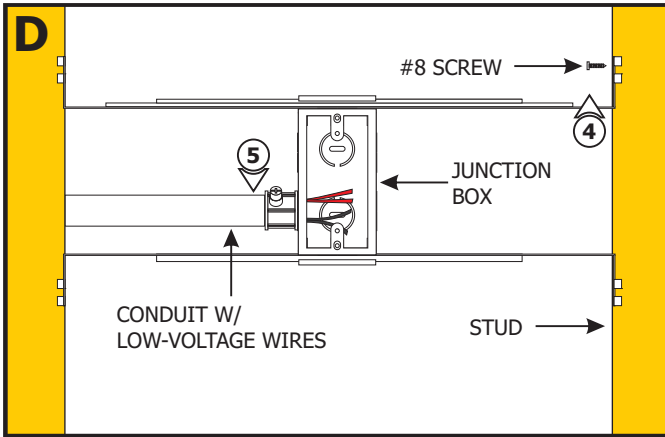

NOTE: The adjustable mounting bars mount to studs that are spaced 15" to 24" apart. If the span needs to be shorter than 15", then break the bar arms from dedicated lines.

4: Place the lips on the adjustable mounting bars against the studs. Secure the adjustable bars to the studs with the #8 screws.

5: Install conduit(s) (if required by local electrical code) and run the 24VDC low voltage wires coming from the power supply to the junction box. Refer to the instructions provided with the power supply.

6: Cut a section of drywall using a 6" fixed jab saw or other appropriate tool to expose the mounting plate area.

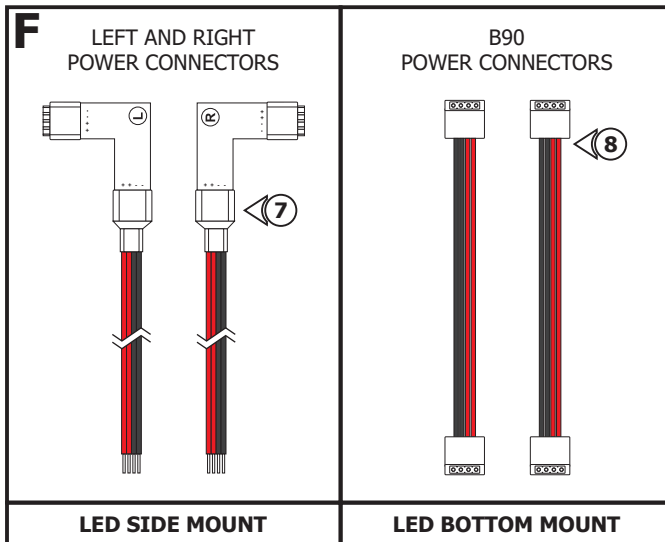
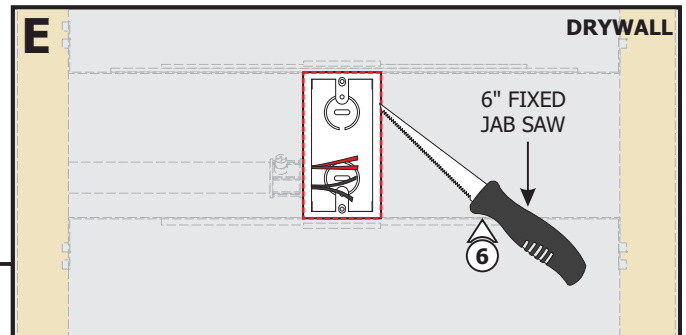

7: For installations where the LED strip will be installed on the **side** of the channel, use the Left and Right Power Connectors.

8: For installations where the LED strip will be installed on the **bottom** of the channel, use the B90 Power Connectors.

9: Determine which power connector will be used. Strip 3/8" off of the power connector wires.

NOTE: L-Picture Frame Power Connector could feed the strip one or both directions. When using to feed one direction, discard the other connectors.

10: For B90 Connectors, cut the end of the power connector that is going to be connected to power. Discard the unused connector. Strip the ends of the wires.

NOTE: If installation requires RGB, RGB+W, or Tunable White, refer to wiring diagrams on pages 8 and 9.

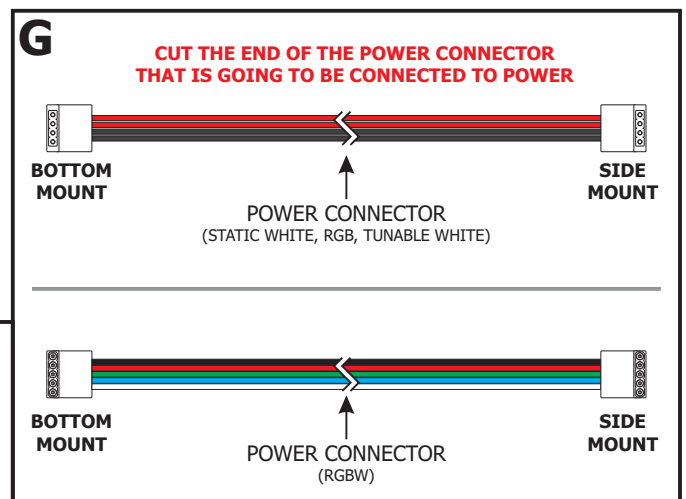

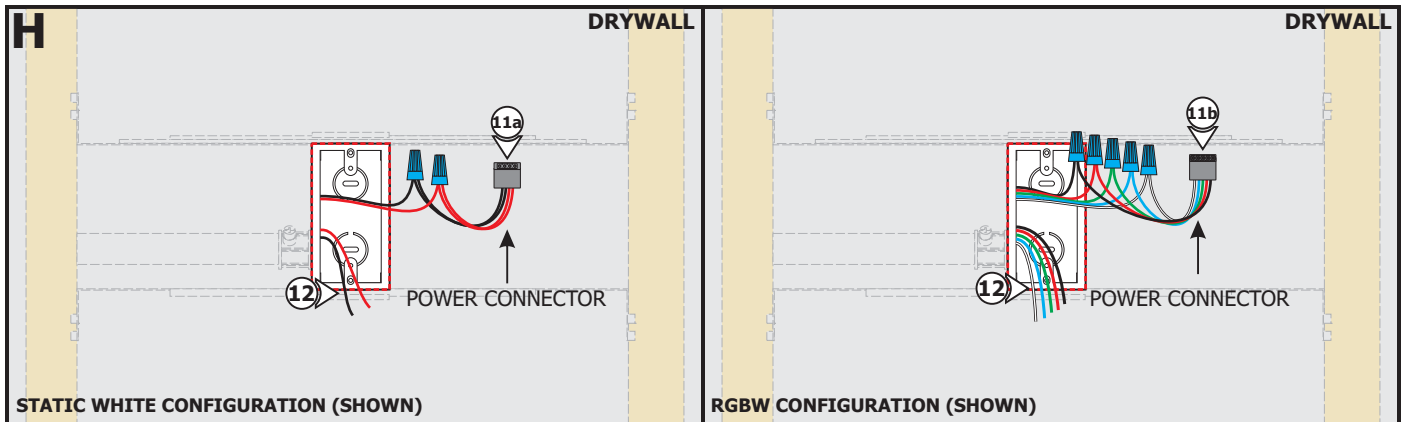

NOTE: Remote power supply wires must be present in junction box. Refer to instructions provided with the power supply.

NOTE: Note the alignment of the +24VDC connection of the power connector to ensure proper alignment when installing the LED Strip in later steps.

11a: Connect the +24VDC low voltage wire of the power supply to the red wires of the power connector using a wire nut. Connect the -24VDC low voltage wires of the power supply to the black wires of the power connector using a wire nut.

11b: For RGBW Configurations, connect the black, red, green, blue and white wires of the DMX decoder respectively to the black, red, green, blue, and white wires of the power connector using wire nuts.

12: Repeat step 11 for additional power connectors and power supplies.

13: Place all wire nut connections inside the junction box.

CAUTION: Unroll the entire LED strip from the reel. Use the power connectors to power the strip making sure there is no outage before continuing with the installation (refer to Sections Three or Four for proper connections). Afterwards, carefully roll the LED strip loosely back into the reel.

Section Two: Prepare and Install the L-Picture Frame Power Connector

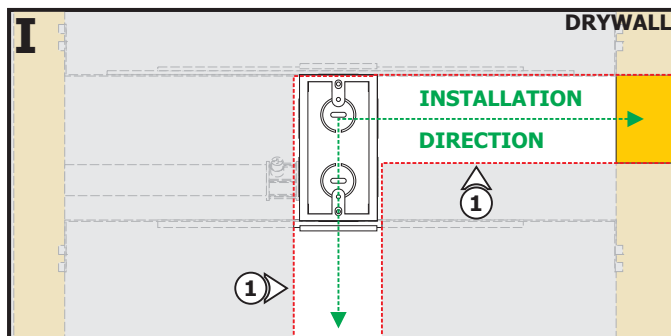

1: Mark and cut out the area where the installation will be located using the junction box opening as a guide (MIN 2.25").

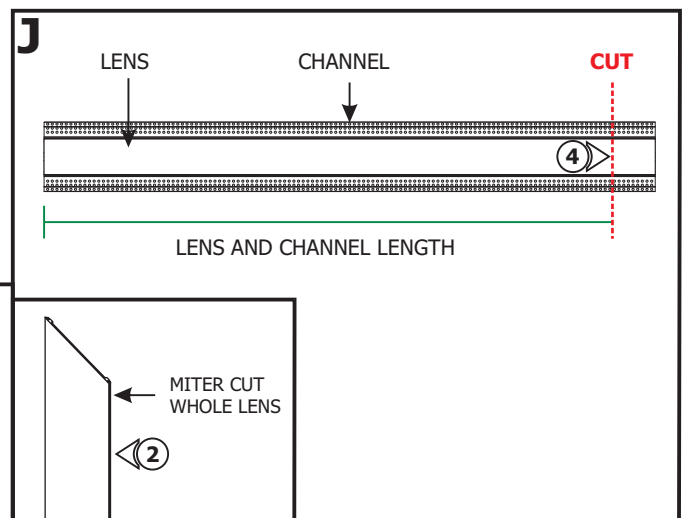

2: To avoid seams and light leaks, use the precut lenses that were provided with the L-Picture Frame Power Connector as a guide to miter cut the whole lens.

3: Discard the precut lens.

4: Refer to Section One in the TruLine 1.6A Channel and Lens instructions to measure and cut the channel and lens.

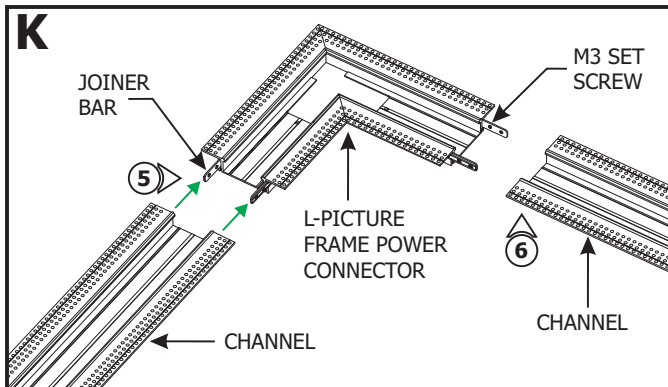

5: Slide a channel onto the joiner bars and tighten the remaining M3 set screws with a 1.5mm Allen wrench.

6: Repeat step 5 for the other end of the L-Picture Frame Power Connector.

7: Place the assembled channel to the cutout area and attach the assembled trap door frame to the junction box using the #4-40 screw.

NOTE: Refer to Section Three in the TruLine 1.6A Channel and Lens instructions to plaster before continuing.

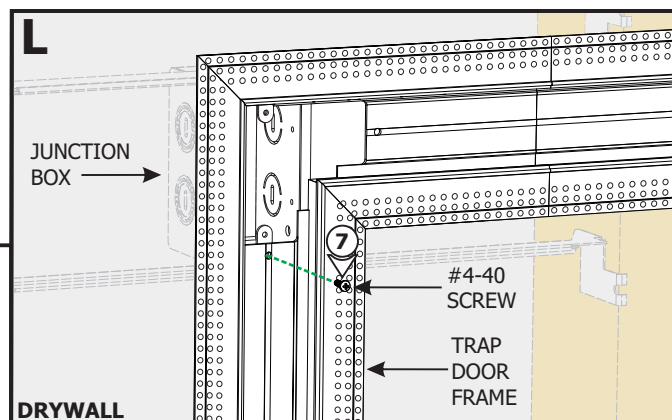

Section Three: Install the LED Strip - Single Feed (side mount)

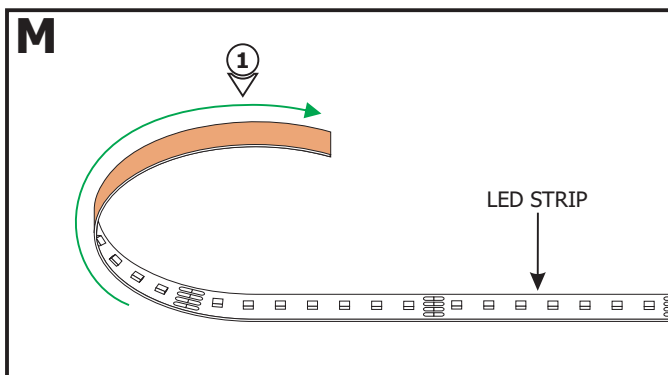

NOTE: LED Strip may not properly adhere to the channel surface unless the channel is cleaned with alcohol prior to application.

1: Gently uncoil the LED Strip before applying to the channel otherwise the strip may lift off of the surface.

2: Carefully remove the backing from the power connector making sure not to remove the tape.

3: Place the outer corner power connector into the channel where the LED Strip will be installed.

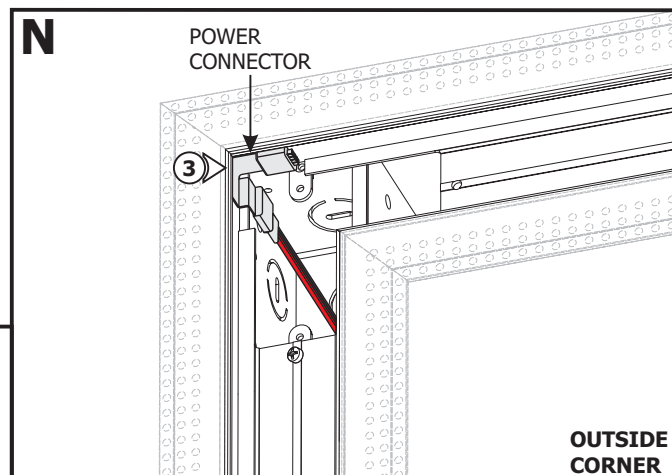

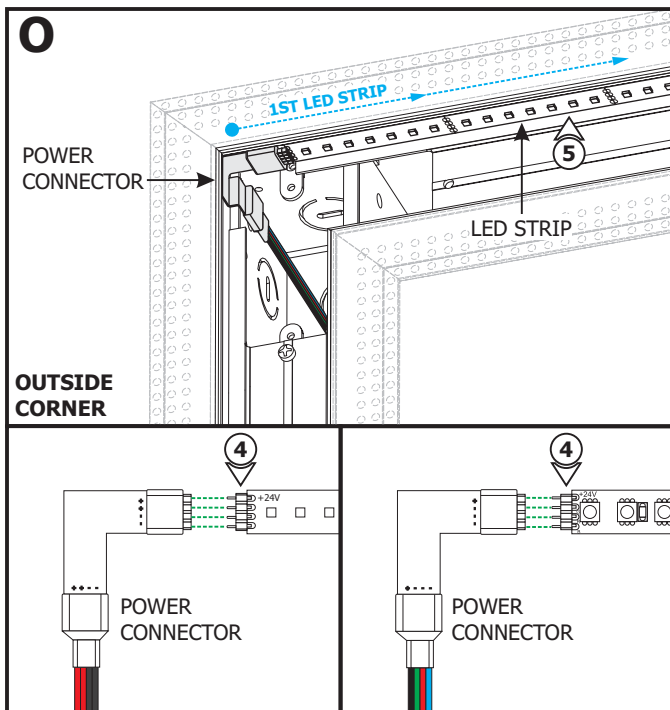

4: Carefully remove the backing from the LED Strips, making sure not to remove the tape. Line up the "+" side of the power connector with the "+" marking on the LED Strip. Push the male connector of the LED Strips into the power connectors.

5: Firmly press down the adhesive portion of the LED Strips onto the channel surface while removing the rest of the backing, making sure there are no air bubbles that can cause surface irregularities.

6: Place the power connector into the inner corner of the channel. Repeat step 4 to install the LED Strip.

7: Replace the trap door and secure using the screw.

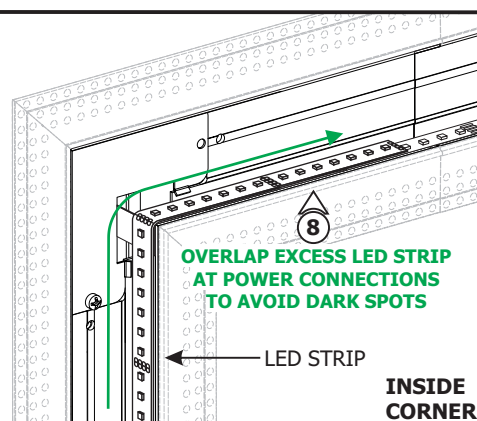
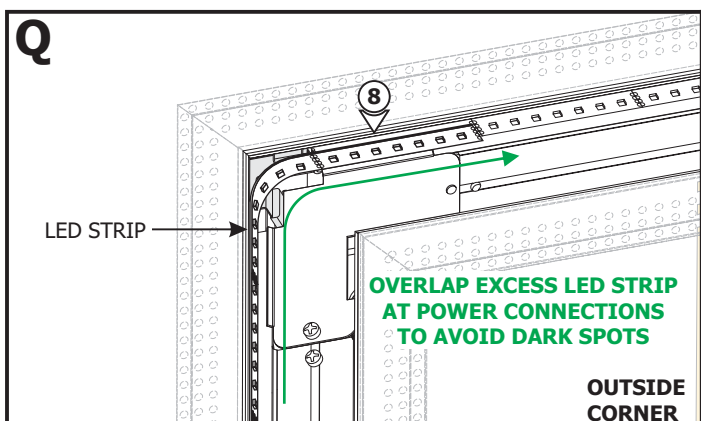
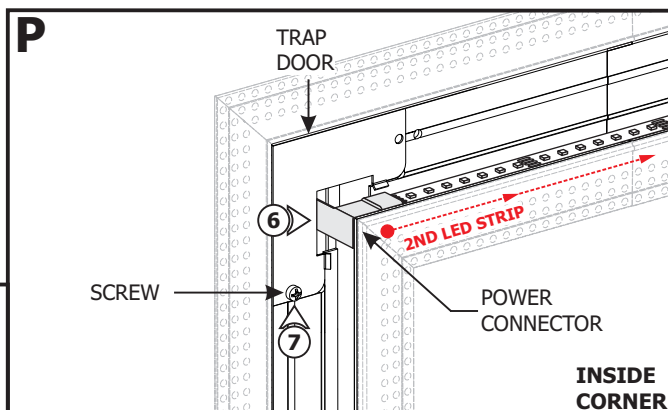

8: Trim excess LED Strip ONLY at dashed cutting lines. Overlap excess LED Strip at power connections to avoid dark spots in the installation.

Section Four: Install the LED Strip (bottom mount)

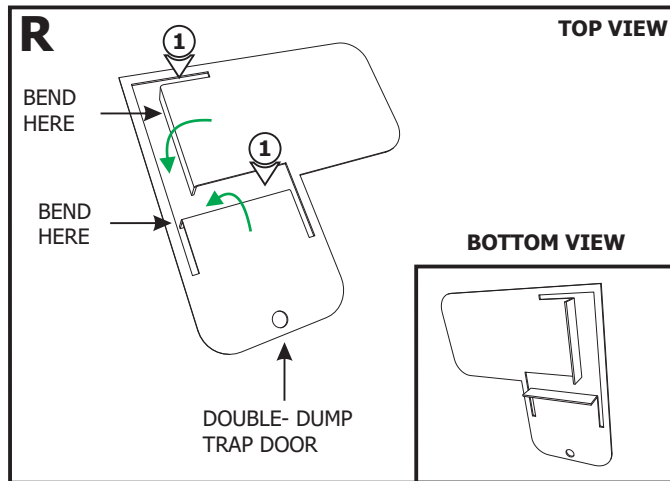

NOTE: For installations where the LED Strip will lay in the bottom of the channel it is necessary to use a double-dump trap door.

1: Use pliers to bend the sections of the trap door cover $\sim 90^\circ$ to allow for access to power connections.

2: Refer to step 1 in Section Three to uncoil the LED Strip.

3a: Line up the +24V connection side of the power connector with the "+24VDC" marking on the LED Strip. Push the pins of the LED Strip into the power connector.

3b: For RGBW Configurations, align the "RGBW" markings on the LED Strip with the corresponding wires of the power connector. Push the pins of the LED Strip into the power connector.

4: Repeat step 3 for the remaining power connectors.

5: To avoid any dark spots, feed the power connector and inside the junction box. If necessary, tuck the LED Strip slightly inside the junction box.

6: Firmly press down the adhesive portion of the LED Strips onto the channel surface while removing the rest of the backing, making sure there are no air bubbles that can cause surface irregularities.

7: If feeding one direction, trim excess LED Strips from other power feeds ONLY at dashed cutting lines and overlap them with the other LED Strips at the power connection to avoid dark spots in the installation.

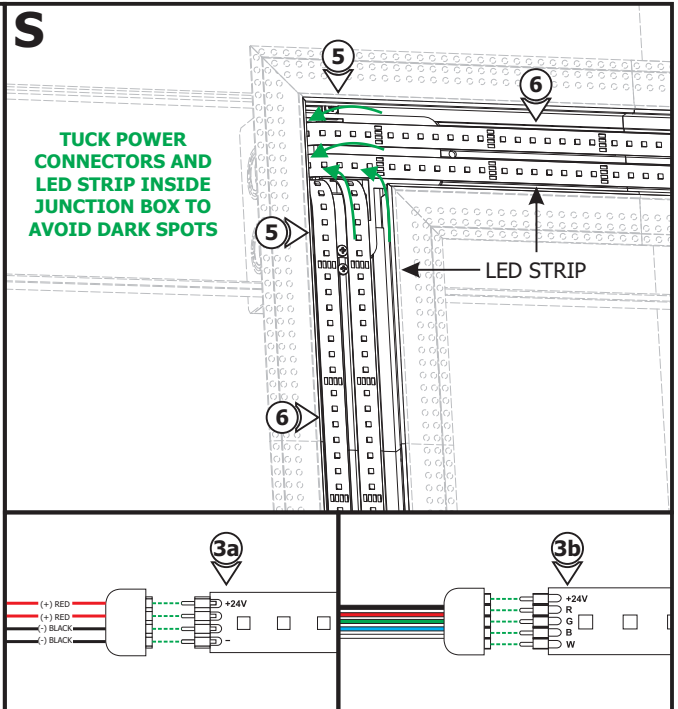

Section Five: Alternate LED Strip Installation (bottom mount)

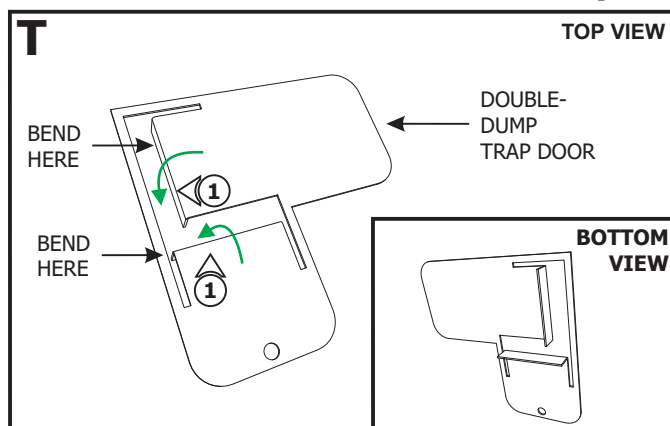

1: Use pliers to bend the sections of the trap door cover $\sim 90^\circ$ to allow for access to power connections.

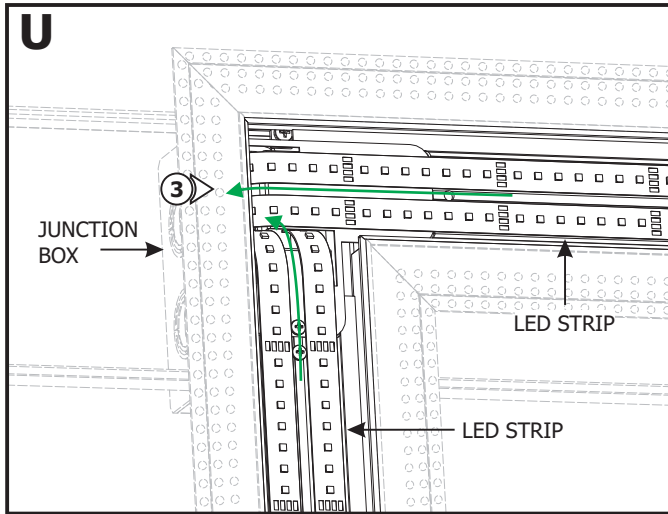

2: Attach the double dump trap door.

3: Route excess LED Strips from other power feeds into the junction box.

Section Six: Lenses

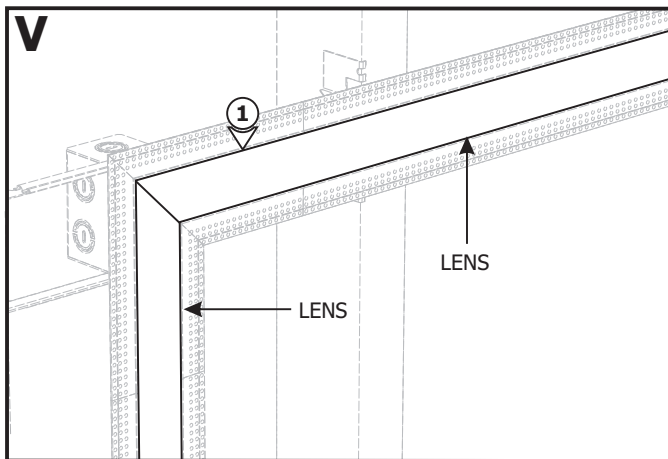

1: Use the whole lens to cover the L-Picture Frame Power Connector along with the rest of the installed channels.

General Wiring Diagrams

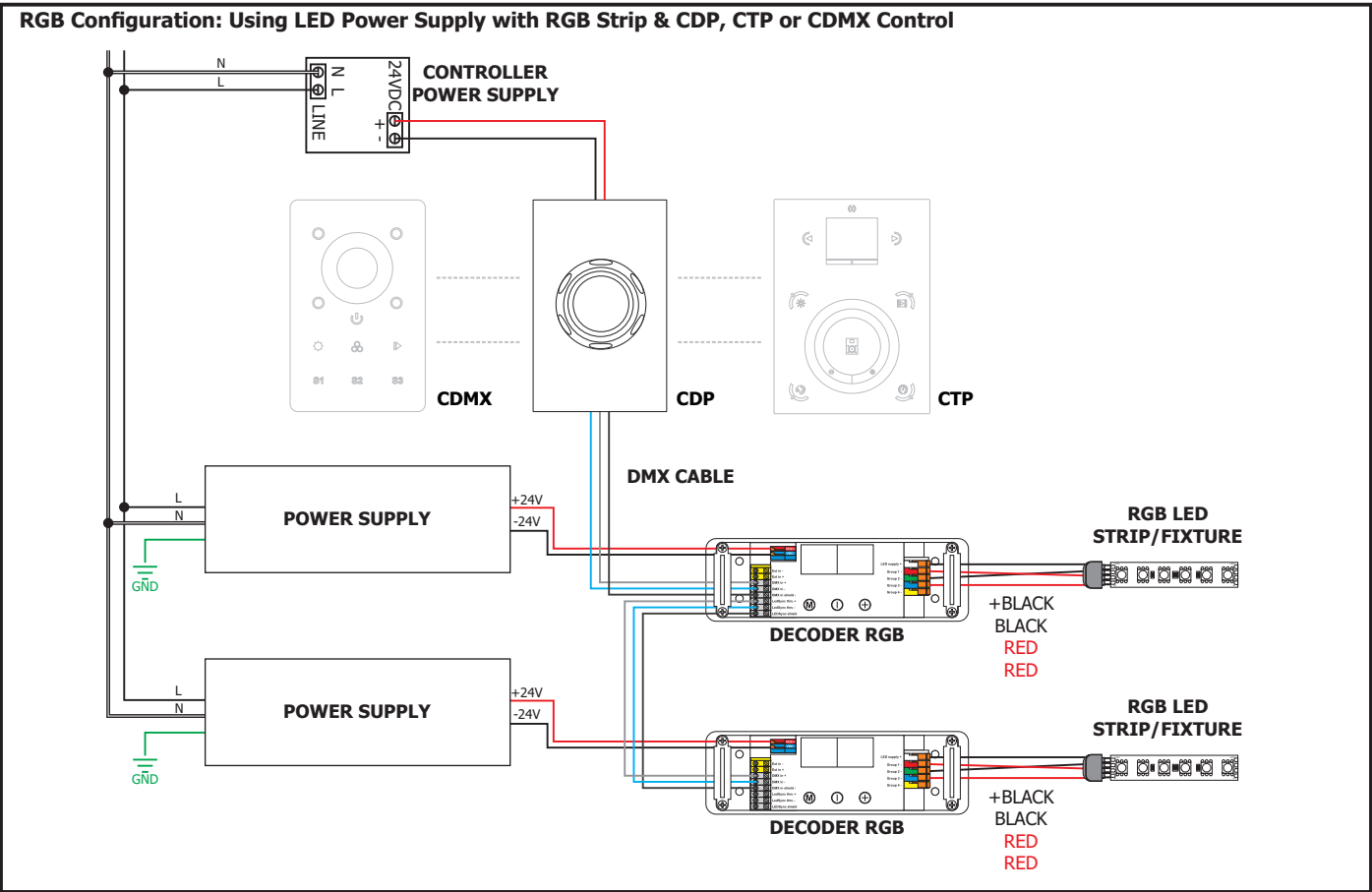
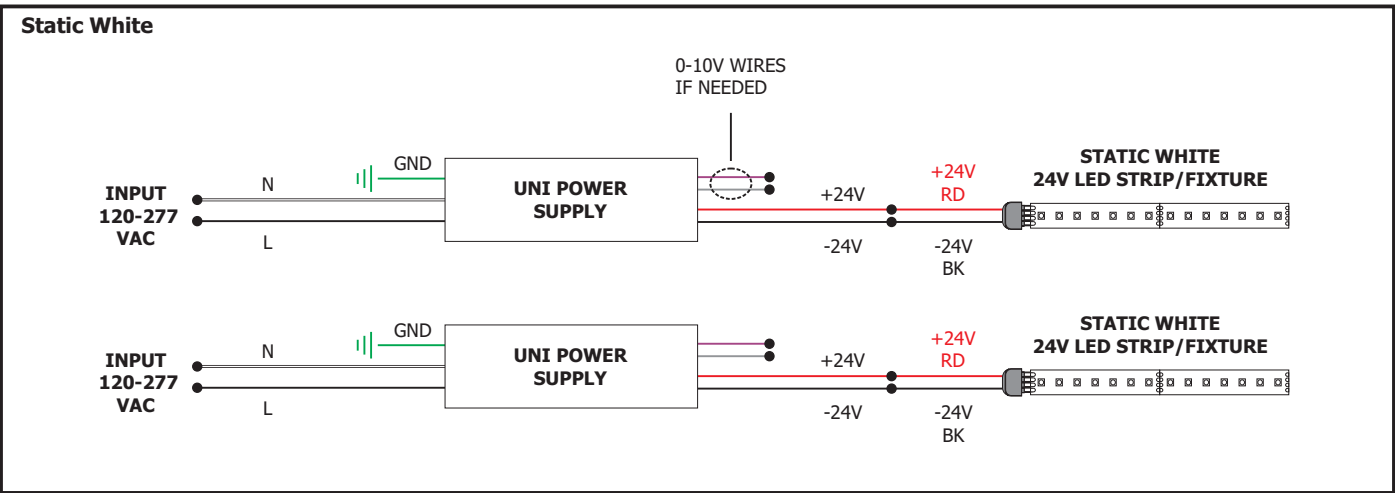

RGB+W Configuration: Using LED Power Supply with RGB Strip & CDP, CTP or CDMX Control

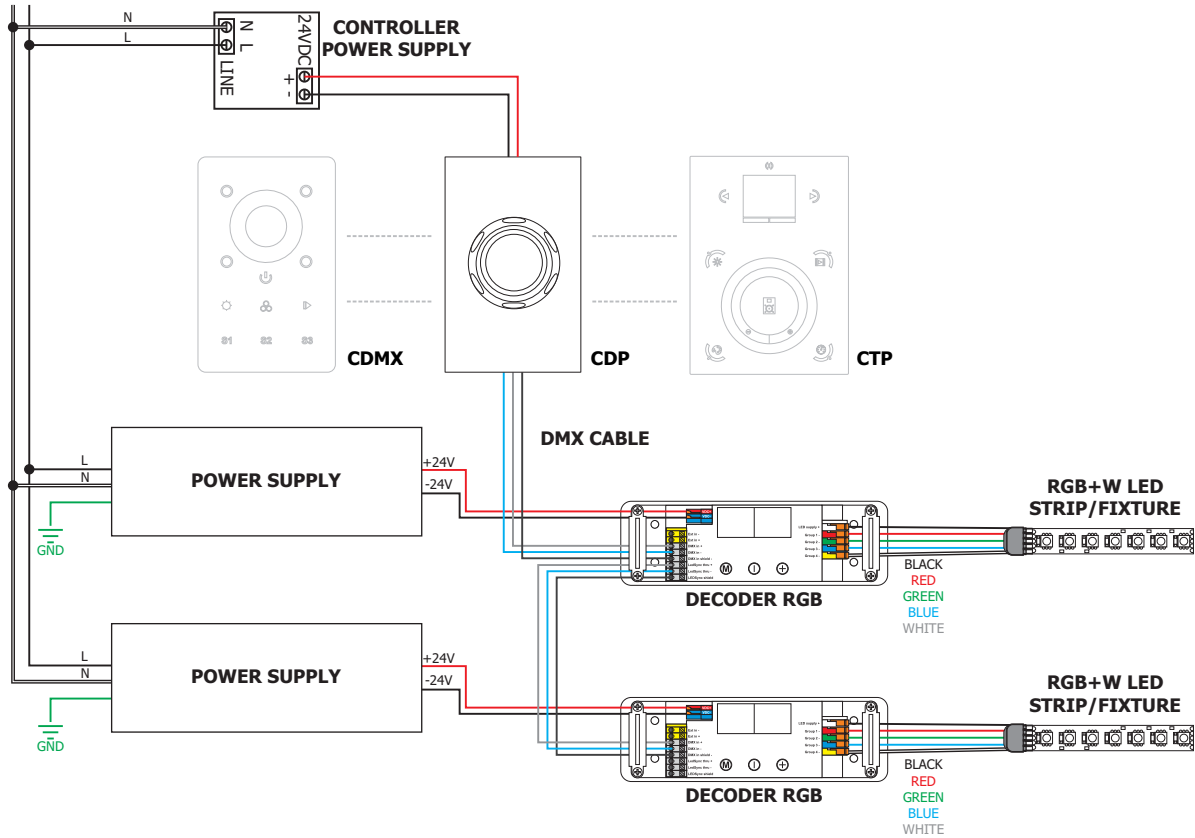

Tunable White: 2XK Power Supply with CDMX Controller

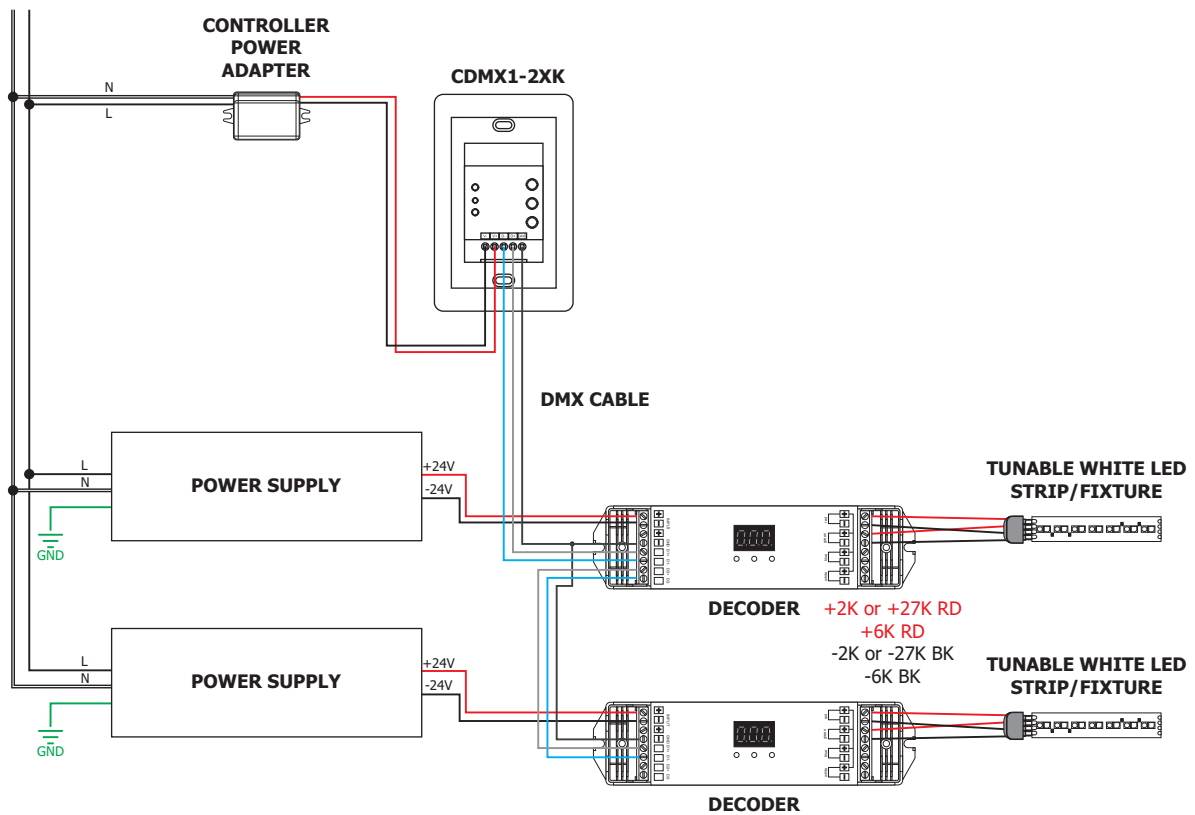

IMPORTANT INFORMATION REGARDING INSTALLATION AND REWORK OF SOFT STRIP LED



DO gently pull up and away from the soft strip if removing to reposition. This avoids damaging the strip.

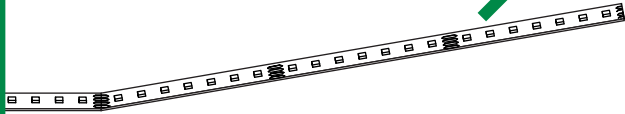

DO NOT pull the strip back towards itself. Doing so risks damaging the strip and making it not function.

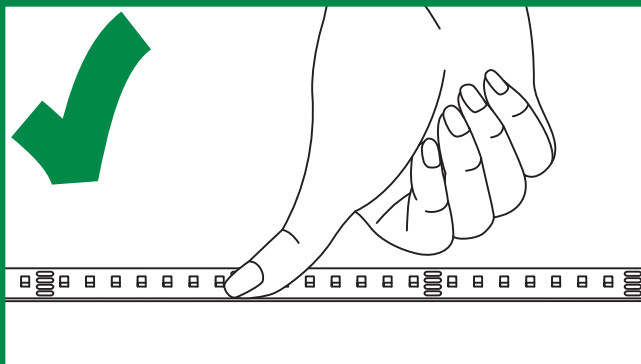
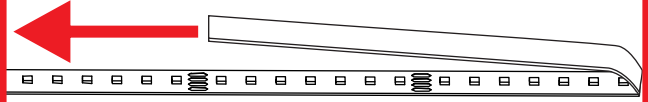

DO only ever use fingers to gently install soft strip to a surface **AFTER** cleaning the surface with alcohol.

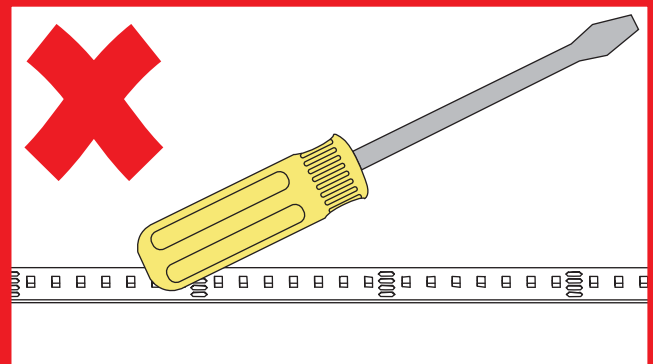

DO NOT use any tool to install soft strip to a surface. This will damage the soft strip component.

Relocating LED Strip (Optional)

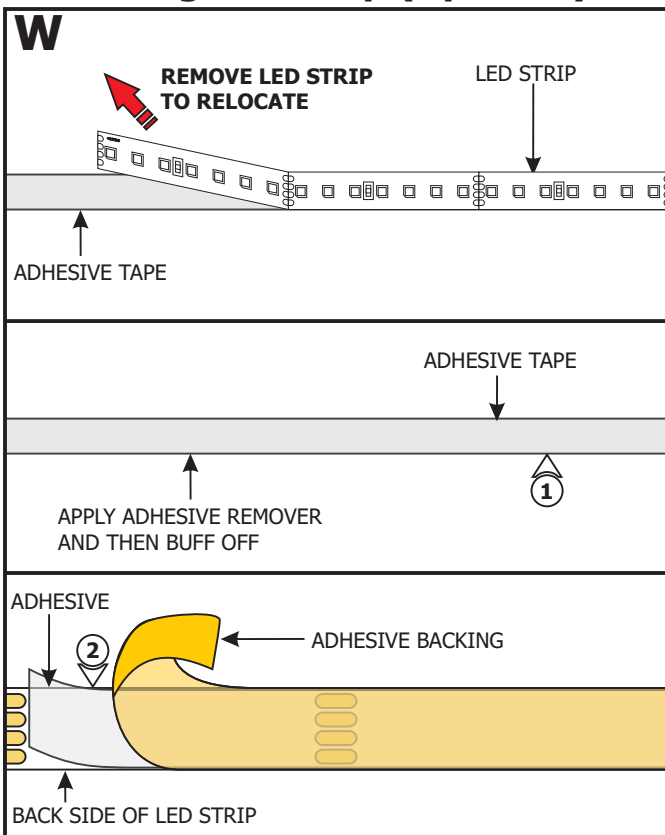

NOTE: If relocating the installed LED strip, make sure that the adhesive tape on back of the LED strip covers the entire strip. The adhesive tape isolates the strip from the installation surface. Damaged or inconsistent adhesive tape may cause the contacts on the back of the strip to come in contact with the conductive heat sink which will cause the strip to short and burn. Call PureEdge Lighting to get replacement adhesive tape and/or optional aluminum heat sink tape (SS-HR-F).

- 1:** To remove tape residue from back of the strip, apply WD-40, Goo Gone, or a mixture of warm water and lemon oil to the corner of a clean, dry towel. Gently buff the area containing the adhesive residue until it is completely removed.
- 2:** Gently remove a few inches from one side of the tape backing. Attach the adhesive tape to the back of the LED strip and apply moderate pressure to affix the tape. Continue this step a few inches at a time until the entire adhesive tape is attached to back of the LED strip.
- 3:** Refer to Sections Three through Five to reinstall the LED Strip.