

SS2P SOFT STRIP 2.3W 24VDC HIGH OUTPUT, PREMIUM RESIDENTIAL GRADE (84+CRI)

REV.02.03.17

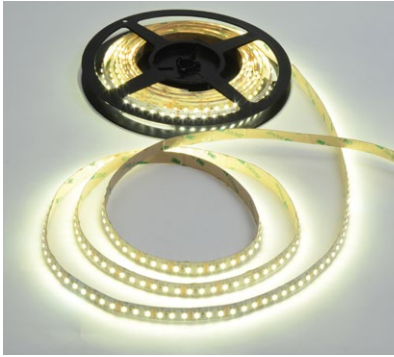

Maximum Length Before Refeeding: 40 Ft*

LENGTH IN FEET	TOTAL WATTAGE	LENGTH IN FEET	TOTAL WATTAGE
1	3	21	49
2	5	22	51
3	7	23	53
4	10	24	56
5	12	25	58
6	14	26	60
7	17	27	63
8	19	28	65
9	21	29	67
10	23	30	69
11	26	31	72
12	28	32	74
13	30	33	76
14	33	34	79
15	35	35	81
16	37	36	83
17	40	37	86
18	42	38	88
19	44	39	90
20	46	40	92

*25 Ft maximum when used with
PSB-60W-ELV-24VDC

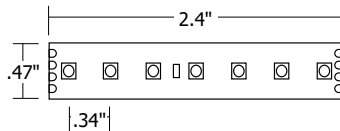

Description:

Premium 24 volt Soft Strip (SS2P) provides high levels of light with 84+ CRI warm white or very warm white LEDs, offering superior color rendering and enhanced color. The LEDs are distributed close together throughout the strip for uniform illumination without hotspots. The 1/2" wide flexible copper strip, with an optically clear protective coating, is sold in 1 ft increments up to 40 feet with cutting increments every 2.4 inches. Snap & Light Power Connector is required and is sold separately (pages 4-5). Additional Snap & Light Connectors (pages 4-5) are also available for making custom configurations. At only 2.3 system watts per foot, this system uses an electronic low-voltage or 0-10V power supply (sold separately). Self-adhering SS2P mounts to most smooth finished surfaces with industrial strength 3M tape (provided on back of strip); some unfinished surfaces may require screw-in mounting clips (sold separately). Designed for indoor/damp locations. Soft Strip is compatible with solderless Snap & Light Connectors. Fixtures include a 5 year warranty.

Applications:

Indoor/Damp Location - Task lighting, under/above cabinet, cove, retail clothing, work stations, closets, wine cellars and toe kicks. ETL listed to conform to UL 2108 for closet and under-cabinet applications.

Lamp:

Watts per Foot	Color Temp.	CRI	Lumens per Watt	per Foot	50,000 Hour Lamp Life
2.3	2700K	84+	72	166	●
2.3	3000K	84+	74	170	●

Average Lamp Life:

50,000 hours

24VDC Power Supply (sold separately):

PSB-96W-010-24VDC 120-277VAC input, 96 watt output

PSB-2X96W-010-24VDC 120-277VAC input, 2x96 watt output

PSB-3X96W-010-24VDC 120-277VAC input, 3x96 watt output

PSB-4X96W-010-24VDC 120-277VAC input, 4x96 watt output

PSB-60W-ELV-24VDC 120VAC input, 60 watt output

PSB-100W-ELV-24VDC 120VAC input, 96 watt output

PSB-2X100W-ELV-24VDC 120VAC input, 2x96 watt output

PSB-3X100W-ELV-24VDC 120VAC input, 3x96 watt output

PSB-4x100W-ELV-24VDC 120VAC input, 4x96 watt output

Dimming:

0-10 power supplies use 0-10V dimmer: Philips Sunrise SR1200ZTUNV.
ELV power supplies use ELV dimmer: Legrand, Adorne ADTP703TU;
Lutron: Diva DVELV-300P, Skylark SELV-300P, Maestro MAELV-600 and Radio Ra 2

Mounting Straps & Clips: (see page 6)

SS-SU

Use U-Strap every 6 to 12 inches for extra support (30 per package).

SS-ST

Use Tie Strap every 6 to 12 inches for extra support (30 per package).

SS-MCL

Mounts beneath strip, snapping strip in place for additional support (10 per package).

System	Voltage	Length in Feet	Color Temperature
SS2P	24V	40	30K
SS2P Soft Strip Premium 2.3W per Ft	24V 24 Volt	Sold in 1 ft increments up to 40 ft (Example 40=40')	27K 2700K Very Warm White 30K 3000K Warm White

PROJECT:

FIXTURE
TYPE:

DATE:



Application: Electronic low-voltage dimming for SS2P Soft Strip

Power Supply: PSB-60W-ELV-24VDC: 120VAC input, 24VDC 60 watt output

Dimming: Dimmable with low voltage electronic dimmer using power supply above. See power supply spec sheet for additional details. Lutron: Diva DVELV-300P; Skylark SELV-300P; Maestro MAELV-600 dimmers are recommended.

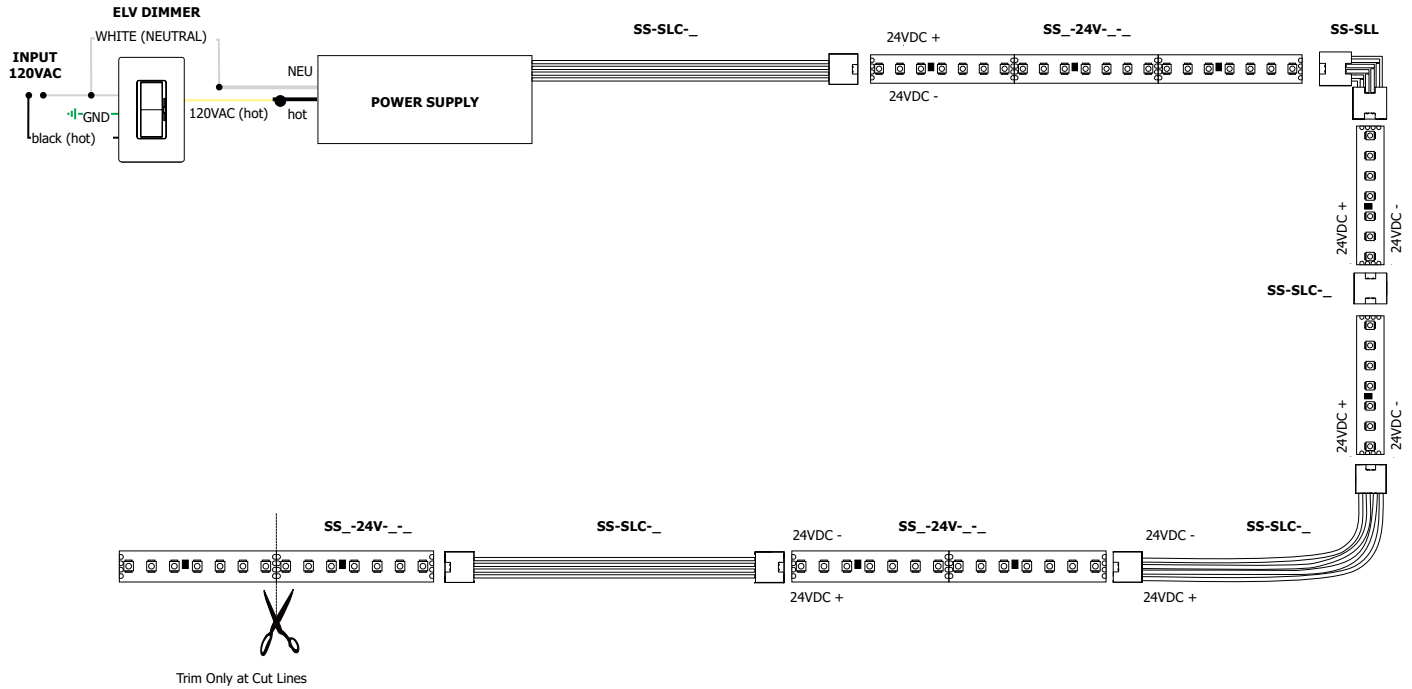

STRIP **DOES NOT** BEND 90°

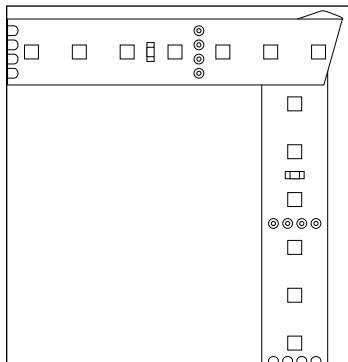

PROJECT:

FIXTURE
TYPE:

DATE:

Application: 0-10V dimming for SS2P Soft Strip

Power Supply: Class 2, 24VDC output: 120-277VAC input, 96 watt output PSB-96W-010-24VDC;
120-277VAC input, 192 watt output PSB-2X96W-010-24VDC

Dimming: Dimmable with 0-10V dimmer using power supply above. See power supply spec sheet for additional details. Philips Sunrise SR1200ZTUNV, 0-10V dimmer recommended.

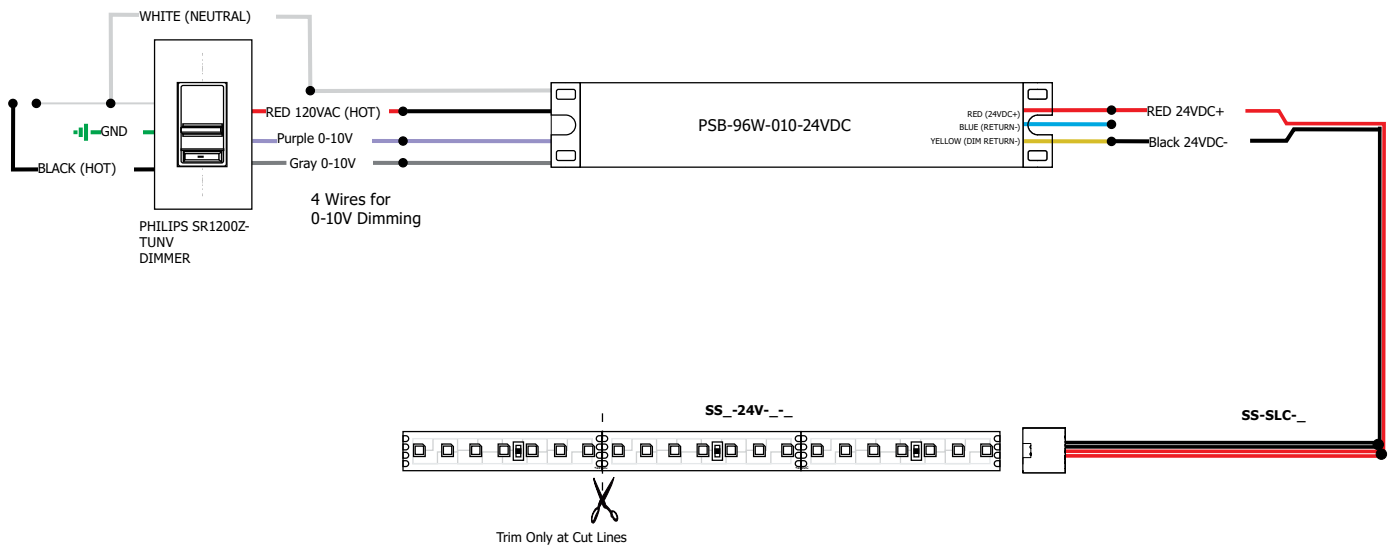

STRIP **DOES NOT** BEND 90°

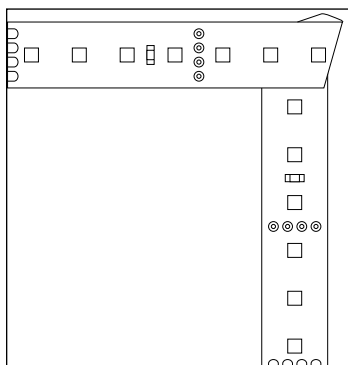

PROJECT:

FIXTURE
TYPE:

DATE:

EDGE
LIGHTING

SNAP & LIGHT ACCESSORIES

REV.02.03.17



Cut in middle of joining contacts



Scrape protective coating from contacts



Place the Strip end under the plastic guide and push under the snap contacts.



Close the cover

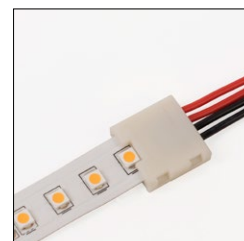

Snap the cover to secure in place

Snap & Light Accessories

Snap & Light Accessories provide easy connection of white or RGB Soft Strip sections. The do-it-yourself accessories — without limitations— allow cutting and rejoining of Soft Strip at any point. The accessories attach to the end of Soft Strip, secure the Strip and snap shut to lock it into place. Snap & Light Accessories ensure a tightly sealed connection, while the gold plated pins provide better connectivity without oxidation.

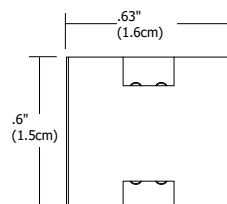

Snap & Light Straight Joiner Connectors

Snap & Light Straight Joiner Connectors join two cut sections of white or RGB Soft Strip end to end.

Product		Type
SS	—	SLC
SS Soft Strip		SLC Snap & Light Straight Connector

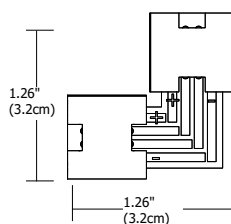

Snap & Light L-Connectors

Snap & Light L-Connectors join and conduct power to two sections of white or RGB Soft Strip in an L-shape.

Product		Type
SS	—	SLL
SS Soft Strip		SLL Snap & Light L-Connector

PROJECT:

FIXTURE
TYPE:

DATE:



SNAP & LIGHT ACCESSORIES

REV.02.03.17

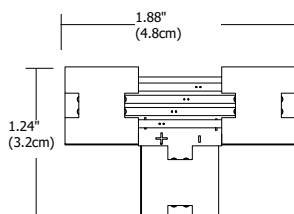

Snap & Light T-Connectors

Snap & Light T-Connectors join and conduct power to three sections of white or RGB Soft Strip in a T-shape.

Product	Type
SS	SLT
SS Soft Strip	SLT Snap & Light T-Connector

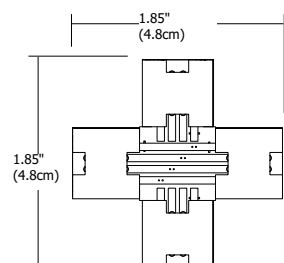
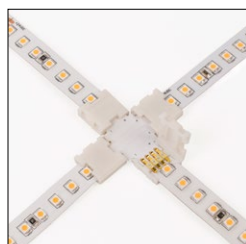

Snap & Light X-Connectors

Snap & Light X-Connectors join and conduct power to four sections of white or RGB Soft Strip in an X-shape.

Product	Type
SS	SLX
SS Soft Strip	SLX Snap & Light X-Connector

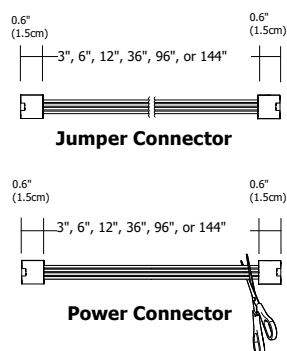

Snap & Light Jumper or Power Connectors

Snap & Light Jumper or Power Connectors join two cut sections of white or RGB Soft Strip end-to-end. Cut and strip the connector wires to use as a Power Connector.

Product	Type	Size
SS	SLC	12IN
SS Soft Strip	SLC Snap & Light Jumper or Power Connectors	
		3IN 3 Inches 6IN 6 Inches 12IN 12 Inches 36IN 36 Inches 96IN 96 Inches 144IN 144 Inches

PROJECT:

FIXTURE
TYPE:

DATE:



MOUNTING STRAPS

REV.02.03.17

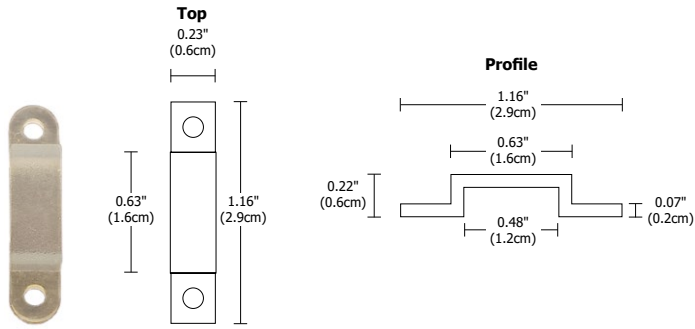

Soft Strip U Strap

Use U-Strap every 6 to 12 inches for extra support (30 per package).

System	Product
SS	SU
SS Soft Strip	SU U-Strap

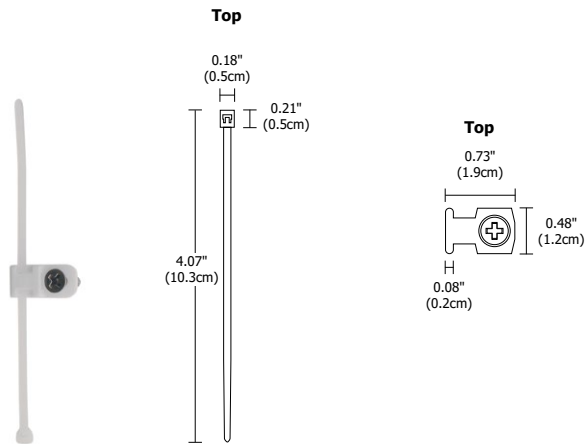

Soft Strip Tie Strap

Use Tie Strap every 6 to 12 inches for extra support (30 per package).

System	Product
SS	ST
SS Soft Strip	ST Tie Strap

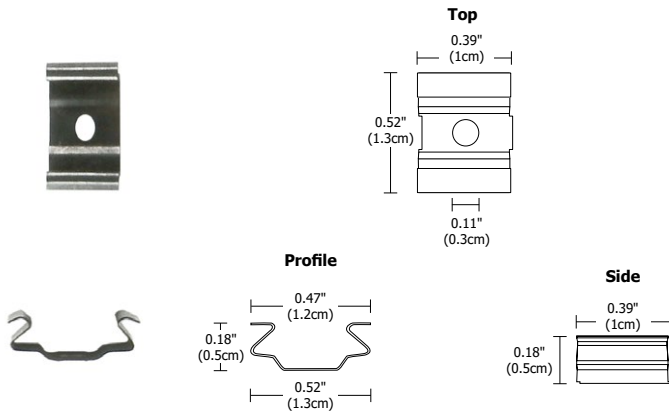

Soft Strip Mounting Clip

Screw In Mounting Clip mounts beneath strip, snapping the Strip into place for additional support (10 per package).

System	Product
SS	MCL
SS Soft Strip	MCL Mounting Clip

PROJECT:

FIXTURE
TYPE:

DATE:

EDGE
LIGHTING