

PURE SMART™ CV96W RGBTW BRIDGEBOX

24VDC, 5 CHANNEL, CONNECTED BY WIZ PRO

ASSEMBLED IN AMERICA

REV 10.29.24

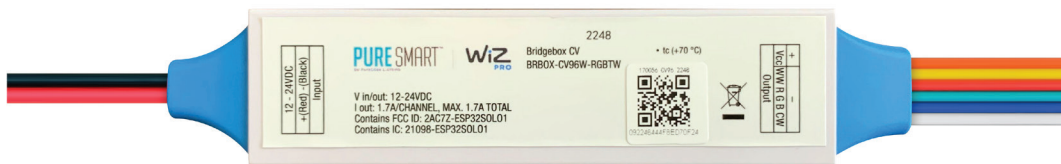

DESCRIPTION

The Pure Smart™ Type CV96W RGBTW Bridgebox enables wireless control of a constant voltage, 5 Channel RGBTW LED load with the WiZ Pro wireless control ecosystem. The CV96W has both Wi-Fi and Bluetooth connectivity. No Hub Required. Voice control can be achieved by integrating with Alexa, Google Assistant, Siri Shortcuts, SmartThings, and IFTTT. Only for use with PSBR-96W-24VDC Power Supply for Remote Bridgebox (sold separately).

APPLICATIONS

Indoor, Dry locations only

POWER INPUT

12V-24VDC, Class 2 wiring
For use with Non-Dim PSB
PSBR-96W-24VDC

POWER OUTPUT

Class 2; 12V-24VDC, 1.7A max per channel

EFFICIENCY

90%

AMBIENT OPERATING TEMPERATURE

-20° C to 50° C

WIZ APP

The WiZ app allows control from any mobile device. The app offers CCT and brightness control as well as scene selection, dynamic light modes, circadian rhythm, scheduling, and grouping. Works with Google Assistant, Amazon Alexa, Siri Shortcuts, IFTTT, and SmartThings. The app and CV Controller are tuned to specific PureEdge RGBTW curves, and ranges.

POWER SUPPLIES* & CONTROLS (SOLD SEPARATELY)

- [Pure Smart™ WiZ Pro PSBR Power Supplies](#)

Pure Smart™ PSBR Power Supply for Remote Bridgebox is developed to support Pure Smart TC TruColor RGBTW luminaires connected by WiZ Pro.

- [Pure Smart™ WiZ Pro 5-Channel Controllers](#)

DIMMING CURVE

PWM 2kHz, 100-5% dimming

SECURITY





3rd party log-in and cloud security provide a safe and protected connection, WiZ does not store nor share any personal information.

INSTALLATION

Intended for installation in Junction Box or PureEdge Power Feed (Sold Separately)

CONNECTIVITY

Wi-Fi IEEE802.11b/g/n, BLE V4.2

	PSBR-60W-24VDC	PSBR-96W-24VDC	PSBR-2X96W-24VDC	PSBR-3X96W-24VDC
				
	SPECIFICATIONS			
MAXIMUM LOAD	60W	96W	2X96W	3X96W
INPUT VOLTAGE	120-277VAC	120-277VAC	120-277VAC	120-277VAC
OUTPUT VOLTAGE	24VDC	24VDC	24VDC	24VDC
DIMENSIONS	12.15" X 6.48" X 2.18"	12.15" X 6.48" X 2.18"	14" X 10" X 3"	17" X 13" X 3"
CLASS 2	•	•	•	•
IN-WALL MOUNTING	•	•	•	•
T-BAR MOUNTING	•	•	•	•
T-BAR CHICAGO PLENUM	•	•	•	•

PROJECT		FIXTURE TYPE		DATE	
---------	--	--------------	--	------	--

PURE SMART™ CV96W RGBTW BRIDGEBOX

24VDC, 5 CHANNEL, CONNECTED BY WIZ PRO

ASSEMBLED IN AMERICA

REV 10.29.24

Product	Wattage	Color Temperature	System
BRBOX	CV96W	TC5W5	RL
BRBOX Bridgebox	CV96W 96 Watts	TC5W5 TruColor™ 5 watts RGB & 5 watts Tunable White TC5W7 TruColor™ 5 watts RGB & 7 watts Tunable White TC5W10 TruColor™ 5 watts RGB & 10 watts Tunable White	CG Ceiling Geometric CL Ceiling Linear FN Flex Neon LC Light Channel RC Recessed Circle RV Recessed Curve RL Recessed Linear RS Recessed Square SB Saber SL Suspension Linear SS Soft/Strip/LED Strip VN Vanity

SYSTEM REFERENCE

SYSTEM	CATEGORY	PRODUCT FAMILIES
CG	Ceiling Geometric	Geo Form
CL	Ceiling Linear	Cirrus Ceiling Glide Ceiling Nova Ceiling Zipp Ceiling
FN	Flex Neon	Flex Neon
LC	Light Channel	Light Channel Micro Grazer Light Channel Recessed Millwork Light Channel Surface Mount
RC	Recessed Circle	TruCirque
RV	Recessed Curve	TruArch TruCurve
RL	Recessed Linear	Reveal Truline Truline Trim Veil Verge

SYSTEM	CATEGORY	PRODUCT FAMILIES
RS	Recessed Square	TruQuad
SB	Saber	Saber
SL	Suspension Linear	Cirrus Suspensions Glide Suspensions Nimbus Glide Suspensions Nova Suspensions Zipp Suspensions
SS	Soft Strip/LED Strip	RGBTW TruColor™ Strip
VN	Vanity	Audrey Mirrors Tie Stix Twiggy

ADDITIONAL COMPONENTS

CV96W fits inside 4 gang junction box.

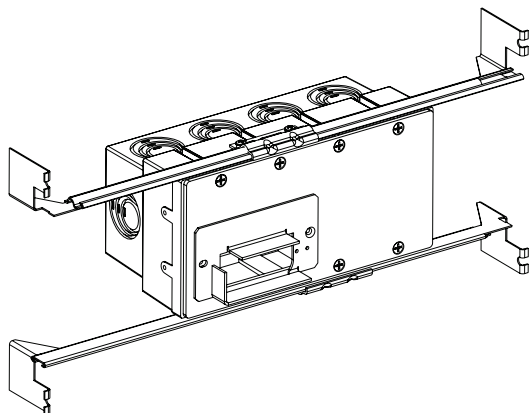

4 GANG JUNCTION BOX WITH MOUNTING PLATE

Includes a 4 gang Junction Box with adjustable bar hangers. Two Class 2, 14 AWG stranded conductors from remote located power supply are required per WIZ Pro CV Bridgebox used.

System	Type
C	1RE4G
C Channel	1RE4G 1" Rectangle End Feed with 4 Gang Junction Box

PROJECT	FIXTURE TYPE	DATE
---------	--------------	------

NETWORK TOPOLOGY & WIRING DIAGRAMS

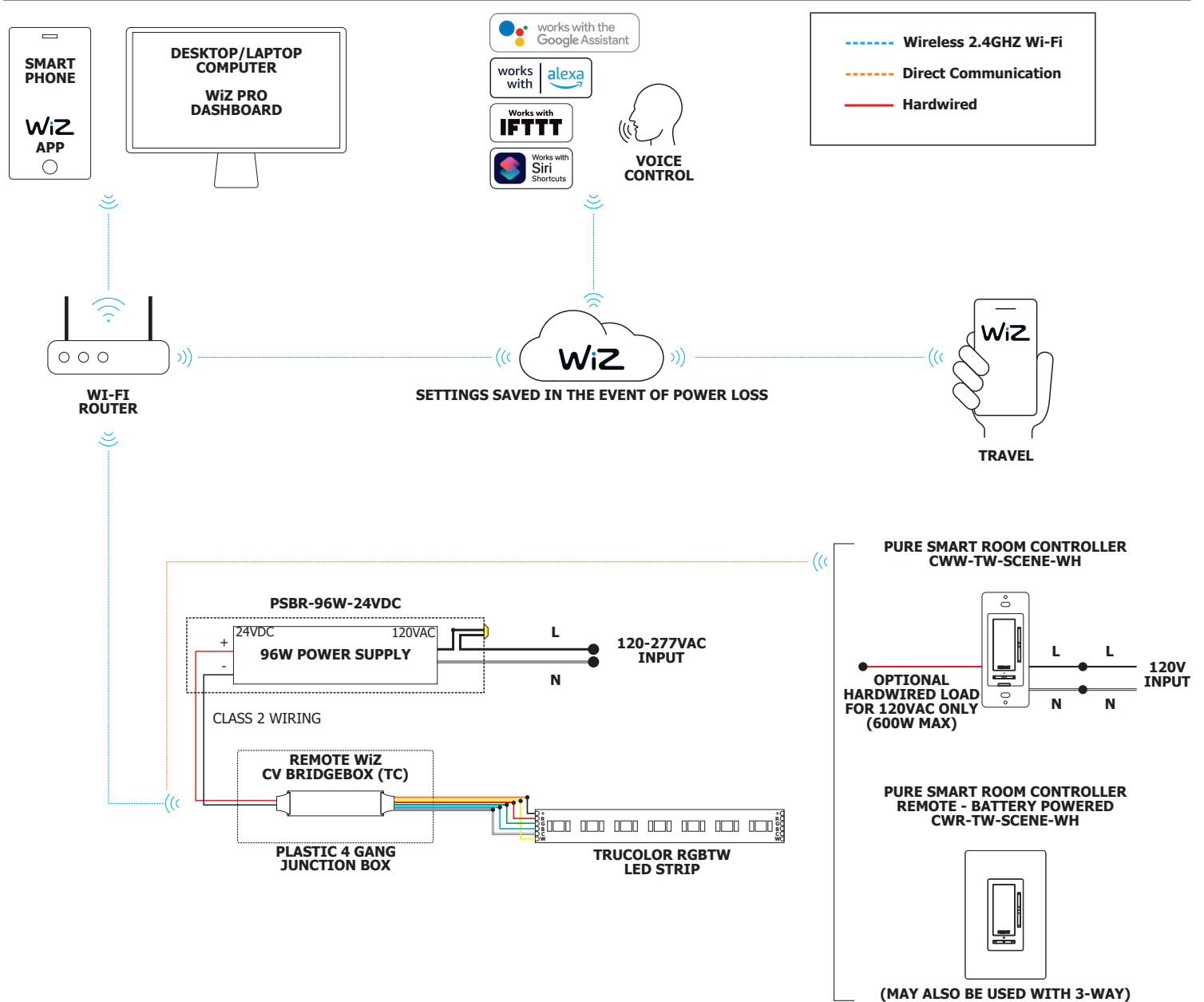

PROJECT		FIXTURE TYPE		DATE	
---------	--	--------------	--	------	--

PURE SMART™ Wi-Fi 120V ROOM CONTROLLER

CONNECTED BY WiZ PRO



DESCRIPTION:

The Pure Smart™ Wi-Fi Room Controller works with any WiZ Connected Smart fixtures/lamps. The Room Controller grants independent adjustment of both color temperature and intensity, as well as scene selection for Single Channel/Static, Tunable White, and TruColor™ RGBTW Fixtures. Four preset scenes can be associated with the room controller via the WiZ App. Custom scenes can be created using multiple layers of light, colors, and can include Pure Smart Wi-Fi Dimmer and Switch as well. No Hub required. Room Controller communicates with fixtures directly on the Local Area Network allowing for control even if the Wi-Fi goes down. Compatible with WiZ Connected fixtures only. For custom quotes and layout assistance, send your drawings and ideas to our design team: design@PureEdgeLighting.com.

OPERATION

Features ON/OFF buttons, CCT and brightness control rockers, and 4 preset/custom scene selections. Maximum output of 600W for hardwired WiZ Connected devices. No load restriction when load wire is not used and devices are connected wirelessly to Room Controller. Communicates with 2.4GHz Wi-Fi only. No Hub Required.

SECURITY

3rd party log-in and cloud security provide a safe and protected connection. WiZ does not store nor share any personal information.

EASY INSTALLATION

The Pure Smart™ Wi-Fi Room Controller installs just like a traditional dimmer. 120V power is all that is needed. Switch leg is optional for CWW-TW-SCENE-WH. This is also offered in a completely wireless version (See Pure Smart Remote Room Controller CWR-TW-SCENE-WH). Compatible with standard gangable boxes. Requires neutral wire. No Hub Required. Single Pole or 3-way compatible. 3-way can be achieved by assigning two room controllers (CWW-TW-SCENE or [CWR-TW-SCENE-WH](#)) to the same target/room/fixture. 3-way can also be achieved with a room controller in combination with the Pure Smart Dimmer ([SWW-DIM-WH](#)), or the Pure Smart Switch ([SWW-SWT-WH](#)) by assigning the dimmer or switch as a target to the room controller.

WiZ APP

The Room Controller is added as an accessory in the WiZ app (Available on iOS or Android) and communicates directly to the WiZ enabled light fixture via direct wi-fi signal on Local Area Network (LAN). Voice control enabled when used in conjunction with Google Assistant, Siri, Alexa, IFTTT, and SmartThings. Grouping, zoning, scheduling, and custom scenes can all be programmed with the WiZ app or WiZ Pro Dashboard.

BODY

Durable polycarbonate body, compatible with decorator style wall plate (not included).

SPECIFICATIONS

Approved Location	Dry / Indoor
Input Voltage	120Vac - 60 Hz
Certification	cULus, FCC
Compatible Load(s)	WiZ Connected products only
Maximum Power	600W (Hardwired Loads), No Maximum for Wireless Loads
Output Current	5A
Power Consumption	Relay OFF: 0.07W Soft OFF: 0.79W ON: 0.79W
Dimming	Dims to 3%
Operating Temperature	23°F~113°F (-5°C~45°C)
Wireless Frequency	2.4GHz
Wireless Standard	IEEE 802.11
Warranty	3 Year

Product	Type	Finish
CWW	TW-SCENE	WH
CWW 120V Controller, Wall Mount, WiZ Pro connected	TW-SCENE Tunable White + Scenes	WH White

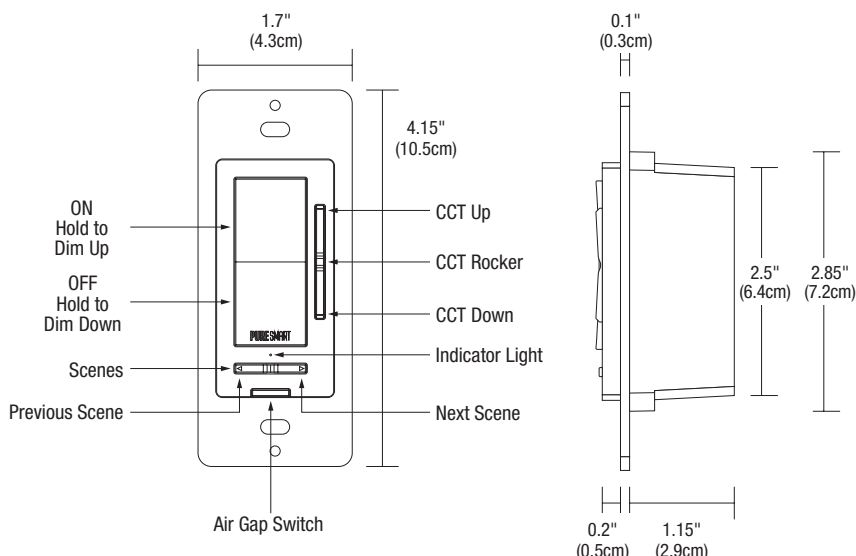

PROJECT	FIXTURE TYPE	DATE
---------	--------------	------

PURE SMART™ Wi-Fi REMOTE ROOM CONTROLLER

CONNECTED BY WiZ PRO FOR TABLE TOP OR WALL



DESCRIPTION:

The Pure Smart™ Wi-Fi Remote Room Controller works with any WiZ Connected Smart fixtures/lamps. The Remote Room Controller is powered by four AAA batteries (not included) and grants independent adjustment of color temperature and intensity, as well as scene selection for four favorite scenes which are selected and assigned to the room controller in the WiZ App. The four favorited scenes, as with any scene in the WiZ ecosystem, can consist of any combination of products including bulbs, luminaires, or smart controls and can support any combination of color ranges including static white or dimmable white, Tunable White, and Tricolor RGBTW allowing for intricate customization and control. No Hub required. Room Controller communicates with fixtures directly on the Local Area Network allowing for control even if the Wi-Fi goes down. Compatible with WiZ Connected fixtures only. For custom quotes and layout assistance, send your drawings and ideas to our design team: design@PureEdgeLighting.com.

OPERATION

Dimming, CCT control rocker, and a scene control toggle. No load maximum. Communicates with 2.4GHz Wi-Fi only. No Hub Required.

EASY INSTALLATION

The Pure Smart™ Wi-Fi Remote Room Controller is powered by 4 AAA batteries (not included) and is therefore completely wireless. Multiple mounting methods available including to a standard switch box, on the wall with the included drywall anchors or adhesive strip, or kept on a tabletop with the rubber pads that help to keep it stationary. Single Pole or 3-way compatible with Pure Smart Dimmer ([SWW-DIM-WH](#)), Pure Smart Switch ([SWW-SWT-WH](#)), 120V Room Controller ([CWW-TW-SCENE-WH](#)) and another Remote Room Controller. No wires. No hub. Total control.

WiZ APP

The Room Controller is added as an accessory in the WiZ app (Available on iOS or Android) and communicates directly to the WiZ enabled light fixture via direct wi-fi signal on Local Area Network (LAN). Voice control enabled when used in conjunction with Google Assistant, Siri, Alexa, IFTTT, and SmartThings. Grouping, zoning, scheduling, and custom scenes can all be programmed with the WiZ app or WiZ Pro Dashboard.

BODY

Durable polycarbonate body.

SECURITY

3rd party log-in and cloud security provide a safe and protected connection. WiZ does not store nor share any personal information.

SPECIFICATIONS

Approved Location	Dry / Indoor
Input Voltage	4 AAA batteries (not included)
Certification	cULus, FCC
Compatible Load(s)	WiZ Connected products only
Maximum Power	No Load Maximum
Output Current	5A
Power Consumption	Relay OFF: 0.07W Soft OFF: 0.79W ON: 0.79W
Dimming	Dims to 3%
Operating Temperature	23°F~113°F (-5°C~45°C)
Wireless Frequency	2.4GHz
Wireless Standard	IEEE 802.11
Warranty	3 Year

Product	Type	Finish
CWR	TW-SCENE	WH
CWR Controller, WiZ Pro connected Remote	TW-SCENE Tunable White + Scenes	WH White

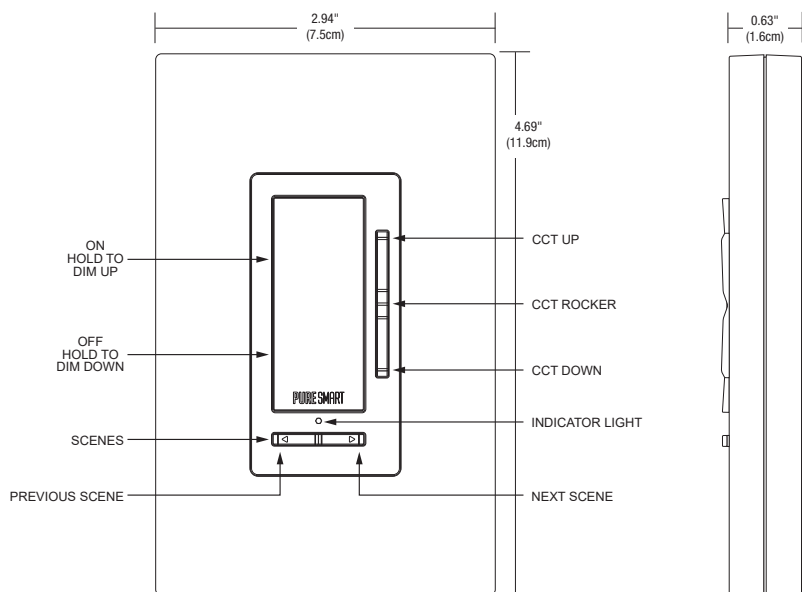

PROJECT		FIXTURE TYPE		DATE	
---------	--	--------------	--	------	--