

# SABER SUSPENSION, 0.8" ROUND

24VDC, 5W | 6W OUTDOOR/WET LOCATION, RGB & RGBW

ASSEMBLED IN AMERICA | US PATENT PENDING

REV 01.16.25

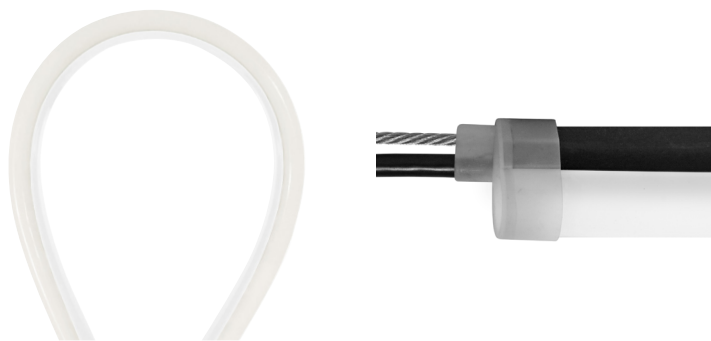

## DESCRIPTION

Visually stimulating and housed within an unconventional silicone lens, PureEdge's Flexible Saber Line is Tension hung offering flexible installation and conceptual yet functional design. The SCS8 bends Up and Down giving it the unique ability to traverse open spaces wall to wall, wall to ceiling, or floor to ceiling. The 0.75" wide round lens, offers superior color quality and performance while creating uniform illumination without pixelation. Offered in RGB (Red, Green and Blue), RGB+W (Red, Green and Blue, Plus White). Saber is an IP67 rated wet location system featuring watertight barrel connections. System includes a pair of turnbuckles and aircraft cable. 5 year pro-rated warranty. Patent Pending. For custom designs and quotes, email our design team: [design@PureEdgeLighting.com](mailto:design@PureEdgeLighting.com).

## SPECIFICATIONS

DIMENSIONS	Height: 1.12" Width: 0.66" (TOP) 0.75" (BOTTOM)
BEAM ANGLE	160°
INPUT	24VDC with 5" leads
POWER SUPPLIES	Remote 24VDC power supply required
POWER CONSUMPTION	RGB 5W per foot, RGBW 6W per foot
INCREMENTS	1'
MAX LENGTH	5W RGB - 20' or 40' with power feeds at both ends 6W RGBW - 12' or 24' with power feeds at both ends
MATERIAL	UV Resistant PVC
OPERATING TEMPERATURE	-40° F (-40° C) to 122° F (+50° C)
AVERAGE LED LIFE	50,000 hrs
WARRANTY	5 Year pro-rated
COMPLIANCE	Outdoor Wet Location with Water Tight Barrel Connectors IP67 Rated, ETL listed



## CONTROLLER FOR RGB & RGB+W (SOLD SEPARATELY)

- CDMX1-RGBW - Single zone DMX touch controller
- CTP - Multiple zone DMX touch controller

## REMOTE POWER SUPPLIES\*, DIMMERS & CONTROLS (SOLD SEPARATELY)

- [Home Integration Solutions](#)
- [DMX Dynamic Color Changing & Controllers](#)

For quick & easy reference, plus the most up-to-date pricing, use our [Saber Suspension Configurator](#)

## Wet Location End Cap with Aircraft Cable

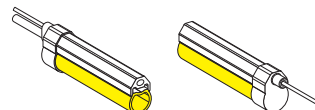

System	Viewing Angle Model Shape	Wattage	Length in Feet	Color Temperature	5" Input Wire Feed	Output Wire	Environment
<b>FN</b>	<b>SCS8</b>	<b>5W</b>	<b>20</b>	<b>RGB</b>	<b>E</b>	<b>CA</b>	<b>W</b>
<b>FN</b> Flex Neon 24V	<b>SCS8</b> Suspension Saber .8" bends up/down. Includes suspension aircraft cable and turnbuckle. Order power supply and canopy separately.	<b>5W</b> 5 watts per foot (RGB) <b>6W</b> 6 watts per foot (RGB+W)	5W - Up to 20' with power feed at one end (RGB) 6W - Up to 13' with power feed at one end (RGB+W)	<b>RGB</b> Red, Green, and Blue <b>RGB20K</b> Red, Green, Blue + White 2000K (6 Watt Only) <b>RGB27K</b> Red, Green, Blue + White 2700K <b>Special Order</b> <b>RGB30K</b> Red, Green, Blue + White 3000K <b>Special Order</b> <b>RGB40K</b> Red, Green, Blue + White 4000K <b>Special Order</b>	<b>E</b> End Power Input Wire	<b>CA</b> Cap at end, no feed through	<b>W</b> Outdoor wet location Barrel Connector cable leads
*Lengths surpassing 26' may have a slight sag up to 1"							
System	Viewing Angle Model Shape	Wattage	Length in Feet	Color Temperature	5" Input Wire Feed	Output Wire	Environment
<b>FN</b>	<b>SCS8</b>	<b>5W</b>	<b>26</b>	<b>RGB</b>	<b>E</b>	<b>E</b>	<b>W</b>
<b>FN</b> Flex Neon 24V	<b>SCS8</b> Suspension Saber .8" bends up/down. Includes suspension aircraft cable and turnbuckle. Order power supply and canopy separately.	<b>5W</b> 5 watts per foot (RGB) <b>6W</b> 6 watts per foot (RGB+W)	5W - 21-40' with power feed at both ends (RGB) 6W - 13-26' with power feed at one end (RGB+W)	<b>RGB</b> Red, Green, and Blue <b>RGB20K</b> Red, Green, Blue + White 2000K (6 Watt Only) <b>RGB27K</b> Red, Green, Blue + White 2700K <b>Special Order</b> <b>RGB30K</b> Red, Green, Blue + White 3000K <b>Special Order</b> <b>RGB40K</b> Red, Green, Blue + White 4000K <b>Special Order</b>	<b>E</b> End Power Input Wire	<b>E</b> End Wire Lead Out	<b>W</b> Outdoor wet location Barrel Connector cable leads
*Lengths surpassing 26' may have a slight sag up to 1"							
PROJECT				FIXTURE TYPE			DATE

# SABER SUSPENSION, 0.8" ROUND

24VDC, 5W | 6W OUTDOOR/WET LOCATION, RGB & RGBW

## Drawings: Saber Line SCS8

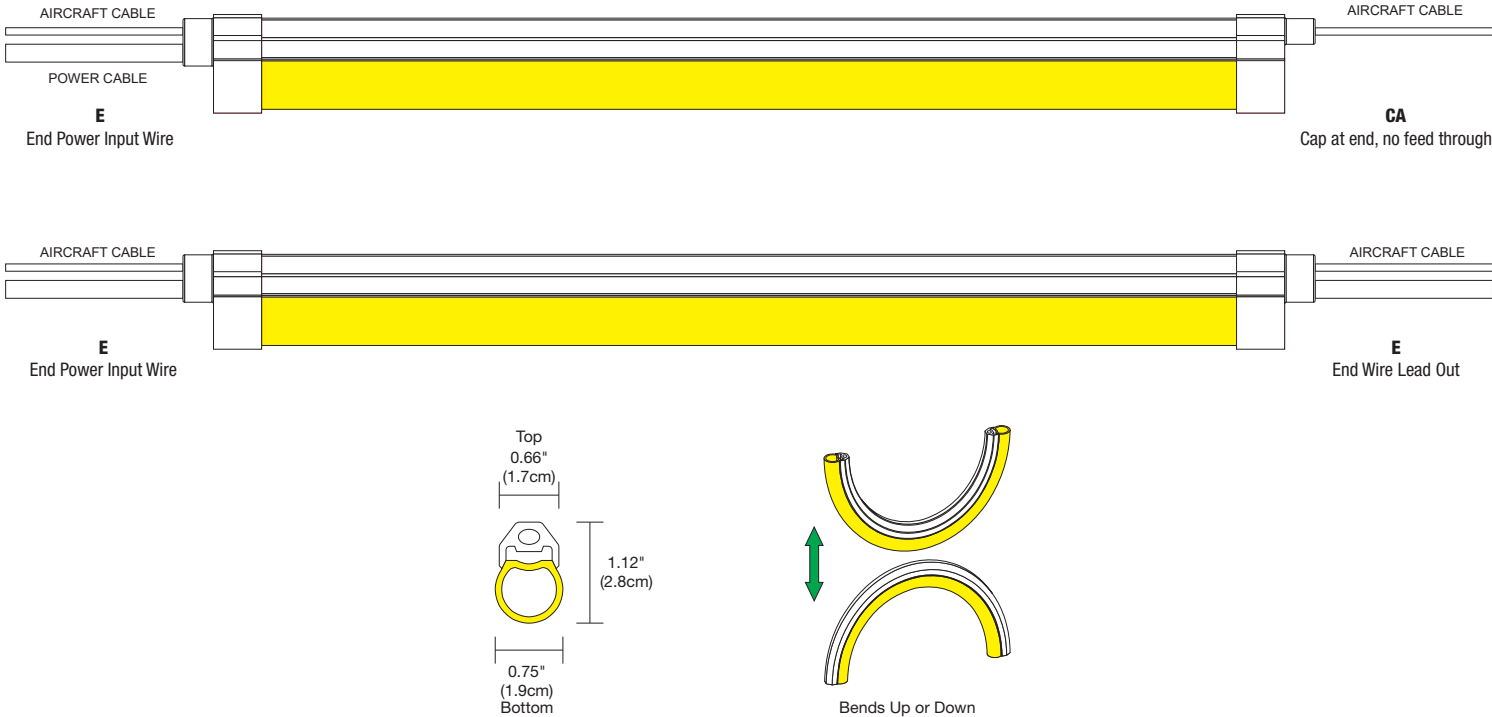

## LENGTH CHART Actual lengths for Saber Line SCS8

LENGTH CHART							
Ordering Code (Nominal Size)	Actual Length (Inches)	Ordering Code (Nominal Size)	Actual Length (Inches)	Ordering Code (Nominal Size)	Actual Length (Inches)	Ordering Code (Nominal Size)	Actual Length (Inches)
1	12.75	11	132.75	21	252.75	31	372.75
2	24.75	12	144.75	22	264.75	32	384.75
3	36.75	13	156.75	23	276.75	33	396.75
4	48.75	14	168.75	24	288.75	34	408.75
5	60.75	15	180.75	25	300.75	35	420.75
6	72.75	16	192.75	26	312.75	36	432.75
7	84.75	17	204.75	27	324.75	37	444.75
8	96.75	18	216.75	28	336.75	38	456.75
9	108.75	19	228.75	29	348.75	39	468.75
10	120.75	20	240.75	30	360.75	40	480.75

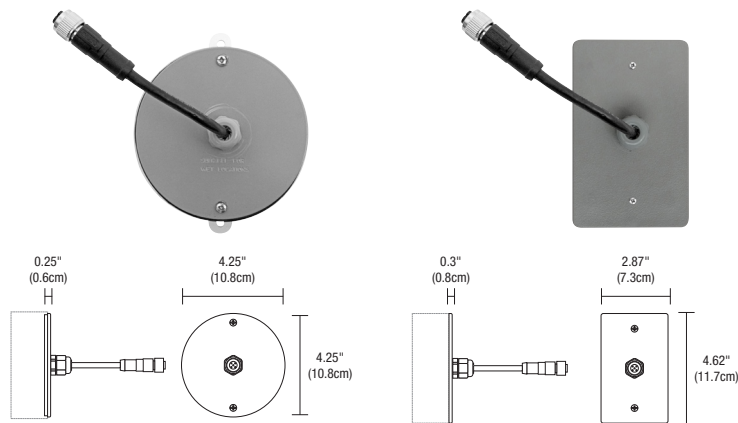

## CANOPY (ORDER SEPARATELY)

Outdoor canopy with 8ft outdoor barrel connector power feed, may be cut on job site.

System	Type	Canopy	Finish
<b>OC8P</b>	<b>CFX-6C</b>	<b>RD</b>	<b>ZN</b>
<b>OC8P</b> Outdoor Canopy with 8' outdoor Power cable	<b>CFX-6C</b> Flexible 6 Conductor barrel cable connector	<b>RD</b> Round Cover, 1 gauge 4.125" <b>RE</b> Rectangle Cover, 1 gauge 2.8" x 4.5"	<b>ZN</b> Zinc

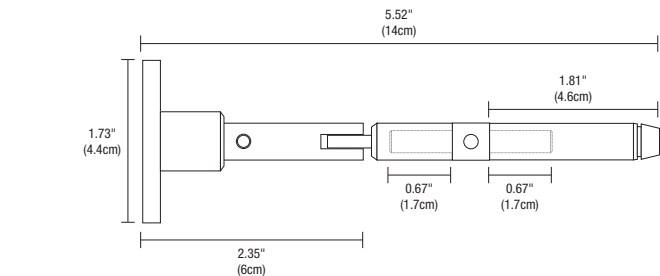

## PAIR OF TURNBUCKLES AND AIRCRAFT CABLE (INCLUDED)

The Slim-Profile Turnbuckles hold the tension of the air craft cable running through the silicone Saber tube with LED strip. 6' stainless steel aircraft cable included.

Product	Finish
<b>SABT</b>	<b>SA</b>
<b>SABT</b> Saber Line Turnbuckle	<b>SA</b> Satin Aluminum



## AIRCRAFT CABLE (INCLUDED WITH AN EXTRA 6')

Product	Type	Length
<b>ACBL</b>	<b>SAB</b>	<b>50FT</b>
<b>ACBL</b> Aircraft Cable for Saber	<b>SAB</b> Saber	10' to 100' lengths

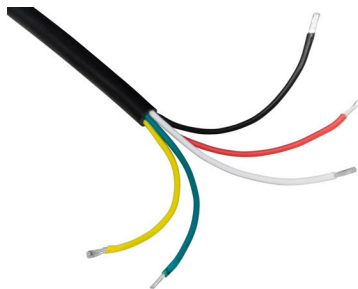

## WET AND DAMP LOCATION CABLE ORDER PER FOOT

Our Wet Location, 5 Conductor, 14 Gauge Cable is a durable and adaptable cable suitable for transmitting power, control, and switching in indoor and outdoor wet and damp environments. Cable sold by the foot, simply specify the length needed by the foot. Keep within 50 ft between fixture and power supply. Cable sold by the foot, simply specify the length needed by the foot.

Product	Gauge	Cable
<b>OC</b>	<b>14G</b>	<b>5C</b>
<b>OC</b> Outdoor Cable	<b>14G</b> 14 Gauge	<b>5C</b> 5 Conductor

PROJECT		FIXTURE TYPE		DATE	
---------	--	--------------	--	------	--



# FLEX NEON ACCESSORIES AND J-BOXES

24VDC, 5W | 6W OUTDOOR/WET LOCATION, RGB & RGBW

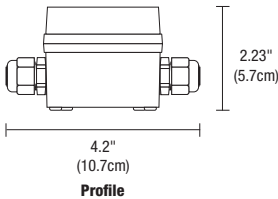
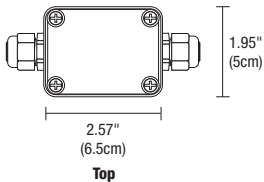

## WET LOCATION JUNCTION BOX

Wet-rated low voltage Splice Box with connectors.

Product	Type	Option
<b>2RE</b>	<b>JBOX</b>	<b>W</b>
2RE 2" Rectangle	JBOX Junction Box	W Wet Location



## RGB OR RGBW WET LOCATION JUNCTION BOX WITH 6" POWER CABLE

This watertight, multi-fixture Junction Box is especially designed for lighting in wet and damp locations. It is versatile, rugged and simple to install. The Junction Box comes standard with a 6" Flexible Cable providing easy, safe, and reliable connections for 24V low voltage luminaires. This box is approved for indoor and outdoor usage and complies with all the requirements of UL1241 and the National Electric Code. Compatible with RGB.

Product	Canopy	Product	Size	Type	Option
<b>SS</b>	<b>2RE</b>	<b>JBOX</b>	<b>6IN</b>	<b>RGBW</b>	<b>W</b>
SS LED Soft Strip Flex Neon	2RE 2" Rectangle	JBOX Junction Box	6IN 6" Four Wire Connection	RGBW RGBW	W Wet Location (COMPATIBLE WITH RGB)



## RGB OR RGBW POWER CABLE CONNECTOR WET LOCATION

The flexible power cable connector is designed to work in outdoor environments for safe and reliable connections. This Flexible Connector is easy to install and configure, helping you create innovative lighting designs in an outdoor commercial or residential space.

Product	Type	Size	Conductor	Option
<b>SS</b>	<b>CFX</b>	<b>16IN</b>	<b>6C</b>	<b>W</b>
SS Soft Strip and Flex Neon	CFX Flexible 4 Wire Connector	16IN 16" 96IN 96"	6C 6 Conductor	W Wet Location

PROJECT		FIXTURE TYPE		DATE	
---------	--	--------------	--	------	--

# DMX OUTDOOR/WET LOCATION POWER SUPPLIES & CONTROLS

24VDC, 5-CHANNEL, FOR PUREEDGE CONSTANT VOLTAGE SYSTEM

REV 05.14.24

## RECOMMENDED CONTROLLERS

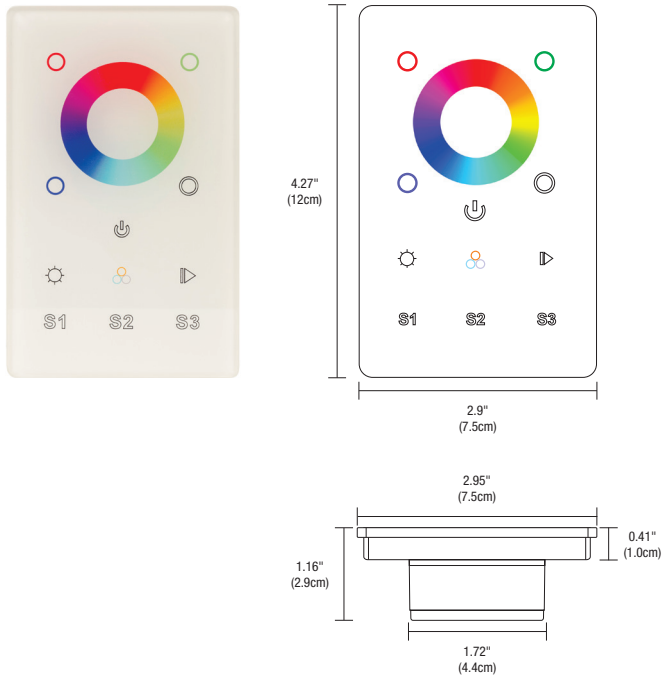

### DESCRIPTION

Full touch controller offers fast and accurate color tone adjustment and independent brightness control. The 1 zone controller can adjust RGB and RGBW LEDs smoothly and accurately. Independent smooth dimming of each channel enables the controller to achieve millions of colors. For indoor applications only, and includes a Power Adapter to operate the controller.

### APPLICATIONS

Indoor

### INSTALLATION

Fits in a single gang 2.5 inch deep junction box, not to be used with a multi gang box

### POWER INPUT

120-277VAC

### OUTPUT SIGNAL

USITT DMX 512 (1990)

Product	Type	Finish
<b>CDMX1</b>	<b>RGBW</b>	<b>WH</b>
<b>CDMX1</b> DMX 1 Zone Touch Controller	<b>RGB</b> Red, Green and Blue <b>RGBW</b> Red, Green, Blue and White	<b>WH</b> White

## REQUIRED COMPONENTS SOLD SEPARATELY

### WIRING DIAGRAM

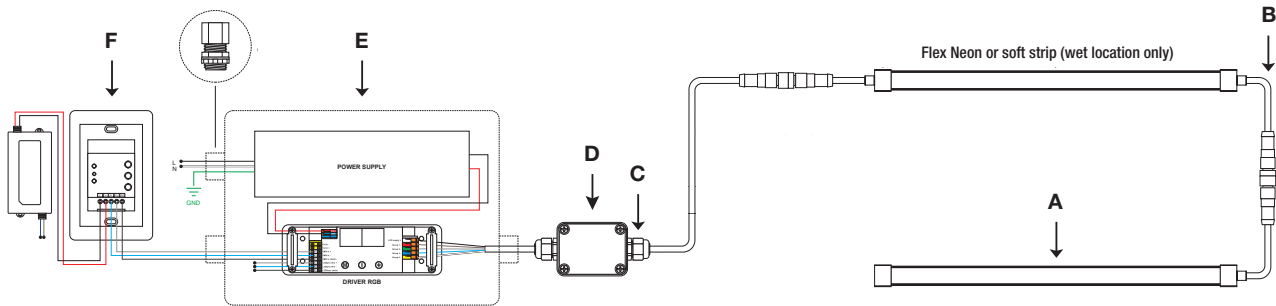

### A. OUTDOOR 24VDC FIXTURE OR FLEX NEON

Wet location LED Flex Neon or soft strip. Please refer to fixture ordering code for incremental lengths, Flex Neon and soft strip are not field cuttable or submersible.

### B. RGB & RGBW POWER CABLE CONNECTOR

The flexible power cable connector is designed to work in outdoor environments for safe and reliable connections.

### C. POWER CONNECTOR

Sold Separately for Flex Neon and wet location soft strip.

\*Included with Wet Location LED Soft Strips - comes connected to each end of the LED Soft Strip sealed in water-resistant silicone.

### D. OUTDOOR CONNECTION BOX

Wet-rated low voltage Splice Box with connectors.

### E. OUTDOOR RATED POWER SUPPLY WITH DMX DRIVER

Outdoor-rated Power Supplies are required for use with Outdoor LED Soft Strip and fixtures.

### F. DMX CONTROLLER

Indoor Only. Sold Separately. See page 2.

PROJECT		FIXTURE TYPE		DATE	
---------	--	--------------	--	------	--

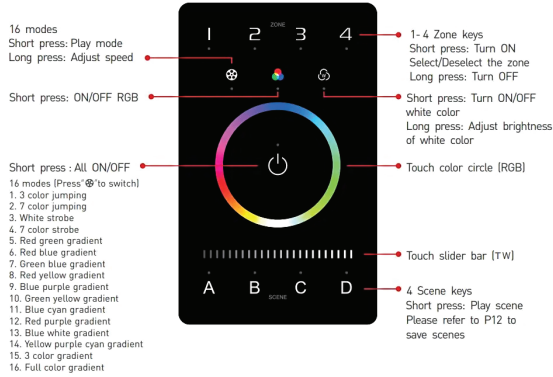

(TW)

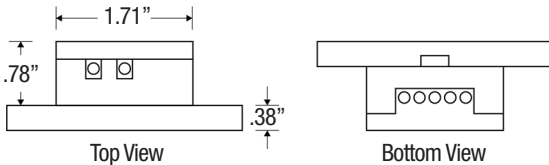
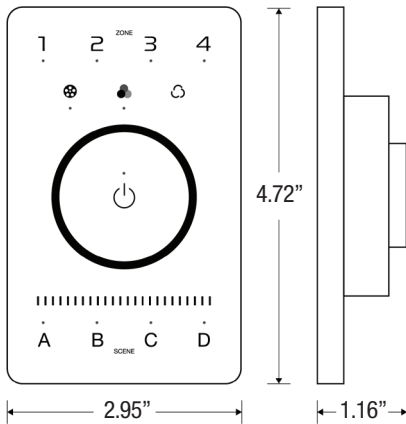

### DESCRIPTION

The RGBTW Smart Touch Panel integrates Bluetooth5.0 SIG Mesh protocol with DMX. Simple yet elegant, the frame is comprised with CNC aviation grade aluminum and a tempered glass face. Programmable for multi-scene and multi-zone for both residential and commercial lighting control applications. Bluetooth and mobile app enabled for smooth dimming of each channel enables the controller to achieve millions of colors. For indoor applications only. For custom quotes and layout assistance, send your drawings and ideas to our design team: [design@PureEdgeLighting.com](mailto:design@PureEdgeLighting.com).

### KEY FEATURES

- Smart and Stable Wireless Control
- Mobile App and Bluetooth integration included
- Minimal tempered glass design
- 16 Million Color Choices
- 4 Zone Controls
- 16 Modes
- 4 Preset Scenes
- Graphic color display
- Playback options such as scene queuing and looping
- Multiple Speed Options
- Color Wheel Pallet
- Independent Dimming and Color Temperature Tuning
- Touch sensitive wheel allows for accurate color selection

Use with [PureEdge DMX Power Supplies](#)

### APPLICATIONS

Indoor

### POWER INPUT

12-24VDC, Class 2 120-277vac POWER SUPPLY INCLUDED

Product	Color Temperature	Finish
<b>CDMX4</b>	<b>RGBTW</b>	<b>BK</b>
CDMX4 Bluetooth 5.0 SIG Mesh Controller	RGBTW Red, Green, Blue, Tunable White	BK Black

PROJECT	FIXTURE TYPE	DATE
---------	--------------	------