

CIRRUS CEILING WALL WASH WITH GLARE SHIELD

REMOTE POWER, RGB & RGB+W

DESIGNED BY GREGORY KAY | ASSEMBLED IN AMERICA | PATENT PENDING

REV 03.28.25



DESCRIPTION

The New Generation of our Cirrus Wall Wash with shield is precision-engineered to block glare and illuminate vertical surfaces from the top of the ceiling at a 3:1 ratio. Available in 5 or 6 watts per foot, in RGB and RGB+White. Mounted 24" from the wall, and offered with a Split Canopy that mounts on Standard Junction Box or with a Slim Profile Channel Junction Box (C-1RE-JBOX) with no visible canopy on the ceiling, becoming one with the architecture of a space. The Cirrus Wall Wash with Glare Shield include mounting Clips every 18". Powered by Class 2, 24VDC remote power supplies that can be located up to 40' away. Ordered in increments from 12"-240". For Chrome channels, lengths greater than 84" ship as two or more segments that join together. Lengths greater than 240" or making 90 degree turns contact us for a custom quotation. *Remote Power Supplies are Required and Sold Separately. Fixtures include a 5 year pro-rated warranty. For custom designs and quotes, email our design team: design@PureEdgeLighting.com.

INSTALLATION

- Mounts to a Standard Junction Box, pre-wired from 120V/24VC Remote Power Supply up to 100 Watts (sold separately) at maximum 40' away
- Includes your choice of Canopy: 1" Rectangular Junction Box or 4.6" Square Canopy
- 6' Whip
- Includes drywall ceiling Mounting Clips, TBar clips order separately
- Remote power supplies sold separately

FINISHES

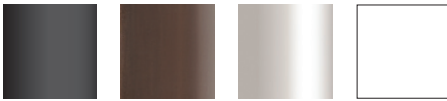

Satin Black **BK** Antique Bronze **BZ** Satin Nickel **SN** White **WH**

LENS

- Diffused White Wall Wash Lens with Glare Shield, optional Black or White Louvers

LAMPING

- RGB: Red, Green and Blue
- RGB+W: Dynamic Red, Green, Blue plus White (**2000K**)
- Power Consumption: 5 or 6 watts per foot
- 50,000 Hour Lamp Life

REMOTE POWER SUPPLIES*, DIMMERS & CONTROLS (SOLD SEPARATELY)

24VDC, Class 2 wiring

- [Home Integration Solutions](#)
- [Pure Smart™ WIZ Pro Power Supplies & Controls](#)
- [DMX Dynamic Color Changing](#)
- [Controllers](#)

*In-Wall Mounting Kits available for select power supplies

APPLICATIONS

Designed for indoor use only. Ideal applications include residential, commercial, retail, and hospitality environments

APPROVALS

Damp Location, Class 2 wiring, ETL Listed, Made in America

System	Wattage Per Foot	Canopy	Nominal Size	Color Temperature	Finish
CCWSH	6W	1R	240	RGB	SN
CCWSH Cirrus Ceiling with Glare Shield Wall Wash CCWSHW Cirrus Ceiling with Glare Shield Wall Wash with White Louver CCWSHB Cirrus Ceiling with Glare Shield Wall Wash with Black Louver	5W 5 Watts (240" max, 20') 6W 6.3 Watts (180" max, 15')	1R 1" Rectangle Canopy 4S 4.6" Square Split Canopy TBA Mounting clips are compatible with 15/16" and 9/16" T-Bar systems where the ceiling panels are flush with the grid, and 15/16" tegular ceiling panels. TBB Mounting clips are compatible with 15/16" and 9/16" T-Bar systems where the ceiling panels sit below T-Bar grid (includes spacer). TBC Mounting clips are compatible with Armstrong PB Vector 15/16" T-Bar systems with 1/4" reveal ceiling panels. TBE Mounting clips are compatible with Slotted T-Bar Drop Ceiling systems with 1/4" openings, and mounts flush anywhere along the T-Bar grid. TBI Mounting clips are compatible with Armstrong Interlude™ T-Bar systems where the ceiling panels are flush with the bottom of the grid.	12-240 Order in various increments from 12"-240" *Maximum shipping length 120" *See length chart for exact dimensions	RGB Red, Green and Blue (5W only) RGBW Red, Green, Blue and 2000K White (6W Only)	BK Satin Black BZ Antique Bronze SN Satin Nickel WH White

PROJECT		FIXTURE TYPE		DATE	
---------	--	--------------	--	------	--

CIRRUS CEILING WALL WASH WITH GLARE SHIELD

REMOTE POWER, RGB & RGB+W



CIRRUS CEILING WALL WASH WITH GLARE SHIELD

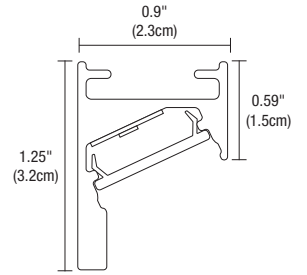

CIRRUS CEILING WALL WASH WITH GLARE SHIELD

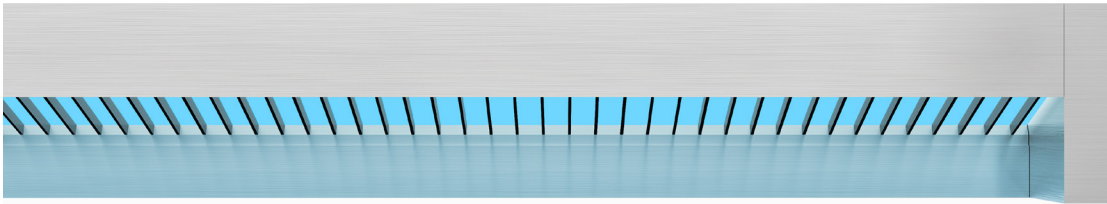

CIRRUS CEILING WALL WASH WITH GLARE SHIELD AND BLACK LOUVER

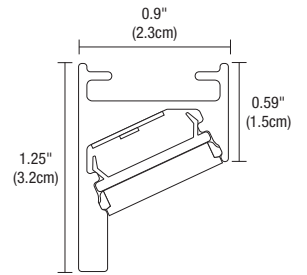

CIRRUS CEILING WALL WASH WITH GLARE SHIELD AND LOUVER



CIRRUS CEILING WALL WASH WITH GLARE SHIELD



CIRRUS CEILING WALL WASH WITH GLARE SHIELD AND WHITE LOUVER

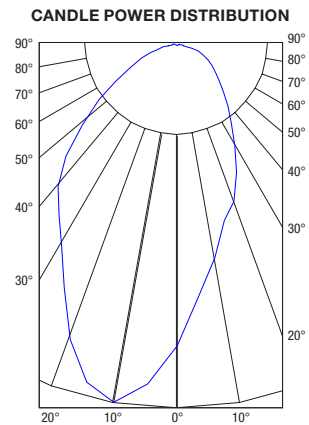
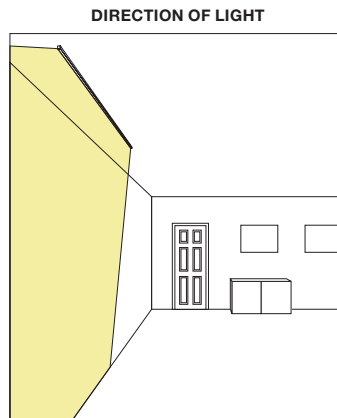
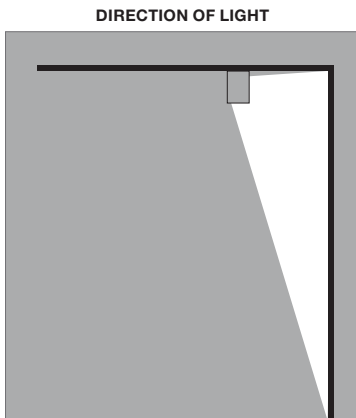

PROJECT		FIXTURE TYPE		DATE	
---------	--	--------------	--	------	--

CIRRUS CEILING WALL WASH WITH GLARE SHIELD

REMOTE POWER, RGB & RGB+W

Length Chart: Actual lengths for Cirrus Ceiling Wall Wash

STATIC WHITE			
Ordering Code (Nominal Size)	Actual Length (Inches)	Ordering Code (Nominal Size)	Actual Length (Inches)
12	13	128	128.2
15	15.4	130	130.6
17	17.8	132	133.0
20	20.2	135	135.4
22	22.6	137	137.8
24	25	140	140.2
27	27.4	142	142.6
29	29.8	144	145.0
32	32.2	147	147.4
34	34.6	149	149.8
36	37	152	152.2
39	39.4	154	154.6
41	41.8	156	157.0
44	44.2	159	159.4
46	46.6	161	161.8
48	49	164	164.2
51	51.4	166	166.6
53	53.8	168	169.0
56	56.2	171	171.4
58	58.6	173	173.8
60	61	176	176.2
63	63.4	178	178.6
65	65.8	180	181.0
68	68.2	183	183.4
70	70.6	185	185.8
72	73	188	188.2
75	75.4	190	190.6
77	77.8	192	193.0
80	80.2	195	195.4
82	82.6	197	197.8
84*	85	200	200.2
87	87.4	202	202.6
89	89.8	204	205.0
92	92.2	207	207.4
94	94.6	209	209.8
96	97	212	212.2
99	99.4	214	214.6
101	101.8	216	217.0
104	104.2	219	219.4
106	106.6	221	221.8
108	109	224	224.2
111	111.4	226	226.6
113	113.8	228	229.0
116	116.2	231	231.4
118	118.6	233	233.8
120**	121	236	236.2
123	123.4	238	238.6
125	125.8	240	241.0

*Maximum Chrome Length **Maximum Shipping Length

DRAWINGS Canopy & Channel Drawings for Cirrus Ceiling Wall Wash

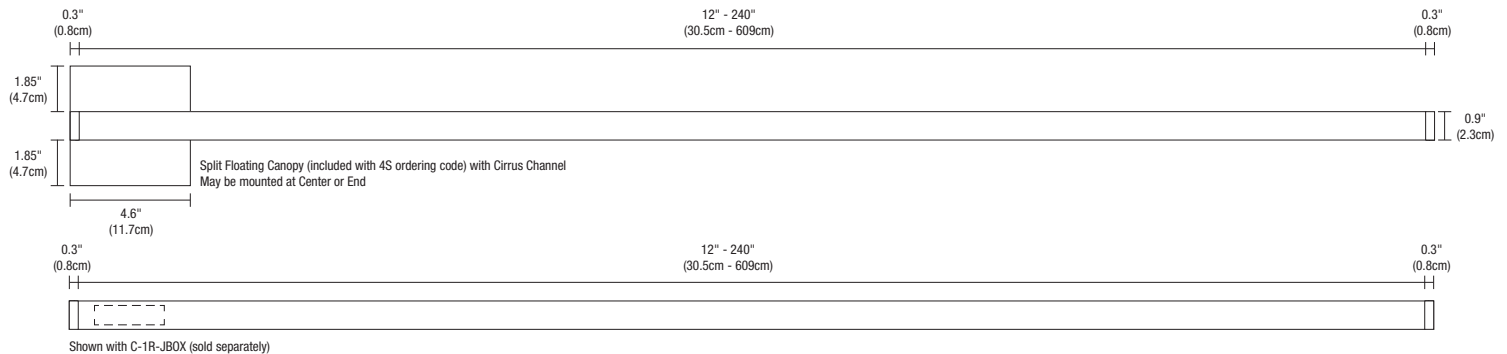

PROJECT	FIXTURE TYPE	DATE
---------	--------------	------

CIRRUS CEILING WALL WASH WITH GLARE SHIELD

REMOTE POWER, RGB & RGB+W

ADDITIONAL COMPONENTS

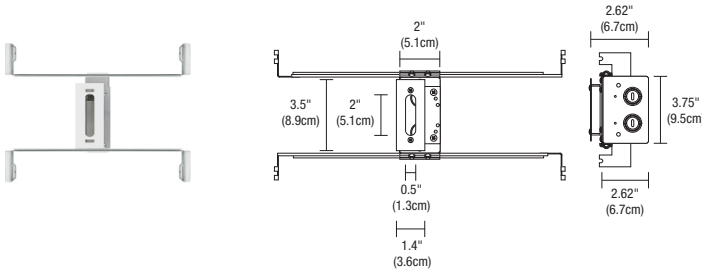

1" RECTANGLE CANOPY & J-BOX

(INCLUDED WITH 1R SELECTED IN FIXTURE ORDERING CODE)

The Slim-Profile Junction Box with Hanger Bars mounts to studs spaced between 14.5" and 25" apart behind drywall. Allows low voltage DC wires from Remote Power Supply to connect to channel wires. The Junction Box opening is covered by the fixture for a clean, safe connection. Includes a Goof Plate, for poor plastering around J-box.

System	Canopy	Product
C	1RE	JBOX
C Channel	1RE 1" Rectangle	JBOX Junction Box

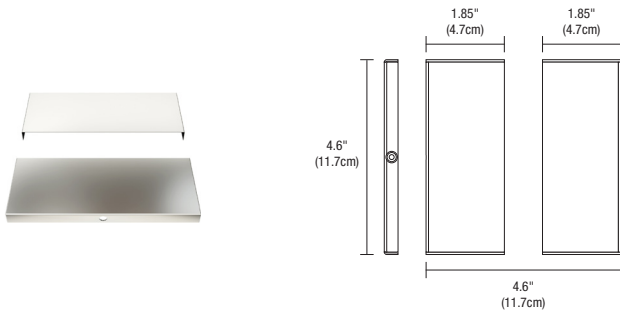

4" SQUARE SPLIT CANOPY

(INCLUDED WITH 4S SELECTED IN FIXTURE ORDERING CODE)

The 4" Square Canopy fits on a standard 4" electrical box with round plaster ring. It fits flush along channel while covering Junction Box. The Canopy may float anywhere along the channel and comes in six finishes.

System	Canopy	Finish
CC	4SQ	SN
CC Cirrus Ceiling	4SQ 4.6" Split Square	BK Satin Black SB Satin Brass BZ Antique Bronze SN Satin Nickel CH Chrome WH White

PROJECT	FIXTURE TYPE	DATE
---------	--------------	------

CIRRUS CEILING WALL WASH WITH GLARE SHIELD

REMOTE POWER, RGB & RGB+W

T-Bar Mounting Options for Cirrus Channels

9/16" TBAR 15/16" TBAR

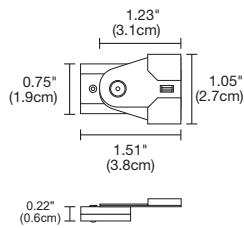
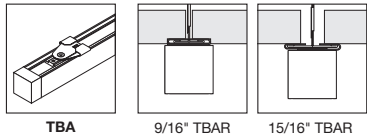
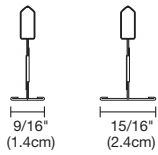

CEILING MOUNTING T-BAR CLIPS FOR 15/16" AND 9/16" CEILING GRID

TBA mounting clips are compatible with 15/16" and 9/16" T-Bar systems where the ceiling panels are flush with the grid, and 15/16" tegular ceiling panels.

System	Component	Type	Finish
CCD1M	MCL	TBA	WH
CCD1M Cirrus Ceiling	MCL Mounting Clip	TBA T-Bar Clip	WH White BK Black

15/16" TBAR

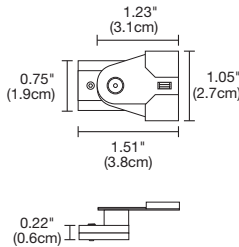
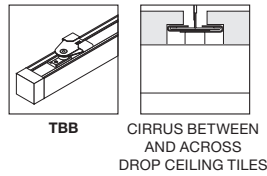

CEILING MOUNTING T-BAR CLIPS FOR 15/16" CEILING GRID

TBB mounting clips are compatible with 15/16" T-Bar systems where the ceiling panels sit below T-Bar grid (includes spacer).

System	Component	Type	Finish
CCD1M	MCL	TBB	WH
CCD1M Cirrus Ceiling	MCL Mounting Clip	TBB T-Bar Clip	WH White BK Black

OPTIMA PB VECTOR

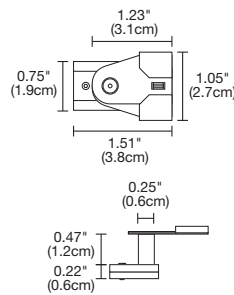
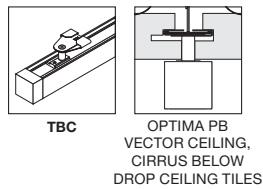
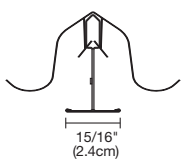

T-BAR CLIP FOR ARMSTRONG® OPTIMA® PB VECTOR

TBC Mounting clips are compatible with Armstrong® Optima® PB Vector 15/16" T-Bar systems with 1/4" reveal ceiling panels.

System	Component	Type	Finish
CCD1M	MCL	TBC	WH
CCD1M Cirrus Ceiling	MCL Mounting Clip	TBC T-Bar Clip	WH White BK Black

SLOTTED T-BAR

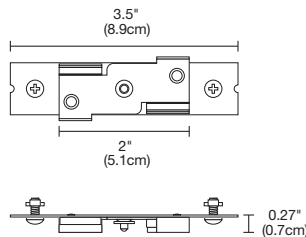
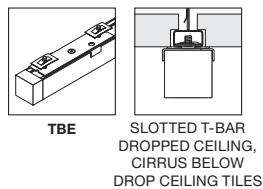
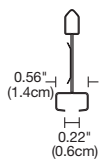

T-BAR SLOT MOUNTING CLIP

TBE Mounting clips are compatible with Slotted T-Bar Drop Ceiling systems with 1/4" openings, and mounts flush anywhere along the T-Bar grid.

System	Component	Type	Finish
CCD1M	MCL	TBE	WH
CCD1M Cirrus Ceiling	MCL Mounting Clip	TBE T-Bar Clip	WH White BK Black

SLOTTED T-BAR FINELINE 1/8"

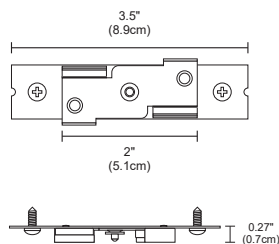
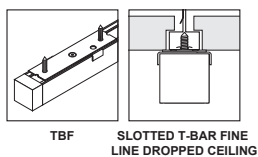
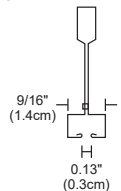

T-BAR FINELINE® SLOT MOUNTING CLIP

TBF Mounting clips are compatible with Donn® Fineline® Slotted T-Bar Drop Ceiling systems with 1/8" openings, and mounts flush anywhere along the T-Bar grid.

System	Component	Type	Finish
CCD1M	MCL	TBF	WH
CCD1M Cirrus Ceiling	MCL Mounting Clip	TBF T-Bar Clip	WH White BK Black

PROJECT	FIXTURE TYPE	DATE
---------	--------------	------

CIRRUS CEILING WALL WASH WITH GLARE SHIELD

REMOTE POWER, RGB & RGB+W

ARMSTRONG® INTERLUDE XL HRC

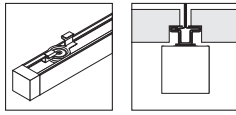

TBI ARMSTRONG INTERLUDE™ T-BAR, CIRRUS BELOW DROP CEILING TILES

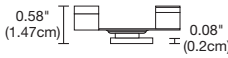
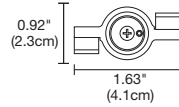

T-BAR INTERLUDE CLIP AND 9/16" FLAT GRID WITH TEGULAR TILES

TBI Mounting clips are compatible with Armstrong Interlude™ T-Bar systems where the ceiling panels are flush with the bottom of the grid and compatible with 9/16" flat grid with tegular tiles that sit below the grid up to 3/8".

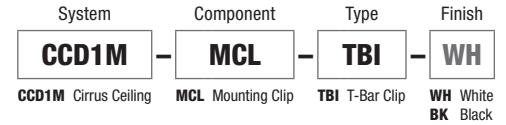

FLAT 9/16" TBAR GRID

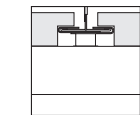

CIRRUS BETWEEN AND ACROSS DROP CEILING TILES

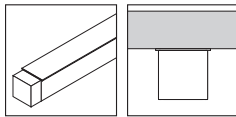

TBM METAL CEILING



MAGNETIC TAPE

TBM Magnetic Tape is compatible with flat metal ceilings such as Armstrong® Metalworks™.

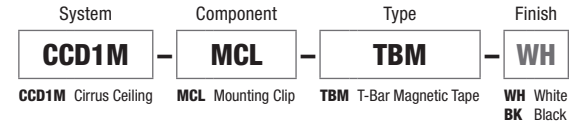

Drywall Mounting Options for Cirrus Channels

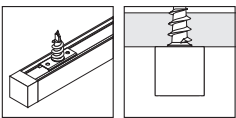

CC-MCL DRYWALL CEILING

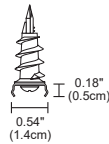
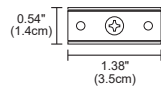

CEILING MOUNTING SPRING CLIP

Ceiling Mounting Spring clips are provided with every 2ft of Cirrus Ceiling Channel. The Clip snaps into the channel, staying securely fastened to the ceiling or wall.

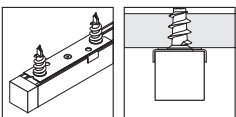
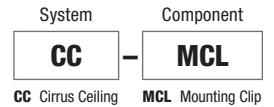

CC-MCL-L DRYWALL CEILING

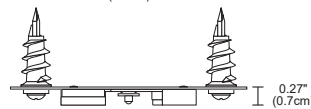
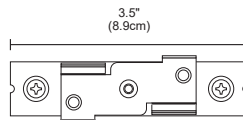

CEILING MOUNTING LOCKING CLIP

Ceiling Mounting Locking Clips may be ordered separately for extra support. The channel slides into the clip and locks in place staying securely fastened to the ceiling or to the wall.

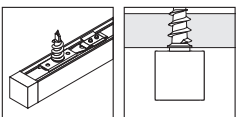
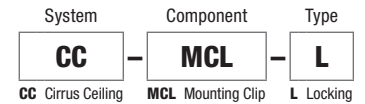

CCD1M-MCL-FL DRYWALL CEILING

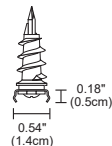
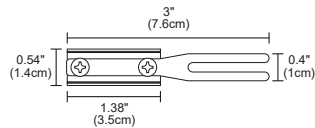

FORK LOCKING CLIP

Fork locking clip for ceiling or wall Mounting. The channel slides into the Fork locking Clip keeping the fixture secure.

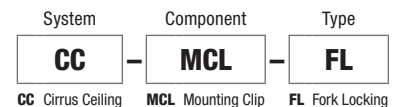

PROJECT		FIXTURE TYPE		DATE	
---------	--	--------------	--	------	--