

CIRRUS CEILING WALL GRAZER

24VDC REMOTE POWER, STATIC WHITE & WARM DIM

DESIGNED BY GREGORY KAY | ASSEMBLED IN AMERICA

REV 04.14.25

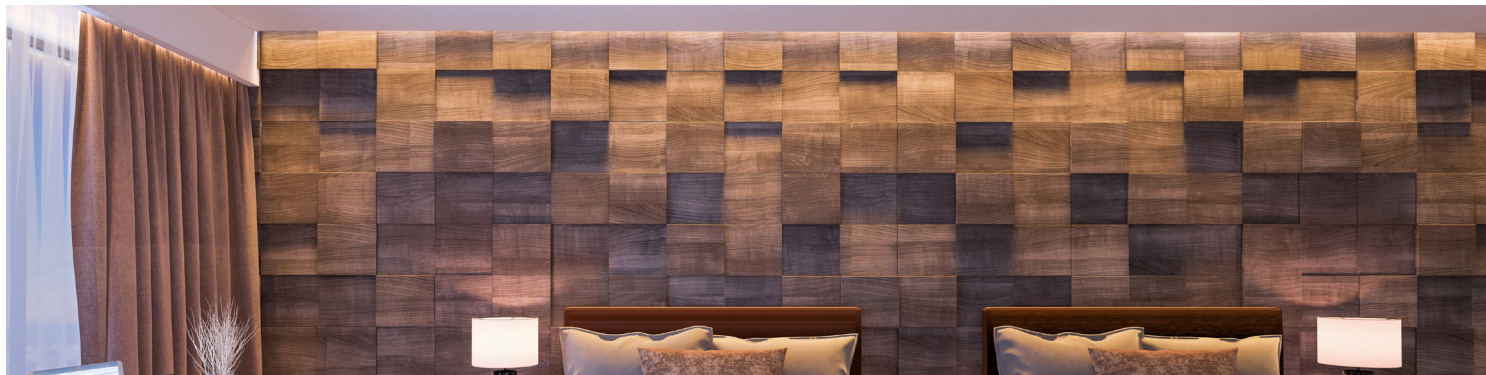

DESCRIPTION

A feature wall deserves to pop, the Cirrus Ceiling Wall Grazer brings to life undulating tiles, textural masonry and so much more. Offered in various increments from 12"-240", with a 10° or a 20° beam spread, and a variety of finishes and color multiple wattage and color temperatures ranging from 2400K through 4000K. Click here for all [other color temperatures](#). Fixture includes a 5 year pro-rated warranty. Send us your design ideas and we will provide the layout, parts list, and directions for easy installation: design@PureEdgeLighting.com.

INSTALLATION

- Mounts to a Standard Junction Box, 24VDC Class 2 Remote Power Supply (sold separately) feeding up to 100 watts at a maximum of 40' away
- Includes your choice of Canopy: 1" Rectangle Junction Box or 4.6" Square Canopy
- Power Supply sold separately
- Includes Ceiling Lock Clips for support (supplied every 4')
- May be recessed in Ceilings, Perimeters and Coves

FINISHES



Satin Black **BK** Antique Bronze **BZ** Chrome **CH** Satin Aluminum **SA** Satin Nickel **SN** White **WH**



Satin Brass with Black End Caps **BB** (CUSTOM) Satin Brass with White End Caps **BW** (CUSTOM)

LENSES

- Clear Lens with 10° Beam Spread
- Frosted Lens with 20° Beam Spread
- Up to 738 lumens per foot at 3000K

LAMP

- Offered in multiple Static White Color Temperatures: 2400K, 2700K, 3000K, 3500K & 4000K
- Lumen Performance: 356lm/ft at 3000K 7W per foot
- Designer Grade High CRI 95+ LEDs
- Average life: 50,000 hours
- For additional color temperatures refer to other specifications

REMOTE POWER SUPPLIES*, DIMMERS & CONTROLS (SOLD SEPARATELY)

24VDC, Class 2 wiring

- Pure Smart™ WiZ Pro [Power Supplies](#) & [Smart Controls](#)
- [UNI Driver: Universal Dimming \(ELV, TRIAC, 0-10V\)](#) ELV & TRIAC [Smart Dimmer & Switch](#)
- [DALI/DALI-2](#)
- [Electronic Low Voltage \(ELV\)](#)† 50W (fits inside junction box)

Lutron

- [Lutron](#) Hi-Lume/Ecosystem

*In-wall mounting and drop ceiling kits available for select power supplies

†ELV power supplies are not compatible with nLight, use only universal power supplies

APPLICATIONS

Designed for indoor use only. Wall grazing for textured surfaces such as architectural wall panels, hallways, brick, stone and wood.

APPROVALS

Indoor use, Class 2 wiring, ETL Listed, RoHS.

For quick & easy reference, plus the most up-to-date pricing, use our [Cirrus Ceiling Wall Grazer Configurator](#).

System	Lens	Wattage Per Foot	Canopy	Nominal Size	Color Temperature	Finish
CCWG	C	7W	1R	12	27K	SN
CCWG Cirrus Ceiling Wall Grazer	C 10° Clear Lens F 20° Frosted Lens	5W 4.4 Watts 7W 7.3 Watts	1R 1" Rectangle Canopy 4S 4.6" Square Split Canopy TBA Clips with 2ft Teflon plenum power feed, use for 15/16" or 9/16" Wide T-Bar Flush mounted ceiling panels TBB Clips with 2ft Teflon plenum power feed, use for 15/16" or 9/16" wide T-Bar with ceiling panel 3/8" below grid TBC Mounting clips are compatible with Armstrong Optima™ T-Bar systems where the ceiling panels are flush with the bottom of the grid TBD Tbar Ceiling Mounting Clips are compatible with 9/16" T-Bar systems where the ceiling panels sit below T-Bar grid (includes spacer) TBE Clips with 2ft Teflon plenum power feed, use for 9/16" wide Slotted T-Bar TBI Mounting clips are compatible with Armstrong Interlude™ T-Bar systems where the ceiling panels are flush with the bottom of the grid. TBM T-Bar Magnetic Tape is compatible with flat metal ceilings such as Armstrong Metalworks™	12-240 Order in various increments from 12" to 240"	24K 2400K Very Warm White 27K 2700K Incandescent White 27D 2700K Warm Dim (5W only) 30K 3000K Warm White 30D 3000K Warm Dim (5W only) 35K 3500K Neutral White 40K 4000K Cool White	BK Satin Black BZ Antique Bronze CH Chrome SA Satin Aluminum SN Satin Nickel WH White BB* Satin Brass with Black End Caps BW* Satin Brass with White End Caps *Available via Custom Quotation

*Maximum shipping length 120", Chrome 84"

**See length chart for exact dimensions

PROJECT	FIXTURE TYPE	DATE
---------	--------------	------

CIRRUS CEILING WALL GRAZER

24VDC REMOTE POWER, STATIC WHITE & WARM DIM

NOMINAL LAMP DATA: Lamp Data Cirrus Ceiling Wall Grazer

DESCRIPTION	CCWG																							
	20° CLEAR LENS										20° FROSTED LENS													
	5W (4.4 watts)					7W (7.3 watts)					5W (4.4 watts)					7W (7.3 watts)								
WATTS PER FOOT	24K	27K	27D*	30K	30D*	35K	40K	24K	27K	30K	35K	40K	24K	27K	27D*	30K	30D*	35K	40K	24K	27K	30K	35K	40K
COLOR TEMPERATURE	379	383	454	399	455	459	483	584	590	615	707	744	455	460	545	479	546	551	580	701	708	738	849	893
LUMENS PER FOOT (lm/ft)	86	87	95	91	95	104	110	80	81	84	97	102	103	105	114	109	114	125	132	96	97	101	116	122
LUMENS PER WATT (lm/w)	90+	95+	93+	95+	92+	85+	85+	90+	95+	95+	85+	85+	90+	95+	93+	95+	92+	85+	85+	90+	95+	95+	85+	85+
CRI																								

*27D, 30D - Warm Dim (4.8 Watts)

LIGHT DATA Beam Spread & Foot Candle Data for Cirrus Ceiling Wall Grazer

30K 20° 5W FROSTED LENS			30K 20° 7W FROSTED LENS		
DISTANCE	BEAM	FOOT CANDLE	DISTANCE	BEAM	FOOT CANDLE
12"	4"	288	12"	4"	432
18"	6"	127	18"	6"	170
24"	8"	76	24"	8"	100
36"	12"	50	36"	12"	67

DRAWINGS Canopy & Channel Drawings for Cirrus Ceiling Wall Grazer

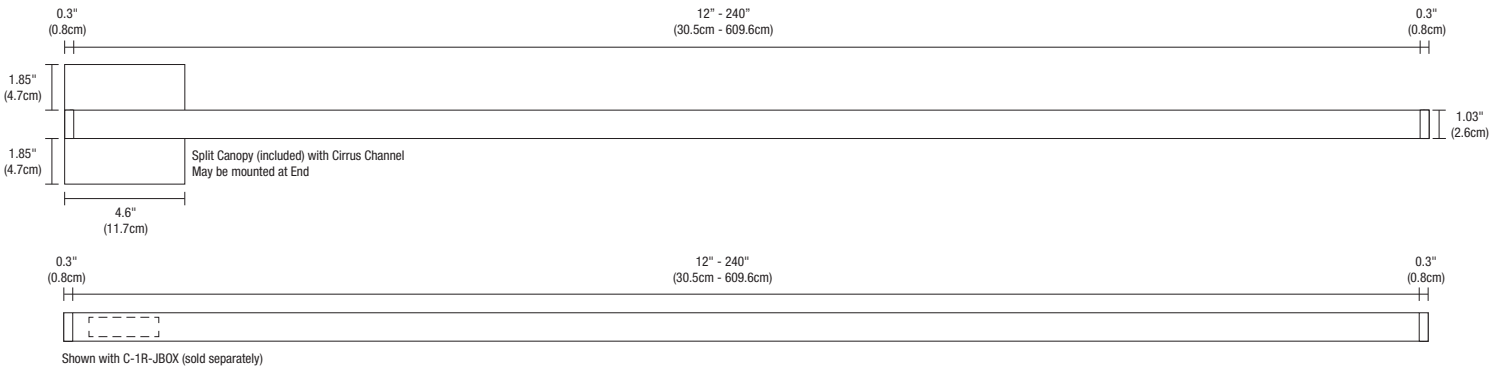

CIRRUS WALL GRAZER

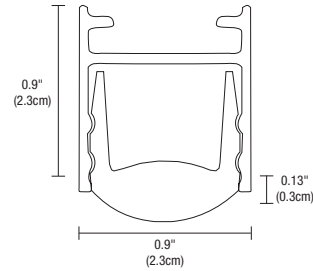

CIRRUS WALL GRAZER LENS

PROJECT	FIXTURE TYPE	DATE
---------	--------------	------

COMPONENTS J-box, Split Canopies, & Mounting Clips are included and sold separately for replacement

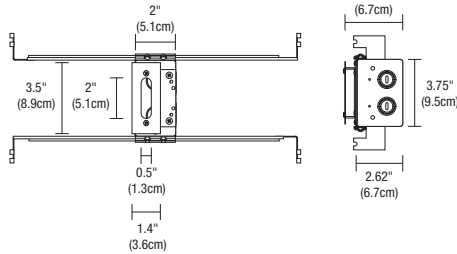
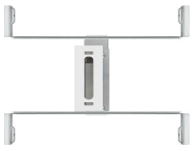

1" RECTANGLE CANOPY & J-BOX
(INCLUDED WITH 1R SELECTED IN FIXTURE ORDERING CODE)

The Slim-Profile Junction Box with Hanger Bars mounts to studs spaced between 14.5" and 25" apart behind drywall. Allows low voltage DC wires from Remote Power Supply to connect to channel wires. The Junction Box opening is covered by the fixture for a clean, safe connection. Includes a Goof Plate, for poor plastering around J-box.

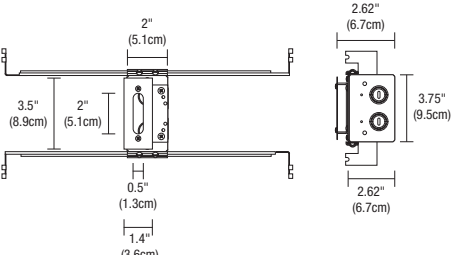
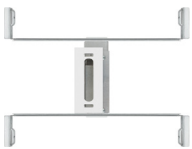
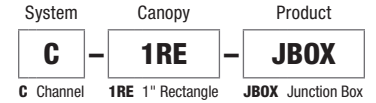

1" RECTANGLE CANOPY & J-BOX WITH 50W POWER SUPPLY
(ORDER SEPARATELY)

The Slim-Profile Junction Box with Hanger Bars mounts to studs spaced between 14.5" and 25" apart behind drywall. Allows low voltage DC wires from included power supply to connect to channel wires. The Junction Box opening is covered by the fixture for a clean, safe connection. Rated 60 watts for Non-Insulated Ceiling or Wall Power Supply. Rated 50 watts for Insulated Ceiling. Includes a Goof Plate, for poor plastering around J-box. ELV power supplies are not compatible with nLight, use only 0-10 volt or Uni driver power supplies

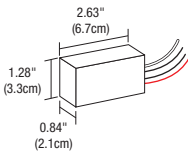

MOUNTING CLIPS

LCS.6 mounting clips are provided with every 12" of Flex Neon and may be ordered separately as replacement parts. The LCS.6-MCL-075 rotates Channel up to 75°. LCS.6-MCL-90 mounts Channel at a 90° angle.



LCS.6-MCL-075

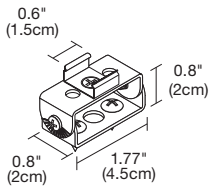

LCS.6-MCL-075

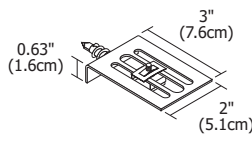

LCS.6-MCL-90

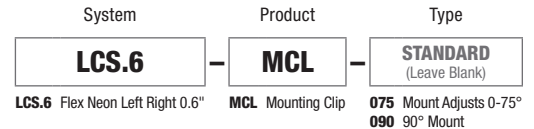

PROJECT		FIXTURE TYPE		DATE	
---------	--	--------------	--	------	--

CIRRUS CEILING WALL GRAZER

24VDC REMOTE POWER, STATIC WHITE & WARM DIM

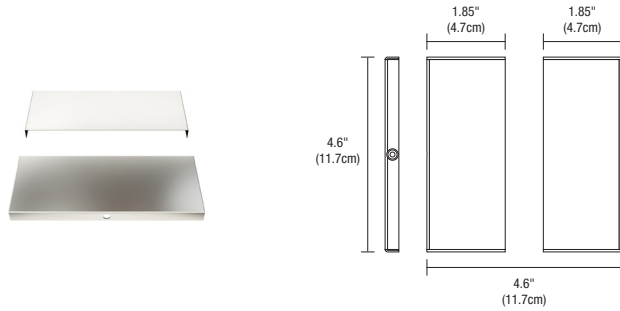

4" SQUARE SPLIT CANOPY

(INCLUDED WITH 4S SELECTED IN FIXTURE ORDERING CODE)

The 4" Square Canopy fits on a standard 4" electrical box with round plaster ring. It fits flush along channel while covering Junction Box. The Canopy may float anywhere along the channel and comes in six finishes.

System	Canopy	Finish
CC	4SQ	SN
CC Cirrus Ceiling	4SQ 4.6" Split Square	BK Satin Black BZ Antique Bronze CH Chrome SB Satin Brass SN Satin Nickel WH White

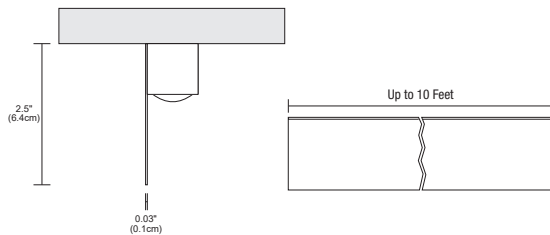

SHIELD

The Channel Shield mounts to the ceiling along the Cirrus Wall Wash or Cirrus Wall Grazer fixtures (with C-1RE-JBOX only) to shield light brightness from view.

System	Product	Length	Finish
C	2.5	10FT	WH
C Channel	2.5 Shield 2.5" Height	10FT 10 Feet	WH White

PROJECT		FIXTURE TYPE		DATE	
---------	--	--------------	--	------	--

CIRRUS CEILING WALL GRAZER

24VDC REMOTE POWER, STATIC WHITE & WARM DIM

T-Bar Mounting Options for Cirrus Channels

9/16" TBAR 15/16" TBAR

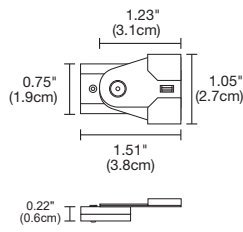
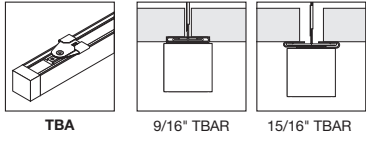
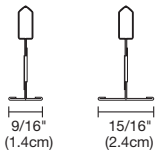

CEILING MOUNTING T-BAR CLIPS FOR 15/16" AND 9/16" CEILING GRID

TBA mounting clips are compatible with 15/16" and 9/16" T-Bar systems where the ceiling panels are flush with the grid, and 15/16" tegular ceiling panels.

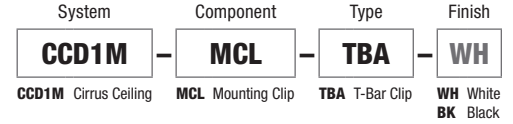

15/16" TBAR

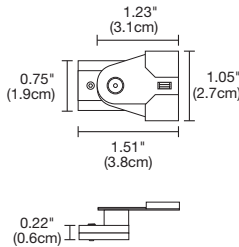
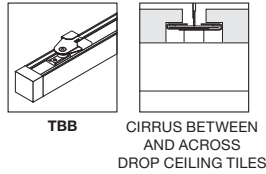

CEILING MOUNTING T-BAR CLIPS FOR 15/16" CEILING GRID

TBB mounting clips are compatible with 15/16" T-Bar systems where the ceiling panels sit below T-Bar grid (includes spacer).

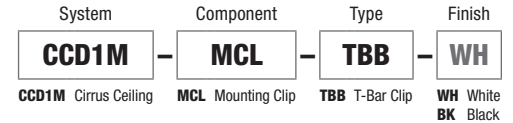

OPTIMA PB VECTOR

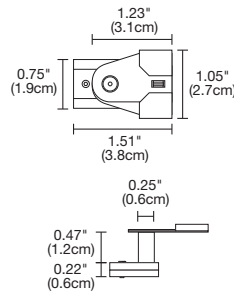
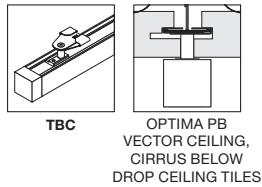
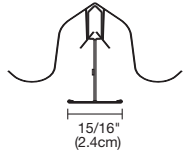

T-BAR CLIP FOR ARMSTRONG® OPTIMA® PB VECTOR

TBC Mounting clips are compatible with Armstrong® Optima® PB Vector 15/16" T-Bar systems with 1/4" reveal ceiling panels.

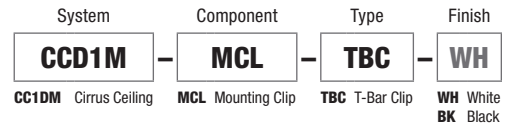

SLOTTED T-BAR

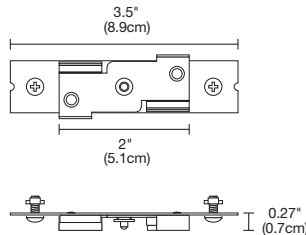
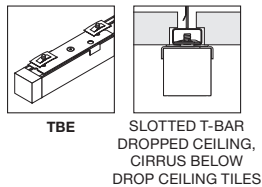
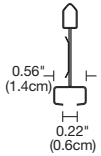

T-BAR SLOT MOUNTING CLIP

TBE Mounting clips are compatible with Slotted T-Bar Drop Ceiling systems with 1/4" openings, and mounts flush anywhere along the T-Bar grid.

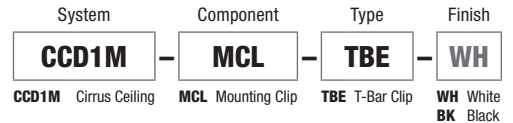

SLOTTED T-BAR FINELINE 1/8"

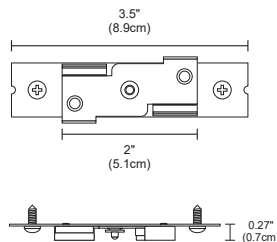
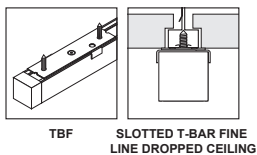
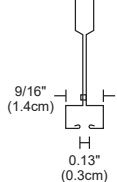

T-BAR FINELINE® SLOT MOUNTING CLIP

TBF Mounting clips are compatible with Donn® Fineline® Slotted T-Bar Drop Ceiling systems with 1/8" openings, and mounts flush anywhere along the T-Bar grid.

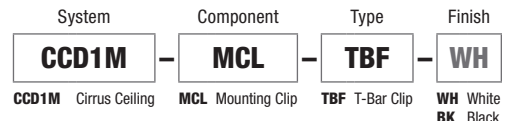

PROJECT	FIXTURE TYPE	DATE
---------	--------------	------

CIRRUS CEILING WALL GRAZER

24VDC REMOTE POWER, STATIC WHITE & WARM DIM

ARMSTRONG®
INTERLUDE XL HRC

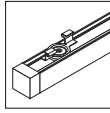

TBI

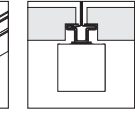

ARMSTRONG
INTERLUDE™ T-BAR,
CIRRUS BELOW
DROP CEILING TILES

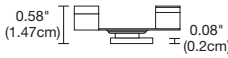
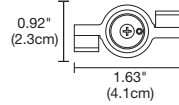

T-BAR INTERLUDE CLIP AND 9/16" FLAT GRID WITH TEGULAR TILES

TBI Mounting clips are compatible with Armstrong Interlude™ T-Bar systems where the ceiling panels are flush with the bottom of the grid and compatible with 9/16" flat grid with tegular tiles that sit below the grid up to 3/8".

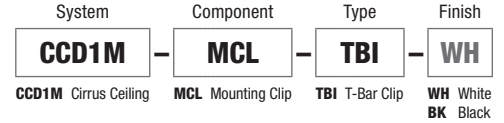

FLAT 9/16" TBAR GRID

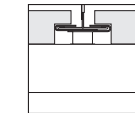

CIRRUS BETWEEN
AND ACROSS
DROP CEILING TILES

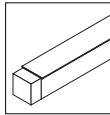

TBM

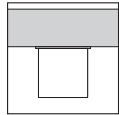

METAL CEILING



MAGNETIC TAPE

TBM Magnetic Tape is compatible with flat metal ceilings such as Armstrong® Metalworks™.

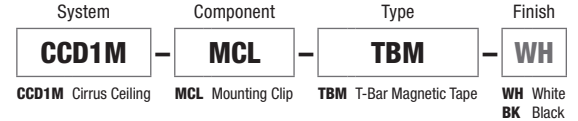

Drywall Mounting Options for Cirrus Channels

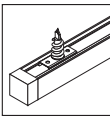

CC-MCL

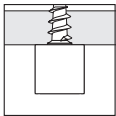

DRYWALL CEILING

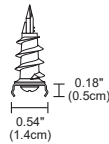
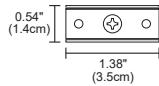

CEILING MOUNTING SPRING CLIP

Ceiling Mounting Spring clips are provided with every 2ft of Cirrus Ceiling Channel. The Clip snaps into the channel, staying securely fastened to the ceiling or wall.

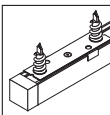
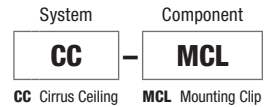

CC-MCL-L

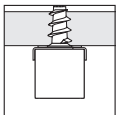

DRYWALL CEILING

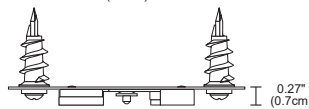
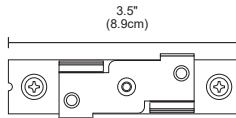

CEILING MOUNTING LOCKING CLIP

Ceiling Mounting Locking Clips may be ordered separately for extra support. The channel slides into the clip and locks in place staying securely fastened to the ceiling or to the wall.

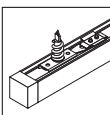

CCD1M-MCL-FL

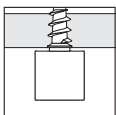

DRYWALL CEILING

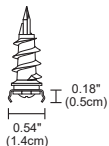
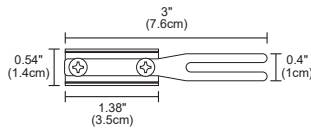

FORK LOCKING CLIP

Fork locking clip for ceiling or wall Mounting. The channel slides into the Fork locking Clip keeping the fixture secure.

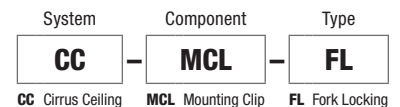

PROJECT		FIXTURE TYPE		DATE	
---------	--	--------------	--	------	--



CIRRUS CEILING WALL GRAZER

24VDC REMOTE POWER, STATIC WHITE & WARM DIM



REV 04.14.25

Length Chart: Actual lengths for Cirrus Ceiling Wall Grazer

STATIC WHITE					
Ordering Code (Nominal Size)	Actual Length (Inches)	Actual Length (Chrome)	Ordering Code (Nominal Size)	Actual Length (Inches)	Actual Length (Chrome)
12	13.1	13.1	128	128.4	128.4
15	15.5	15.5	130	130.8	130.8
17	17.9	17.9	132	133.2	133.2
20	20.3	20.3	135	135.6	135.6
22	22.7	22.7	137	138	138
24	25.1	25.1	140	140.4	140.4
27	27.5	27.5	142	142.8	142.8
29	29.9	29.9	144**	145.2	145.2
32	32.3	32.3	147	147.6	147.6
34	34.7	34.7	149	150	150
36	37.1	37.1	152	152.4	152.4
39	39.5	39.5	154	154.8	154.8
41	41.9	41.9	156	157.2	157.2
44	44.3	44.3	159	159.6	159.6
46	46.7	46.7	161	162	162
48	49.1	49.1	164	164.4	164.4
51	51.5	51.5	166	166.8	166.8
53	53.9	53.9	168	169.2	169.2
56	56.3	56.3	171	171.6	172
58	58.7	58.7	173	174	174.4
60	61.1	61.1	176	176.4	176.8
63	63.5	63.5	178	178.8	179.2
65	65.9	65.9	180	181.2	181.6
68	68.3	68.3	183	183.6	184
70	70.7	70.7	185	186	186.4
72	73.1	73.1	188	188.4	188.8
75	75.5	75.5	190	190.8	191.2
77	77.9	77.9	192	193.2	193.6
80	80.3	80.3	195	195.6	196
82	82.7	82.7	197	198	198.4
84	85.1	85.1*	200	200.4	200.8
87	87.5	87.6	202	202.8	203.2
89	89.9	90	204	205.2	205.6
92	92.3	92.4	207	207.6	208
94	94.7	94.8	209	210	210.4
96	97.1	97.2	212	212.4	212.8
99	99.5	99.6	214	214.8	215.2
101	101.9	102	216	217.2	217.6
104	104.3	104.4	219	219.6	220
106	106.7	106.8	221	222	222.4
108	109.1	109.2	224	224.4	224.8
111	111.5	111.6	226	226.8	227.2
113	113.9	114	228	229.2	229.6
116	116.3	116.4	231	231.6	232
118	118.7	118.8	233	234	234.4
120*	121.1	121.2	236	236.4	236.8
123	123.6	123.6	238	238.8	239.2
125	126	126	240	241.2	241.6

*Maximum shipping length

**Maximum Chrome shipping length

PROJECT		FIXTURE TYPE		DATE	
---------	--	--------------	--	------	--



CIRRUS CEILING WALL GRAZER

24VDC REMOTE POWER, STATIC WHITE & WARM DIM



REV 04.14.25

Length Chart: Actual lengths for Cirrus Ceiling Wall Grazer

WARM DIM					
Ordering Code (Nominal Size)	Actual Length (Inches)	Actual Length (Chrome)	Ordering Code (Nominal Size)	Actual Length (Inches)	Actual Length (Chrome)
12	13.1	13.1	129	130.2	130.2
15	16.1	16.1	132	133.2	133.2
18	19.1	19.1	135	136.2	136.2
21	22.1	22.1	138	139.2	139.2
24	25.1	25.1	141	142.2	142.2
27	28.1	28.1	144	145.2	145.2
30	31.1	31.1	147	148.2	148.2
33	34.1	34.1	150	151.2	151.2
36	37.1	37.1	153	154.2	154.2
39	40.1	40.1	156	157.2	157.2
42	43.1	43.1	159	160.2	160.2
45	46.1	46.1	162	163.2	163.2
48	49.1	49.1	165	166.2	166.2
51	52.1	52.1	168	169.2	169.2
54	55.1	55.1	171	172.2	172.6
57	58.1	58.1	174	175.2	175.6
60	61.1	61.1	177	178.2	178.6
63	64.1	64.1	180	181.2	181.6
66	67.1	67.1	183	184.2	184.6
69	70.1	70.1	186	187.2	187.6
72	73.1	73.1	189	190.2	190.6
75	76.1	76.1	192	193.2	193.6
78	79.1	79.1	195	196.2	196.6
81	82.1	82.1	198	199.2	199.6
84	85.1	85.1**	201	202.2	202.6
87	88.1	88.2	204	205.2	205.6
90	91.1	91.2	207	208.2	208.6
93	94.1	94.2	210	211.2	211.6
96	97.1	97.2	213	214.2	214.6
99	100.1	100.2	216	217.2	217.6
102	103.1	103.2	219	220.2	220.6
105	106.1	106.2	222	223.2	223.6
108	109.1	109.2	225	226.2	226.6
111	112.1	112.2	228	229.2	229.6
114	115.1	115.2	231	232.2	232.6
117	118.1	118.2	234	235.2	235.6
120*	121.1	121.2	237	238.2	238.6
123	124.2	124.2	240	241.2	241.6
126	127.2	127.2			

*Maximum shipping length

**Maximum Chrome shipping length

PROJECT		FIXTURE TYPE		DATE	
---------	--	--------------	--	------	--

TM30 DATA

24VDC REMOTE POWER, STATIC WHITE & WARM DIM

TM-30-15 DATA: The data below is for bare LED Static White Strip. Consistent color temperatures throughout a single strip and among multiple strips is possible through a 3 phase binning process in which each order is inspected with a color meter to ensure uniformity.

2400K | Rf: 84.5 | Rg: 94.4

Color Vector Graphic

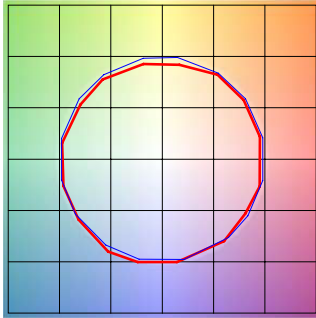

■ Test ■ Reference

HUE BIN	Rf	GRAPHIC SHIFTS %	
		CHROMA	HUE
1	92	-2.4%	1.5%
2	94.7	-2.1%	-0.0%
3	95.4	-1.9%	-0.1%
4	88.7	-6.7%	-3.1%
5	92.8	-5.6%	1.0%
6	92.7	-3.4%	3.4%
7	89.9	-4.3%	4.1%
8	92.4	-1.4%	4.4%
9	89	-0.6%	5.8%
10	88.9	0.4%	6.2%
11	89.7	4.0%	5.4%
12	92.6	3.0%	-0.7%
13	90.9	1.1%	-7.0%
14	89.9	0.5%	-5.8%
15	92.1	-3.2%	0.1%
16	88.9	-1.7%	-6.3%

2700K | Rf: 87.7 | Rg: 96.1

Color Vector Graphic

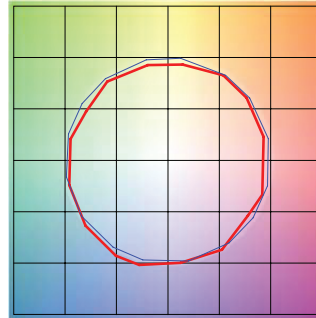

■ Test ■ Reference

HUE BIN	Rf	GRAPHIC SHIFTS %	
		CHROMA	HUE
1	88.0	-4.3%	2.6%
2	91.6	-2.4%	2.0%
3	93.7	-1.4%	1.9%
4	88.9	-5.6%	-3.1%
5	92.3	-5.5%	-0.5%
6	92.9	-3.5%	0.1%
7	84.5	-7.5%	4.6%
8	90.8	-3.0%	4.4%
9	84.5	-1.3%	8.3%
10	83.9	2.0%	9.8%
11	87.2	5.3%	7.1%
12	89.2	5.4%	-2.6%
13	88.7	0.3%	-7.8%
14	86.8	1.7%	-9.3%
15	87.6	-5.4%	-1.3%
16	83.6	-3.3%	-9.5%

3000K | Rf: 88.1 | Rg: 99.7

Color Vector Graphic

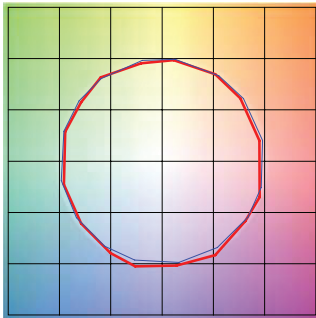

■ Test ■ Reference

HUE BIN	Rf	GRAPHIC SHIFTS %	
		CHROMA	HUE
1	92.5	-3.1%	0.3%
2	93.3	-2.3%	1.9%
3	90.9	-0.8%	3.9%
4	94.3	-1.1%	1.4%
5	92.5	-2.6%	1.5%
6	96.4	1.2%	-0.3%
7	92.6	-2.5%	-0.0%
8	96.9	-1.4%	0.2%
9	92.3	-1.8%	4.3%
10	86.6	-0.7%	7.0%
11	86.5	2.4%	8.2%
12	89.8	5.9%	1.7%
13	93.9	2.6%	-2.7%
14	89.4	5.1%	-5.8%
15	90.1	-0.1%	-4.7%
16	86.5	0.3%	-9.7%

3500K | Rf: 86.1 | Rg: 95.5

Color Vector Graphic

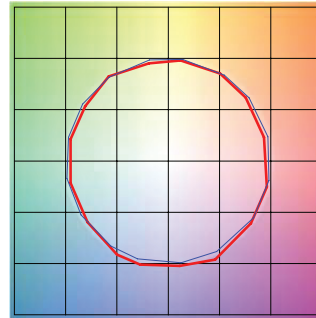

■ Test ■ Reference

HUE BIN	Rf	GRAPHIC SHIFTS %	
		CHROMA	HUE
1	90.8	-3.8%	0.3%
2	92.3	-2.8%	2.1%
3	89.7	-1.0%	4.3%
4	92.6	-1.4%	1.7%
5	91.8	-3.1%	1.3%
6	96.2	0.8%	-0.4%
7	92.9	-3.2%	0.2%
8	94.3	-2.5%	1.5%
9	90.4	-2.5%	5.2%
10	84.3	-1.4%	9.5%
11	83.1	3.5%	9.8%
12	88.2	4.8%	3.4%
13	94.0	2.7%	-2.0%
14	88.7	5.9%	-5.8%
15	88.7	0.7%	-5.9%
16	86.8	-0.7%	-6.7%

4000K | Rf: 87.6 | Rg: 96.8

Color Vector Graphic

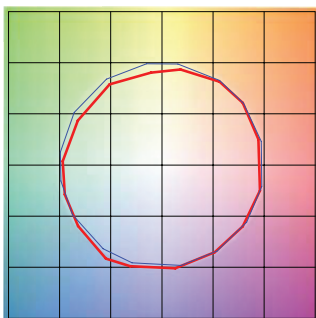

■ Test ■ Reference

HUE BIN	Rf	GRAPHIC SHIFTS %	
		CHROMA	HUE
1	88.9	-2.4%	2.5%
2	93.3	-0.4%	0.8%
3	94.8	-1.0%	-0.6%
4	87.9	-4.9%	-3.6%
5	85.3	-9.4%	-2.6%
6	90.2	-6.0%	0.2%
7	85.3	-7.6%	4.6%
8	83.7	-4.1%	8.2%
9	79.5	-1.1%	13.8%
10	78.6	1.5%	12.1%
11	83.5	6.4%	7.8%
12	90.9	3.6%	-1.1%
13	88.3	1.7%	-6.3%
14	91.9	-0.4%	-2.2%
15	84.5	-0.9%	-5.5%
16	84.7	-1.1%	-4.4%

PROJECT		FIXTURE TYPE		DATE	
---------	--	--------------	--	------	--

TM30 DATA

24VDC REMOTE POWER, STATIC WHITE & WARM DIM

TM-30-15 DATA: The data below is for bare LED Warm Dim Strip. Consistent color temperatures throughout a single strip and among multiple strips is possible through a 3 phase binning process in which each order is inspected with a color meter to ensure uniformity.

2700D | Rf: 90.7 | Rg: 101.1

Color Vector Graphic

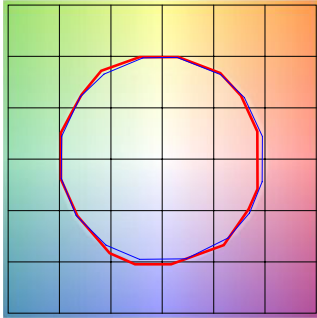

■ Test ■ Reference

HUE BIN	Rf	GRAPHIC SHIFTS %	
		CHROMA	HUE
1	90.9	-4.1%	1.1%
2	91.8	-2.2%	3.2%
3	89.0	0.2%	5.0%
4	92.9	-1.1%	0.8%
5	93.9	1.1%	1.7%
6	93.3	3.3%	0.0%
7	93.1	-0.5%	-1.9%
8	97.2	-0.3%	-0.9%
9	93.4	-1.0%	3.2%
10	89.9	-0.1%	5.6%
11	87.0	4.7%	7.2%
12	89.2	5.8%	-0.2%
13	89.1	3.5%	-6.7%
14	86.3	4.1%	-9.2%
15	91.4	-2.0%	-3.6%
16	84.7	-2.1%	-10.3%

3000D | Rf: 90.6 | Rg: 101.1

Color Vector Graphic

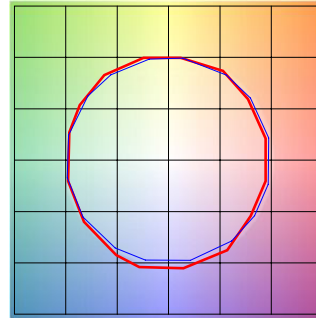

■ Test ■ Reference

HUE BIN	Rf	GRAPHIC SHIFTS %	
		CHROMA	HUE
1	91.5	-3.5%	1.3%
2	92.2	-1.8%	3.0%
3	89.3	0.5%	4.8%
4	92.7	-1.1%	0.6%
5	93.3	0.5%	1.4%
6	93.8	2.7%	-0.8%
7	91.2	-2.1%	-0.2%
8	97.0	-0.5%	-0.7%
9	92.5	-0.7%	3.8%
10	88.3	0.9%	7.1%
11	87.5	3.9%	7.6%
12	88.2	6.2%	-0.2%
13	89.9	3.4%	-6.0%
14	86.9	4.4%	-8.5%
15	91.9	-1.9%	-2.9%
16	84.7	-1.3%	-10.6%

PROJECT		FIXTURE TYPE		DATE	
---------	--	--------------	--	------	--