

Front

PURE SMART™
by PureEdge Lighting

WIZ
PRO

Smart Wi-Fi Room Controller Single Pole or 3-Way Compatible

CWW-TW-SCENE-WH

Included in Box:



Specifications:

Power: 120V AC, 60Hz
Wireless Frequency: 2.4GHz
Wireless Standard: IEEE802.11b/g/n
Maximum Load: 600W for hardwired loads
No Maximum for wireless loads
Temperature Range: 32° F-104° F
Range: up to 50 ft radius from Wi-Fi Access point
Indoor use.
For control of WIZ Connected smart loads only

Contents

Section 1. Installation

- Pre-installation preparation
- Installation steps

Section 2. Wiring Diagram

- Wiring Instructions
- Single pole and 3-way wiring diagram

Section 3. APP Pairing

- Download the app
- Add a device in your app using Smart Pairing

For more details, please refer to the manual.
If you have any questions during installation,
please contact us techsupport@pureedgelighting.com

Section 1. Installation

✂ A Few Quick Reminders

A quick note before we go over the wiring schematics. Please do not try installing this device if you are unsure of how electrical circuits operate within your home. As exciting as it is to have a smart switch installed, it can be dangerous and even life-threatening if you do not install this correctly. Please consult a qualified electrician if necessary.

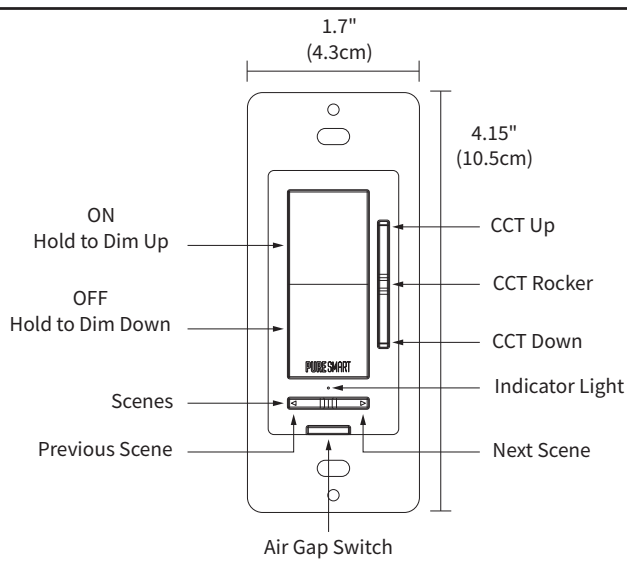
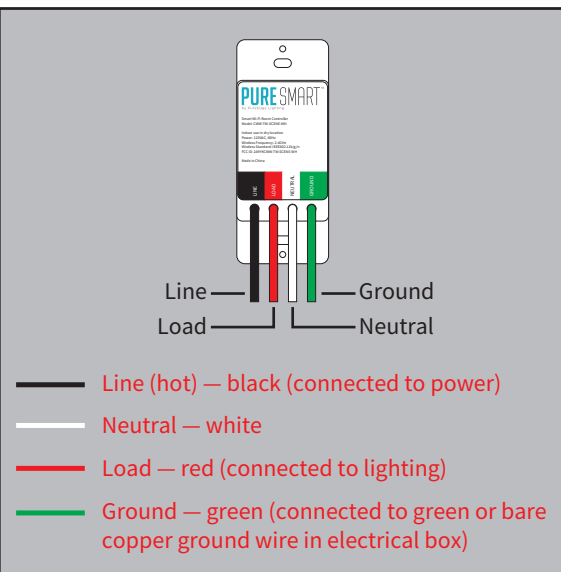

Note before installation

- 1) The Pure Smart Room Controller must not exceed 600W for hardwired loads. Hardwired installation is optional. No load maximum for wireless loads.
- 2) Works with smart loads only. Not for use with non-smart bulbs or fixtures. Compatible with any WIZ Connected or Pure Smart lamp/fixture/device.
- 3) Works only with another Pure Smart or WIZ Connected wall control for 2 location control. Only compatible with **SWW-SWT-WH**, **SWW-DIM-WH**, **CWW-TW-SCENE-WH**, and **CWR-TW-SCENE-WH** for multi-location control. May NOT be used with traditional non-smart 3-way/4-way on-off combinations.
- 4) Please check the original 3-way wiring in your home before installation, and then follow the wiring diagram included here in the manual.
- 5) Install the smart room controller in the electrical box which directly connects to the power **Line and Neutral**.
- 6) This room controller **requires a Neutral for installation**.
- 7) Not recommended for use with a fan.

If you have any questions, please contact us at techsupport@pureedgelighting.com

Section 2. Wiring Diagram

Installation

1. Tools Needed: Flat Head Screwdriver.
2. Turn power OFF at circuit breaker or fuse box.
3. Remove wallplate.
4. Remove the switch mounting screws.

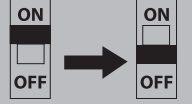

5. Disconnect the wires and label them after removing the old switch. Please use our sticker.



6. There are up to 4 different colored wire leads on the smart room controller, each of these are marked. Refer to the wiring diagrams included here for how to connect the wire leads with the existing conductors in the electrical box.
7. After successful wiring, install the wall plate with the included screws.

- 1) Neutral required. If the electrical box does not have a Neutral, please stop! Connect the white wire to the neutral wire (use the white jumper that is included in the packaging.)
- 2) Before the old switch is detached, please identify the line voltage.
- 3) Only works with a smart dimmer, smart on/off, or another smart room controller for 2 location control. Not for use with traditional non-smart wall controls.

NOTE: Only for use with **SWW-SWT-WH Smart On/Off Switch**, **SWW-DIM-WH Smart Dimmer**, **CWW-TW-SCENE-WH Smart Room Controller**, and **CWR-TW-SCENE-WH Battery Operated Smart Room Controller** for multi-location control.

Single Pole Wiring

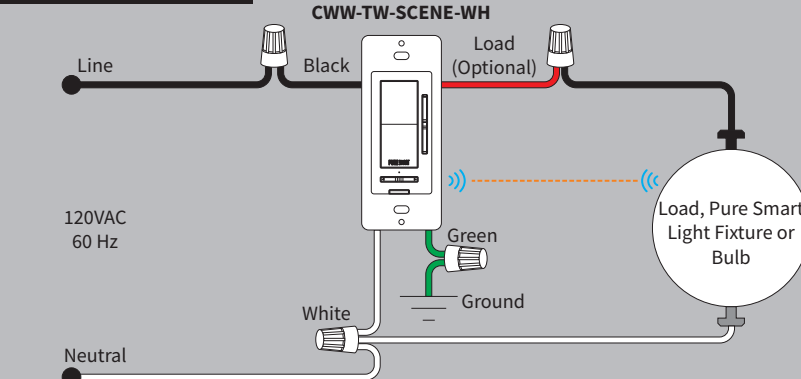

Multi - Location Wiring

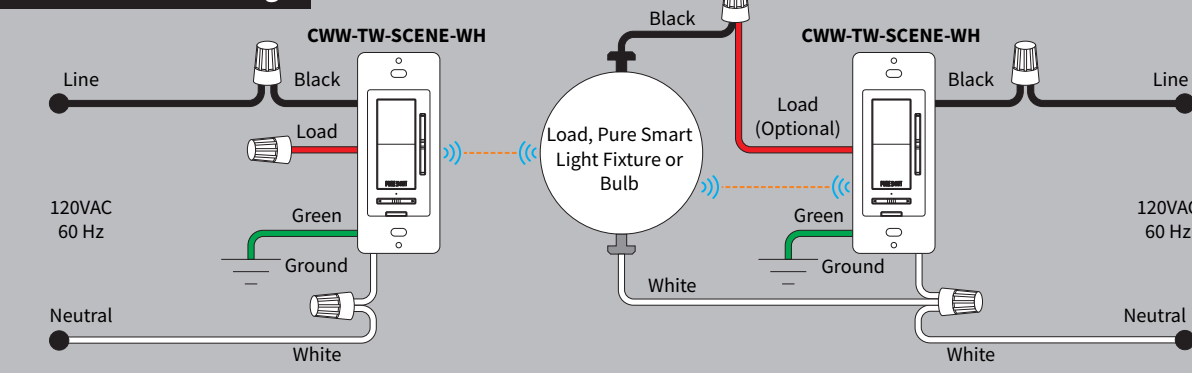

FOR MULTI-LOCATION CONTROL:

For multi-location control with the Pure Smart Room Controller and Pure Smart Wi-Fi Switch or Dimmer, you'll place the Room Controller in the same room and make the Smart Switch or Dimmer the target for the Room Controller. For multi-location control with 2 Room Controllers, you'll place both of them in the same room or in control of the same target. **No 3 way wiring is required. Hardwired load is optional.** Refer to wiring diagram and pairing instructions for additional information.

Replace Existing Traditional 3-way

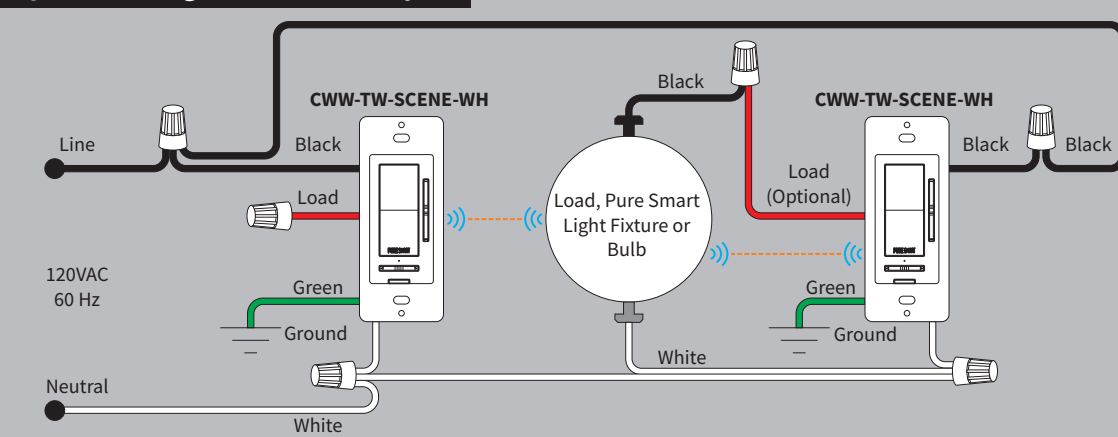

Section 3. App Pairing

Downloading WIZ App V2:

1. Please scan the QR code to download the application "WIZ App V2".
2. You may also find the WIZ app in the Apple App Store or the Google Play Store under "WIZ App V2".
3. After you download the WIZ Connected App and register a new account, please follow the instructions below to set up your smart switch.

For WIZ Pro Dashboard Users: WIZ Pro Dashboard account and home must be created before starting commissioning in the WIZ app. Please create an account on WIZ Pro Dashboard. Then create your home or location. After doing so, you may proceed to create an invitation in the dashboard by going to "Settings" and then the "members" tab. By clicking on the "Invite" button you will be able to generate an invitation to access this dashboard location in the WIZ app. From there you can proceed with commissioning in the WIZ app but also have the added functionality of the Dashboard desktop application.

PLEASE READ BEFORE PAIRING ROOM CONTROLLER IN WIZ APP:
In the WIZ app, any Pure Smart / WIZ Connected fixture(s) must be added to a room prior to adding the Room Controller that will control them. Please refer to the installation manual included with the Pure Smart / WIZ Connected light fixtures for setup.

Connected by
**WIZ
PRO**



Smart Pairing

1. Once your lamps or fixtures have been connected, press the plus sign in the top right hand corner to add your smart room controller.
2. Select "Wall Controller" from the available device types.
3. Select whichever room the Wall Controller will be installed in or controlling.
4. Follow the on-screen instructions and ensure that your Wall Controller is connected to 120V power and then press "START".
5. Follow the on-screen instructions by pressing the On button 3 times and wait while the WIZ app looks for your Wall Controller.
6. When you receive the "Accessory found" message you may press done and begin controlling the light fixtures in that room with your Wall Controller. Follow additional instructions below to personalize settings and controls.

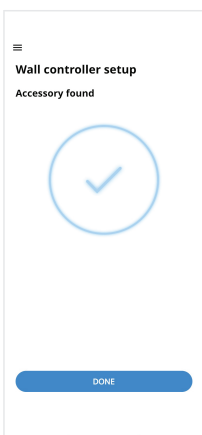
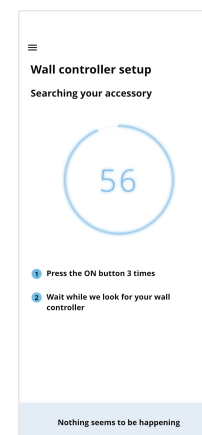
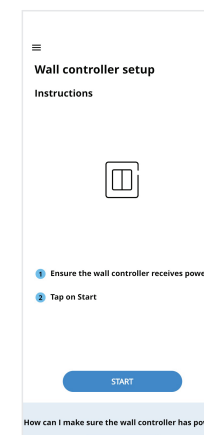
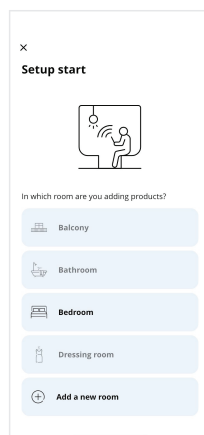
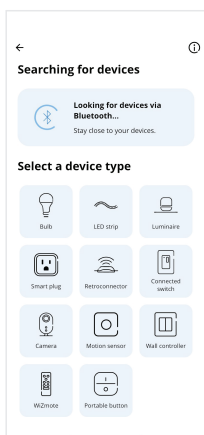
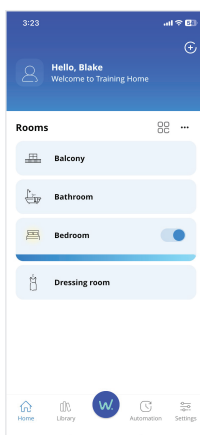

Additional Settings for Wall Controller Accessory

1. For additional setup, select "Settings" on the bottom right hand corner of the Home screen.
2. Select "Accessories" from the Settings menu.
3. Select the Wall Controller that you'd like to customize control with.
4. If needed, you have the option to rename your Wall Controller.
5. You can select individual targets that the Wall Controller will control by choosing specific fixtures or devices.
6. Or you can choose an entire room for the Wall Controller to control.

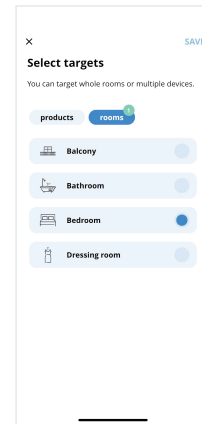
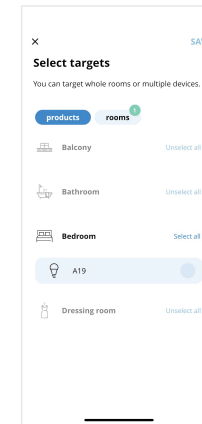
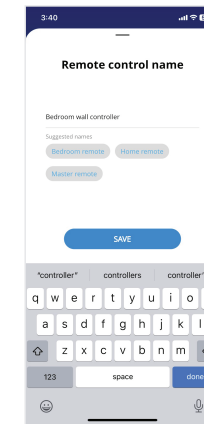
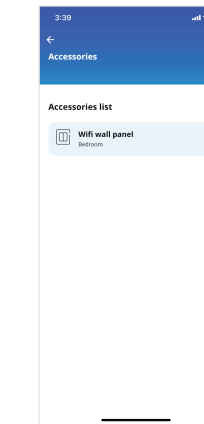
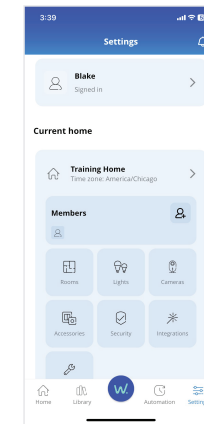
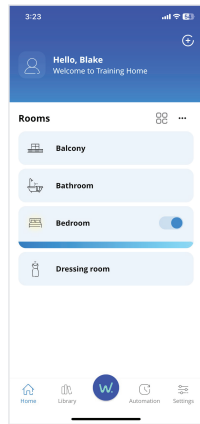

FCC
This device complies with part 15 of the FCC and Industry Canada license-exempt RSS standard(s). Operation is subject to the following two conditions:
(1) This device may not cause harmful interference, and (2) this device must accept any interference received, including interference that may cause undesired operation.

FCC NOTE: The manufacturer is not responsible for any radio or TV interference caused by unauthorized modifications to this equipment. Such modifications could void the user's authority to operate the equipment.
— Reorient or relocate the receiving antenna.
— Increase the separation between the equipment and receiver.
— Connect the equipment into an outlet on a circuit different from that to which the receiver is connected.
— Consult the dealer or an experienced radio/TV technician for help

NOTE: This equipment has been tested and found to comply with the limits for a Class B digital device, pursuant to Part 15 of the FCC Rules. These limits are designed to provide reasonable protection against harmful interference in a residential installation. This equipment generates, uses and can radiate radio frequency energy and, if not installed and used in accordance with the instructions may cause harmful interference to radio communications. However, there is no guarantee that interference will not occur in a particular installation. If this equipment does cause harmful interference to radio or television reception, which can be determined by turning the equipment off and on, the user is encouraged to try to correct the interference by one or more of the following measures:
Important note: To comply with the FCC RF exposure compliance requirements, no change to the antenna or the device is permitted. Any change to the antenna or the device could result in the device exceeding the RF exposure requirements and void user's authority to operate the device.

CAUTION - PLEASE READ!
This device is intended for installation in accordance with the National Electric Code and local regulations in the United States, or the Canadian Electrical Code and local regulations in Canada. If you are unsure or uncomfortable about performing this installation consult a qualified electrician.

WARNING - SHOCK HAZARD
TURN OFF THE POWER to the circuit for the switch and lighting fixture at the service panel (circuit breaker) prior to installation.
ALL WIRING CONNECTIONS MUST BE MADE WITH THE POWER OFF to avoid personal injury and/or damage to the switch.

OTHER WARNINGS
Risk of Fire
Risk of Electrical Shock
Risk of Burns
V1.0

WIZ Pro Software Suite



WIZ Pro Dashboard

- Grant access permission to different stakeholders
- A clear overview to monitor lights with their mapped location
- Full range of configurations and remote control
- Comprehensive reporting on device status



Wiz Pro Setup

- An interface dedicated to installers
- Extends capabilities of installation of WIZ Pro products



WIZ app

- For end users to have simple, quick control on a daily basis
- Rich features including Scenes and Rhythms

pro.wizconnected.com

