



1718 W. Fullerton Chicago, IL 60614  
 Ph: 773.770.1195 • Fax: 773.935.5613  
 www.PureEdgeLighting.com • info@PureEdgeLighting.com  
 © 2016 PureEdge Lighting. All Rights Reserved.

## Installation Instructions for Vanishing Point Tubo Small Down Light LED 24VDC

V\_-HW24-TUBSD\_-

### IMPORTANT INFORMATION

- This instruction shows a typical installation.
- This product is ceiling mount.

**SAVE THESE INSTRUCTIONS!**



### Section One: Install the Junction Box

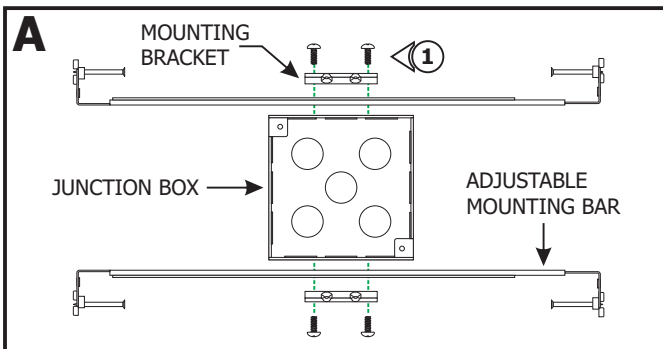

- 1:** Mount each adjustable mounting bar to one side of the junction box and secure them with the mounting brackets and two Phillips screws provided.

**NOTE:** Adjustable mounting bars mount to studs that are spaced 14.5" to 25" apart.

- 2:** Select the location between the two studs for the junction box to be mounted.
- 3:** Place the adjustable mounting bar tabs between the studs. Secure the adjustable bars to the studs with the #8 screws.
- 4:** Pinch anywhere on the inner edge of the mounting bars to lock in place.

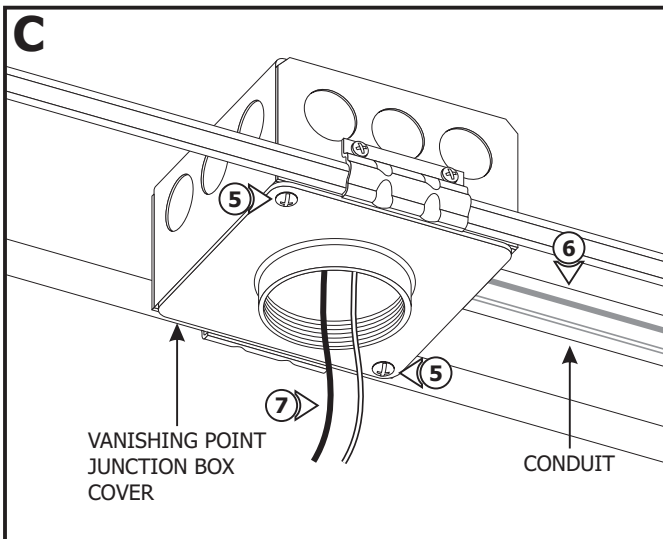
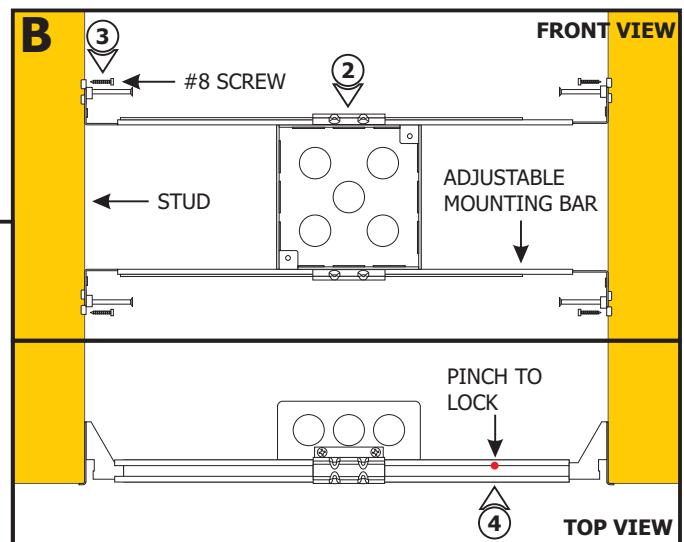

- 5:** Install the Vanishing Point junction box cover to the junction box using two #8-32 screws.
- 6:** Remove a knockout to install a conduit into the junction box. Install conduit(s) (if required by local electrical code).
- 7:** Run the line voltage wires to the junction box.
- 8:** If using remote power supply, then run the low-voltage 24V wires coming from the remote power supply to the junction box.

**NOTE:** Ensure remote power supply wires are present in the junction box. Refer to instructions provided with the power supply.

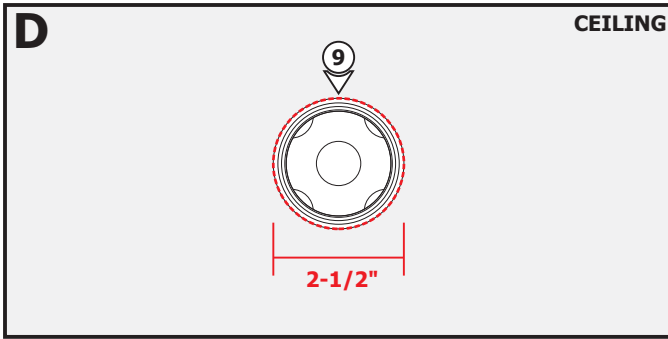

**9:** Use a 2-1/2" hole saw to cut out the drywall section where the junction box opening is located.

**10:** Install the drywall. If necessary, plaster and finish the drywall.

## Section Two: Install the Fixture

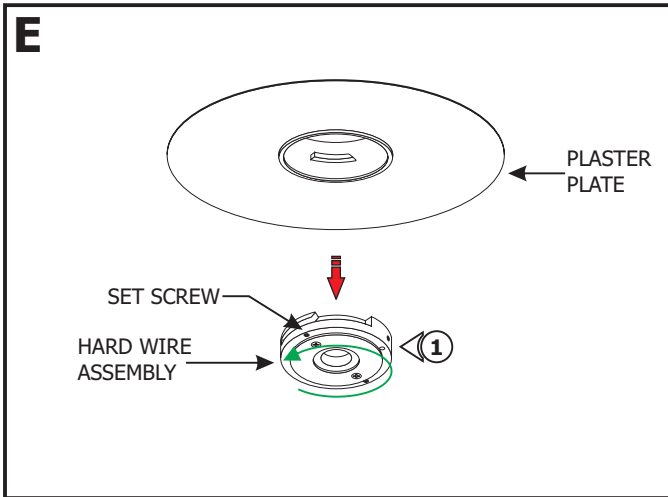

**1:** Loosen (**Do Not Remove**) the #4-40 set screws on the Hard Wire assembly using a 0.05" Allen wrench and rotate the Hard Wire assembly counter clockwise to remove from the Plaster Plate.

- 2:** Screw the plaster plate clockwise into the junction box cover, ensuring the plate is tight.
- 3:** If the drywall is 5/8" thick, tighten the bottom #4-40 set screw inside the plaster plate using a 0.05" Allen wrench.
- 4:** If the drywall is 3/4" and thicker, tighten the top #4-40 set screw inside the plaster plate using a 0.05" Allen wrench.

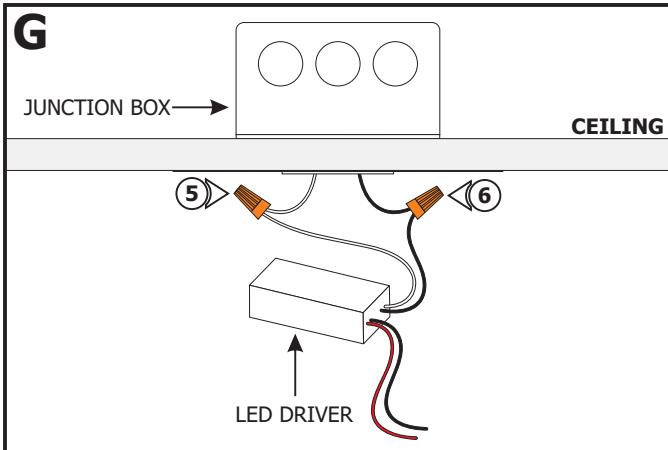
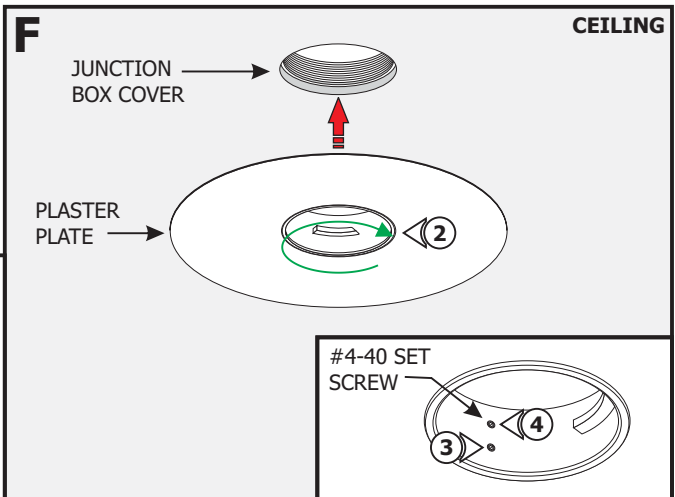

**NOTE:** Steps 5 through 7 are for the 24V power supply included inside the junction box. Omit these steps if using remote power supply.

**NOTE:** Make sure the junction box is grounded in accordance to local electrical codes.

**5:** Connect the white LED driver wire to the neutral power wire with a wire nut.

**6:** Connect the black LED driver wire to the hot power wire with a wire nut.

**7:** Place the LED driver and wire nut connections inside the junction box.

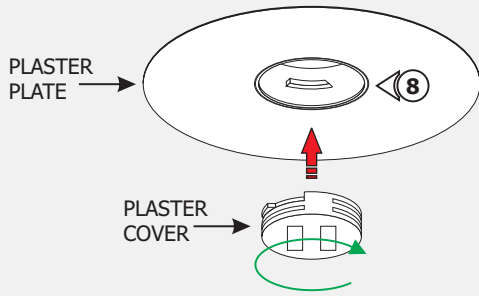
**H****CEILING****8:** Rotate the plaster cover clockwise into the plaster plate.**9:** Plaster, sand and paint the surface.

**NOTE:** For areas with lots of vibration, it is suggested to use Durabond to avoid cracking of plaster.

**NOTE:** **Do Not use premixed joint compound "Soft Mud."**  
**No use compuesto para juntas premezclado "Soft Mud."**

**NOTE:** Recommended plaster method: 1st Coat - Durabond 45 with 8" Blade, 2nd Coat - Easy Sand 45 with 10" Blade, 3rd Coat with 12" Blade

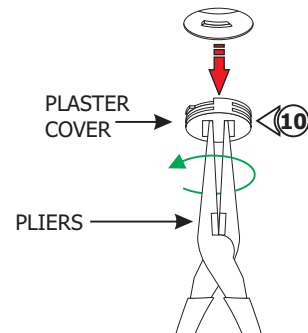
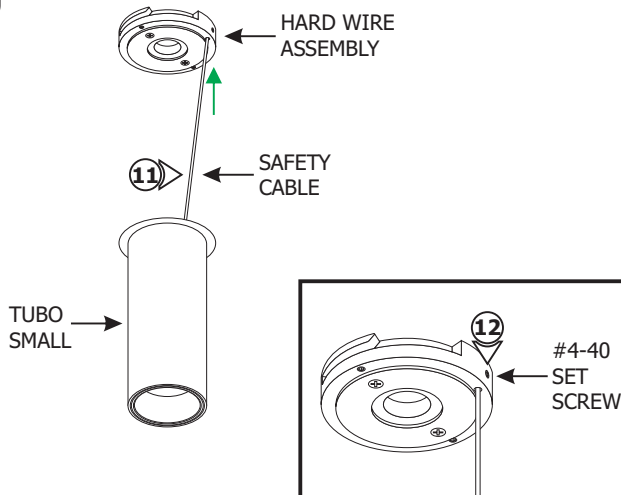
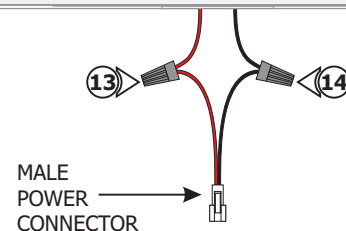
**I****10:** Use pliers to rotate the plaster cover counter clockwise and remove it. Clean the hole.**J****11:** Insert the safety cable on the Tubo Small track head into the hole on the Hard Wire assembly.**12:** Tighten the #4-40 set screw on the side of the assembly using a 0.05" Allen wrench.**13:** Connect the red wire of the male power connector to the +24VDC power supply wire using a wire nut.**14:** Connect the black wire of the male power connector to the -24VDC power supply wire using a wire nut.**K**

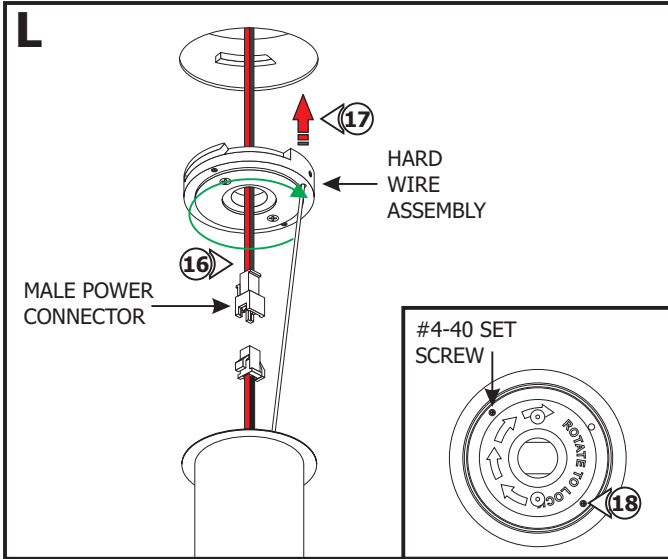

**15:** Place all wire nut connections inside the junction box.

**16:** Feed the male power connector through the Hard Wire assembly.

**17:** Insert the Hard Wire assembly into the opening and rotate clockwise to lock in place.

**18:** Tighten the #4-40 set screws using a 0.05" Allen wrench to secure in place.

**19:** Push to snap the female connector of the Tubo Small track head to the male power connector.

**20:** Place the power connectors inside the junction box.

**NOTE:** Test the fixture.

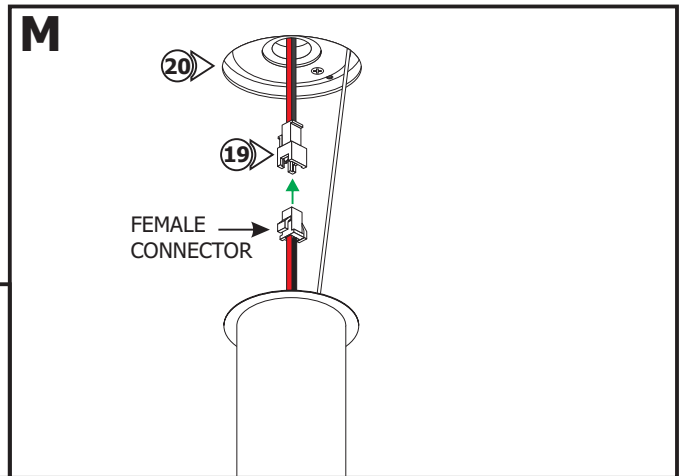

**21:** Place the Tubo Small track head over the Hard Wire assembly. The magnets on the back will keep the track head in place.

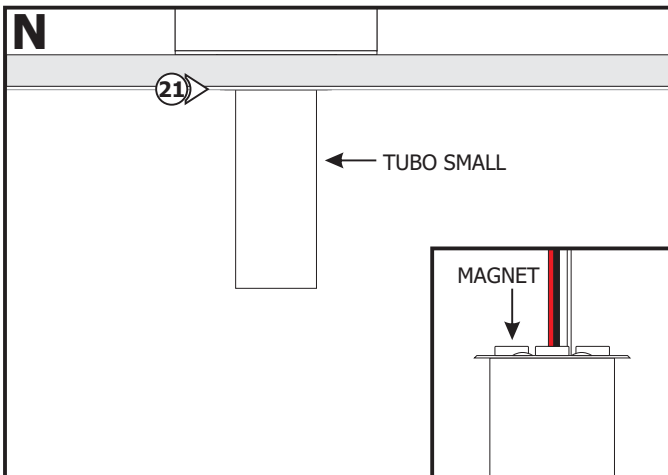

## Section Three: Replace the Lens

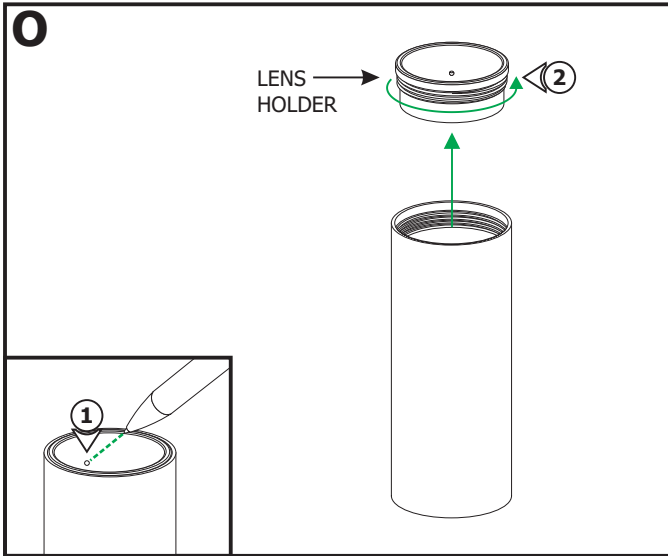

- 1: Use a pen or small Allen wrench to loosen the lens holder.
- 2: Unscrew the lens holder counter-clockwise and remove it from the fixture.

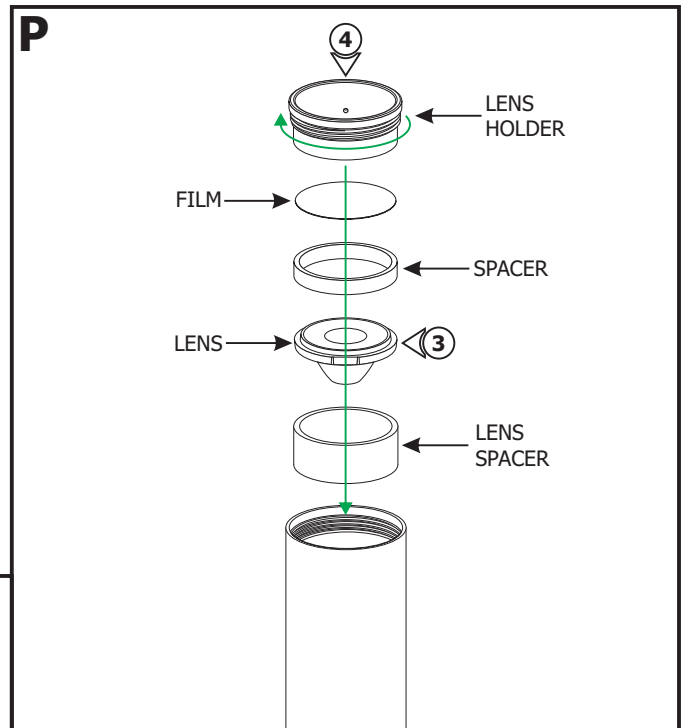

- 3: Remove the lens spacer, lens, spacer and film.
- 4: Replace the lens. Place the lens spacer and lens inside the fixture. Place the spacer and film over the lens and screw the lens holder back clockwise to secure in place.

## General Wiring for Remote Power

