



1718 W. Fullerton Chicago, IL 60614
 Ph: 773.770.1195 • Fax: 773.935.5613
 www.PureEdgeLighting.com • info@PureEdgeLighting.com
 © 2016 PureEdge Lighting. All Rights Reserved.

Installation Instructions for Vanishing Point 2" Flush Canopy for Millwork Ceilings 120 VAC Pendant Connection

V2M-C120_ _

IMPORTANT INFORMATION

- This instruction shows a typical installation.
- This product is ceiling mount.

SAVE THESE INSTRUCTIONS!

Section One: Install the Junction Box

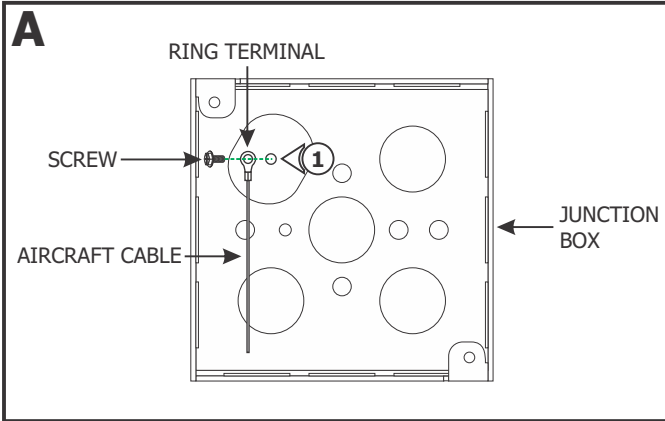

1: Attach the ring terminal with aircraft cable to the junction box using the screw provided.

2: Mount each adjustable mounting bar to one side of the junction box and secure them with the mounting brackets and two Phillips screws provided.

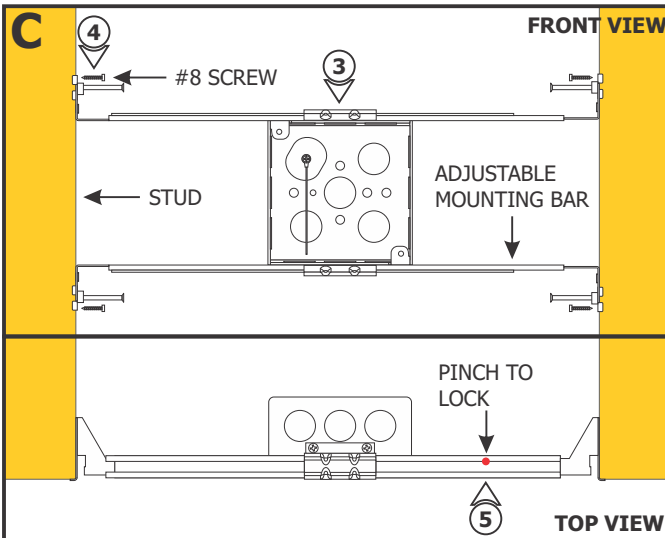
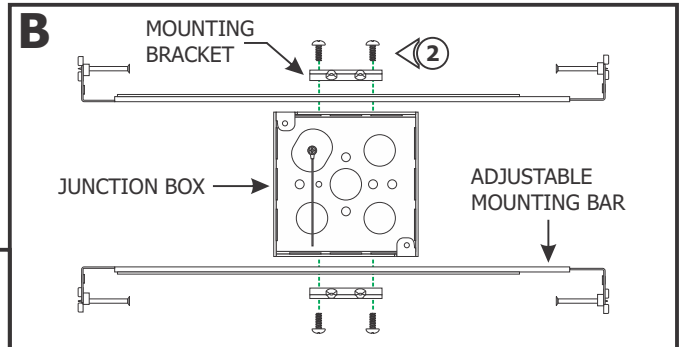

NOTE: Adjustable mounting bars mount to studs that are spaced 14.5" to 25" apart.

- 3:** Select the location between the two studs for the junction box to be mounted.
- 4:** Place the adjustable mounting bar tabs between the studs. Secure the adjustable bars to the studs with the #8 screws.
- 5:** Pinch anywhere on the inner edge of the mounting bars to lock in place.

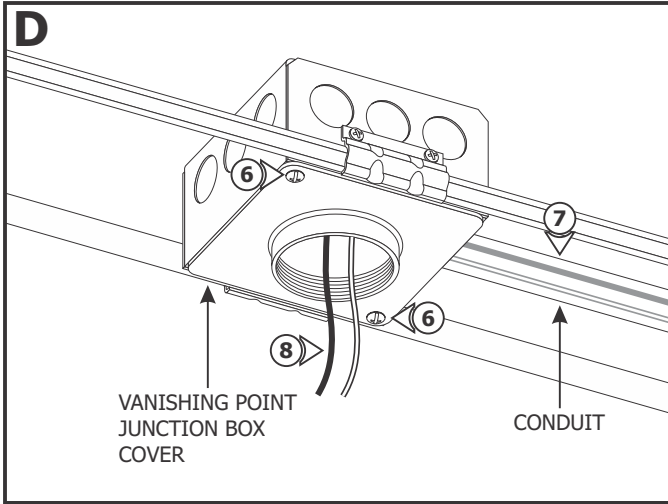

- 6:** Install the Vanishing Point junction box cover to the junction box using two #8-32 screws.
- 7:** Remove a knockout to install a conduit into the junction box. Install conduit(s) (if required by local electrical code).
- 8:** Run the 120VAC power wires to the junction box.

NOTE: Vanishing Point Millwork needs to be installed onto a minimum 5/8" to maximum 7/8" thick wood/surface. The cut out slot must be 2-1/2" in diameter.

- 9:** Use a 2-1/2" hole saw to cut out the surface where the junction box opening is located.

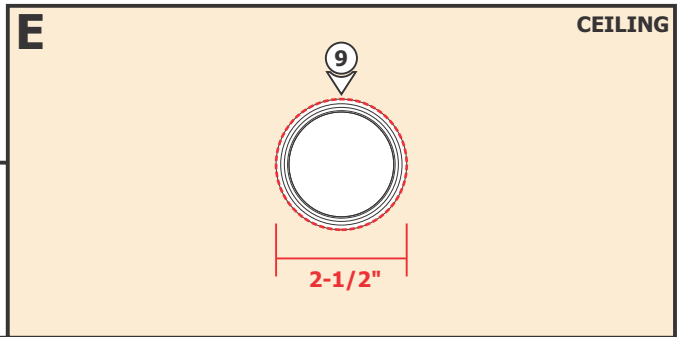

Section Two: Install the Fixture

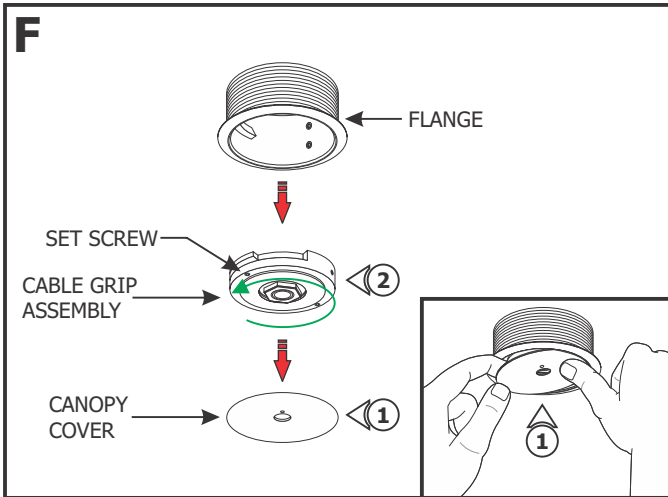

- 1:** Use fingers to push on the perimeter of the canopy cover until it slightly rocks and lift the cover to remove it from the assembly.
- 2:** Loosen (**Do Not Remove**) the #4-40 set screws on the Cable Grip Assembly using a 0.05" Allen wrench and rotate the Cable Grip Assembly counter clockwise to remove from the flange.

- 3:** Screw the flange clockwise into the junction box cover, ensuring the flange is tight.

- 4:** If the surface is 5/8" thick, tighten the bottom #4-40 set screw inside the flange using a 0.05" Allen wrench.

- 5:** If the surface is 3/4" and thicker, tighten the top #4-40 set screw inside the flange using a 0.05" Allen wrench.

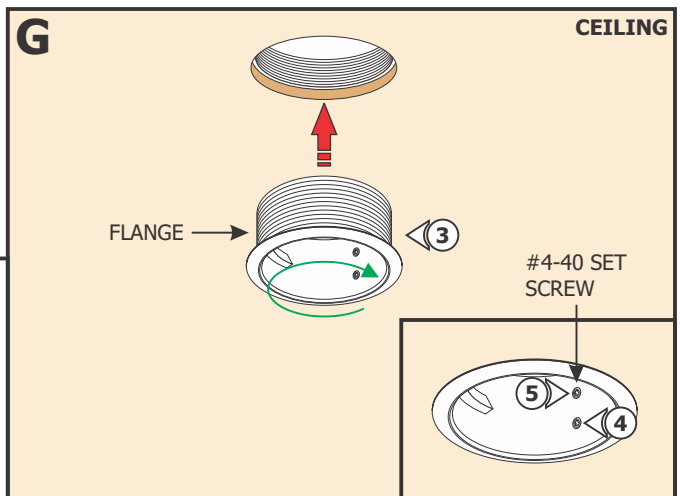

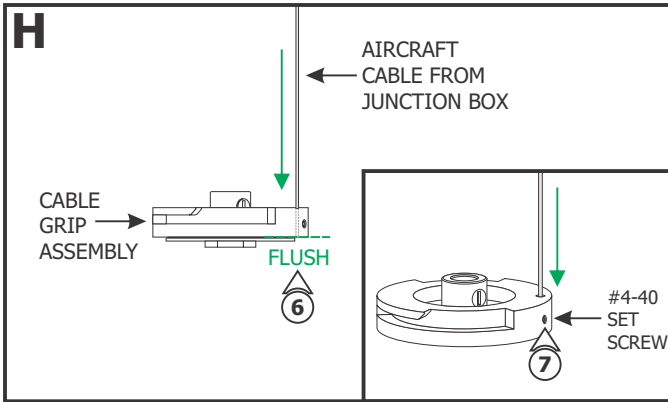

NOTE: Omit steps 6 and 7 if the fixture comes with aircraft cable.

6: Insert the end of the aircraft cable coming from the junction box into the hole on the Cable Grip Assembly, ensuring the cable is flush with the bottom.

7: Tighten the #4-40 set screw on the side of the assembly using a 0.05" Allen wrench.

NOTE: Omit steps 8 through 12 if the fixture does not come with aircraft cable.

8: Feed the aircraft cable coming from the junction box through the Inline Aircraft Holder tab.

9: Insert the end of the junction box aircraft cable into the hole on the Cable Grip Assembly, ensuring the cable is flush with the bottom, and tighten the #4-40 set screw on the side of the assembly using a 0.05" Allen wrench.

10: Feed the fixture aircraft cable through the small hole on the canopy cover and through the Cable Grip Assembly and other Inline Aircraft Holder tab.

11: Adjust the fixture height by pressing and holding the tab and sliding the cable up and down. Release the tab to lock the aircraft cable in place.

12: If necessary, trim excess aircraft cable using sharp cutters.

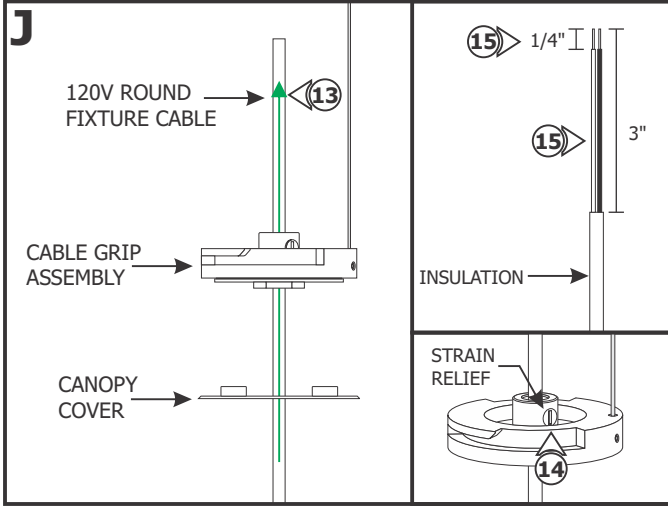
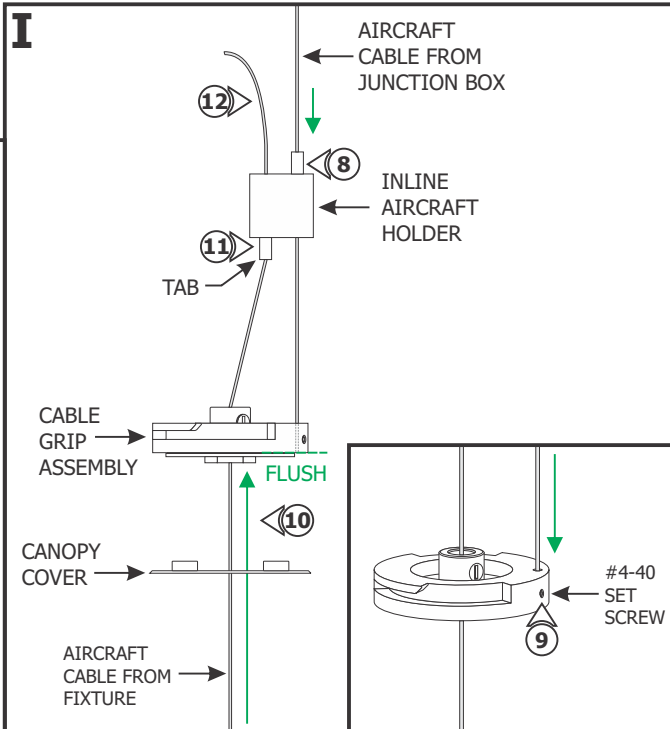

13: Feed the 120V round fixture cable (max. 1/4" thick) through the canopy cover and Cable Grip Assembly.

14: Adjust the fixture height and tighten the strain relief on the Cable Grip Assembly using a flat head screw driver.

15: Leave at least 6" of cable behind the strain relief. Strip 3" of the cable insulation with a sharp knife. Make sure not to nick the wires. Strip 1/4" of the wires.

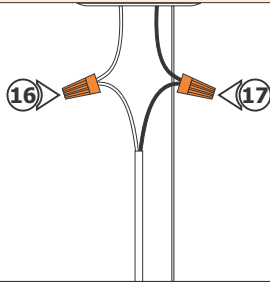
K

NOTE: Ensure the fixture is grounded in accordance with local electrical codes.

16: Connect the 120V neutral power wire to the neutral fixture wire using a wire nut.

17: Connect the 120V hot power wire to the hot fixture wire using a wire nut.

18: Place all wire nut connections, and Inline Aircraft Holder, inside the junction box.

19: Insert the Cable Grip Assembly into the opening and rotate clockwise to lock in place.

20: Tighten the #4-40 set screws using a 0.05" Allen wrench to secure in place.

NOTE: Test the fixture.

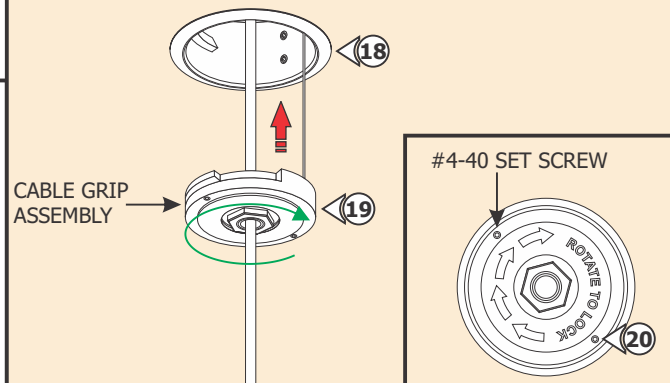
L

21: Place the canopy cover over the Cable Grip Assembly. The magnets on the back will keep the canopy cover in place.

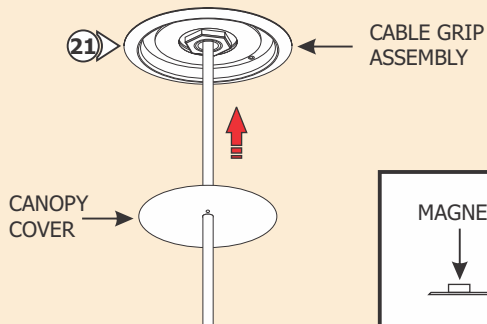
M

22: If necessary, use fingers to push on the perimeter of the canopy cover until it slightly rocks and lift the cover to remove it from the assembly.

N