



1718 W. Fullerton Chicago, IL 60614
 Ph: 773.770.1195 • Fax: 773.935.5613
 www.PureEdgeLighting.com • info@PureEdgeLighting.com
 © 2016 PureEdge Lighting. All Rights Reserved.

Installation Instructions for **Twiggy Hinged 24VDC, Tunable White**

TWH2-D1_

IMPORTANT INFORMATION

- This instruction shows a typical installation.
- This product must be installed by a qualified electrician.
- The 1RE version mounts to the provided CV2-1RE-JBOX. The 4SQ version mounts to standard electrical box with plaster ring or octagon box.
- This product requires remote 24VDC 2XK power supply (sold separately) or 24VDC 0-10V 2XK power supply (sold separately).
- **Before beginning any electrical work, ensure that the power to the installation is turned OFF!**

SAVE THESE INSTRUCTIONS!

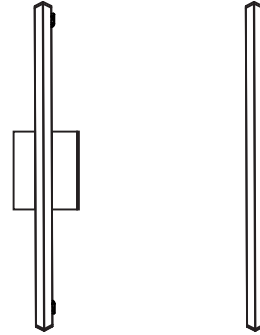

Section One: TWH2-1RE

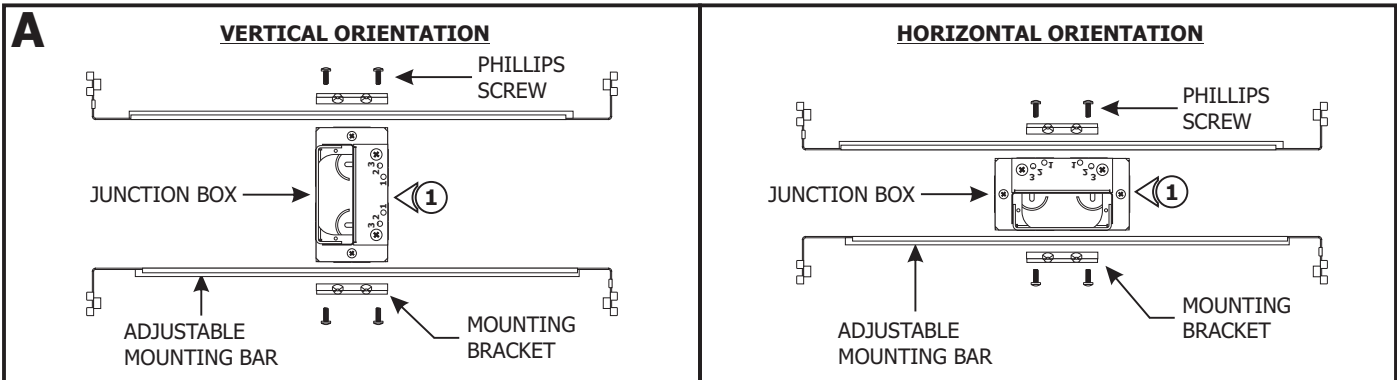

- 1:** Mount each adjustable mounting bar to one side of the junction box (mounts to any side of the housing depending on the orientation of the channel) and secure them with the mounting brackets and two Phillips screws provided.

NOTE: The adjustable mounting bars mount to studs that are spaced 14.5" to 25" apart.

NOTE: Ensure the opening of the junction box is aligned with the center of the desired fixture location. If necessary, adjust the junction box location by loosening the screws and sliding the junction box to the proper location. Tighten the Phillips screws after adjusting.

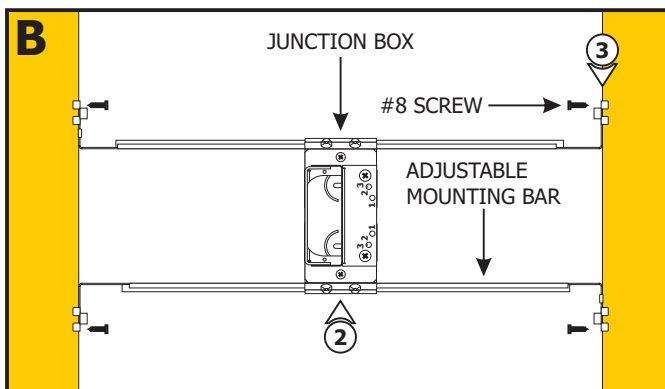

- 2:** Select the location between the two studs for the junction box to be mounted.
- 3:** Place the adjustable mounting bar tabs between the studs. Secure the adjustable bars to the studs with the #8 screws.

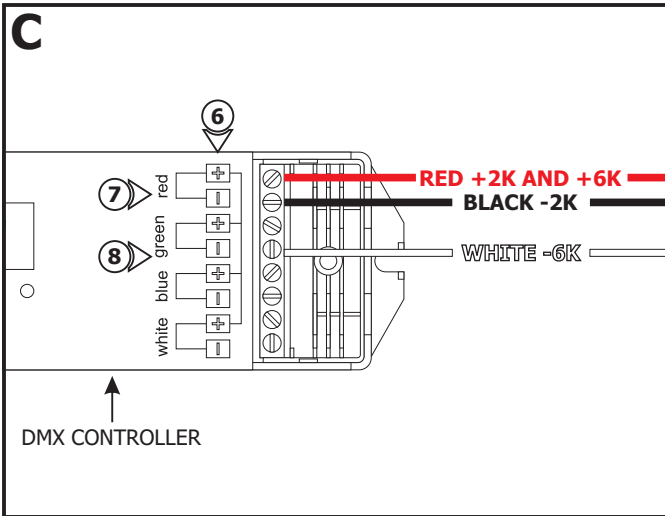

NOTE: Omit steps 4 through 8 if using two channel controls. Refer to wiring diagram on page 6.

- 4: Use the "Low Voltage Wire Size Chart" below to determine proper wire size connecting to the DMX controller terminals.
- 5: Run the proper size black, red, and white wires from the fixture to the power supply enclosure.
- 6: Connect the red fixture wire to the red "+" DMX terminal and tighten the screw.
- 7: Connect the black fixture wire to the red "-" DMX terminal and tighten the screw.
- 8: Connect the white fixture wire to the green "-" DMX terminal and tighten the screw.

100W, 24VAC LOW VOLTAGE WIRE SIZE CHART					
3% VOLTAGE DROP	WIRE LENGTH IN FT	UP TO 31FT	32FT-49FT	50FT-81FT	82FT-124FT
	WIRE SIZE	14 AWG	12 AWG	10 AWG	8 AWG
	VOLTAGE AT END OF THE WIRE	23.28 VAC	23.29 VAC	23.28 VAC	23.28 VAC

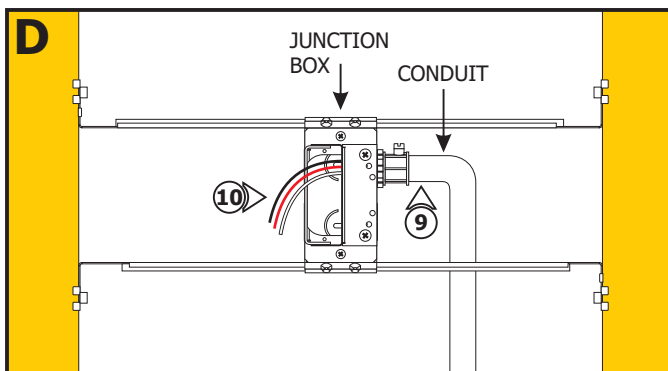

- 9: Remove a knockout to install a conduit into the junction box. Install conduit(s) (if required by local electrical code).
- 10: Run the wires coming from the DMX controller or dimming module to the junction box. Refer to the instructions provided with the power supply.

11: Mark a rectangle shape on the drywall where the junction box opening will be located depending on selected position.

12: Cut out the marked rectangle opening, using a "Dremel Multi-Max" with the "wood & drywall" cutting bit.

13: Install & finish drywall.

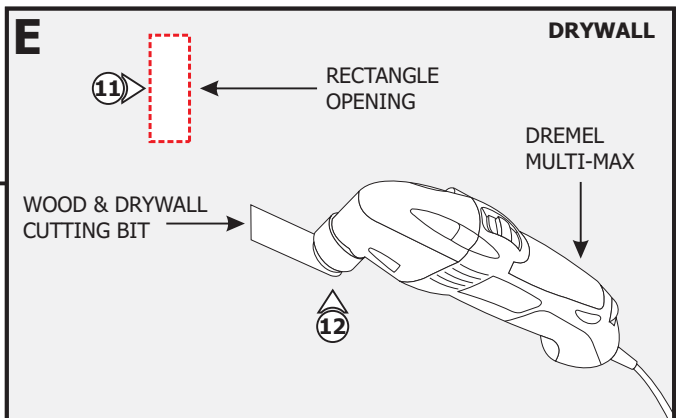

Section Two: TWH2-4SQ

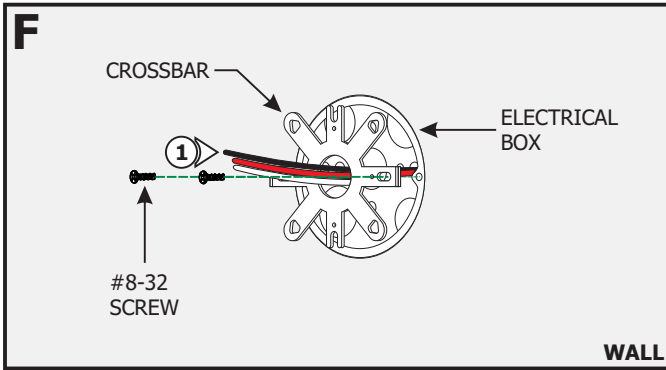

1: Feed the wires coming from the dimming module or the DMX controller (refer to Drawing C and steps 4 through 8 on page 2), through the crossbar hole and mount the crossbar to the electrical box with two #8-32 screws provided.

2: Complete installation by following steps in Section Three.

Section Three: Install Fixture for Both Versions

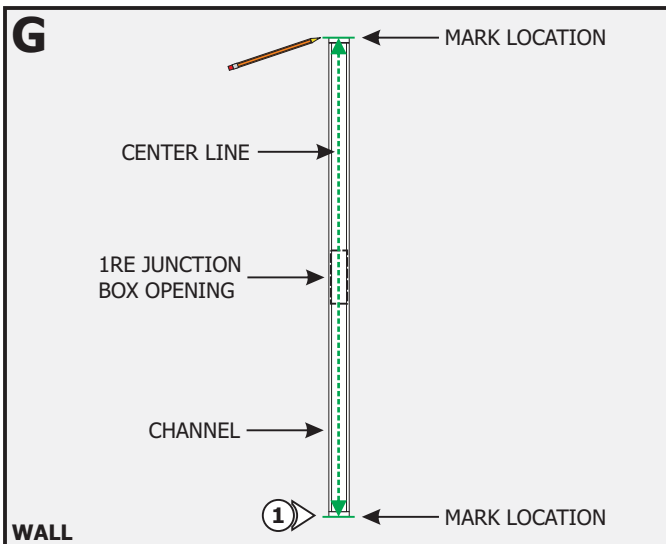

NOTE: TWH2-1RE is shown for demonstration purposes.

NOTE: It is recommended more than one person to assist in this installation.

NOTE: Fixture can be mounted in a horizontal or vertical position.

NOTE: Channel rotates in only one direction, so orientation must be determined before installing.

NOTE: The junction box does not need to be in middle of the channel (could be mounted from any end) but needs to be aligned in the center of the channel.

1: Center the channel to the junction box opening. Mark each end of the channel and a center line from end to end.

WALL

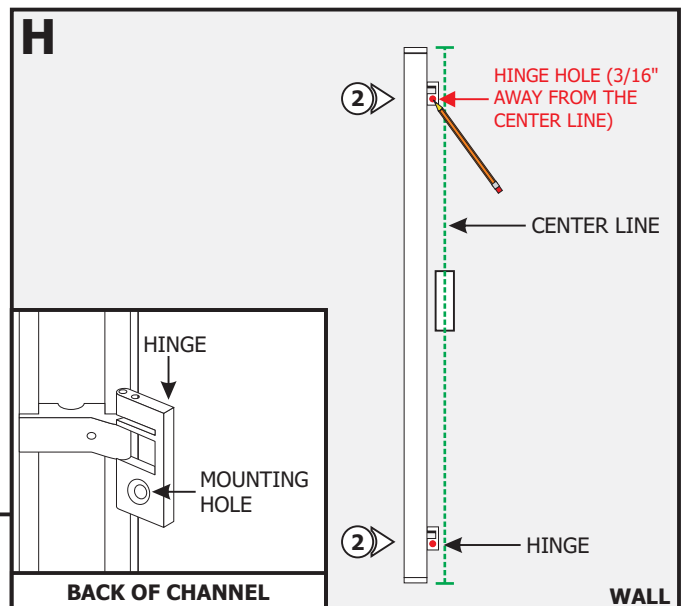

2: Unfold the hinges. Align the channel between the marked lines and mark the hinge holes 3/16" away from the center line.

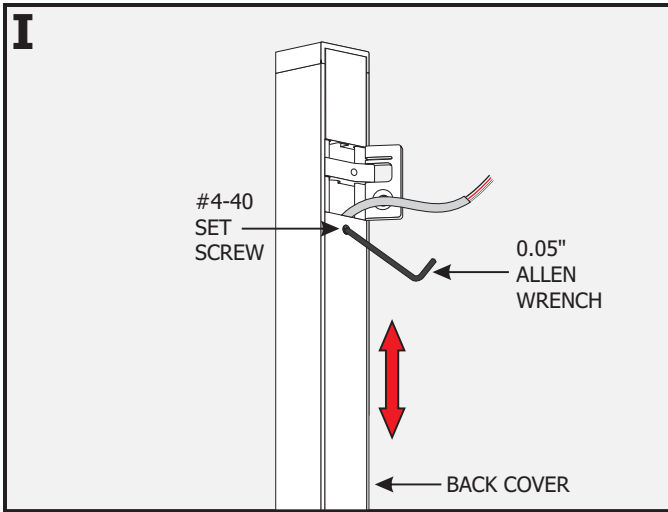

NOTE: If junction box is located at one end of the channel, then loosen the #4-40 set screw with the 0.05" Allen wrench on one of the back covers moving the opening hole to one end. Pull the wires out of that end & retighten the #4-40 set screw.

NOTE: Steps 3 and 4 are for drywall mounting. Omit these steps if mounting the hinges to a wood surface directly.

3: Tap the anchors onto the marked points up to the threaded portion with a hammer.

4: Screw in the threaded portion of the anchors with a Phillips screwdriver.

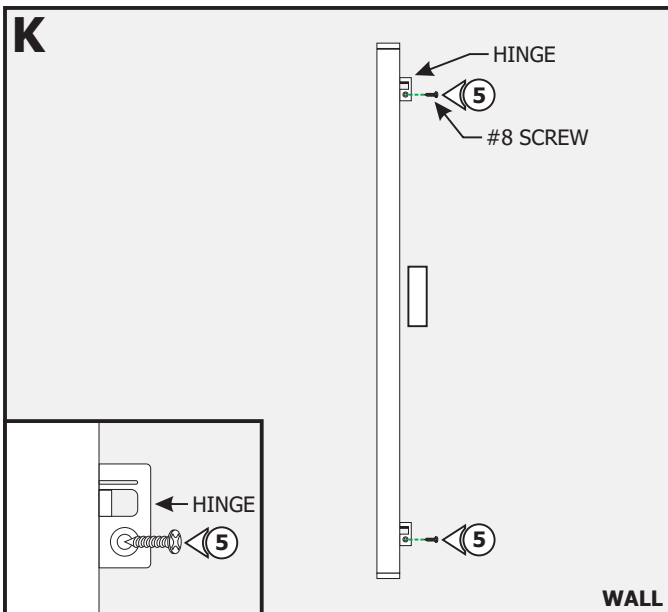
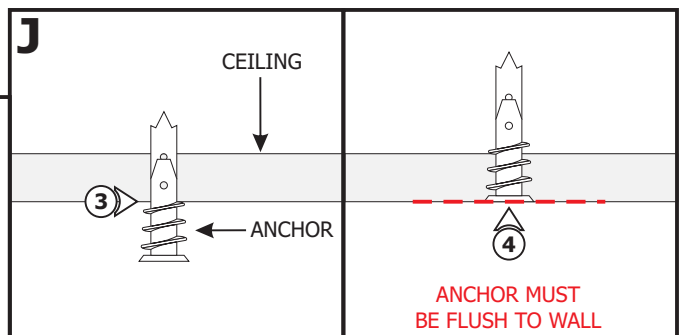

5: Line up the hinge to the anchors and secure it by tightening the #8 screws to each hinge.

6: Feed the cable through the center hole of the junction box cover and strip the wires.

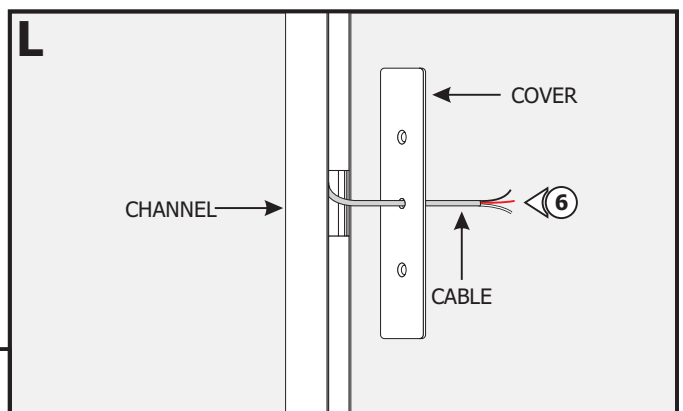

M

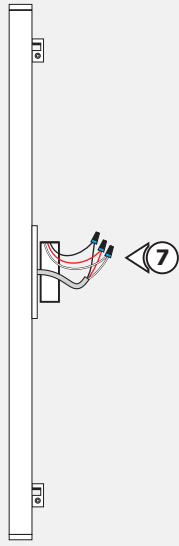

WALL

7: Refer to the wiring diagrams on page 6 to connect the wires properly.

N

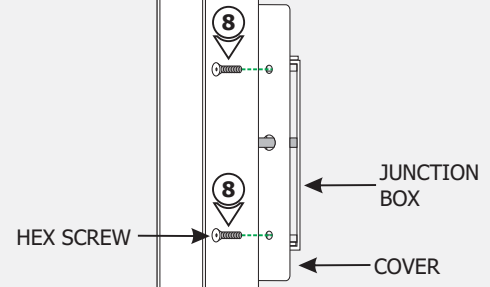

WALL

8: Attach the junction box cover to the junction box with the provided hex screws.

O

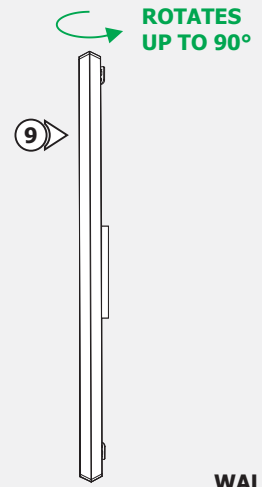

WALL

9: If necessary, rotate the channel up to 90° and tighten the M2 set screws to each hinge with an Allen wrench to secure in place.

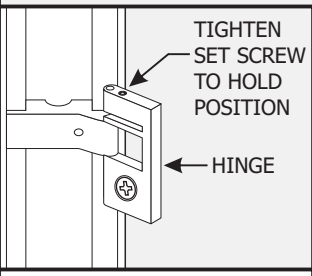

BACK OF CHANNEL

P

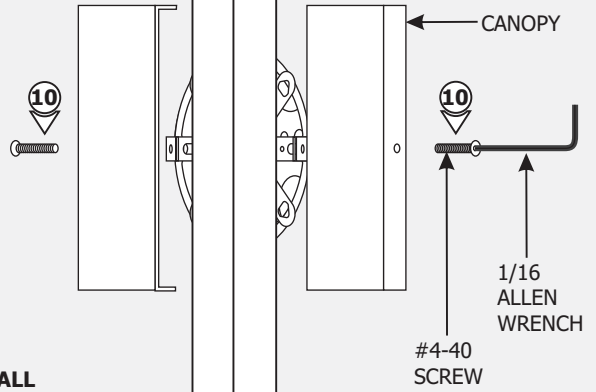

WALL

10 (OPTIONAL): For 4" Square Canopy installations, place each canopy piece against the crossbar and secure it to the electrical box holes with the provided #4-40 screws using the 1/16 Allen wrench.

General Wiring Diagram

Using LED Power Supply with CDP, CTP, or CDMX Control

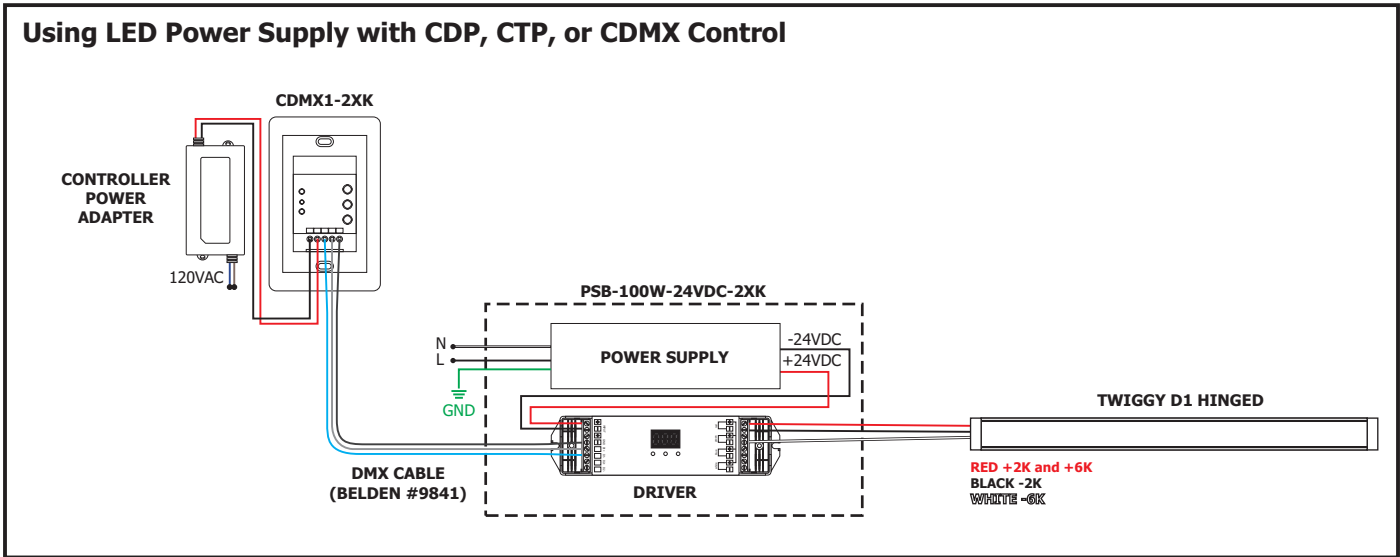

Tunable White: LED Power Supply with two Channel Controls, for Intensity and Color Temperature

