



1718 W. Fullerton Chicago, IL 60614
 Ph: 773.770.1195 • Fax: 773.935.5613
 www.PureEdgeLighting.com • info@PureEdgeLighting.com
 © 2016 PureEdge Lighting. All Rights Reserved.

Installation Instructions for Monorail 24", 48" and 96"



IMPORTANT INFORMATION

- This product is ETL listed for indoor dry locations.
- Monorail is bendable horizontally to a radius as small as 6" and vertically to a radius as small as 24".
- The product is intended to be used with PureEdge Lighting Monorail systems only.

SAVE THESE INSTRUCTIONS!



Techniques to Bend the Monorail

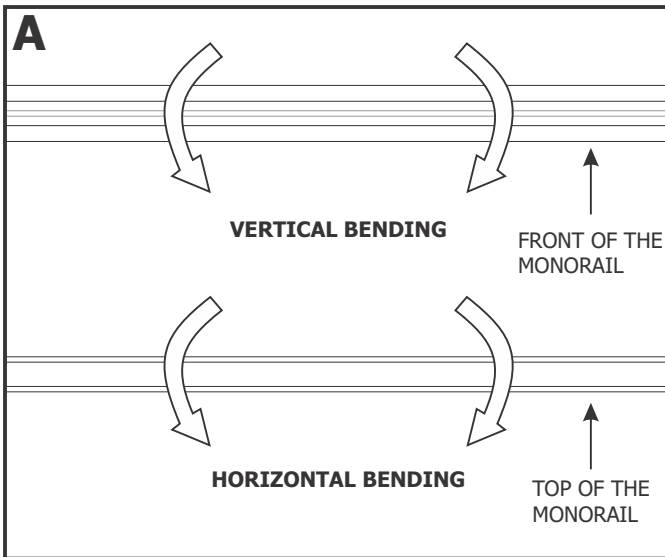

NOTE: There are three techniques to bend the monorail horizontally which are Plywood Template, Free Style, and Wiremold pipe bender. Monorail can only be bent vertically by a Wiremold pipe bender. When bending vertically, bend the Monorail in short increments and avoid bending it back which may cause the rails to separate from the insulator.

Horizontal Bending Using a Plywood Template

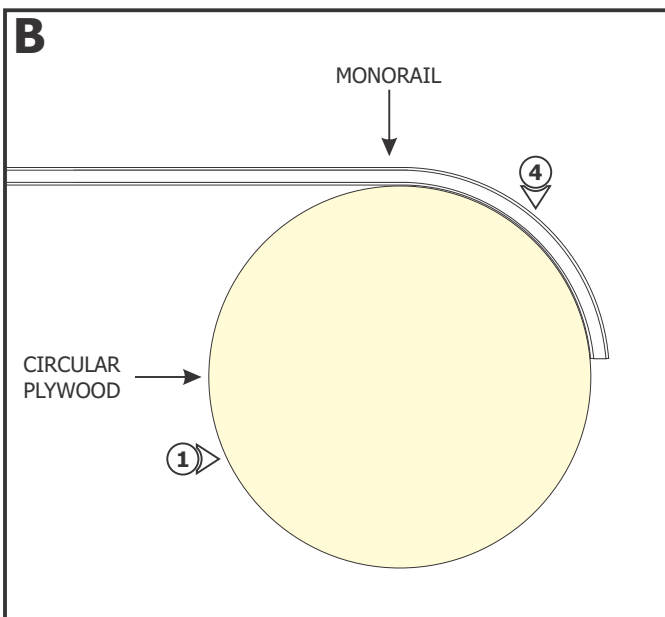

- 1:** Determine the radius of the curve or circle.
- 2:** Draw the curve on plywood and cut out the pattern from the plywood.
- 3:** Secure the plywood in place.
- 4:** Hold one edge of the Monorail against the plywood. Start bending the Monorail against the plywood until the desired curve or circle is achieved.

Free Style Horizontal Bending

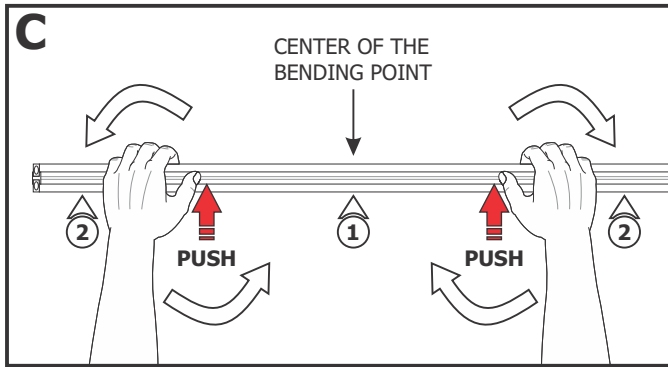

1: Locate the center of the bending point on a Monorail section. The bending point should be centered between hands.

2: For a smooth curve, bend the Monorail with hands as far apart as possible. Move hands close together as bending progresses and the desired shape is achieved.

Wiremold Pipe Bender (Horizontal or Vertical Bend)

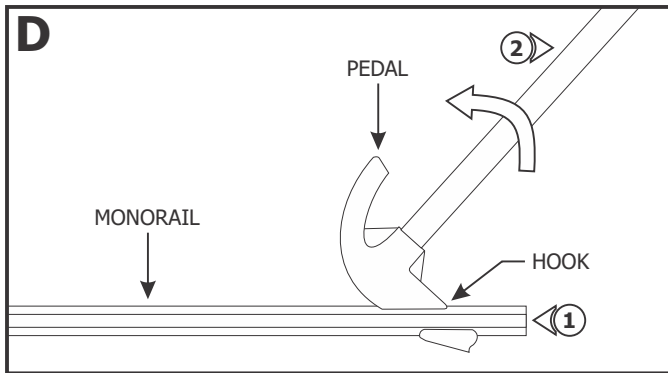

NOTE: The Wiremold pipe bender can be used to create smooth horizontal curve of 90° or less. Do not step on the pedal of the pipe bender which will flatten and damage the Monorail. For offsets, refer to the instructions provided with the pipe bender.

1: Feed the Monorail through the pipe bender hook.

2: Start bending the Monorail with small angles (less than 10°) by gently pulling back on the pipe bender handle.

3: After each bend unhook and check the Monorail against the pattern.

Joining Monorail Sections with Straight Conductive Connectors

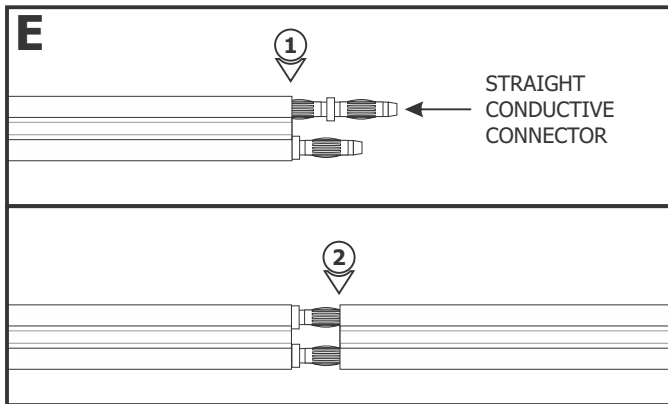

1: Push the straight conductive connectors completely into the end of one Monorail section.

2: Push the other Monorail section entirely onto the straight conductive connectors.

Joining Monorail Sections with Straight Isolating Connectors

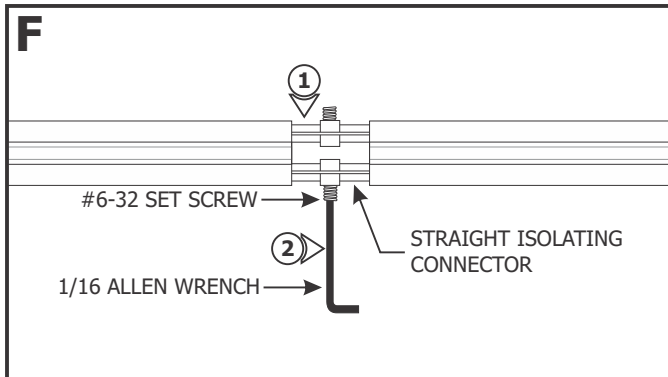

1: Push the straight isolating connectors completely into one Monorail section end and push the other Monorail section entirely onto the straight isolating connectors.

2: Tighten the #6-32 set screws on each of the isolating connector firmly with the 1/16 Allen wrench. **Do not over tighten the set screws as this may strip the threads.**