



1718 W. Fullerton Chicago, IL 60614
 Ph: 773.770.1195 • Fax: 773.935.5613
 www.PureEdgeLighting.com • info@PureEdgeLighting.com
 © 2016 PureEdge Lighting. All Rights Reserved.

Installation Instructions for Cirrus MIYO Rectangle LED Suspension with Remote Power - End Feed

CSD_-RE-E_

IMPORTANT INFORMATION

- This product is suitable for indoor locations.
- This instruction shows a typical installation.
- It is recommended more than one person to assist in this installation.

SAVE THESE INSTRUCTIONS!

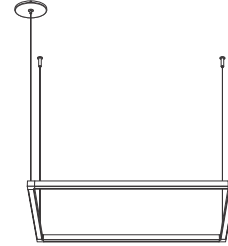

Section One: Install the Canopy

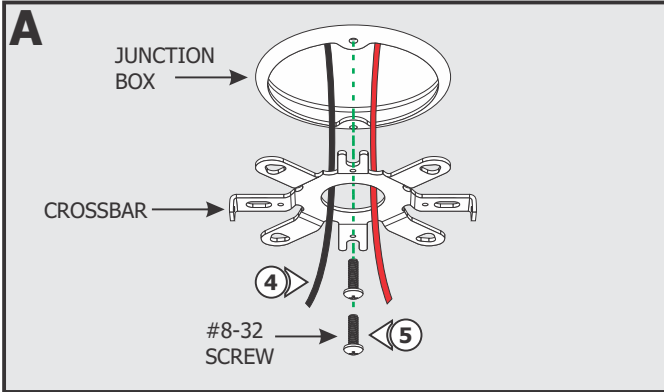

- 1: Feed the low voltage wires from the power supply through the center hole of the crossbar.
- 2: Mount the crossbar to the junction box holes with two #8-32 screws.

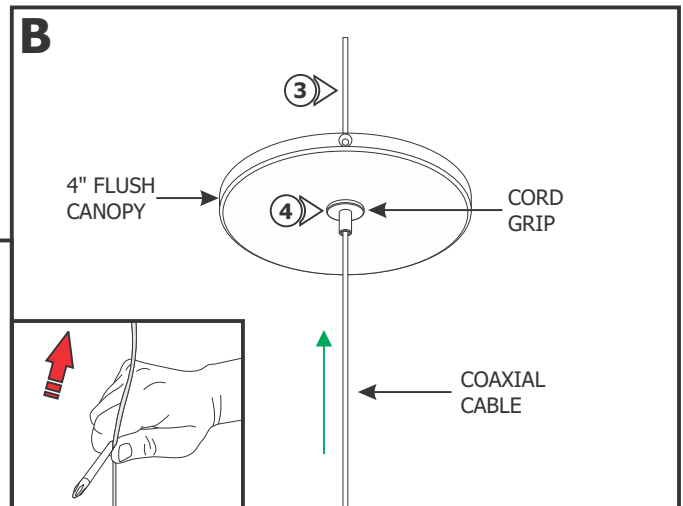

- 3: Push the coaxial cable through the cord grip on the canopy.
- 4: Adjust the fixture height by pushing the cord grip to slide the fixture up and down. Release the cord grip to lock the coaxial cable in place.

NOTE: If cable is curled or kinked, straighten by holding between the shaft of a screwdriver and thumb and pulling the cable through (see inset).

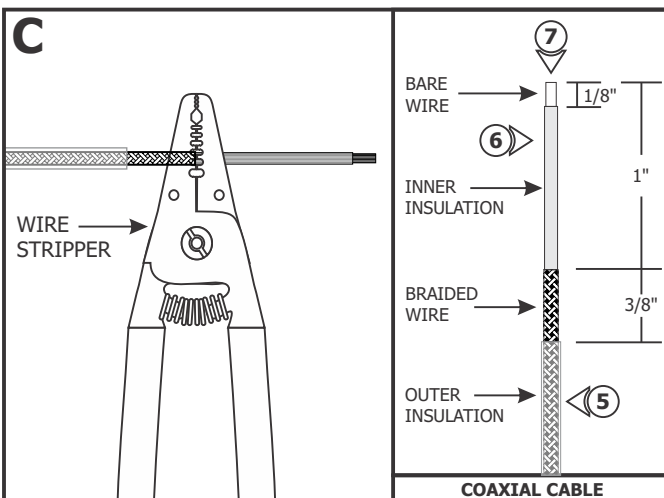

NOTE: Scan the QR Code to watch the video clip of the following steps or visit https://www.PureEdgeLighting.com/video_feed/installation_cxc_connector

- 5: Use the 18AWG hole of the wire stripper to remove 1-3/8" of the outer insulation to expose the braided wire.
- 6: Use the 18AWG hole of the wire stripper to remove 1" of the braided wire making sure not to nick the inner wire insulation.
- 7: Use the 20AWG hole of the wire stripper to remove 1/8" of the inner insulated wire.

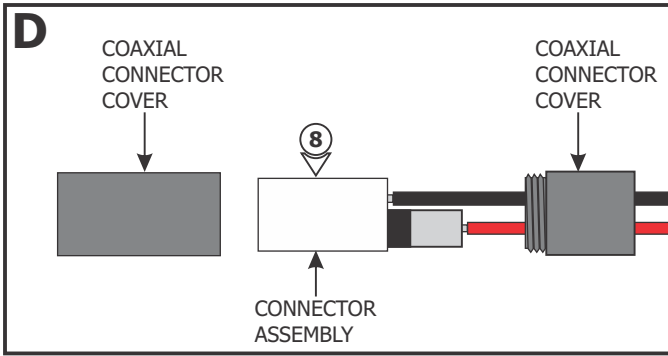

8: Unscrew the coaxial connector covers and remove from the connector assembly.

9: Using the provided 1.5mm Allen wrench, remove the M3 set screw from the coaxial connector assembly.

10: Using the provided 2mm Allen wrench to loosen (do not remove) the M4 set screw.

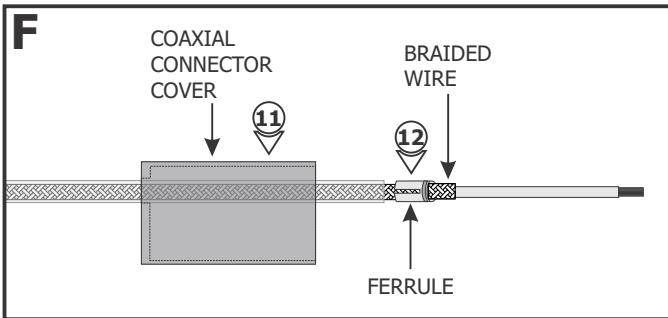
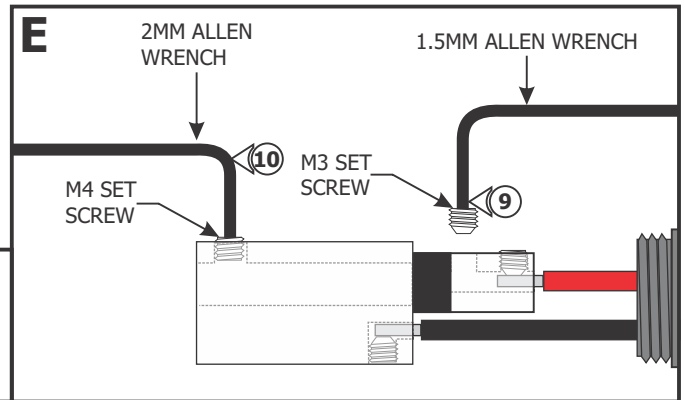

11: Slide the connector cover over the coaxial cable.

12: Place the ferrule over the 3/8" braided wire of the coaxial cable.

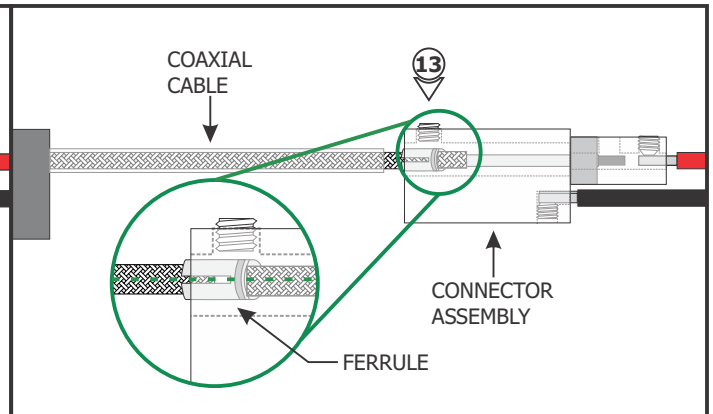
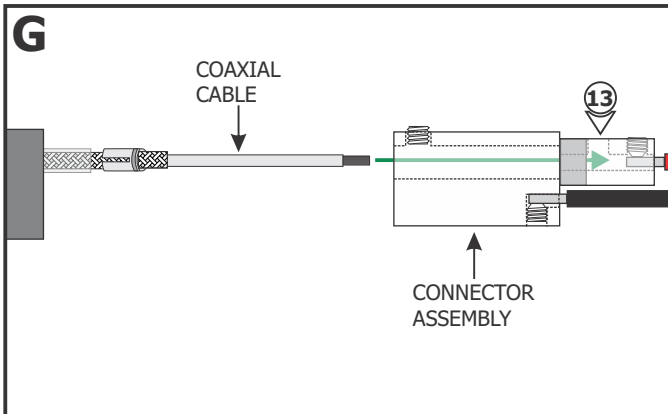

13: Insert the coaxial cable into the coaxial connector until the wires of the center conductor are visible through the M3 set screw hole.

NOTE: Ensure that the split in the ferrule is aligned 90° from the M4 set screw (see inset).

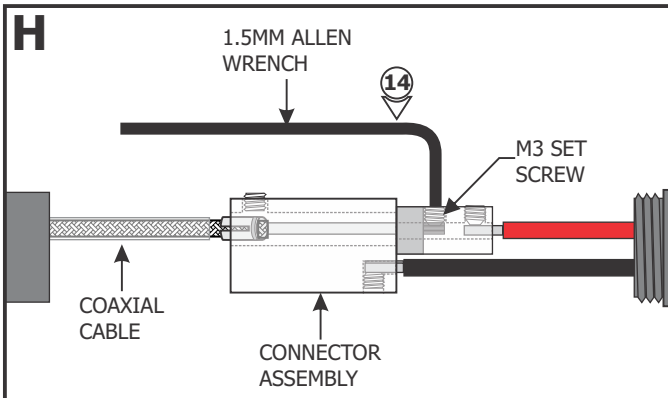

14: Use the provided 1.5mm Allen wrench to replace and securely tighten the M3 set screw.

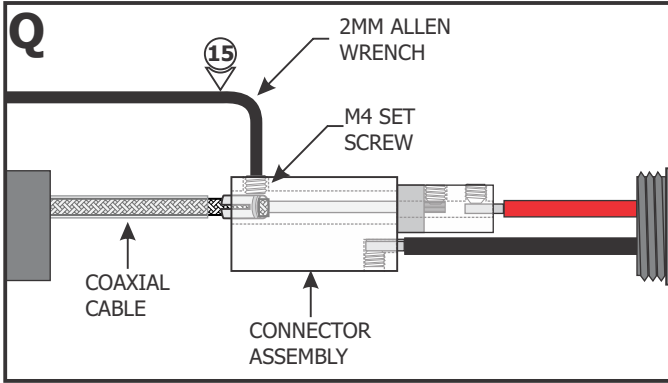

15: Use the provided 2mm Allen wrench to securely tighten the M4 set screw until it squeezes the wire ferrule tightly to the coaxial cable.

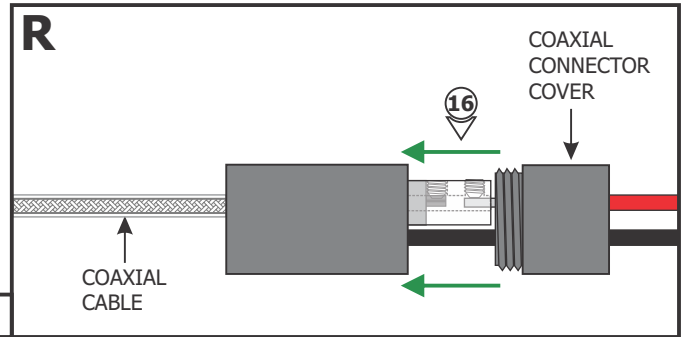

16: Replace the coaxial connector cover and tighten into place.

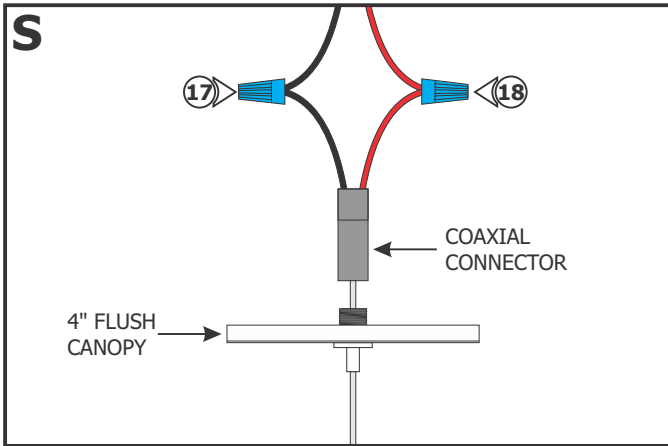

17: Connect the black wire of the coaxial connector to the -24VDC power supply wire with a wire nut.

18: Connect the red wire of the coaxial connector to the +24VDC power supply wire with a wire nut.

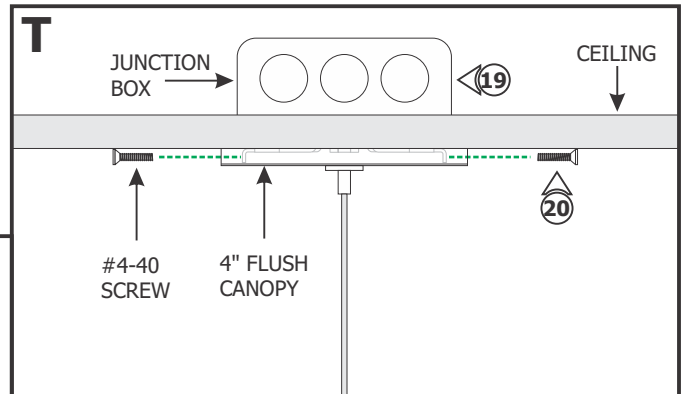

19: Place all wires and wire nut connections inside the junction box.

20: Align the 4" canopy with the crossbar and secure it with the two #4-40 screws using a 1/16" Allen wrench.

Section Three: Install the Standoff

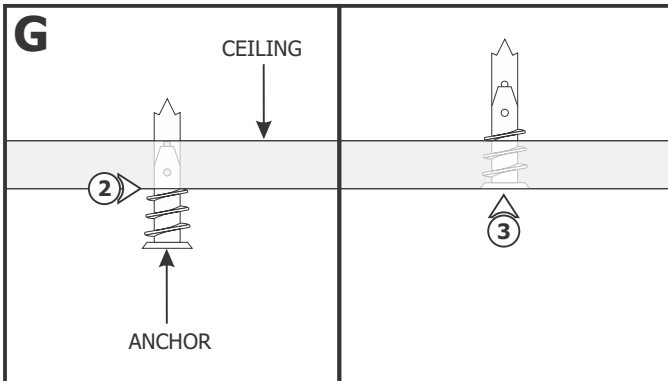

1: Determine the location of the fixture. Lift the end of each aircraft cable against the ceiling to mark the locations of the standoffs.

2: For each provided standoff, tap the anchor onto the marked location up to the threaded portion with a hammer.

3: Screw in the threaded portion of the anchors with a Phillips screwdriver.

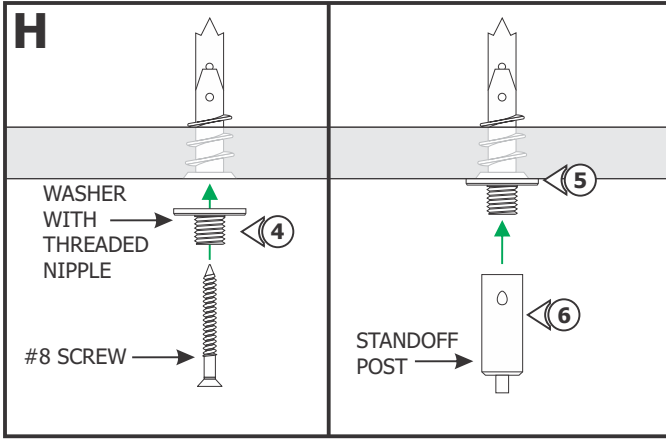

- 4:** Feed the #8 screw through the washer with threaded nipple into the anchor.
- 5:** Tighten the #8 screw completely into the anchor.
- 6:** Tighten the standoff post completely onto the threaded nipple.

- 7:** Feed the aircraft cable coming from the fixture through the standoff post.
- 8:** Adjust the fixture height by pushing the cord grip and pulling the aircraft cable out of the side of the standoff post. Release the cord grip to secure the cable in place.
- 9:** If necessary, trim excess aircraft cable using sharp cutters.
- 10:** Repeat steps 1 through 9 for the remaining standoffs.

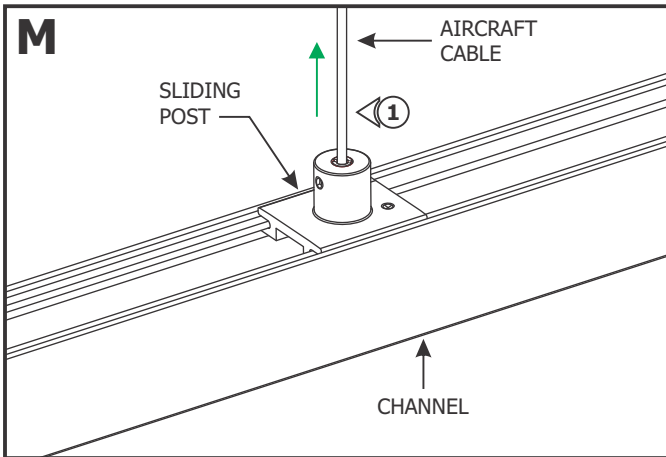
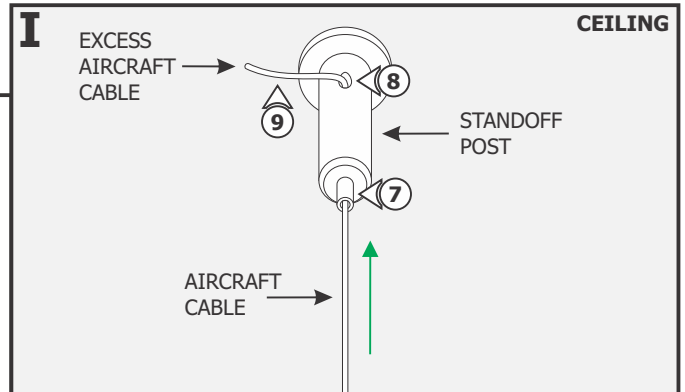

NOTE: Support cables are provided in the middle of the channels if the sides of the fixture are 72" and longer.

Additional Support

- 11:** Lift the end of the aircraft cable coming from the sliding post against the ceiling to mark the location of the standoff.
- 12:** Refer to steps 1 through 9 to install the standoffs.

General Wiring Diagram

