



1718 W. Fullerton Chicago, IL 60614
 Ph: 773.770.1195 • Fax: 773.935.5613
 www.PureEdgeLighting.com • info@PureEdgeLighting.com
 © 2016 PureEdge Lighting. All Rights Reserved.

Installation Instructions for Cirrus MIYO Rectangle LED Suspension with Remote Power - Center Feed

CSD_-RE-C_

IMPORTANT INFORMATION

- This product is suitable for indoor locations.
- This instruction shows a typical installation.

SAVE THESE INSTRUCTIONS!

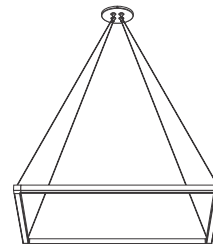

Section One: Install the Fixture

A

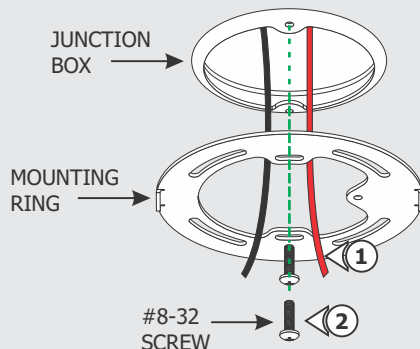

NOTE: Before beginning any electrical work, ensure that power to the junction box is turned off.

NOTE: Ensure remote power supply wires are present in the junction box. Refer to the instructions provided with the power supply.

- 1: Feed the low voltage wires from the remote power supply through the center hole of the mounting ring.
- 2: Mount the ring to the junction box holes with two #8-32 screws.

- 3: Determine the fixture height from the bottom of the channel to the top of the canopy.

- 4: Push each wire through the cord grips on the canopy.

- 5: Adjust the fixture height by pushing the cord grip to slide the fixture up and down. Release the cord grip to lock the wire in place.

NOTE: If wire is curled or kinked, straighten by holding between the shaft of a screwdriver and thumb and pulling the wire through (see inset).

- 6: Identify the two power wires which are marked with "POWER" labels.

NOTE: The wires with "SUPPORT" labels are the support wires. **DO NOT** strip and power the support wires.

B

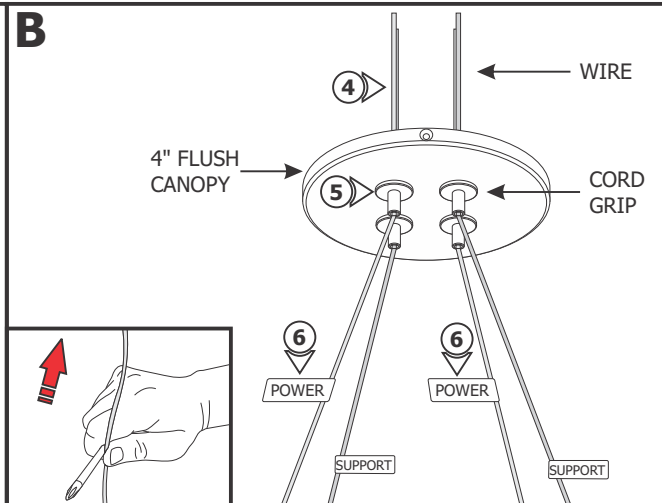

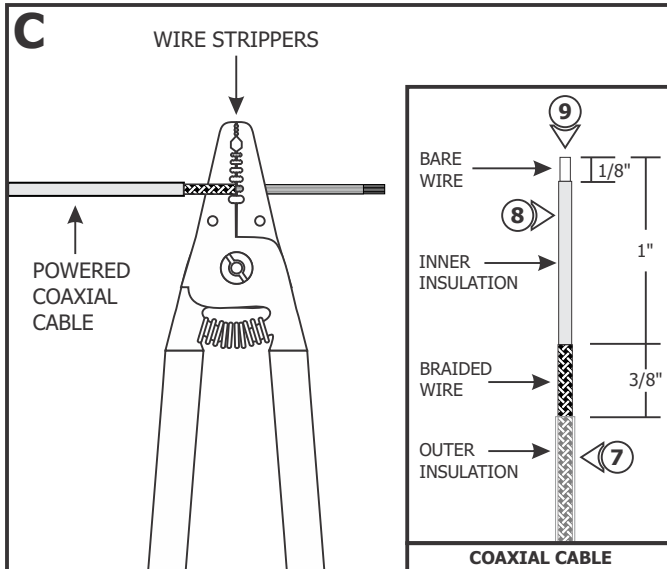

NOTE: Scan the QR Code to watch the video clip of the following steps or visit https://www.PureEdgeLighting.com/video_feed/installation_cxc_connector

7: Use the 18AWG hole of the wire stripper to remove 1-3/8" of the outer insulation to expose the braided wire of the powered cable only.

8: Use the 18AWG hole of the wire stripper to remove 1" of the braided wire making sure not to nick the inner wire insulation of the powered cable only.

9: Use the 20AWG hole of the wire stripper to move 1/8" of the inner insulated wire of the powered cable.

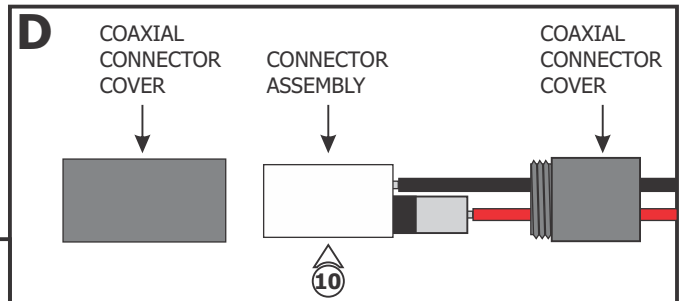

10: Unscrew the coaxial connector covers and remove from the connector assembly.

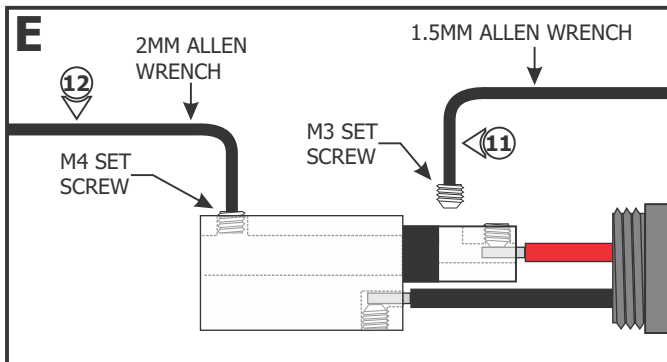

11: Using the provided 1.5mm Allen Wrench, remove the M3 set screw from the coaxial connector assembly.

12: Using the provided 2mm Allen wrench to loosen (do not remove) the M4 set screw.

13: Slide the connector cover over the coaxial cable.

14: Place the ferrule over the 3/8" braided wire of the coaxial cable.

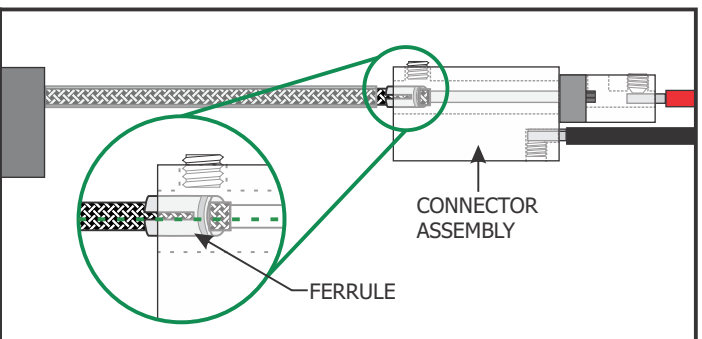
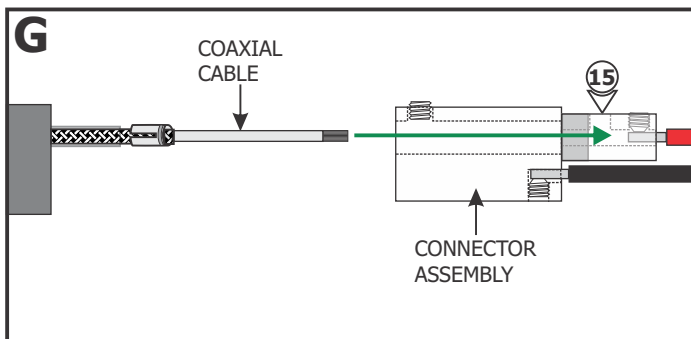
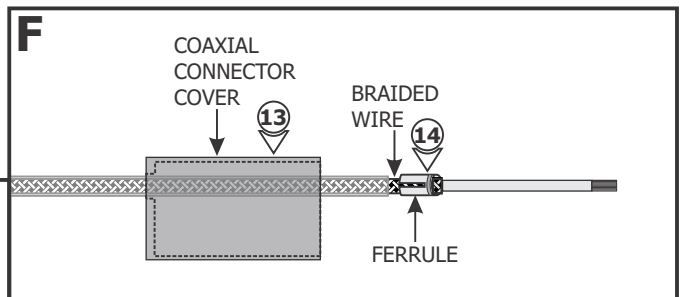

15: Insert the coaxial cable into the coaxial connector until the wires of the center conductor are visible through the M3 set screw hole.

NOTE: Ensure that the split in the ferrule is aligned 90° from the M4 set screw (see inset).

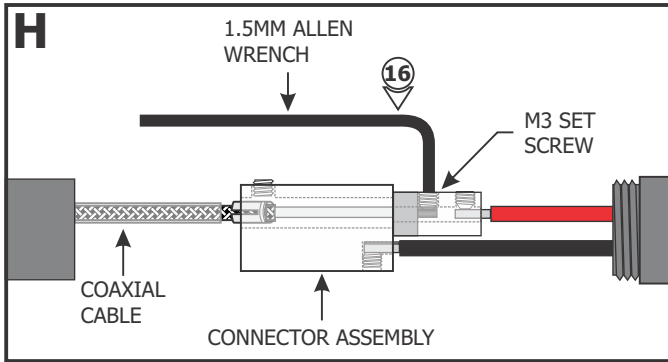

16: Use the provided 1.5mm Allen wrench to replace and securely tighten the M3 set screw.

17: Use the provided 2mm Allen wrench to securely tighten the M4 set screw until it squeezes the wire ferrule tightly to the coaxial cable.

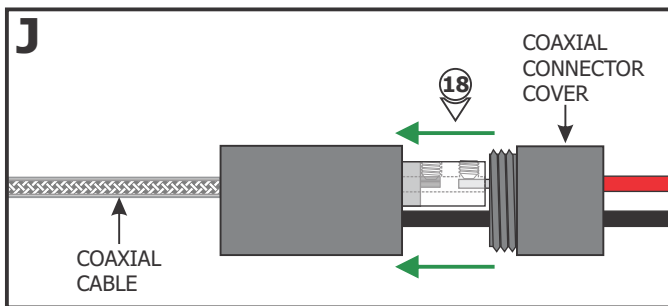
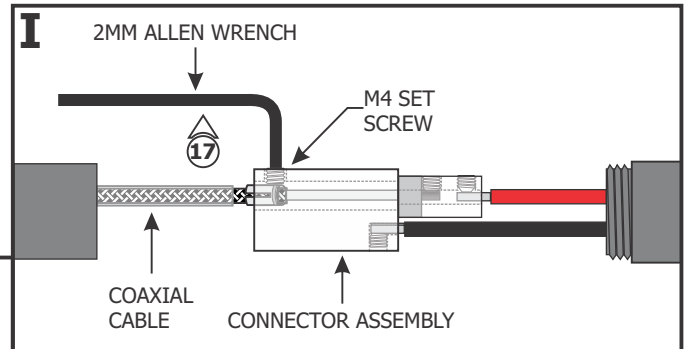

18: Replace the coaxial connector cover and tighten into place.

19: Repeat steps 7 through 18 for the other powered cable.

- 20:** Connect the red wire of the coaxial cable to the +24VDC power supply wire with a wire nut.
- 21:** Connect the black wire of the coaxial cable to the -24VDC power supply wire with a wire nut.
- 22:** Repeat steps 20 and 21 to connect the other powered cable to the other power supply.

CAUTION: Test the fixture before removing the labels.

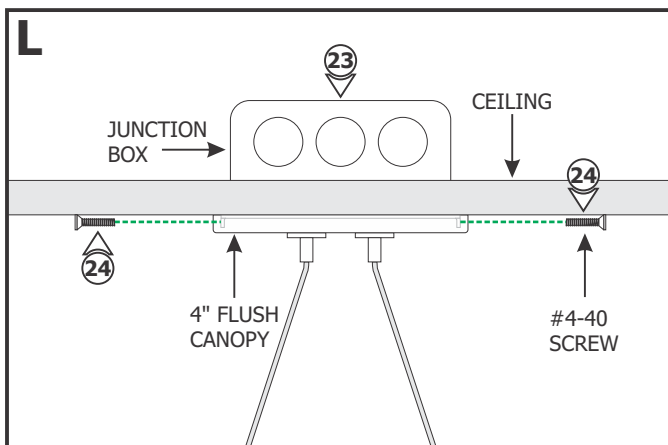
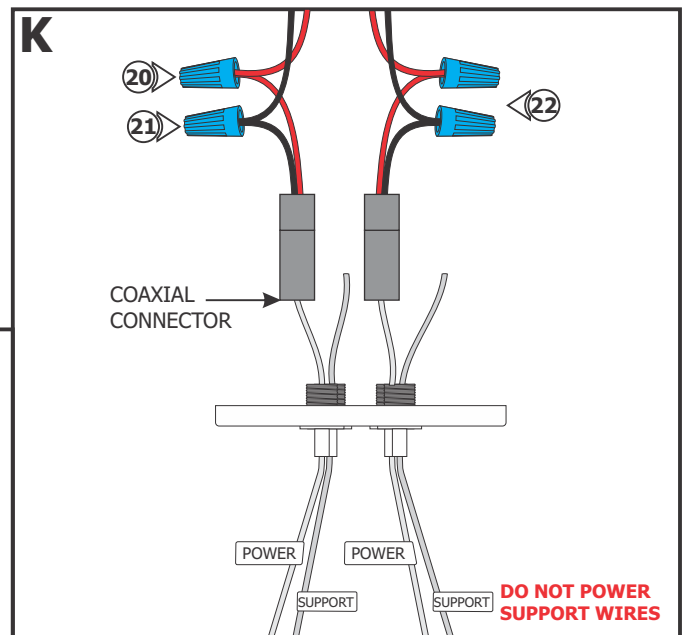

23: Place all wires and wire nut connections inside the junction box.

24: Align the canopy with the mounting ring and secure it with the two #4-40 screws using a 1/16" Allen wrench.

Section Two: Install Additional Support

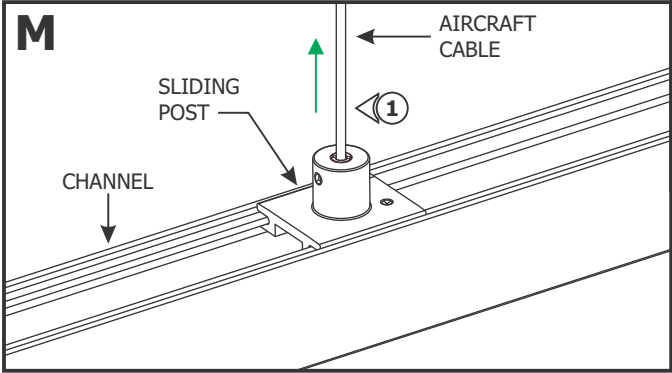

NOTE: Omit this section if the sides of the fixture are less than 72" or do not come with support cables in the middle of the channels.

1: Lift the end of the aircraft cable coming from the sliding post against the ceiling to mark the location of the standoff.

- 2:** Tap the anchor onto the marked location up to the threaded portion with a hammer.
- 3:** Screw in the threaded portion of the anchor with a Phillips screwdriver.

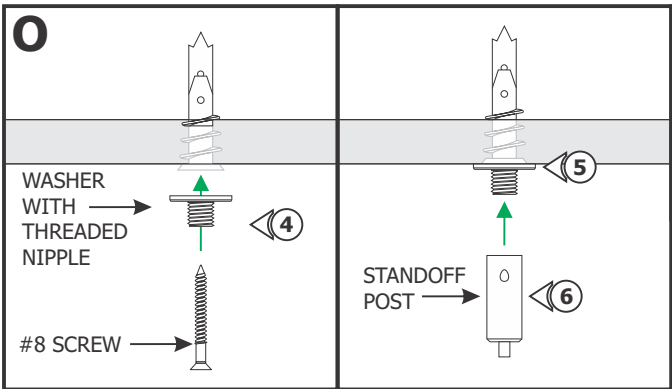
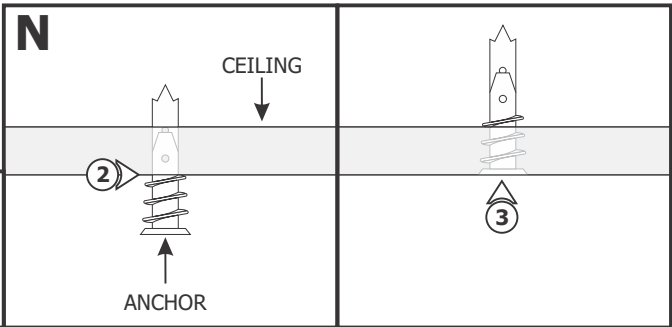

- 4:** Feed the #8 screw through the washer with threaded nipple into the anchor.
- 5:** Tighten the #8 screw completely into the anchor.
- 6:** Tighten the standoff post completely onto the threaded nipple.

- 7:** Feed the aircraft cable coming from the fixture through the standoff post.
- 8:** Push the cord grip and pull the aircraft cable out of the side of the standoff post. Release the cord grip to secure the aircraft cable in place.
- 9:** If necessary, trim excess aircraft cable using sharp cutters.
- 10:** Repeat steps 1 through 9 for the remaining supports on the other sides of the fixture.

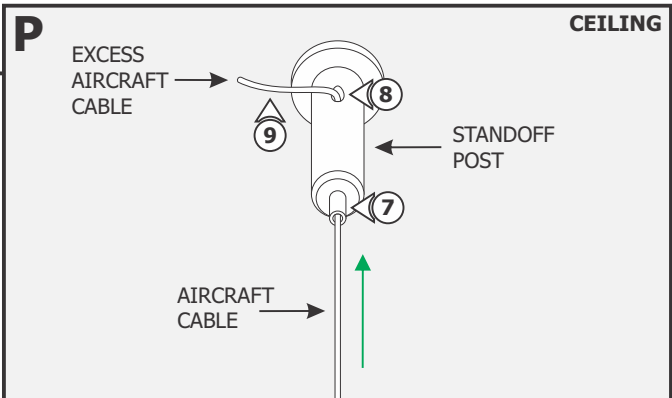

General Wiring Diagram

