

## Installation Instructions for 4 x 4 LED

### IMPORTANT INFORMATION

- This product is ETL listed for indoor and outdoor locations.
- **RISK OF FIRE:** This product must be installed 4 ft above the ground for wet locations.
- This product can be wall or ceiling mounted.
- This product can mount to either a 4" square electrical box with round plaster ring or an octagon electrical box.

**SAVE THESE INSTRUCTIONS!**

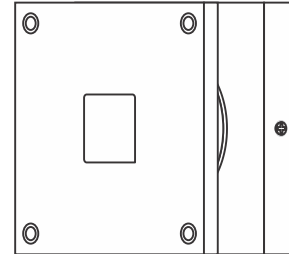

## Install the Fixture

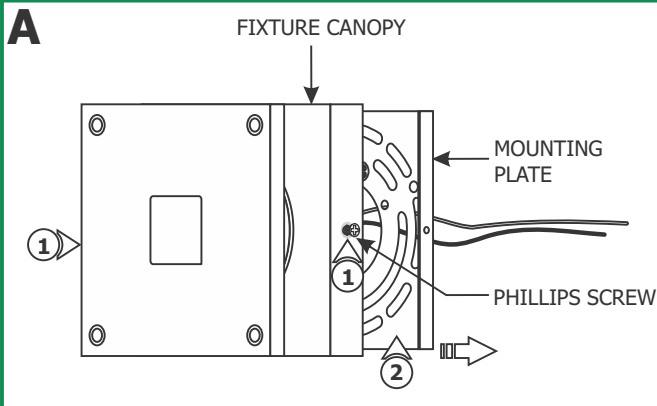

- 1: Remove the two Phillips screws on the sides of the fixture canopy.
- 2: Pull the mounting plate off of the fixture canopy.

- 3: Connect the white power supply wire to the neutral power wire with a wire nut.
- 4: Connect the black power supply wire to the hot power wire with a wire nut.
- 5: Place the power supply and wires inside the electrical box.

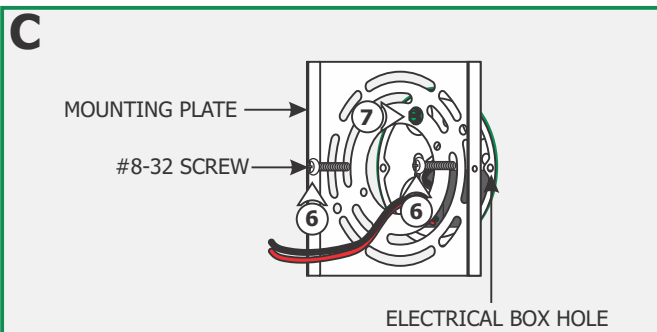
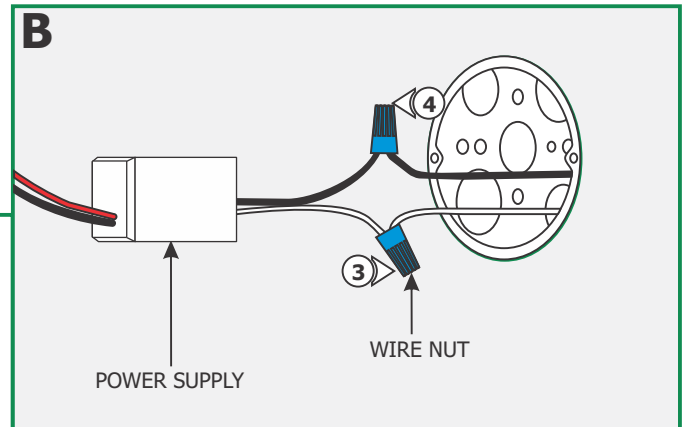

- 6: Line up the mounting plate with the electrical box holes, and secure it in place by tightening the two #8-32 screws provided.
- 7: Make sure that the mounting plate is grounded in accordance with local electrical codes.

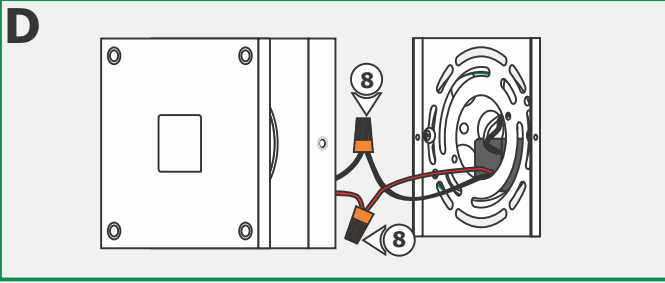

**8:** Connect the red power supply wire to the red fixture wire with a wire nut.

**9:** Connect the black power supply to the black fixture wire with a wire nut.

**10:** Place the wires inside the electrical box.

**11:** Place the fixture canopy onto the mounting plate, make sure the gasket is in place and secure it by tightening the two Phillips screws.

**12:** For installation in **wet location**, caulk around the fixture canopy with waterproof construction sealant.

**NOTE:** This fixture contains an **8.7** watt integrated LED lamp. These lamps are rated for 50,000 hours.

