



INDEPENDENT TESTING LABORATORIES, INC.
3386 LONGHORN ROAD, BOULDER, CO 80302 USA

PHONE: (303)442-1255 • FAX: (303)449-5274 • E-MAIL: itl@itlboulder.com • WEBSITE: www.itlboulder.com

DATE: 08/08/09

REPORT NUMBER: ITL62907

PREPARED FOR: EDGE LIGHTING

CATALOG NUMBER: SUN3-**-**-**

LUMINAIRE: CAST METAL HOUSING WITH FINNED UPPER SECTION, ONE CIRCUIT BOARD WITH FOUR LEDS, ONE CLEAR PLASTIC LENS BELOW LEDS WITH MICRO-PRISMATIC BOTTOM, CLEAR FLAT GLASS LENS IN FABRICATED SEMI-DIFFUSE METAL FRAME.

LAMPS: FOUR LIGHT EMITTING DIODE WHITE LIGHT EMITTING DIODES (LEDs), VERTICAL BASE-UP POSITION.

TOTAL INPUT WATTS = 10.2 AT 120.0 VOLTS

MOUNTING: RECESSED

LED DRIVER: MDL CORP 319-0002

NOTE: DATA SHOWN IS ABSOLUTE FOR THE SAMPLE PROVIDED AT RATED INPUT VOLTAGE (120VAC, 60Hz) TO THE LED DRIVER. A 6 FOOT POWER CORD EXTENDS FROM THE LED DRIVER TO THE LED ASSEMBLY.

TEST PROCEDURE: IESNA LM-79-08

TEST DISTANCE = 25.25 FEET

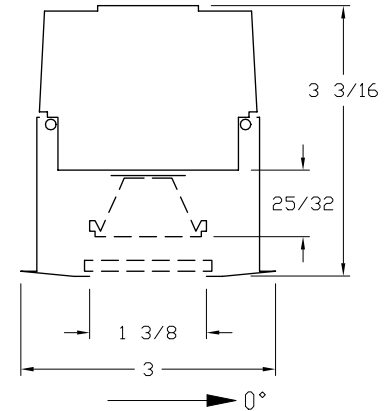

DEG	CANDELA	LUMENS
0	1520	
5	1353	114
15	497	137
25	113	55
35	31	20
45	12	9
55	5	4
65	2	1
75	1	0
85	0	0
90	0	

ZONAL LUMEN SUMMARY

ZONE	LUMENS	%FIXT
0- 30	307	89.2
0- 40	328	95.2
0- 60	342	99.3
0- 90	345	100.0
90-180	0	0.0
0-180	345	100.0

EFFICACY = 33.8 Lm/W

CIE TYPE - DIRECT

LUMINAIRE SPACING CRITERION = 0.4

BEAM ANGLE (50%) : 23.4 DEGREES

FIELD ANGLE (10%) : 45.9 DEGREES

LUMINOUS LENGTH : 1.375 1.375

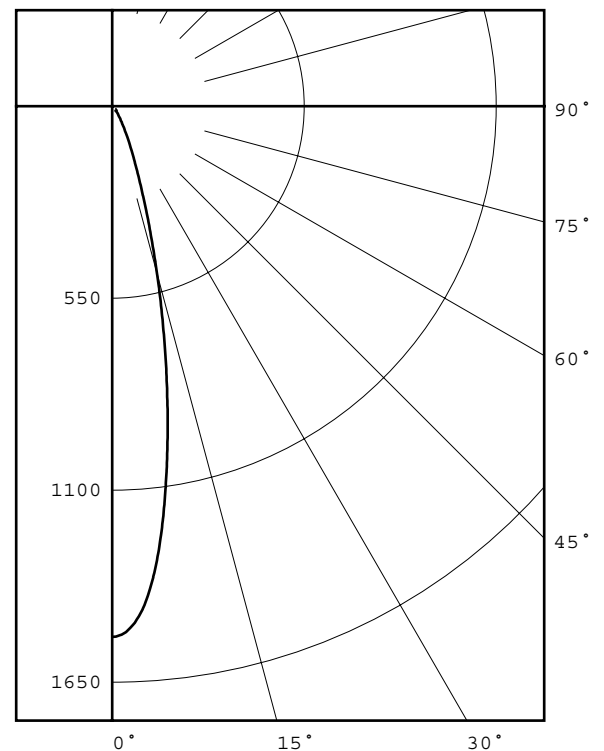

LUMINANCE DATA IN CANDELA/SQ M
ANGLE AVERAGE
IN DEG

45	13913.
55	7147.
65	3880.
75	3168.
85	0.

Checked N. WHITE

Approved R. BERGIN



INDEPENDENT TESTING LABORATORIES, INC.
3386 LONGHORN ROAD, BOULDER, CO 80302 USA

PHONE: (303)442-1255 • FAX: (303)449-5274 • E-MAIL: itl@itlboulder.com • WEBSITE: www.itlboulder.com

REPORT NUMBER: ITL62907
PREPARED FOR: EDGE LIGHTING

DATE: 08/08/09

CANDELA DISTRIBUTION

0.0	1520	82.5	0
0.5	1519	85.0	0
1.0	1514	87.5	0
1.5	1507	90.0	0
2.0	1495		
2.5	1481		
3.0	1463		
3.5	1442		
4.0	1416		
4.5	1386		
5.0	1353		
5.5	1318		
6.0	1278		
6.5	1237		
7.0	1193		
7.5	1148		
8.0	1101		
8.5	1055		
9.0	1007		
9.5	961		
10.0	915		
10.5	869		
11.0	823		
11.5	779		
12.0	735		
12.5	692		
13.0	650		
13.5	610		
14.0	571		
14.5	534		
15.0	497		
15.5	462		
16.0	429		
16.5	398		
17.0	369		
17.5	342		
18.0	316		
18.5	294		
19.0	271		
19.5	252		
20.0	233		
22.5	161		
25.0	113		
27.5	80		
30.0	57		
32.5	42		
35.0	31		
37.5	24		
40.0	18		
42.5	15		
45.0	12		
47.5	10		
50.0	8		
52.5	7		
55.0	5		
57.5	4		
60.0	3		
62.5	2		
65.0	2		
67.5	1		
70.0	1		
72.5	1		
75.0	1		
77.5	0		
80.0	0		

ZONAL LUMEN SUMMARY

0- 5	34.
5- 10	80.
10- 15	81.
15- 20	57.
20- 25	35.
25- 30	21.
30- 35	13.
35- 40	8.
40- 45	6.
45- 50	4.
50- 55	3.
55- 60	2.
60- 65	1.
65- 70	1.
70- 75	1.
75- 80	0.
80- 85	0.
85- 90	0.
90- 95	0.
95-100	0.
100-105	0.
105-110	0.
110-115	0.
115-120	0.
120-125	0.
125-130	0.
130-135	0.
135-140	0.
140-145	0.
145-150	0.
150-155	0.
155-160	0.
160-165	0.
165-170	0.
170-175	0.
175-180	0.

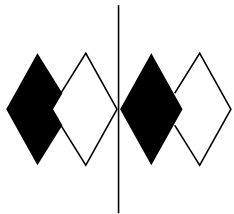

itl boulder
THE LIGHT CENTER OF THE INDUSTRY SINCE 1955

INDEPENDENT TESTING LABORATORIES, INC.
3386 LONGHORN ROAD, BOULDER, CO 80302 USA

PHONE: (303)442-1255 • FAX: (303)449-5274 • E-MAIL: itl@itlboulder.com • WEBSITE: www.itlboulder.com

REPORT NUMBER: ITL62907

DATE: 08/08/09

PREPARED FOR: EDGE LIGHTING

COEFFICIENTS OF UTILIZATION - ZONAL CAVITY METHOD

EFFECTIVE FLOOR CAVITY REFLECTANCE 0.20

RC	80				70				50			30			10			0
RW	70	50	30	10	70	50	30	10	50	30	10	50	30	10	50	30	10	0
0	119	119	119	119	117	117	117	117	111	111	111	107	107	107	102	102	102	100
1	115	113	111	109	113	111	109	107	107	105	104	103	102	101	99	99	98	96
2	111	107	104	101	109	105	102	100	102	100	98	99	97	95	96	95	94	92
3	107	102	98	95	105	100	97	94	98	95	92	96	93	91	93	91	90	88
4	103	97	93	90	101	96	92	89	94	91	88	92	89	87	90	88	86	85
5	100	93	89	85	98	92	88	85	91	87	84	89	86	84	88	85	83	82
6	96	90	85	82	95	89	85	81	87	84	81	86	83	80	85	82	80	79
7	93	86	82	79	92	86	81	78	85	81	78	84	80	78	83	80	77	76
8	91	83	79	76	90	83	79	76	82	78	75	81	78	75	80	77	75	74
9	88	81	76	73	87	80	76	73	79	76	73	79	75	73	78	75	73	72
10	85	78	74	71	85	78	74	71	77	73	71	76	73	71	76	73	70	69

ALL CANDELA, LUMENS, LUMINANCE, AND VCP VALUES IN THIS REPORT ARE
BASED ON ABSOLUTE PHOTOMETRY. THE COEFFICIENT OF UTILIZATION VALUES
ARE BASED ON THE TOTAL ABSOLUTE LUMEN OUTPUT OF THIS LUMINAIRE SAMPLE.

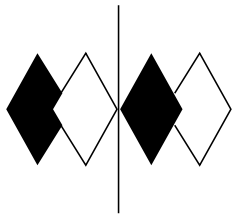

itl boulder
THE LIGHT CENTER OF THE INDUSTRY SINCE 1955

INDEPENDENT TESTING LABORATORIES, INC.
3386 LONGHORN ROAD, BOULDER, CO 80302 USA

PHONE: (303)442-1255 • FAX: (303)449-5274 • E-MAIL: itl@itlboulder.com • WEBSITE: www.itlboulder.com

REPORT NUMBER: ITL62907

DATE: 08/08/09

PREPARED FOR: EDGE LIGHTING

CONE OF LIGHT DIAGRAM

(diameter shown is where fc value is half the fc at nadir)

