



Designed by Gregory Kay - Patent Pending

Additional System Connectors



M-ATL-6-PN
Fast Jack Atlas in Polished Nickel. Shown with Monorail connector.



M-ATL-6-PN
Fast Jack Atlas with snoot in Polished Nickel. Shown with Monorail connector.

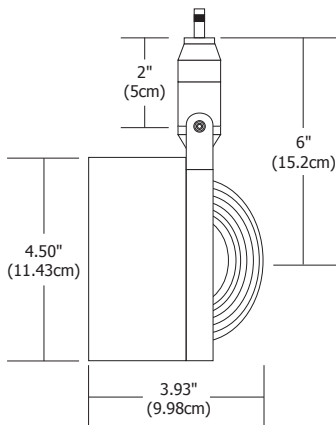

Fast Jack Atlas without snoot shown

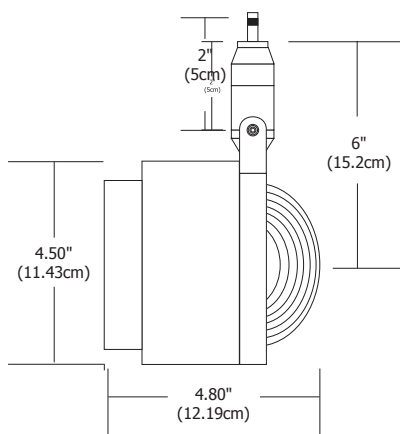

Fast Jack Atlas with snoot shown

Description:

Atlas, Pro Aim LED111 (4.4" diameter) fixture features manual locking horizontal and vertical rotation with spread lens locking capability. Pivots 0° to 90° adjustment and rotates 360°. LEDs do not project UV or IR toward the illuminated object. Cool to touch and safe to rotate by hand. Comes with a Fast Jack connector, snoot, and is 6" in length to center of head.

System:

Mounts to any Fast Jack LED 12VAC power canopy or any Monorail Fast Jack Connector, or Monorail 2 Circuit Fast Jack Connector with a magnetic transformer on the system.

Accessories:

4" Optical Controls: Snoot (included), Glass Lens (sold separately)

Body Finish:

Satin Nickel, Polished Nickel or White

Lamp Size:

111 mm, 4.3 inches

Lamp Type:

LED111 (4.4"), 22 watts 12vac, 3500K, 80CRI, 1300 Lumens, 50,000 hours at 70% of lamp initial lumen output

Dimmable:

With magnetic dimmer, with LED electronic transformer use an electronic dimmer

Weight:

2 lb (.9 kg)

System	Fixture	Length	Finish
FJ	ATL	6	SN

FJ Fast Jack
M Monorail
M2 Monorail 2 Circuit

ATL Atlas fixture

6" 6" (15.2cm)

SN Satin Nickel
PN Polished Nickel
WH White

Additional System Connectors — Fast Jack Power Canopy Ordered Separately



PROJECT:

FIXTURE
TYPE:

DATE: