



Description: Beam wall sconce features a satin aluminum finish and can accommodate up to a 50 watt 12 volt MR16 halogen lamp (not included). 60 watt electronic transformer included. General downward light distribution.

Body Finish: Satin Aluminum

Lamp: **HALOGEN (H)**
H1 - MR16/GU5.3/50W/12V

Total Wattage: H1 - 50W

Dimmer: Low voltage electronic

Dimensions: W 5" x H 4.75" x D 5.25"
W 12.7cm x H 12.1cm x D 13.3cm

Weight: 3.25 lbs (1.47 kg)

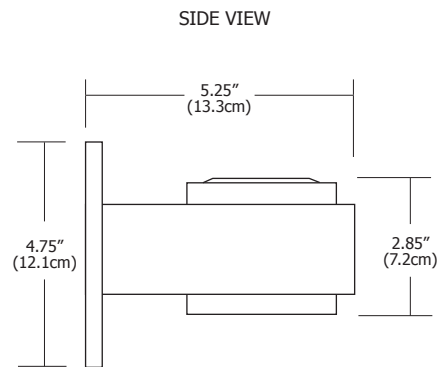
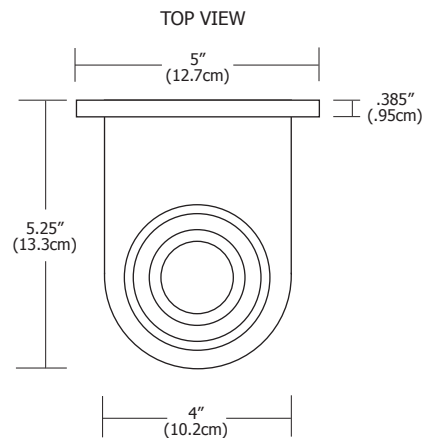

| Ordering Code | Type | Lamp | Finish | Voltage |
|---------------|-----------|---------------|----------------------|----------------------------------|
| BEAM | W | H1 | SA | Standard 120V (leave blank) |
| | -W - Wall | -H1 - Halogen | -SA - Satin Aluminum | -2 - 230V 50Hz -3 - 277V 60Hz |

| | | |
|----------|---------------|--------------|
| COMPANY: | FIXTURE TYPE: | DATE: |
| PROJECT: | CONSULTANT: | APPROVED BY: |